

Oklahoma Corporation Commission
Oil & Gas Conservation Division
Post Office Box 52000
Oklahoma City, Oklahoma 73152-2000
Rule 165: 10-3-25

Form 1002A

API No.: 35037293550000

Completion Report

Spud Date: November 11, 2016

OTC Prod. Unit No.:

Drilling Finished Date: November 16, 2016

1st Prod Date: December 21, 2016

Completion Date: December 05, 2016

Drill Type: STRAIGHT HOLE

Well Name: TIGER CREEK 2

Purchaser/Measurer:

Location: CREEK 5 17N 7E
SW SW NE NW
1332 FSL 1395 FWL of 1/4 SEC
Latitude: 35.984913 Longitude: -96.59743
Derrick Elevation: 0 Ground Elevation: 830

First Sales Date:

Operator: LITTLE RIVER ENERGY COMPANY 10148
PO BOX 1113
1260-A E BROADWAY ST
DRUMRIGHT, OK 74030-1113

| Completion Type | | Location Exception | | Increased Density | |
|-----------------|---------------|--------------------|--|-------------------|--|
| X | Single Zone | Order No | | Order No | |
| | Multiple Zone | 658003 | | 657585 | |
| | Commingle | | | | |

| Casing and Cement | | | | | | | |
|-------------------|-------|--------|-------|------|------|-----|------------|
| Type | Size | Weight | Grade | Feet | PSI | SAX | Top of CMT |
| SURFACE | 8.625 | 23 | J | 740 | 4000 | 380 | SURFACE |
| PRODUCTION | 5.50 | 15.5 | J | 3140 | 4000 | 405 | SURFACE |

| Liner | | | | | | | | |
|--|------|--------|-------|--------|-----|-----|-----------|--------------|
| Type | Size | Weight | Grade | Length | PSI | SAX | Top Depth | Bottom Depth |
| There are no Liner records to display. | | | | | | | | |

Total Depth: 3200

| Packer | |
|---|--------------|
| Depth | Brand & Type |
| There are no Packer records to display. | |

| Plug | |
|---------------------------------------|-----------|
| Depth | Plug Type |
| There are no Plug records to display. | |

| Initial Test Data | | | | | | | | | | |
|-------------------|-----------|-------------|-------------------|-------------|-------------------------|---------------|-------------------|--------------------------|------------|----------------------|
| Test Date | Formation | Oil BBL/Day | Oil-Gravity (API) | Gas MCF/Day | Gas-Oil Ratio Cu FT/BBL | Water BBL/Day | Pumpin or Flowing | Initial Shut-In Pressure | Choke Size | Flow Tubing Pressure |
| Dec 21, 2016 | RED FORK | 15 | 35 | | | | SWAB | | | |

Completion and Test Data by Producing Formation

Formation Name: RED FORK

Code: 404RDFK

Class: OIL

Spacing Orders

| Order No | Unit Size |
|----------|-----------|
| 563445 | 10 |

Perforated Intervals

| From | To |
|------|------|
| 2545 | 2548 |

Acid Volumes

| |
|-------------|
| 250 GALLONS |
|-------------|

Fracture Treatments

| |
|----------------------------|
| 11,500 POUNDS, 230 BARRELS |
|----------------------------|

| Formation | Top |
|------------|------|
| HOGSHOOTER | 1430 |
| LAYTON | 1445 |
| BIG LIME | 2205 |
| OSWEGO | 2240 |
| PRUE | 2320 |
| PINK LIME | 2530 |
| RED FORK | 2545 |
| 1ST WILCOX | 2775 |

Were open hole logs run? Yes

Date last log run: November 15, 2016

Were unusual drilling circumstances encountered? No

Explanation:

Other Remarks

INDUCTION, DENSITY AND BOND LOGS ENCLOSED

FOR COMMISSION USE ONLY

1135743

Status: Accepted

RECEIVED

Form 1002A
Rev. 2009

JAN 23 2017

OKLAHOMA CORPORATION
COMMISSION

OKLAHOMA CORPORATION COMMISSION
Oil & Gas Conservation Division
Post Office Box 52000
Oklahoma City, Oklahoma 73152-2000
Rule 165:10-3-25

COMPLETION REPORT

API NO. 037-29355
OTC PROD.
UNIT NO.

PLEASE TYPE OR USE BLACK INK ONLY
NOTE:

Attach copy of original 1002A
if recompletion or reentry.

☒ ORIGINAL
☐ AMENDED (Reason)

TYPE OF DRILLING OPERATION

☒ STRAIGHT HOLE ☐ DIRECTIONAL HOLE ☐ HORIZONTAL HOLE
☐ SERVICE WELL

If directional or horizontal, see reverse for bottom hole location.

| | | | | | | | | | |
|-----------------------------|-----------------------------------|-------|---------------------|-------------------------|---------|-----|----------------------|--------------------|----------|
| COUNTY | Creek | SEC | 5 | TWP | 17N | RGE | 7E | SPUD DATE | 11/11/16 |
| LEASE NAME | TIGER CREEK | | | WELL NO. | 2 | | | DRLG FINISHED DATE | 11/16/16 |
| SW 1/4 SW 1/4 NE 1/4 NW 1/4 | FSL 1/4 SEC 1332 FWL 1/4 SEC 1395 | | | DATE OF WELL COMPLETION | 12/5/16 | | | 1st PROD DATE | 12/21/16 |
| ELEVATION N Derrick | Ground | 830 | Latitude (if known) | 35.984913 | | | Longitude (if known) | -96.597430 | |
| OPERATOR NAME | LITTLE RIVER ENERGY | | | OTC/OCC OPERATOR NO. | 10148 | | | | |
| ADDRESS | PO BOX 1113 | | | | | | | | |
| CITY | DRUMRIGHT | STATE | OK | ZIP | 74030 | | | | |

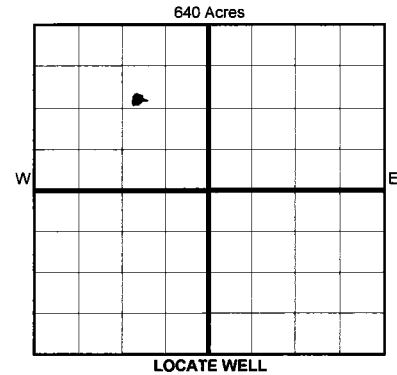

COMPLETION TYPE

| | |
|---|--------|
| <input checked="" type="checkbox"/> SINGLE ZONE | |
| <input type="checkbox"/> MULTIPLE ZONE | |
| Application Date | |
| COMMINGLED | |
| Application Date | |
| LOCATION | 658003 |
| EXCEPTION ORDER | |
| INCREASED DENSITY ORDER NO. | 657585 |

CASING & CEMENT (Form 1002C must be attached)

| TYPE | SIZE | WEIGHT | GRADE | FEET | PSI | SAX | TOP OF CMT |
|--------------|-------|--------|-------|------|------|-----|------------|
| CONDUCTOR | | | | | | | |
| SURFACE | 8.625 | 23 | J | 740 | 4000 | 380 | SURFACE |
| INTERMEDIATE | | | | | | | |
| PRODUCTION | 5.50 | 15.5 | J | 3140 | 4000 | 405 | SURFACE |
| LINER | | | | | | | |

PACKER @ NA BRAND & TYPE PLUG @ TYPE PLUG @ TYPE
PACKER @ BRAND & TYPE PLUG @ TYPE PLUG @ TYPE

TOTAL DEPTH 3,200

COMPLETION & TEST DATA BY PRODUCING FORMATION 404RDFK

| | | | | | |
|---|----------------------|--|--|--|--|
| FORMATION | RED FORK | | | | |
| SPACING & SPACING ORDER NUMBER | 269243 & 563445 (10) | | | | |
| CLASS: Oil, Gas, Dry, Inj, Disp, Comm Disp, Svc | OIL | | | | |
| PERFORATED INTERVALS | 2545 - 2548 | | | | |
| ACID/VOLUME | 250 GAL | | | | |
| FRACTURE TREATMENT (Fluids/Prop Amounts) | 11,500# | | | | |
| | 230 BBLs | | | | |

Monitor Report to Flow Focus

☐ Min Gas Allowable (165:10-17-7) OR ☐ Oil Allowable (165:10-13-3) Gas Purchaser/Measurer First Sales Date

INITIAL TEST DATA

| | | | | | |
|--------------------------|------------|--|--|--|--|
| INITIAL TEST DATE | 12/21/2016 | | | | |
| OIL-BBL/DAY | 15 | | | | |
| OIL-GRAVITY (API) | 35 | | | | |
| GAS-MCF/DAY | NOMINAL | | | | |
| GAS-OIL RATIO CU FT/BBL | | | | | |
| WATER-BBL/DAY | -0- | | | | |
| PUMPING OR FLOWING | SWAB | | | | |
| INITIAL SHUT-IN PRESSURE | -0- | | | | |
| CHOKE SIZE | NA | | | | |
| FLOW TUBING PRESSURE | NA | | | | |

AS SUBMITTED

A record of the formations drilled through, and pertinent remarks are presented on the reverse. I declare that I have knowledge of the contents of this report and am authorized by my organization to make this report, which was prepared by me or under my supervision and direction, with the data and facts stated herein to be true, correct, and complete to the best of my knowledge and belief.

R. Steve Crowder
SIGNATURE NAME (PRINT OR TYPE) 1/16/2017 918-352-4444
PO Box 1113 Drumright OK 74030
ADDRESS CITY STATE ZIP littleriver07@att.net
EMAIL ADDRESS

PLEASE TYPE OR USE BLACK INK ONLY

FORMATION RECORD

Give formation names and tops, if available, or descriptions and thickness of formations drilled through. Show intervals cored or drillstem tested.

| NAMES OF FORMATIONS | TOP |
|---------------------|-------|
| HOGSHOOTER | 1,430 |
| LAYTON | 1,445 |
| BIG LIME | 2,205 |
| OSWEGO | 2,240 |
| PRUE | 2,320 |
| PINK LIME | 2,530 |
| RED FORK | 2,545 |
| 1ST WILCOX | 2,775 |
| TOTAL DEPTH | 3,200 |

LEASE NAME

TIGER CREEK

WELL NO.

2

FOR COMMISSION USE ONLY

ITD on file ☐ YES ☐ NO

APPROVED DISAPPROVED

2) Reject Codes

Were open hole logs run? ☒ yes ☐ no

Date Last log was run 11/15/2016

Was CO₂ encountered? ☐ yes ☒ no at what depths?

Was H₂S encountered? ☐ yes ☒ no at what depths?

Were unusual drilling circumstances encountered? ☐ yes ☒ no
If yes, briefly explain below

Other remarks: INDUCTION, DENSITY AND BOND LOGS ENCLOSED

640 Acres

| | | | | | | | | | |
|--|--|--|--|--|--|--|--|--|--|
| | | | | | | | | | |
| | | | | | | | | | |
| | | | | | | | | | |
| | | | | | | | | | |
| | | | | | | | | | |
| | | | | | | | | | |
| | | | | | | | | | |
| | | | | | | | | | |
| | | | | | | | | | |
| | | | | | | | | | |

If more than three drainholes are proposed, attach a separate sheet indicating the necessary information.

Direction must be stated in degrees azimuth. Please note, the horizontal drainhole and its end point must be located within the boundaries of the lease or spacing unit.

Directional surveys are required for all drainholes and directional wells.

640 Acres

| | | | | | | | | | |
|--|--|--|--|--|--|--|--|--|--|
| | | | | | | | | | |
| | | | | | | | | | |
| | | | | | | | | | |
| | | | | | | | | | |
| | | | | | | | | | |
| | | | | | | | | | |
| | | | | | | | | | |
| | | | | | | | | | |
| | | | | | | | | | |
| | | | | | | | | | |

BOTTOM HOLE LOCATION FOR DIRECTIONAL HOLE

| | | | | | |
|----------------------|-----|-------------------------|--------|---|-----|
| SEC | TWP | RGE | COUNTY | | |
| Spot Location | | Feet From 1/4 Sec Lines | | FSL | FWL |
| 1/4 | 1/4 | 1/4 | 1/4 | | |
| Measured Total Depth | | True Vertical Depth | | BHL From Lease, Unit, or Property Line: | |

BOTTOM HOLE LOCATION FOR HORIZONTAL HOLE: (LATERALS)

LATERAL #1

| | | | | | |
|----------------------|-----|-------------------------|-----------|---|-----|
| SEC | TWP | RGE | COUNTY | | |
| Spot Location | | Feet From 1/4 Sec Lines | | FSL | FWL |
| 1/4 | 1/4 | 1/4 | 1/4 | | |
| Depth of Deviation | | Radius of Turn | Direction | Total Length | |
| Measured Total Depth | | True Vertical Depth | | BHL From Lease, Unit, or Property Line: | |

LATERAL #2

| | | | | | |
|----------------------|-----|-------------------------|-----------|---|-----|
| SEC | TWP | RGE | COUNTY | | |
| Spot Location | | Feet From 1/4 Sec Lines | | FSL | FWL |
| 1/4 | 1/4 | 1/4 | 1/4 | | |
| Depth of Deviation | | Radius of Turn | Direction | Total Length | |
| Measured Total Depth | | True Vertical Depth | | BHL From Lease, Unit, or Property Line: | |

LATERAL #3

| | | | | | |
|----------------------|-----|-------------------------|-----------|---|-----|
| SEC | TWP | RGE | COUNTY | | |
| Spot Location | | Feet From 1/4 Sec Lines | | FSL | FWL |
| 1/4 | 1/4 | 1/4 | 1/4 | | |
| Depth of Deviation | | Radius of Turn | Direction | Total Length | |
| Measured Total Depth | | True Vertical Depth | | BHL From Lease, Unit, or Property Line: | |