

Oklahoma Corporation Commission
Oil & Gas Conservation Division
Post Office Box 52000
Oklahoma City, Oklahoma 73152-2000
Rule 165: 10-3-25

Form 1002A

API No.: 35117236740000

Completion Report

Spud Date: May 16, 2016

OTC Prod. Unit No.:

Drilling Finished Date: May 20, 2016

1st Prod Date:

Completion Date: October 17, 2016

Drill Type: STRAIGHT HOLE

SERVICE WELL

Well Name: GRAVITT 12-36

Purchaser/Measurer:

Location: PAWNEE 36 20N 7E
C S2 NE NW
1650 FSL 1980 FWL of 1/4 SEC
Derrick Elevation: 0 Ground Elevation: 912

First Sales Date:

Operator: HALL GREG OIL & GAS LLC 21902

2940 NW 156TH ST
EDMOND, OK 73013-2102

Completion Type		Location Exception		Increased Density	
X	Single Zone	Order No		Order No	
	Multiple Zone	There are no Location Exception records to display.		There are no Increased Density records to display.	
	Commingled				

Casing and Cement							
Type	Size	Weight	Grade	Feet	PSI	SAX	Top of CMT
SURFACE	8 5/8	24	J-55	718		230	SURFACE
PRODUCTION	5 1/2	15.5	J-55	2752		110	

Liner								
Type	Size	Weight	Grade	Length	PSI	SAX	Top Depth	Bottom Depth
There are no Liner records to display.								

Total Depth: 3000

Packer		Plug	
Depth	Brand & Type	Depth	Plug Type
2525	TENSION	There are no Plug records to display.	

Initial Test Data

Test Date	Formation	Oil BBL/Day	Oil-Gravity (API)	Gas MCF/Day	Gas-Oil Ratio Cu FT/BBL	Water BBL/Day	Pumpin or Flowing	Initial Shut- In Pressure	Choke Size	Flow Tubing Pressure
There are no Initial Data records to display.										

Completion and Test Data by Producing Formation									
Formation Name: SKINNER				Code: 404SKNR			Class: INJ		
Spacing Orders				Perforated Intervals					
Order No		Unit Size		From			To		
There are no Spacing Order records to display.				2575			2950		
Acid Volumes				Fracture Treatments					
There are no Acid Volume records to display.				There are no Fracture Treatments records to display.					

Formation	Top
SKINNER	2575
RED FORK	2684

Were open hole logs run? Yes
 Date last log run: May 20, 2016

 Were unusual drilling circumstances encountered? No
 Explanation:

Other Remarks
PERMIT NUMBER 1609620049

FOR COMMISSION USE ONLY
<div>Status: Accepted</div> <div>1135595</div>

API NO. 117 23674
OTC PROD.
UNIT NO.

PLEASE TYPE OR USE BLACK INK ONLY
NOTE:

Attach copy of original 1002A
if recompletion or reentry.

OKLAHOMA CORPORATION COMMISSION
Oil & Gas Conservation Division
Post Office Box 52000
Oklahoma City, Oklahoma 73152-2000
Rule 165-10-3-25

RECEIVED

DEC 02 2016

OKLAHOMA CORPORATION
COMMISSION

☒ ORIGINAL
☐ AMENDED (Reason)

TYPE OF DRILLING OPERATION

☒ STRAIGHT HOLE ☐ DIRECTIONAL HOLE ☐ HORIZONTAL HOLE
☒ SERVICE WELL

If directional or horizontal, see reverse for bottom hole location.

COUNTY	Pawnee	SEC	36	TWP	20N	RGE	7E	SPUD DATE	5/16/16	
LEASE NAME	Gravitt				WELL NO.	12-36	DATE OF WELL COMPLETION	10/17/16		
C	1/4 S/2	1/4 NE	1/4 NW	1/4	FSL OF 1/4 SEC	1650	FWL OF 1/4 SEC	1980	1st PROD DATE	N/A
ELEVATION	Ground				912	Latitude (if known)		Longitude (if known)		
OPERATOR NAME	Greg Hall Oil & Gas, LLC.				OTC/OCC OPERATOR NO.		21902			
ADDRESS	2940 NW 156th St.									
CITY	Edmond		STATE	OK		ZIP	73013			

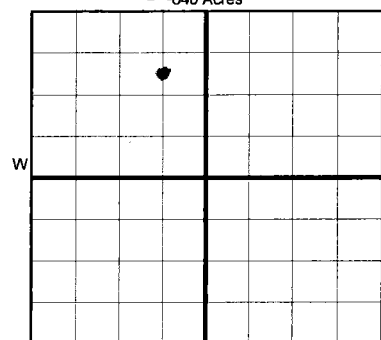

COMPLETION TYPE

<input checked="" type="checkbox"/> SINGLE ZONE
<input type="checkbox"/> MULTIPLE ZONE
<input type="checkbox"/> COMMINGLED
<input type="checkbox"/> LOCATION
<input type="checkbox"/> EXCEPTION ORDER
<input type="checkbox"/> INCREASED DENSITY
<input type="checkbox"/> ORDER NO.

CASING & CEMENT (Form 1002C must be attached)

TYPE	SIZE	WEIGHT	GRADE	FEET	PSI	SAX	TOP OF CMT
CONDUCTOR							
SURFACE	8 5/8	24	J-55	718		230	surface
INTERMEDIATE							
PRODUCTION	5 1/2	15.5	J-55	2752		110	
LINER							
TOTAL DEPTH						3,000	

PACKER @ 2,525 BRAND & TYPE Tension PLUG @ TYPE PLUG @ TYPE
PACKER @ BRAND & TYPE PLUG @ TYPE PLUG @ TYPE

COMPLETION & TEST DATA BY PRODUCING FORMATION

FORMATION	Skinner						No Frac
SPACING & SPACING ORDER NUMBER	N/A						
CLASS: Oil, Gas, Dry, Inj, Disp, Comm Disp, Svc	Inj.						
PERFORATED INTERVALS	2575-2950						
ACID/VOLUME							
FRACTURE TREATMENT (Fluids/Prop Amounts)	N/A						

Min Gas Allowable (165-10-17-7)

Gas Purchaser/Measurer

OR
Oil Allowable (165-10-13-3)

First Sales Date

INITIAL TEST DATA

INITIAL TEST DATE	10/17/2016						
OIL-BBL/DAY	N/A						
OIL-GRAVITY (API)							
GAS-MCF/DAY	N/A						
GAS-OIL RATIO CU FT/BBL	N/A						
WATER-BBL/DAY	N/A						
PUMPING OR FLOWING	N/A						
INITIAL SHUT-IN PRESSURE	N/A						
CHOKE SIZE	N/A						
FLOW TUBING PRESSURE	N/A						

AS SUBMITTED

A record of the formations drilled through, and pertinent remarks are presented on the reverse. I declare that I have knowledge of the contents of this report and am authorized by my organization to make this report, which was prepared by me or under my supervision and direction, with the data and facts stated herein to be true, correct, and complete to the best of my knowledge and belief.

SIGNATURE	NAME (PRINT OR TYPE)	DATE	PHONE NUMBER
Matt Smith	Matt Smith	11/15/2016	405.285.2588
2940 N.W. 156th st	Edmond OK 73013	matt@ghog.co	
ADDRESS	CITY STATE ZIP	EMAIL ADDRESS	

PLEASE TYPE OR USE BLACK INK ONLY

FORMATION RECORD

Give formation names and tops, if available, or descriptions and thickness of formations drilled through. Show intervals cored or drillstem tested.

NAMES OF FORMATIONS	TOP
Skinner	2,575
Red fork	2684

LEASE NAME Gravitt WELL NO. 12-36

FOR COMMISSION USE ONLY

ITD on file ☐ YES ☐ NO

APPROVED _____ DISAPPROVED _____

2) Reject Codes _____

Were open hole logs run? ☒ yes ☐ no

Date Last log was run 5/20/2016

Was CO₂ encountered? ☐ yes ☒ no at what depths? _____

Was H₂S encountered? ☐ yes ☒ no at what depths? _____

Were unusual drilling circumstances encountered? ☐ yes ☒ no

If yes, briefly explain below _____

Other remarks: Permit 1609620049

640 Acres

If more than three drainholes are proposed, attach a separate sheet indicating the necessary information.

Direction must be stated in degrees azimuth. Please note, the horizontal drainhole and its end point must be located within the boundaries of the lease or spacing unit.

Directional surveys are required for all drainholes and directional wells.

640 Acres

BOTTOM HOLE LOCATION FOR DIRECTIONAL HOLE

SEC	TWP	RGE	COUNTY
Spot Location	1/4	1/4	1/4
Measured Total Depth	True Vertical Depth		Feet From 1/4 Sec Lines
		FSL	FWL
BHL From Lease, Unit, or Property Line:			

BOTTOM HOLE LOCATION FOR HORIZONTAL HOLE: (LATERALS)

LATERAL #1

SEC	TWP	RGE	COUNTY
Spot Location	1/4	1/4	1/4
Depth of Deviation	Radius of Turn		Direction
Measured Total Depth	True Vertical Depth		Total Length
		FSL	FWL
BHL From Lease, Unit, or Property Line:			

LATERAL #2

SEC	TWP	RGE	COUNTY
Spot Location	1/4	1/4	1/4
Depth of Deviation	Radius of Turn		Direction
Measured Total Depth	True Vertical Depth		Total Length
		FSL	FWL
BHL From Lease, Unit, or Property Line:			

LATERAL #3

SEC	TWP	RGE	COUNTY
Spot Location	1/4	1/4	1/4
Depth of Deviation	Radius of Turn		Direction
Measured Total Depth	True Vertical Depth		Total Length
		FSL	FWL
BHL From Lease, Unit, or Property Line:			