

Oklahoma Corporation Commission
Oil & Gas Conservation Division
Post Office Box 52000
Oklahoma City, Oklahoma 73152-2000
Rule 165: 10-3-25

Form 1002A

API No.: 35003221520002

Completion Report

Spud Date: January 03, 2012

OTC Prod. Unit No.:

Drilling Finished Date: February 09, 2012

1st Prod Date:

Amended

Completion Date: March 29, 2012

Amend Reason: RECOMPLETION (PLUG BACK FROM ARBUCKLE) AND CORRECTING
BOTTOM HOLE LOCATION (FROM WEST LINE)

Recomplete Date: November 09, 2016

Drill Type: DIRECTIONAL HOLE

SERVICE WELL

Well Name: MISSISSIPPI 14-26-12 SWD 1

Purchaser/Measurer:

Location: ALFALFA 14 26N 12W
SW SW NW SW
1520 FSL 250 FWL of 1/4 SEC
Derrick Elevation: 1347 Ground Elevation: 1329

First Sales Date:

Operator: CHESAPEAKE OPERATING LLC 17441
PO BOX 18496
6100 N WESTERN AVE
OKLAHOMA CITY, OK 73154-0496

Completion Type		Location Exception		Increased Density	
X	Single Zone	Order No		Order No	
	Multiple Zone	There are no Location Exception records to display.		There are no Increased Density records to display.	
	Commingled				

Casing and Cement							
Type	Size	Weight	Grade	Feet	PSI	SAX	Top of CMT
SURFACE	18 5/8	87.5	J-55 / K-55	340		950	SURFACE
INTERMEDIATE	13 3/8	54.5	J-55	1305		1305	SURFACE
PRODUCTION	9 5/8	40	HCK-55	6815		970	4850

Liner								
Type	Size	Weight	Grade	Length	PSI	SAX	Top Depth	Bottom Depth
There are no Liner records to display.								

Total Depth: 9108

Packer	
Depth	Brand & Type
6405	PERMANENT
6780	HALLIBURTON PERMAPAK

Plug	
Depth	Plug Type
6770	CIBP
8499	CEMENT

Initial Test Data

Test Date	Formation	Oil BBL/Day	Oil-Gravity (API)	Gas MCF/Day	Gas-Oil Ratio Cu FT/BBL	Water BBL/Day	Pumpin or Flowing	Initial Shut- In Pressure	Choke Size	Flow Tubing Pressure
There are no Initial Data records to display.										

Completion and Test Data by Producing Formation									
Formation Name: SIMPSON				Code: 202SMPS			Class: DISP		
Spacing Orders				Perforated Intervals					
Order No		Unit Size		From			To		
There are no Spacing Order records to display.				6457			6632		
Acid Volumes				Fracture Treatments					
3,000 GALLONS 15% ACID				There are no Fracture Treatments records to display.					

Formation	Top
SIMPSON	6456
ARBUCKLE	6787

Were open hole logs run? Yes
 Date last log run: January 27, 2012

 Were unusual drilling circumstances encountered? No
 Explanation:

Other Remarks
UIC APPLICATION / PERMIT NUMBER 1703190017

Bottom Holes
Sec: 14 TWP: 26N RGE: 12W County: ALFALFA NE SW SE SW 582 FSL 1742 FWL of 1/4 SEC Depth of Deviation: 0 Radius of Turn: 0 Direction: 0 Total Length: 0 Measured Total Depth: 9108 True Vertical Depth: 8133 End Pt. Location From Release, Unit or Property Line: 582

FOR COMMISSION USE ONLY
<div> <div>Status: Accepted</div> <div>1135594</div> </div>

API NO. 003-22152
OTC PROD. N/A
UNIT NO.

PLEASE TYPE OR USE BLACK INK ONLY

NOTE:

Attach copy of original 1002A if recompletion or reentry.

OKLAHOMA CORPORATION COMMISSION

Oil & Gas Conservation Division

Post Office Box 52000

Oklahoma City, Oklahoma 73152-2000

Rule 165:10-3-25

RECEIVED

Form 1002A

Rev. 2009

DEC 01 2016

OKLAHOMA CORPORATION COMMISSION

☒ ORIGINAL
☒ AMENDED
Reason Amended **Recompletion and correcting BHL (FWL)**

TYPE OF DRILLING OPERATION

☐ STRAIGHT HOLE ☒ DIRECTIONAL HOLE ☐ HORIZONTAL HOLE
☒ SERVICE WELL

If directional or horizontal, see reverse for bottom hole location.

COMPLETION REPORT

COUNTY	Alfalfa	SEC	14	TWP	26N	RGE	12W
LEASE NAME	Mississippi 14-26-12 SWD			WELL NO	1		
SHL	SW 1/4	SW 1/4	NW 1/4	SW 1/4	FSL	FWL OF	
ELEVATION	Derrick Fl 1,347			Ground 1,329	1,520	1/4 SEC	250
OPERATOR NAME	CHESAPEAKE OPERATING, L.L.C.			OTC/OCC OPERATOR NO.	17441		
ADDRESS	P.O. BOX 18496						
CITY	OKLAHOMA CITY			STATE	OK	ZIP	73154

SPUD DATE 1/3/2012
DRLG FINISHED DATE 2/9/2012
DATE OF WELL COMPLETION 3/29/2012
1ST PROD DATE N/A
RECOMP DATE 11/9/2016
Longitude (if Known)

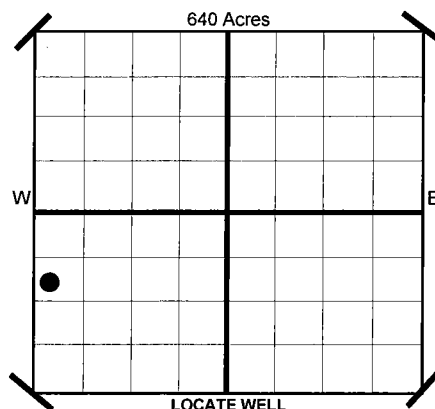

COMPLETION TYPE

<input checked="" type="checkbox"/> SINGLE ZONE
<input type="checkbox"/> MULTIPLE ZONE
Application Date
<input type="checkbox"/> COMMINGLED
Application Date
LOCATION
EXCEPTION ORDER NO. N/A
INCREASED DENSITY ORDER NO. N/A

CASING & CEMENT (Form 1002C must be attached)

TYPE	SIZE	WEIGHT	GRADE	FEET	PSI	SAX	TOP
CONDUCTOR							
SURFACE	18-5/8"	87.5#	J-55/K-55	340		950	Surface
INTERMEDIATE	13-3/8"	54.5#	J-55	1,305		1,305	Surface
PRODUCTION	9-5/8"	40#	HCK-55	6,815		970	4,850
LINER							
TOTAL DEPTH							9,108

PACKER @ 6.780 BRAND & TYPE Halliburton PermaPak
PACKER @ 6.405 BRAND & TYPE Permanent

PLUG @ TYPE PLUG @ 6.770 TYPE CIBP
PLUG @ TYPE PLUG @ 8.499 TYPE Cement

COMPLETION & TEST DATA BY PRODUCING FORMATION

FORMATION	Simpson					No Frac
SPACING & SPACING ORDER NUMBER	N/A					
CLASS: Oil, Gas, Dry, Inj. Disp, Comm Disp, Svc	Disposal					
	6457 - 6632					
PERFORATED INTERVALS						
ACID/VOLUME	3,000 gals 15% acid					
FRACTURE TREATMENT (Fluids/Prop Amounts)						

Minimum Gas Allowable

(165:10-17-7)

Gas Purchaser/Measurer



OR

1st Sales Date

Oil Allowable

(165:10-13-3)

INITIAL TEST DATA

INITIAL TEST DATE					
OIL-BBL/DAY					
OIL-GRAVITY (API)					
GAS-MCF/DAY					
GAS-OIL RATIO CU FT/BBL					
WATER-BBL/DAY					
PUMPING OR FLOWING					
INITIAL SHUT-IN PRESSURE					
CHOKE SIZE					
FLOW TUBING PRESSURE					

AS SUBMITTED

A record of the formations drilled through, and pertinent remarks are presented on the reverse. I declare that I have knowledge of the contents of this report and am authorized by my organization to make this report, which was prepared by me or under my supervision and direction, with the data and facts stated herein to be true, correct, and complete to the best of my knowledge and belief.

SIGNATURE	JEFF BULL - REGULATORY MANAGER	11/29/2016	405-848-8000
P.O. BOX 18496	OKLAHOMA CITY	OK	73154
ADDRESS	CITY	STATE	ZIP
			juanita.cooper@chk.com
			EMAIL ADDRESS

PLEASE TYPE OR USE BLACK INK ONLY
FORMATION RECORD

Give formation names and tops, if available, or descriptions and thickness of formations drilled through. Show intervals cored or drillstem tested.

LEASE NAME Mississippi 14-26-12 SWD

WELL NO. 1

NAMES OF FORMATIONS	TOP
Simpson	6,456
Arbuckle	6,787

FOR COMMISSION USE ONLY	
ITD on file <input type="checkbox"/> YES <input type="checkbox"/> NO	
APPROVED _____	DISAPPROVED _____
2) Reject Codes	

Were open hole logs run?	<input checked="" type="checkbox"/> yes	<input type="checkbox"/> no
Date Last log was run	1/27/2012	
Was CO ₂ encountered?	yes	<input checked="" type="checkbox"/> no at what depths?
Was H ₂ S encountered?	yes	<input checked="" type="checkbox"/> no at what depths?
Were unusual drilling circumstances encountered?	<input type="checkbox"/> yes <input checked="" type="checkbox"/> no	
If yes, briefly explain.		

Other remarks:

UIC Application / Permit No. 1703190017

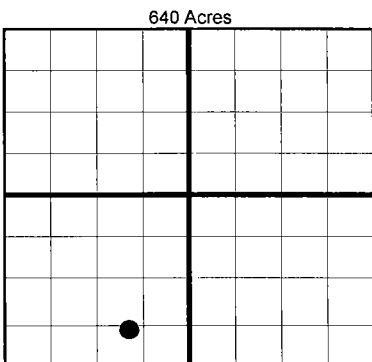

If more than three drainholes are proposed, attach a separate sheet indicating the necessary information.

Direction must be stated in degrees azimuth.
Please note, the horizontal drainhole and its end point must be located within the boundaries of the lease or spacing unit.

Directional surveys are required for all drainholes and directional wells.
640 Acres

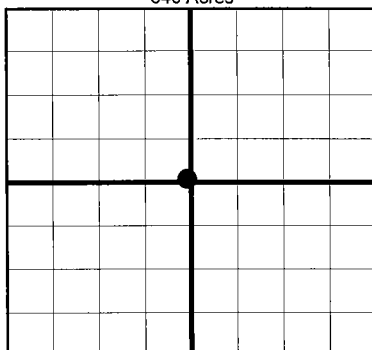

BOTTOM HOLE LOCATION FOR DIRECTIONAL HOLE

SEC 14	TWP 26N	RGE 12W	COUNTY Alfalfa
Spot Location NE 1/4 SW 1/4 SE 1/4 SW 1/4	Feet From 1/4 Sec Lines	FSL 582	FWL 1,742
Measured Total Depth 9,108	True Vertical Depth 8,133	BHL From Lease, Unit, or Property Line: 582	

BOTTOM HOLE LOCATION FOR HORIZONTAL HOLE: (LATERALS)

SEC	TWP	RGE	COUNTY
Spot Location 1/4 1/4 1/4 1/4	Feet From 1/4 Sec Lines	FSL	FWL
Depth of Deviation	Radius of Turn	Direction	Total Length
Measured Total Depth	True Vertical Depth	BHL From Lease, Unit, or Property Line:	

LATERAL #2

SEC	TWP	RGE	COUNTY
Spot Location 1/4 1/4 1/4 1/4	Feet From 1/4 Sec Lines	FSL	FWL
Depth of Deviation	Radius of Turn	Direction	Total Length
Measured Total Depth	True Vertical Depth	BHL From Lease, Unit, or Property Line:	

LATERAL #3

SEC	TWP	RGE	COUNTY
Spot Location 1/4 1/4 1/4 1/4	Feet From 1/4 Sec Lines	FSL	FWL
Depth of Deviation	Radius of Turn	Direction	Total Length
Measured Total Depth	True Vertical Depth	BHL From Lease, Unit, or Property Line:	