

Oklahoma Corporation Commission
Oil & Gas Conservation Division
Post Office Box 52000
Oklahoma City, Oklahoma 73152-2000
Rule 165: 10-3-25

Form 1002A

API No.: 35003231870001

Completion Report

Spud Date: April 01, 2015

OTC Prod. Unit No.: 003-218158

Drilling Finished Date: April 16, 2015

Amended

1st Prod Date: November 30, 2016

Amend Reason: SHOW COMPLETION

Completion Date: November 14, 2016

Drill Type: HORIZONTAL HOLE

Min Gas Allowable: Yes

Well Name: RICE TRUST 14-27-12 1H

Purchaser/Measurer: CHESAPEAKE OPERATING LLC

Location: ALFALFA 23 27N 12W
N2 N2 NW NW
185 FNL 660 FWL of 1/4 SEC
Derrick Elevation: 1254 Ground Elevation: 1233

First Sales Date: 11/30/2016

Operator: CHESAPEAKE OPERATING LLC 17441
PO BOX 18496
6100 N WESTERN AVE
OKLAHOMA CITY, OK 73154-0496

Completion Type		Location Exception		Increased Density	
X	Single Zone	Order No		Order No	
	Multiple Zone	636876		636875	
	Commingle				

Casing and Cement							
Type	Size	Weight	Grade	Feet	PSI	SAX	Top of CMT
SURFACE	13 3/8	48	J-55	401		282	SURFACE
INTERMEDIATE	9 5/8	36	J-55	1202		353	SURFACE
PRODUCTION	7	26	P-110EC	5725		298	3778

Liner								
Type	Size	Weight	Grade	Length	PSI	SAX	Top Depth	Bottom Depth
LINER	4 1/2	11.6	P-110EC	5024	0	585	5491	10515

Total Depth: 10515

Packer	
Depth	Brand & Type
5401	AS-3

Plug	
Depth	Plug Type
There are no Plug records to display.	

Initial Test Data

Test Date	Formation	Oil BBL/Day	Oil-Gravity (API)	Gas MCF/Day	Gas-Oil Ratio Cu FT/BBL	Water BBL/Day	Pumpin or Flowing	Initial Shut-In Pressure	Choke Size	Flow Tubing Pressure
Dec 14, 2016	MISSISSIPPIAN	62		305	4919	385	ARTIFICIA			76

Completion and Test Data by Producing Formation

Formation Name: MISSISSIPPIAN

Code: 359MSSP

Class: OIL

Spacing Orders

Order No	Unit Size
594830	640

Perforated Intervals

From	To
5569	10380

Acid Volumes

10,000 GALLONS HCL ACID

Fracture Treatments

43,595 BARRELS FRAC FLUID, 218,360 POUNDS PROPPANT
--

Formation	Top
MISSISSIPPIAN	5429

Were open hole logs run? No

Date last log run:

Were unusual drilling circumstances encountered? No

Explanation:

Other Remarks

OCC - THIS DOCUMENT IS ACCEPTED BASED ON THE DATA SUBMITTED THE FINAL LOCATION EXCEPTION HAS NOT BEEN ISSUED.

Lateral Holes

Sec: 14 TWP: 27N RGE: 12W County: ALFALFA

NW NE NW NW

181 FNL 754 FWL of 1/4 SEC

Depth of Deviation: 5160 Radius of Turn: 221 Direction: 357 Total Length: 5086

Measured Total Depth: 10515 True Vertical Depth: 5381 End Pt. Location From Release, Unit or Property Line: 181

FOR COMMISSION USE ONLY

1135607

Status: Accepted

API NO. 35-003-23187
OTC PROD.
UNIT NO. 003-218158

PLEASE TYPE OR USE BLACK INK ONLY
NOTE: Attach copy of original 1002A if recompletion or reentry.

OKLAHOMA CORPORATION COMMISSION

Oil & Gas Conservation Division

Post Office Box 52000

Oklahoma City, Oklahoma 73152-2000

Rule 165:10-3-25

RECEIVED
1002A
Rev. 12-09

DEC 22 2016

OKLAHOMA CORPORATION
COMMISSION

☐ ORIGINAL
☒ AMENDED

Reason Amended Show Completion

TYPE OF DRILLING OPERATION

☐ STRAIGHT HOLE ☐ DIRECTIONAL HOLE ☒ HORIZONTAL HOLE
SERVICE WELL

If directional or horizontal, see reverse for bottom hole location.

COUNTY	ALFALFA	SEC	23	TWP	27N	RGE	12W
LEASE NAME	RICE TRUST 14-27-12			WELL NO	1H		
SHL	N2 1/4	N2 1/4	NW 1/4	NW 1/4	185	1/4 SEC	660
ELEVATION	Derrick Ft 1,254			Ground	1,233		
OPERATOR NAME	CHESAPEAKE OPERATING, L.L.C.			OTC/OCC OPERATOR NO.	17441		
ADDRESS	P.O. BOX 18496						
CITY	OKLAHOMA CITY			STATE	OK	ZIP	73154

COMPLETION REPORT

SPUD DATE	4/1/2015
DRLG FINISHED DATE	4/16/2015
DATE OF WELL COMPLETION	11/14/2016
1ST PROD DATE	11/30/2016
RECOMP DATE	
Longitude (if Known)	

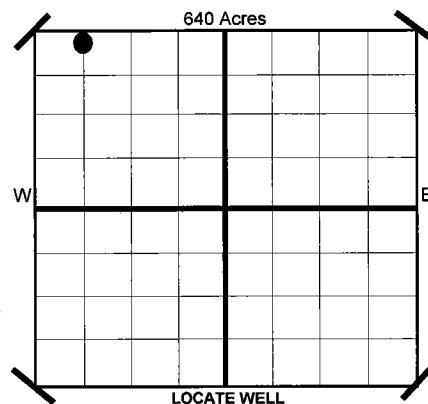

COMPLETION TYPE

<input checked="" type="checkbox"/> SINGLE ZONE	
<input type="checkbox"/> MULTIPLE ZONE	
Application Date	
COMMINGLED	
Application Date	
LOCATION EXCEPTION ORDER NO.	636876 (INTERIM)
INCREASED DENSITY ORDER NO.	636875

CASING & CEMENT (Form 1002C must be attached)

TYPE	SIZE	WEIGHT	GRADE	FEET	PSI	SAX	TOP
CONDUCTOR							
SURFACE	13 3/8"	48#	J-55	401		282	SURFACE
INTERMEDIATE	9 5/8"	36#	J-55	1,202		353	SURFACE
PRODUCTION	7"	26#	P-110EC	5,725		298	3,778
LINER	4 1/2"	11.6#	P-110EC	5,491-10,515		585	5,491
							10,515

PACKER @ 5.401 BRAND & TYPE AS-3 PLUG @ TYPE PLUG @ TYPE
PACKER @ BRAND & TYPE PLUG @ TYPE PLUG @ TYPE

TOTAL DEPTH

COMPLETION & TEST DATA BY PRODUCING FORMATION

FORMATION	Mississippian
SPACING & SPACING	640
ORDER NUMBER	594830
CLASS: Oil, Gas, Dry, Inj. Disp, Comm Disp, Svc	Oil
PERFORATED INTERVALS	5569 - 10,380
ACID/VOLUME	HCL Acid 10,000 Gals Frac Fluid 43,595 Bbls Proppant 218,360 Lbs

Reported to
Frac Focus

Minimum Gas Allowable (165:10-17-7)

Gas Purchaser/Measurer

Chesapeake Operating, L.L.C.

☒

OR

1st Sales Date

11/30/2016

INITIAL TEST DATA

Oil Allowable (165:10-13-3)

INITIAL TEST DATE	12/14/2016
OIL-BBL/DAY	62
OIL-GRAVITY (API)	
GAS-MCF/DAY	305
GAS-OIL RATIO CU FT/BBL	4,919
WATER-BBL/DAY	385
PUMPING OR FLOWING	Artificial Lift
INITIAL SHUT-IN PRESSURE	
CHOKE SIZE	
FLOW TUBING PRESSURE	76

AS SUBMITTED

A record of the formations drilled through, and pertinent remarks are presented on the reverse. I declare that I have knowledge of the contents of this report and am authorized by my organization to make this report, which was prepared by me or under my supervision and direction, with the data and facts stated herein to be true, correct, and complete to the best of my knowledge and belief.

Sara Everett

Sara Everett, Regulatory Analyst

12/20/2016

405-848-8000

SIGNATURE

NAME (PRINT OR TYPE)

DATE

PHONE NUMBER

P.O. BOX 18496

OKLAHOMA CITY

OK

73154

sara.everett@chk.com

ADDRESS

CITY

STATE

ZIP

EMAIL ADDRESS

Give formation names and tops, if available, or descriptions and thickness of formations drilled through. Show intervals cored or drillstem tested.

WELL NO. 1H

NAMES OF FORMATIONS	TOP
MISSISSIPPIAN	5,429

FOR COMMISSION USE ONLY	
ITD on file	<input type="checkbox"/> YES <input type="checkbox"/> NO
APPROVED	DISAPPROVED
2) Reject Codes	

Were open hole logs run?	<u> </u> yes	<u>X</u> no	
Date Last log was run	N/A		
Was CO ₂ encountered?	<u> </u> yes	<u>X</u> no	at what depths?
Was H ₂ S encountered?	<u> </u> yes	<u>X</u> no	at what depths?
Were unusual drilling circumstances encountered?	<u> </u> yes	<u>X</u> no	
If yes, briefly explain.			

Other remarks:

640 Acres

If more than three drainholes are proposed, attach a separate sheet indicating the necessary information.

Direction must be stated in degrees azimuth.
Please note, the horizontal drainhole and its end point must be located within the boundaries of the lease or spacing unit.

Directional surveys are required for all drainholes and directional wells.

SEC	TWP	RGE	COUNTY
Spot Location	1/4	1/4	1/4
Measured Total Depth	True Vertical Depth	BHL From Lease, Unit, or Property Line:	

LATERAL #1										
SEC	14	TWP	27N	RGE	12W	COUNTY				
						ALFALFA				
Spot Location						Feet From 1/4 Sec Lines	FNL	181	FWL	754
NW 1/4		NE 1/4		NW 1/4		NW 1/4				
Depth of Deviation		5,160		Radius of Turn		221		Direction		
						357		Total Length		
								5,086		
Measured Total Depth				True Vertical Depth		BHL From Lease, Unit, or Property Line:				
10,515				5,381		181				

SEC	TWP	RGE	COUNTY				
Spot Location	1/4	1/4	1/4	1/4	Feet From 1/4 Sec Lines	FSL	FWL
Depth of Deviation	Radius of Turn			Direction	Total Length		
Measured Total Depth	True Vertical Depth			BHL From Lease, Unit, or Property Line:			

SEC	TWP	RGE	COUNTY			
Spot Location						
1/4	1/4	1/4	1/4	Feet From 1/4 Sec Lines	FSL	FWL
Depth of Deviation		Radius of Turn		Direction	Total Length	
Measured Total Depth		True Vertical Depth		BHL From Lease, Unit, or Property Line:		

6709 NORTH CLASSEN BLVD., OKLA. CITY, OKLA. 73116 * LOCAL (405) 843-4847 * OUT OF STATE (800) 654-3219

Certificate of Authorization No. 1293 LS.

ALFA

County, Oklahoma

185'FNL-660'FWL Section 23 Township 27N Range 12W J.M.

