

Oklahoma Corporation Commission  
Oil & Gas Conservation Division  
Post Office Box 52000  
Oklahoma City, Oklahoma 73152-2000  
Rule 165: 10-3-25

Form 1002A

API No.: 35087216230001

**Completion Report**

Spud Date: March 28, 1998

OTC Prod. Unit No.: 087-102061

Drilling Finished Date: May 04, 1998

**Amended**

1st Prod Date: June 23, 1998

Amend Reason: CONVERT TO NON-COMMERCIAL DISPOSAL

Completion Date: May 23, 1998

Recomplete Date: November 08, 2016

**Drill Type: DIRECTIONAL HOLE**

**SERVICE WELL**

Well Name: MYRNA CHANDLER 2-1

Purchaser/Measurer:

Location: MCCLAIN 1 6N 2W  
SE NW SE SE  
815 FSL 1951 FWL of 1/4 SEC  
Derrick Elevation: 1046 Ground Elevation: 1030

First Sales Date:

Operator: RJA ENERGY LLC 23212

1708 TOPEKA ST  
NORMAN, OK 73069-8224

| Completion Type |               | Location Exception                                  |  | Increased Density                                  |  |
|-----------------|---------------|---|--|--|--|
| X               | Single Zone   | Order No  |  | Order No   |  |
|                 | Multiple Zone | There are no Location Exception records to display. |  | There are no Increased Density records to display. |  |
|                 | Commingled    |   |  |  |  |

| Casing and Cement |       |        |       |      |     |     |            |
|-------------------|-------|--------|-------|------|-----|-----|------------|
| Type              | Size  | Weight | Grade | Feet | PSI | SAX | Top of CMT |
| CONDUCTOR         | 16    | 44     | H-40  | 60   |     | 122 | SURFACE    |
| SURFACE           | 9.625 | 36     | J-55  | 1037 | 200 | 415 | SURFACE    |
| PRODUCTION        | 5.500 | 17     | N-80  | 9102 | 500 | 200 | 8150       |

| Liner                                  |      |        |       |        |     |     |           |              |
|--|------|--------|-------|--------|-----|-----|-----------|--------------|
| Type                                   | Size | Weight | Grade | Length | PSI | SAX | Top Depth | Bottom Depth |
| There are no Liner records to display. |      |        |       |        |     |     |           |              |

**Total Depth: 9102**

| Packer |                 |
|--------|-----------------|
| Depth  | Brand & Type    |
| 8596   | BAKER MODEL "R" |

| Plug                                  |           |
|---------------------------------------|-----------|
| Depth                                 | Plug Type |
| There are no Plug records to display. |           |

| Initial Test Data |
|-------------------|
|-------------------|

|   |           |             |                   |  |                         |               |                   |                          |            |                      |
|---|-----------|-------------|-------------------|--|-------------------------|---------------|-------------------|--------------------------|------------|----------------------|
| Test Date                                       | Formation | Oil BBL/Day | Oil-Gravity (API) | Gas MCF/Day  | Gas-Oil Ratio Cu FT/BBL | Water BBL/Day | Pumpin or Flowing | Initial Shut-In Pressure | Choke Size | Flow Tubing Pressure |
| There are no Initial Data records to display.   |           |             |                   |  |                         |               |                   |                          |            |                      |
| Completion and Test Data by Producing Formation |           |             |                   |  |                         |               |                   |                          |            |                      |
| Formation Name: BROMIDECode: 202BRMDClass: DISP |           |             |                   |  |                         |               |                   |                          |            |                      |
| Spacing Orders                                  |           |             |                   | Perforated Intervals                                 |                         |               |                   |                          |            |                      |
| Order No  |           | Unit Size   |                   | From   |                         |               | To                |                          |            |                      |
| There are no Spacing Order records to display.  |           |             |                   | 8644   |                         |               | 8903              |                          |            |                      |
| Acid Volumes                                    |           |             |                   | Fracture Treatments                                  |                         |               |                   |                          |            |                      |
| 2,000 GALLONS 15% MUD ACID                      |           |             |                   | There are no Fracture Treatments records to display. |                         |               |                   |                          |            |                      |

|              |      |  |
|--------------|------|--|
| Formation    | Top  | Were open hole logs run? Yes<br>Date last log run: May 15, 1998<br><br>Were unusual drilling circumstances encountered? No<br>Explanation: |
| OSAGE LAYTON | 5800 |  |
| HOGSHOOTER   | 6170 |  |
| CHECKERBOARD | 6635 |  |
| DEESE        | 6945 |  |
| HUNTON       | 7825 |  |
| VIOLA        | 8173 |  |
| BROMIDE      | 8620 |  |
| TULIP CREEK  | 9040 |  |

Other Remarks  
ORIGINAL OPERATOR PERFORATED 8,676' - 8,680' AND CEMENTED OFF INTERVAL. ORIGINAL OPERATOR PERFORATED 8,644' - 8,658' AND INTERVAL WATERED OUT. UIC PERMIT NUMBER 1701590043. USED 2 3/8" SEAL TITE TUBING.

Bottom Holes  
Sec: 1 TWP: 6N RGE: 2W County: MCCLAIN  
SE NE NW SW  
2055 FSL 1288 FWL of 1/4 SEC  
Depth of Deviation: 0 Radius of Turn: 0 Direction: 0 Total Length: 0  
Measured Total Depth: 9102 True Vertical Depth: 8169 End Pt. Location From Release, Unit or Property Line: 585

FOR COMMISSION USE ONLY

Status: Accepted1135603

API NO. 087-21623  
OTC PROD. UNIT NO. 087-102061

PLEASE TYPE OR USE BLACK INK ONLY  
NOTE:

Attach copy of original 1002A  
if recompletion or reentry.

OKLAHOMA CORPORATION COMMISSION  
Oil & Gas Conservation Division  
Post Office Box 52000  
Oklahoma City, Oklahoma 73152-2000  
Rule 165:10-3-25

RECEIVED

DEC 02 2016

Form 1002A  
Rev. 2009

☐ ORIGINAL  
☒ AMENDED (Reason) CONVERT TO NON COMMERCIAL DISPOSAL

COMPLETION REPORT

TYPE OF DRILLING OPERATION  
☐ STRAIGHT HOLE ☒ DIRECTIONAL HOLE ☐ HORIZONTAL HOLE  
☒ SERVICE WELL  
If directional or horizontal, see reverse for bottom hole location.

|                             |                    |                      |                |                    |             |                         |         |               |         |
|-----------------------------|--------------------|----------------------|----------------|--------------------|-------------|-------------------------|---------|---------------|---------|
| COUNTY                      | McCLAIN            | SEC                  | 1              | TWP                | 6N          | RGE                     | 2W      | SPUD DATE     | 3-28-98 |
| LEASE NAME                  | MYRNA CHANDLER     | WELL NO.             | 2-1            | DRLG FINISHED DATE | 5-4-98      | DATE OF WELL COMPLETION | 5-23-98 | 1st PROD DATE | 6-23-98 |
| SE 1/4 NW 1/4 SE 1/4 SE 1/4 | FSL OF 1/4 SEC     | 815'                 | FWL OF 1/4 SEC | 1,951'             | RECOMP DATE | 11-8-2016               |         |               |         |
| ELEVATION                   | 1046' Ground 1030' | Latitude (if known)  |                |                    |             | Longitude (if known)    |         |               |         |
| OPERATOR NAME               | RJA ENERGY, LLC    | OTC/OCC OPERATOR NO. | 23212          |                    |             |                         |         |               |         |
| ADDRESS                     | 1708 TOPEKA DRIVE  |                      |                |                    |             |                         |         |               |         |
| CITY                        | NORMAN             | STATE                | OK             | ZIP                | 73069       |                         |         |               |         |

640 Acres

|  |  |  |  |  |  |  |  |  |  |
|--|--|--|--|--|--|--|--|--|--|
|  |  |  |  |  |  |  |  |  |  |
|  |  |  |  |  |  |  |  |  |  |
|  |  |  |  |  |  |  |  |  |  |
|  |  |  |  |  |  |  |  |  |  |
|  |  |  |  |  |  |  |  |  |  |
|  |  |  |  |  |  |  |  |  |  |
|  |  |  |  |  |  |  |  |  |  |
|  |  |  |  |  |  |  |  |  |  |
|  |  |  |  |  |  |  |  |  |  |
|  |  |  |  |  |  |  |  |  |  |

LOCATE WELL

COMPLETION TYPE

|   |
|---|
| <input checked="" type="checkbox"/> SINGLE ZONE |
| <input type="checkbox"/> MULTIPLE ZONE          |
| Application Date                                |
| <input type="checkbox"/> COMINGLED              |
| Application Date                                |
| LOCATION  |
| EXCEPTION ORDER                                 |
| INCREASED DENSITY                               |
| ORDER NO.                                       |

CASING & CEMENT (Form 1002C must be attached)

| TYPE         | SIZE   | WEIGHT | GRADE | FEET   | PSI | SAX | TOP OF CMT |
|--------------|--------|--------|-------|--------|-----|-----|------------|
| CONDUCTOR    | 16"    | 44     | H-40  | 60'    |     | 122 | SURFACE    |
| SURFACE      | 9.625" | 36     | J-55  | 1,037' | 200 | 415 | SURFACE    |
| INTERMEDIATE | 5.500" | 17     | N-80  | 9,102' | 500 | 200 | 8,150'     |
| PRODUCTION   |        |        |       |        |     |     |            |
| LINER        |        |        |       |        |     |     |            |

PACKER @ 8,596' BRAND & TYPE BKR MOD "R" PLUG @ TYPE PLUG @ TYPE TOTAL DEPTH 9,102'

COMPLETION & TEST DATA BY PRODUCING FORMATION 202 BRIND

|   |                      |              |  |  |  |         |
|---|----------------------|--------------|--|--|--|---------|
| FORMATION                                       | BROMIDE              |              |  |  |  | No Frac |
| SPACING & SPACING ORDER NUMBER                  | NA                   |              |  |  |  |         |
| CLASS: Oil, Gas, Dry, Inj, Disp, Comm Disp, Svc | DISPOSAL             |              |  |  |  |         |
| PERFORATED INTERVALS                            | 8,644'-58'           | 8,842'-59'   |  |  |  |         |
|   | 8,676'-80'           | 8,894'-8903' |  |  |  |         |
|   | 8,705'-19'           |              |  |  |  |         |
| ACID/VOLUME                                     | 2000 GAL 15% MUDACID |              |  |  |  |         |
| FRACTURE TREATMENT (Fluids/Prop Amounts)        |                      |              |  |  |  |         |

Min Gas Allowable (165:10-17-7) Gas Purchaser/Measurer  
OR  
Oil Allowable (165:10-13-3) First Sales Date

INITIAL TEST DATA

|                          |           |  |  |  |  |
|--------------------------|-----------|--|--|--|--|
| INITIAL TEST DATE        | 11-8-2016 |  |  |  |  |
| OIL-BBL/DAY              |           |  |  |  |  |
| OIL-GRAVITY (API)        |           |  |  |  |  |
| GAS-MCF/DAY              |           |  |  |  |  |
| GAS-OIL RATIO CU FT/BBL  |           |  |  |  |  |
| WATER-BBL/DAY            |           |  |  |  |  |
| PUMPING OR FLOWING       |           |  |  |  |  |
| INITIAL SHUT-IN PRESSURE |           |  |  |  |  |
| CHOKE SIZE               |           |  |  |  |  |
| FLOW TUBING PRESSURE     |           |  |  |  |  |

AS SUBMITTED

A record of the formations drilled through, and pertinent remarks are presented on the reverse. I declare that I have knowledge of the contents of this report and am authorized by my organization to make this report, which was prepared by me or under my supervision and direction, with the data and facts stated herein to be true, correct, and complete to the best of my knowledge and belief.

D. N. S. SIGNATURE O. N. GOODE, JR. NAME (PRINT OR TYPE) 11-14-2016 DATE 405-642-3131 PHONE NUMBER  
1218 RANCHO SERENA DRIVE ADDRESS KELLER CITY TX STATE 76248 ZIP messick.gemallies@gmail.com EMAIL ADDRESS

PLEASE TYPE OR USE BLACK INK ONLY

FORMATION RECORD

Give formation names and tops, if available, or descriptions and thickness of formations drilled through. Show intervals cored or drillstem tested.

LEASE NAME MYRNA CHANDLER

WELL NO. 2-1

| NAMES OF FORMATIONS | TOP           |
|---------------------|---------------|
| OSAGE LAYTON        | 5800'-50'     |
| HOGSHOOTER          | 6,170'-6220'  |
| CHECKERBOARD        | 6,635'-48'    |
| DEESE               | 6,945'-7,010' |
| HUNTON              | 7,825'-8,052' |
| VIOLA               | 8,173'-8,483' |
| BROMIDE             | 8,620'-9,003' |
| TULIP CREEK         | 9,040'-TD     |
| TOTAL DEPTH         | 9,102'        |

FOR COMMISSION USE ONLY

ITD on file ☐ YES ☐ NO

APPROVED \_\_\_\_\_ DISAPPROVED \_\_\_\_\_

2) Reject Codes \_\_\_\_\_

Were open hole logs run? ☒ yes ☐ no

Date Last log was run 5-15-98

Was CO<sub>2</sub> encountered? ☐ yes ☒ no at what depths? \_\_\_\_\_

Was H<sub>2</sub>S encountered? ☐ yes ☒ no at what depths? \_\_\_\_\_

Were unusual drilling circumstances encountered? ☐ yes ☒ no

If yes, briefly explain below \_\_\_\_\_

Other remarks: ORIGINAL OPERATOR PERFORATED 8,676'-80' & CEMENTED OFF INTERVAL. ORIGINAL OPERATOR PERFORATED 8,644'-58' & INTERVAL WATERED OUT. UIC PERMIT NO. 1701590043 USED 2 3/8" SEAL TITE TUBING

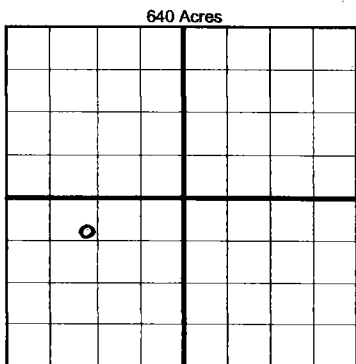

If more than three drainholes are proposed, attach a separate sheet indicating the necessary information.

Direction must be stated in degrees azimuth. Please note, the horizontal drainhole and its end point must be located within the boundaries of the lease or spacing unit.

Directional surveys are required for all drainholes and directional wells.

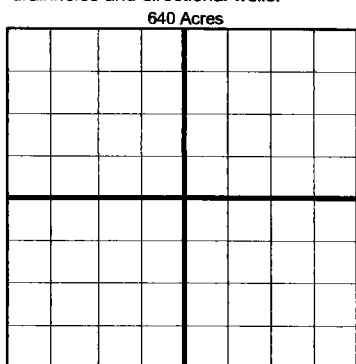

BOTTOM HOLE LOCATION FOR DIRECTIONAL HOLE

|   |                            |  |                |
|---|----------------------------|--|----------------|
| SEC 1                                     | TWP 6N                     | RGE 2W                                       | COUNTY McCLAIN |
| Spot Location SE 1/4 NE 1/4 NW 1/4 SW 1/4 | Feet From 1/4 Sec Lines    | FSL 2,055                                    | FWL 1,288      |
| Measured Total Depth 9,102'               | True Vertical Depth 8,169' | BHL From Lease, Unit, or Property Line: 585' |                |

BOTTOM HOLE LOCATION FOR HORIZONTAL HOLE: (LATERALS)

|                               |                         |   |              |
|-------------------------------|-------------------------|---|--------------|
| LATERAL #1                    |                         |   |              |
| SEC                           | TWP                     | RGE                                     | COUNTY       |
| Spot Location 1/4 1/4 1/4 1/4 | Feet From 1/4 Sec Lines | FSL                                     | FWL          |
| Depth of Deviation            | Radius of Turn          | Direction                               | Total Length |
| Measured Total Depth          | True Vertical Depth     | BHL From Lease, Unit, or Property Line: |              |

|                               |                         |   |              |
|-------------------------------|-------------------------|---|--------------|
| LATERAL #2                    |                         |   |              |
| SEC                           | TWP                     | RGE                                     | COUNTY       |
| Spot Location 1/4 1/4 1/4 1/4 | Feet From 1/4 Sec Lines | FSL                                     | FWL          |
| Depth of Deviation            | Radius of Turn          | Direction                               | Total Length |
| Measured Total Depth          | True Vertical Depth     | BHL From Lease, Unit, or Property Line: |              |

|                               |                         |   |              |
|-------------------------------|-------------------------|---|--------------|
| LATERAL #3                    |                         |   |              |
| SEC                           | TWP                     | RGE                                     | COUNTY       |
| Spot Location 1/4 1/4 1/4 1/4 | Feet From 1/4 Sec Lines | FSL                                     | FWL          |
| Depth of Deviation            | Radius of Turn          | Direction                               | Total Length |
| Measured Total Depth          | True Vertical Depth     | BHL From Lease, Unit, or Property Line: |              |