

Oklahoma Corporation Commission  
Oil & Gas Conservation Division  
Post Office Box 52000  
Oklahoma City, Oklahoma 73152-2000  
Rule 165: 10-3-25

Form 1002A

API No.: 35003210200002

**Completion Report**

Spud Date: April 16, 1983

OTC Prod. Unit No.: 003-81409

Drilling Finished Date: April 28, 1983

**Amended**

Amend Reason: RETURN TO PRODUCING

1st Prod Date: August 01, 1983

Completion Date: August 01, 1983

Recomplete Date: December 26, 2016

**Drill Type: STRAIGHT HOLE**

Well Name: DIEL 1

Purchaser/Measurer:

Location: ALFALFA 20 27N 11W  
C N2 N2 SW  
2310 FSL 1320 FWL of 1/4 SEC  
Derrick Elevation: 0 Ground Elevation: 0

First Sales Date:

Operator: NEILSON INC 21475

25463 COUNTY ROAD 800  
NASH, OK 73761-5026

Completion Type	
X	Single Zone
	Multiple Zone
	Commingled

Location Exception	
Order No	
There are no Location Exception records to display.	

Increased Density	
Order No	
There are no Increased Density records to display.	

Casing and Cement							
Type	Size	Weight	Grade	Feet	PSI	SAX	Top of CMT
SURFACE	8 5/8	24	K-55	1032		600	SURFACE
PRODUCTION	4 1/2	10.5	K-55	5450		400	

Liner								
Type	Size	Weight	Grade	Length	PSI	SAX	Top Depth	Bottom Depth
There are no Liner records to display.								

**Total Depth: 5450**

Packer	
Depth	Brand & Type
5422	OTIS PERMA LATCH

Plug	
Depth	Plug Type
There are no Plug records to display.	

Initial Test Data										
Test Date	Formation	Oil BBL/Day	Oil-Gravity (API)	Gas MCF/Day	Gas-Oil Ratio Cu FT/BBL	Water BBL/Day	Pumpin or Flowing	Initial Shut-In Pressure	Choke Size	Flow Tubing Pressure
Dec 26, 2016	MISSISSIPPI LIME	5		31		55	PUMPING	1000		

**Completion and Test Data by Producing Formation**

Formation Name: MISSISSIPPI LIME

Code: 351MSSLM

Class: OIL

**Spacing Orders**

Order No	Unit Size
140432	640

**Perforated Intervals**

From	To
5312	5400

**Acid Volumes**

There are no Acid Volume records to display.

**Fracture Treatments**

There are no Fracture Treatments records to display.

Formation	Top
WOLFCAMP	1893
LOVELL	3957
TONKAWA	4308
LAYTON	4687
OSWEGO	4910
CHEROKEE	5097
RED FORK	5242
MISSISSIPPI CHAT	5288
MISSISSIPPI LIME	5305

Were open hole logs run? No

Date last log run:

Were unusual drilling circumstances encountered? No

Explanation:

**Other Remarks**

There are no Other Remarks.

**FOR COMMISSION USE ONLY**

1135563

Status: Accepted

RECEIVED

DEC 23 2016

Form 1002A  
Rev. 2009

OKLAHOMA CORPORATION COMMISSION

API NO. 00321020  
OTC PROD.  
UNIT NO. 002-2469

PLEASE TYPE OR USE BLACK INK ONLY  
NOTE:

Attach copy of original 1002A  
if recompletion or reentry.

OKLAHOMA CORPORATION COMMISSION  
Oil & Gas Conservation Division  
Post Office Box 52000  
Oklahoma City, Oklahoma 73152-2000  
Rule 165-10-3-25

ORIGINAL  
 AMENDED (Reason: *to Producing*)

COMPLETION REPORT

TYPE OF DRILLING OPERATION

STRAIGHT HOLE  DIRECTIONAL HOLE  HORIZONTAL HOLE  
 SERVICE WELL

If directional or horizontal, see reverse for bottom hole location.

COUNTY *Alfalfa* SEC *20* TWP *27N* RGE *11W*  
LEASE NAME *Dick* WELL NO. *#1*  
C *1/4* N *22-1/4* E *1/4* SW *1/4* FSL OF 1/4 SEC *230* FWL OF 1/4 SEC *120*  
ELEVATIO N Derrick: Ground Latitude (if known) Longitude (if known)  
OPERATOR NAME *Neilson Inc* OTC/OOC OPERATOR NO. *21475*  
ADDRESS *25463 County Road 800*  
CITY *Nash* STATE *OK* ZIP *73761*

*Per original*

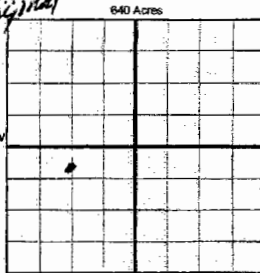

LOCATE WELL

COMPLETION TYPE

SINGLE ZONE  
 MULTIPLE ZONE  
 COMINGLED  
LOCATION  
EXCEPTION ORDER  
INCREASED DENSITY  
ORDER NO.

CASING & CEMENT (Form 1002C must be attached)

TYPE	SIZE	WEIGHT	GRADE	FEET	PSI	SAX	TOP OF CMT
CONDUCTOR							
SURFACE	<i>8 5/8</i>	<i>24</i>	<i>K-55</i>	<i>1032</i>		<i>600 surface</i>	
INTERMEDIATE							
PRODUCTION	<i>4 1/2</i>	<i>10.5</i>	<i>K-55</i>	<i>5450</i>		<i>400</i>	
LINER							

PACKER @ *5422* BRAND & TYPE *Chlor Armo* PLUG @ TYPE PLUG @ TYPE TOTAL DEPTH *5450*

COMPLETION & TEST DATA BY PRODUCING FORMATION

*351M55LM*

FORMATION	SPACING & SPACING ORDER NUMBER	CLASS: Oil, Gas, Dry, Inj, Disp, Comm Disp, Svc	PERFORATED INTERVALS	ACID/VOLUME	FRACTURE TREATMENT (Fluids/Prop Amounts)
<i>M-55 - Lime</i>	<i>140422 / 640</i>	<i>Oil</i>	<i>5312 - 5400</i>		
<i>M-55 - Lime</i>	<i>140472 / 640</i>	<i>Oil</i>	<i>5312 - 5400</i>		

Min Gas Allowable (165:10-17-7) OR Oil Allowable (165:10-13-3) Gas Purchaser/Measurer First Sales Date

INITIAL TEST DATA

INITIAL TEST DATE	<i>8-1-83</i>	<i>12-26-16</i>
OIL-BBL/DAY	<i>20</i>	<i>5</i>
OIL-GRAVITY (API)		
GAS-MCF/DAY	<i>400</i>	<i>31</i>
GAS-OIL RATIO CU FT/BBL	<i>20,000</i>	
WATER-BBL/DAY	<i>10</i>	<i>55</i>
PUMPING OR FLOWING	<i>Flowing</i>	<i>Pumping</i>
INITIAL SHUT-IN PRESSURE		<i>1000</i>
CHOKE SIZE	<i>2 1/2</i>	<i>0</i>
FLOW TUBING PRESSURE	<i>1400</i>	

**AS SUBMITTED**

A record of the formations drilled through, and pertinent remarks are presented on the reverse. I declare that I have knowledge of the contents of this report and am authorized by my organization to make this report which was prepared by me or under my supervision and direction, with the data and facts stated herein to be true, correct, and complete to the best of my knowledge and belief.

SIGNATURE *Justin Neilson* NAME (PRINT OR TYPE) *Justin Neilson* DATE *12-22-16* PHONE NUMBER *580-554-7902*  
ADDRESS *25463 County Road 800* CITY *Nash* STATE *OK* ZIP *73761* EMAIL ADDRESS *jneilson@hotmail.com*

PLEASE TYPE OR USE BLACK INK ONLY  
FORMATION RECORD

Give formation names and tops, if available, or descriptions and thickness of formations drilled through. Show intervals cored or drillstem tested.

LEASE NAME Diel

WELL NO. 1

NAMES OF FORMATIONS	TOP
Wolfcamp	1893
Love II	3957
	4308
Tonkawa	4687
Layton	4910
Oswego	5097
Cherokee	5242
Red Fork	5288
Miss. Chat	
Miss. Lime	5305

FOR COMMISSION USE ONLY

ITD on file  YES  NO

APPROVED \_\_\_\_\_ DISAPPROVED \_\_\_\_\_ 2) Reject Codes \_\_\_\_\_

\_\_\_\_\_

\_\_\_\_\_

\_\_\_\_\_

Were open hole logs run? \_\_\_\_\_ yes \_\_\_\_\_ no

Date last log was run \_\_\_\_\_

Was CO<sub>2</sub> encountered? \_\_\_\_\_ yes \_\_\_\_\_ no at what depths? \_\_\_\_\_

Was H<sub>2</sub>S encountered? \_\_\_\_\_ yes \_\_\_\_\_ no at what depths? \_\_\_\_\_

Were unusual drilling circumstances encountered? \_\_\_\_\_ yes \_\_\_\_\_ no  
If yes, briefly explain below \_\_\_\_\_

Other remarks:

\_\_\_\_\_

\_\_\_\_\_

\_\_\_\_\_

\_\_\_\_\_

640 Acres

If more than three drainholes are proposed, attach a separate sheet indicating the necessary information.

Direction must be stated in degrees azimuth. Please note, the horizontal drainhole and its end point must be located within the boundaries of the lease or spacing unit.

Directional surveys are required for all drainholes and directional wells.

640 Acres

BOTTOM HOLE LOCATION FOR DIRECTIONAL HOLE

SEC	TWP	RGE	COUNTY				
Spot Location	1/4	1/4	1/4	1/4	Feet From 1/4 Sec Lines	FSL	FWL
Measured Total Depth	True Vertical Depth		BHL From Lease, Unit, or Property Line:				

BOTTOM HOLE LOCATION FOR HORIZONTAL HOLE: (LATERALS)

LATERAL #1

SEC	TWP	RGE	COUNTY				
Spot Location	1/4	1/4	1/4	1/4	Feet From 1/4 Sec Lines	FSL	FWL
Depth of Deviation	Radius of Turn		Direction		Total Length		
Measured Total Depth	True Vertical Depth		BHL From Lease, Unit, or Property Line:				

LATERAL #2

SEC	TWP	RGE	COUNTY				
Spot Location	1/4	1/4	1/4	1/4	Feet From 1/4 Sec Lines	FSL	FWL
Depth of Deviation	Radius of Turn		Direction		Total Length		
Measured Total Depth	True Vertical Depth		BHL From Lease, Unit, or Property Line:				

LATERAL #3

SEC	TWP	RGE	COUNTY				
Spot Location	1/4	1/4	1/4	1/4	Feet From 1/4 Sec Lines	FSL	FWL
Depth of Deviation	Radius of Turn		Direction		Total Length		
Measured Total Depth	True Vertical Depth		BHL From Lease, Unit, or Property Line:				