

Oklahoma Corporation Commission
Oil & Gas Conservation Division
Post Office Box 52000
Oklahoma City, Oklahoma 73152-2000
Rule 165: 10-3-25

Form 1002A

API No.: 35019262290000

Completion Report

Spud Date: September 20, 2016

OTC Prod. Unit No.: 019-028650

Drilling Finished Date: September 21, 2016

1st Prod Date:

Completion Date: October 26, 2016

Drill Type: STRAIGHT HOLE

SERVICE WELL

Well Name: OIL CITY UNIT 43

Purchaser/Measurer:

Location: CARTER 27 3S 2W
NW SW SW SE
495 FSL 165 FWL of 1/4 SEC
Derrick Elevation: 967 Ground Elevation: 960

First Sales Date:

Operator: KODIAK OIL & GAS INC 23226

204 N WALNUT ST
MUNSTER, TX 76252-2766

Completion Type	
X	Single Zone
	Multiple Zone
	Commingled

Location Exception
Order No
There are no Location Exception records to display.

Increased Density
Order No
There are no Increased Density records to display.

Casing and Cement							
Type	Size	Weight	Grade	Feet	PSI	SAX	Top of CMT
PRODUCTION	4 1/2	11.6	NEW	1449		300	SURFACE

Liner								
Type	Size	Weight	Grade	Length	PSI	SAX	Top Depth	Bottom Depth
There are no Liner records to display.								

Total Depth: 1500

Packer	
Depth	Brand & Type
950	ARROW TENSION

Plug	
Depth	Plug Type
There are no Plug records to display.	

Initial Test Data										
Test Date	Formation	Oil BBL/Day	Oil-Gravity (API)	Gas MCF/Day	Gas-Oil Ratio Cu FT/BBL	Water BBL/Day	Pumpin or Flowing	Initial Shut-In Pressure	Choke Size	Flow Tubing Pressure
There are no Initial Data records to display.										

Completion and Test Data by Producing Formation

Formation Name: PONTOTOC

Code: 419PNTC

Class: INJ

Spacing Orders

Order No	Unit Size
There are no Spacing Order records to display.	

Perforated Intervals

From	To
970	1440

Acid Volumes

There are no Acid Volume records to display.
--

Fracture Treatments

There are no Fracture Treatments records to display.
--

Formation	Top
PONTOTOC	673

Were open hole logs run? Yes

Date last log run: September 21, 2016

Were unusual drilling circumstances encountered? No

Explanation:

Other Remarks

PERMIT NUMBER 1703090034

FOR COMMISSION USE ONLY

Status: Accepted

1135574

RECEIVED

Form 1002A Rev. 2009

OCT 31 2016

OKLAHOMA CORPORATION COMMISSION

API NO. 019-26229
OTC PROD. UNIT NO. 019-028650

PLEASE TYPE OR USE BLACK INK ONLY
NOTE:

Attach copy of original 1002A if recompletion or reentry.

OKLAHOMA CORPORATION COMMISSION
Oil & Gas Conservation Division
Post Office Box 52000
Oklahoma City, Oklahoma 73152-2000
Rule 165:10-3-25

COMPLETION REPORT

ORIGINAL
AMENDED (Reason)

TYPE OF DRILLING OPERATION

STRAIGHT HOLE
DIRECTIONAL HOLE
HORIZONTAL HOLE
SERVICE WELL

If directional or horizontal, see reverse for bottom hole location.

Form with fields: COUNTY CARTER, SEC 27, TWP 3S, RGE 2W, LEASE NAME OIL CITY UNIT, WELL NO. 43, DATE OF WELL COMPLETION 10-26-2016, OPERATOR NAME Kodiak Oil & Gas, Inc., ADDRESS 204 N. Walnut St, CITY Muenster, STATE TX, ZIP 76252

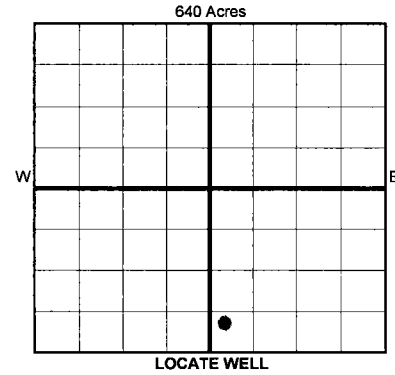

COMPLETION TYPE

Form with fields: SINGLE ZONE, MULTIPLE ZONE, COMMINGLED, LOCATION, EXCEPTION ORDER, INCREASED DENSITY, ORDER NO.

CASING & CEMENT (Form 1002C must be attached)

Table with columns: TYPE, SIZE, WEIGHT, GRADE, FEET, PSI, SAX, TOP OF CMT. Includes rows for CONDUCTOR, SURFACE, INTERMEDIATE, PRODUCTION, LINER.

PACKER @ 950 BRAND & TYPE Arrow Tensior PLUG @ TYPE PLUG @ TYPE TOTAL DEPTH 1,500

COMPLETION & TEST DATA BY PRODUCING FORMATION

419 PNTC

Table with columns: FORMATION, SPACING & SPACING ORDER NUMBER, CLASS, PERFORATED INTERVALS, ACID/VOLUME, FRACTURE TREATMENT. Includes handwritten notes like 'PONTOTOC', 'UNSPACED', 'INJ. (Enh Recovery)', '970-1480 1440 per John Laws'.

Min Gas Allowable (165:10-17-7) OR Gas Purchaser/Measurer First Sales Date
Oil Allowable (165:10-13-3)

INITIAL TEST DATA

Table with columns: INITIAL TEST DATE, OIL-BBL/DAY, OIL-GRAVITY (API), GAS-MCF/DAY, GAS-OIL RATIO CU FT/BBL, WATER-BBL/DAY, PUMPING OR FLOWING, INITIAL SHUT-IN PRESSURE, CHOKE SIZE, FLOW TUBING PRESSURE

AS SUBMITTED

A record of the formations drilled through, and pertinent remarks are presented on the reverse. I declare that I have knowledge of the contents of this report and am authorized by my organization to make this report, which was prepared by me or under my supervision and direction, with the data and facts stated herein to be true, correct, and complete to the best of my knowledge and belief.
Mel Walterscheid
204 N Walnut Muenster TX 76252
10/24/2016 940-759-4001
wfw@ntin.net

PLEASE TYPE OR USE BLACK INK ONLY
FORMATION RECORD

Give formation names and tops, if available, or descriptions and thickness of formations drilled through. Show intervals cored or drillstem tested.

LEASE NAME OIL CITY UNIT WELL NO. 43

NAMES OF FORMATIONS	TOP
PONTOTOC	673

FOR COMMISSION USE ONLY

ITD on file YES NO

APPROVED _____ DISAPPROVED _____ 2) Reject Codes _____

Were open hole logs run? yes no

Date Last log was run 9/21/2016

Was CO₂ encountered? yes no at what depths? _____

Was H₂S encountered? yes no at what depths? _____

Were unusual drilling circumstances encountered? yes no
If yes, briefly explain below

Other remarks: Permit 1703090034

640 Acres

If more than three drainholes are proposed, attach a separate sheet indicating the necessary information.

Direction must be stated in degrees azimuth.
Please note, the horizontal drainhole and its end point must be located within the boundaries of the lease or spacing unit.

Directional surveys are required for all drainholes and directional wells.

640 Acres

BOTTOM HOLE LOCATION FOR DIRECTIONAL HOLE

SEC	TWP	RGE	COUNTY							
Spot Location				1/4	1/4	1/4	1/4	Feet From 1/4 Sec Lines	FSL	FWL
Measured Total Depth				True Vertical Depth		BHL From Lease, Unit, or Property Line:				

BOTTOM HOLE LOCATION FOR HORIZONTAL HOLE: (LATERALS)

LATERAL #1

SEC	TWP	RGE	COUNTY							
Spot Location				1/4	1/4	1/4	1/4	Feet From 1/4 Sec Lines	FSL	FWL
Depth of Deviation				Radius of Turn		Direction		Total Length		
Measured Total Depth				True Vertical Depth		BHL From Lease, Unit, or Property Line:				

LATERAL #2

SEC	TWP	RGE	COUNTY							
Spot Location				1/4	1/4	1/4	1/4	Feet From 1/4 Sec Lines	FSL	FWL
Depth of Deviation				Radius of Turn		Direction		Total Length		
Measured Total Depth				True Vertical Depth		BHL From Lease, Unit, or Property Line:				

LATERAL #3

SEC	TWP	RGE	COUNTY							
Spot Location				1/4	1/4	1/4	1/4	Feet From 1/4 Sec Lines	FSL	FWL
Depth of Deviation				Radius of Turn		Direction		Total Length		
Measured Total Depth				True Vertical Depth		BHL From Lease, Unit, or Property Line:				