

Oklahoma Corporation Commission
Oil & Gas Conservation Division
Post Office Box 52000
Oklahoma City, Oklahoma 73152-2000
Rule 165: 10-3-25

Form 1002A

API No.: 35119215220003

Completion Report

Spud Date: February 12, 1981

OTC Prod. Unit No.:

Drilling Finished Date: February 28, 1981

1st Prod Date:

Amended

Completion Date: December 07, 1981

Amend Reason: ACQUIRED WELL. REPAIRED PRODUCTION CASING AND ADDED CONDUCTOR AND SURFACE CASING

Recomplete Date: August 01, 2016

Drill Type: STRAIGHT HOLE

Well Name: GROVER (WESTFALL 1) 1

Purchaser/Measurer:

Location: PAYNE 15 17N 3E
C NE SE NW
990 FSL 2310 FWL of 1/4 SEC
Latitude: 35.952156 Longitude: -96.97295
Derrick Elevation: 862 Ground Elevation: 858

First Sales Date:

Operator: LAKESHORE OPERATING LLC 23797

23 1/2 E MADISON AVE STE A
IOLA, KS 66749-3329

Completion Type	
X	Single Zone
	Multiple Zone
	Commingled

Location Exception	
Order No	
There are no Location Exception records to display.	

Increased Density	
Order No	
There are no Increased Density records to display.	

Casing and Cement							
Type	Size	Weight	Grade	Feet	PSI	SAX	Top of CMT
CONDUCTOR	16	75	K-55	12			
SURFACE	7	23	K-55	90		45	SURFACE
PRODUCTION	4 1/2	9.5		4390		350	SURFACE

Liner								
Type	Size	Weight	Grade	Length	PSI	SAX	Top Depth	Bottom Depth
There are no Liner records to display.								

Total Depth: 4400

Packer	
Depth	Brand & Type
2252	BAKER AD-1

Plug	
Depth	Plug Type
2450	CEMENT

Initial Test Data

Test Date	Formation	Oil BBL/Day	Oil-Gravity (API)	Gas MCF/Day	Gas-Oil Ratio Cu FT/BBL	Water BBL/Day	Pumpin or Flowing	Initial Shut-In Pressure	Choke Size	Flow Tubing Pressure
-----------	-----------	-------------	-------------------	-------------	-------------------------	---------------	-------------------	--------------------------	------------	----------------------

There are no Initial Data records to display.

Completion and Test Data by Producing Formation

Formation Name: PENN UP

Code: 406PSLVU

Class: DISP

Spacing Orders

Order No	Unit Size
There are no Spacing Order records to display.	

Perforated Intervals

From	To
2272	2370

Acid Volumes

There are no Acid Volume records to display.
--

Fracture Treatments

There are no Fracture Treatments records to display.
--

Formation	Top
-----------	-----

Were open hole logs run? No

Date last log run:

Were unusual drilling circumstances encountered? No

Explanation:

Other Remarks

ORIGINAL WELL NAME WAS R. H. OPERATING WESTFALL 1. THIS 1002A WAS COMPLETED FROM THE 1002A FROM 1997. TO REPAIR THE PRODUCING CASING, WE CUT OFF BELOW THE CASING PATCH @ 18', WELDED A BELL-NIPPLE ON AND SCREWED NEW CASING IN BELL-NIPPLE. WE THEN SET THE CONDUCTOR CASING AND CONCENTRICALLY DRILLED 90' OF 7" CASING AND CEMENTED THE 7" CASING TO SURFACE TO ACT AS SURFACE CASING. WE RAN A NEW PACKER WITH EXISTING LINED TUBING AND SET IT IN THE SAME LOCATION AS THE PREVIOUS PACKER. OCC - OPERATOR REPORTS A SQUEEZE WAS DONE AT 2,495' AND THAT IS THE CEMENT PLUG AT 2,450'. OPERATOR IN PROCESS OF CONVERTING TO DISPOSAL. UIC PERMIT NUMBER 1701710012. A DV TOOL SET IN 4 1/2" CASING AT 891' AND USED 150 SACKS CIRCULATED TO SURFACE.

FOR COMMISSION USE ONLY

1135572

Status: Accepted

API NO. 35-119-21522
 OTC PROC.
 UNIT NO.

PLEASE TYPE OR USE BLACK INK ONLY
 NOTE:

Attach copy of original 1002A if recompletion or reentry.

OKLAHOMA CORPORATION COMMISSION
 Oil & Gas Conservation Division
 Post Office Box 52000
 Oklahoma City, Oklahoma 73152-2000
 Rule 165:10-3-25

RECEIVED

Form 1002A
 Rev. 2009

AUG 30 2016

OKLAHOMA CORPORATION COMMISSION

ORIGINAL
 AMENDED (Reason) Acquired Well, Repaired Production Casing and added conductor and surface casing

COMPLETION REPORT

TYPE OF DRILLING OPERATION
 STRAIGHT HOLE DIRECTIONAL HOLE HORIZONTAL HOLE
 SERVICE WELL
 If directional or horizontal, see reverse for bottom hole location.

SPUD DATE 02/12/1981
 DRLG FINISHED DATE 02/28/1981
 DATE OF WELL COMPLETION 12/07/1981
 1st PROD DATE NA
 RECOMP DATE 8/11/2016
 Longitude (if known) -96.972950
 OTC/OCC OPERATOR NO. 23797

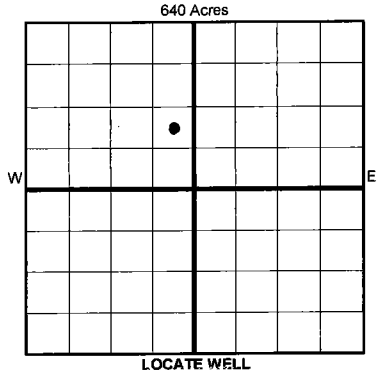

COUNTY Payne SEC 15 TWP 17N RGE 3E
 LEASE NAME Grover WELL NO. 1
 FSL OF 1/4 SEC 990 FWL OF 1/4 SEC 2310
 ELEVATIO N Derrick 862 Ground 858 Latitude (if known) 35.952156
 OPERATOR NAME Lakeshore Operating, LLC
 ADDRESS 23 1/2 E Madison Ave Suite A
 CITY Iola STATE KS ZIP 66749

COMPLETION TYPE
 SINGLE ZONE
 MULTIPLE ZONE
 COMMINGLED
 LOCATION EXCEPTION ORDER INCREASED DENSITY ORDER NO.

CASING & CEMENT (Form 1002C must be attached)

TYPE	SIZE	WEIGHT	GRADE	FEET	PSI	SAX	TOP OF CMT
CONDUCTOR	16 in	75#	K55	12			
SURFACE	7 in	23#	K55	90		45	Surface
INTERMEDIATE				2 Stage DV Tool @ 901'		150	Surface
PRODUCTION	4-1/2	9.5#		4390		200 350	3100 SURFACE
LINER							
TOTAL DEPTH							4400

see remarks

PACKER @ 2252' BRAND & TYPE Baker AD-1 PLUG @ 2450 TYPE Cement PLUG @ _____ TYPE _____
 PACKER @ _____ BRAND & TYPE _____ PLUG @ _____ TYPE _____ PLUG @ _____ TYPE _____

COMPLETION & TEST DATA BY PRODUCING FORMATION 406 PSLVLI

FORMATION	Upper Penn	2272' - 2375'					
SPACING & SPACING ORDER NUMBER							
CLASS: Oil, Gas, Dry, Inj, Disp, Comm Disp, Svc	<u>Disposal</u>						
PERFORATED INTERVALS	Top 22 1/2'						
	Bottom 2370'						
ACID/VOLUME							
FRACTURE TREATMENT (Fluids/Prop Amounts)							

Min Gas Allowable (165:10-17-7) Gas Purchaser/Measurer _____
 OR First Sales Date _____
 Oil Allowable (165:10-13-3)

INITIAL TEST DATA

INITIAL TEST DATE					
OIL-BBL/DAY					
OIL-GRAVITY (API)					
GAS-MCF/DAY					
GAS-OIL RATIO CU FT/BBL					
WATER-BBL/DAY					
PUMPING OR FLOWING					
INITIAL SHUT-IN PRESSURE					
CHOKE SIZE					
FLOW TUBING PRESSURE					

AS SUBMITTED

A record of the formations drilled through, and pertinent remarks are presented on the reverse. I declare that I have knowledge of the contents of this report and am authorized by my organization to make this report, which was prepared by me or under my supervision and direction, with the data and facts stated herein to be true, correct, and complete to the best of my knowledge and belief.

M. Pepper SIGNATURE NAME (PRINT OR TYPE) Martin Pepper
 23-1/2 E Madison Ave Suite A Iola KS 66749
 ADDRESS CITY STATE ZIP
 DATE 8/29/16 PHONE NUMBER (201) 460 5577
 EMAIL ADDRESS martin@lakeshorerresourcesllc.com

PLEASE TYPE OR USE BLACK INK ONLY
FORMATION RECORD

Give formation names and tops, if available, or descriptions and thickness of formations drilled through. Show intervals cored or drillstem tested.

LEASE NAME Grover WELL NO. 1

NAMES OF FORMATIONS	TOP

FOR COMMISSION USE ONLY

ITD on file YES NO

APPROVED _____ DISAPPROVED _____

2) Reject Codes

Were open hole logs run? yes no

Date Last log was run _____

Was CO₂ encountered? yes no at what depths? _____

Was H₂S encountered? yes no at what depths? _____

Were unusual drilling circumstances encountered? yes no

If yes, briefly explain below _____

Other remarks: Original well name was R. H. Opearting Westfall No. 1. This 1002A was completed from the 1002A from 1997.

To repair the production case we cut off below the casing patch @ 18', welded a bell-nipple on and screwed new casing in bell-nipple. We then set the conductor casing and concentrically drilled 90' of 7" casing and cemented the 7" casing to surface to act as surface casing. We ran a new packer with existing lined tubing and set it in the same location as the previous packer.

Operator reports a squeeze was done at 2495' and that is the cement plug at 2450'. Operator in process of converting to Disposal UIC permit 1701710012, DCC-ADV tool set in 4 1/2" casing at 291' and used 150 sacks circulated to surface

640 Acres

If more than three drainholes are proposed, attach a separate sheet indicating the necessary information.

Direction must be stated in degrees azimuth. Please note, the horizontal drainhole and its end point must be located within the boundaries of the lease or spacing unit.

Directional surveys are required for all drainholes and directional wells.

640 Acres

BOTTOM HOLE LOCATION FOR DIRECTIONAL HOLE

SEC	TWP	RGE	COUNTY	Spot Location		Feet From 1/4 Sec Lines	FSL	FWL
				1/4	1/4	1/4		
Measured Total Depth		True Vertical Depth		BHL From Lease, Unit, or Property Line:				

BOTTOM HOLE LOCATION FOR HORIZONTAL HOLE: (LATERALS)

LATERAL #1

SEC	TWP	RGE	COUNTY	Spot Location		Feet From 1/4 Sec Lines	FSL	FWL
				1/4	1/4	1/4		
Depth of Deviation		Radius of Turn		Direction		Total Length		
Measured Total Depth		True Vertical Depth		BHL From Lease, Unit, or Property Line:				

LATERAL #2

SEC	TWP	RGE	COUNTY	Spot Location		Feet From 1/4 Sec Lines	FSL	FWL
				1/4	1/4	1/4		
Depth of Deviation		Radius of Turn		Direction		Total Length		
Measured Total Depth		True Vertical Depth		BHL From Lease, Unit, or Property Line:				

LATERAL #3

SEC	TWP	RGE	COUNTY	Spot Location		Feet From 1/4 Sec Lines	FSL	FWL
				1/4	1/4	1/4		
Depth of Deviation		Radius of Turn		Direction		Total Length		
Measured Total Depth		True Vertical Depth		BHL From Lease, Unit, or Property Line:				