

Oklahoma Corporation Commission
 Oil & Gas Conservation Division
 Post Office Box 52000
 Oklahoma City, Oklahoma 73152-2000
 Rule 165: 10-3-25

Form 1002A

API No.: 35119239110001

Completion Report

Spud Date: April 14, 2012

OTC Prod. Unit No.:

Drilling Finished Date: April 26, 2012

Amended

Amend Reason: PLUG BACK FROM ARBUCKLE AND CHANGE DISPOSAL ZONE TO MISSISSIPPI AND WILCOX

1st Prod Date:

Completion Date: June 18, 2012

Recomplete Date: December 05, 2016

Drill Type: STRAIGHT HOLE

SERVICE WELL

Well Name: FHA SWD 1-15

Purchaser/Measurer:

Location: PAYNE 15 18N 4E
 S2 N2 SE NW
 1700 FNL 1980 FWL of 1/4 SEC
 Derrick Elevation: 906 Ground Elevation: 894

First Sales Date:

Operator: F H A INVESTMENTS LLC 21705
 PO BOX 1030
 808 S EUCHEE VLY
 CUSHING, OK 74023-1030

Completion Type	Location Exception	Increased Density
Single Zone	Order No	Order No
Multiple Zone	There are no Location Exception records to display.	There are no Increased Density records to display.
Commingled		

Casing and Cement							
Type	Size	Weight	Grade	Feet	PSI	SAX	Top of CMT
SURFACE	9 5/8	36	J-55	200		150	SURFACE
PRODUCTION	7	23	J-55	4546		275	3400

Liner								
Type	Size	Weight	Grade	Length	PSI	SAX	Top Depth	Bottom Depth
There are no Liner records to display.								

Total Depth: 5300

Packer	
Depth	Brand & Type
3800	ARROW

Plug	
Depth	Plug Type
4500	CIBP

Initial Test Data

Test Date	Formation	Oil BBL/Day	Oil-Gravity (API)	Gas MCF/Day	Gas-Oil Ratio Cu FT/BBL	Water BBL/Day	Pumpin or Flowing	Initial Shut-In Pressure	Choke Size	Flow Tubing Pressure
-----------	-----------	-------------	-------------------	-------------	-------------------------	---------------	-------------------	--------------------------	------------	----------------------

There are no Initial Data records to display.

Completion and Test Data by Producing Formation

Formation Name: MISSISSIPPI

Code: 351MISS

Class: DISP

Spacing Orders

Order No	Unit Size
There are no Spacing Order records to display.	

Perforated Intervals

From	To
3852	3995

Acid Volumes

There are no Acid Volume records to display.
--

Fracture Treatments

There are no Fracture Treatments records to display.
--

Formation Name: WILCOX

Code: 202WLCX

Class: DISP

Spacing Orders

Order No	Unit Size
There are no Spacing Order records to display.	

Perforated Intervals

From	To
4110	4245

Acid Volumes

There are no Acid Volume records to display.
--

Fracture Treatments

There are no Fracture Treatments records to display.
--

Formation	Top
MISSISSIPPI	3850
WILCOX	4100

Were open hole logs run? No

Date last log run:

Were unusual drilling circumstances encountered? No

Explanation:

Other Remarks

THIS WELL WAS ORIGINALLY PERMITTED AS AN OPEN HOLE ARBUCKLE DISPOSAL WELL PURSUANT TO UIC PERMIT NUMBER 1204230083. AT THE REQUEST OF UIC DEPARTMENT, WE HAVE SET A CIBP ABOVE THE ARBUCKLE AND FILED AN AMENDED DISPOSAL PERMIT APPLICATION. PERMIT NUMBER 1703760062 TO DISMISS ARBUCKLE AND PERMIT MISSISSIPPI AND WILCOX.

FOR COMMISSION USE ONLY

1135567

Status: Accepted

API NO. 119-23911
 OTC PROD.
 UNIT NO.

PLEASE TYPE OR USE BLACK INK ONLY
 NOTE:

Attach copy of original 1002A
 if recompletion or reentry.

OKLAHOMA CORPORATION COMMISSION
 Oil & Gas Conservation Division
 Post Office Box 52000
 Oklahoma City, Oklahoma 73152-2000
 Rule 165:10-3-25

RECEIVED

Form 1002A
 Rev. 2009

DEC 05 2016

OKLAHOMA CORPORATION
 COMMISSION

ORIGINAL
 AMENDED (Reason)

Plug back and change disp zone

from Arbuckle to Mississippi & Wilcox

COMPLETION REPORT

TYPE OF DRILLING OPERATION
 STRAIGHT HOLE DIRECTIONAL HOLE HORIZONTAL HOLE
 SERVICE WELL

If directional or horizontal, see reverse for bottom hole location.

COUNTY	PAYNE	SEC	15	TWP	18N	RGE	4E	SPUD DATE	4/14/2012
LEASE NAME	FHA SWD			WELL NO.	1-15			DRLG FINISHED DATE	4/26/2012
SW 1/4 NE 1/4 SE 1/4 NW 1/4	E 1/4 SEC 1700			FWL OF 1/4 SEC	1980			DATE OF WELL COMPLETION	6/18/2012
ELEVATION N Derrick	906	Ground	894	Latitude (if known)				1st PROD DATE	NA
OPERATOR NAME	F H A INVESTMENTS LLC			OTC/OCC OPERATOR NO.	21705				
ADDRESS	808 S. EUCHEE VALLEY								
CITY	CUSHING	STATE	OK	ZIP	74023-2966				

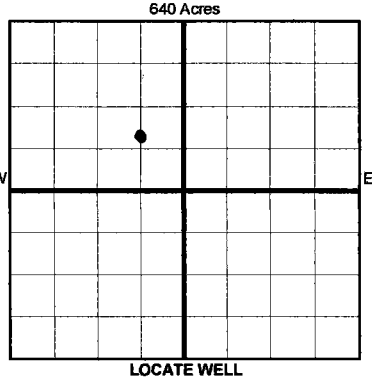

COMPLETION TYPE

<input type="checkbox"/> SINGLE ZONE
<input type="checkbox"/> MULTIPLE ZONE
Application Date
<input type="checkbox"/> COMMINGLED
Application Date
LOCATION
<input type="checkbox"/> EXCEPTION ORDER
<input type="checkbox"/> INCREASED DENSITY ORDER NO.

CASING & CEMENT (Form 1002C must be attached)

TYPE	SIZE	WEIGHT	GRADE	FEET	PSI	SAX	TOP OF CMT	
CONDUCTOR								
SURFACE	9 5/8"	36	J-55	200		150	SURFACE	
INTERMEDIATE								
PRODUCTION	7"	23	J-55	4546		275	3400	
LINER								
							TOTAL DEPTH	5,300

PACKER @ 3,800 BRAND & TYPE ARROW PLUG @ 4500 TYPE CIBP PLUG @ _____ TYPE _____
 PACKER @ _____ BRAND & TYPE _____ PLUG @ _____ TYPE _____ PLUG @ _____ TYPE _____

COMPLETION & TEST DATA BY PRODUCING FORMATION *351 MISS 202 WLCX*

FORMATION	MISSISSIPPI	WILCOX
SPACING & SPACING ORDER NUMBER	NA DISP WELL	
CLASS: Oil, Gas, Dry, Inj, Disp, Comm Disp, Svc	<i>Disposal</i>	<i>Disposal</i>
PERFORATED INTERVALS	3852-3995	4110-4245
ACID/VOLUME	NA	NA
FRACTURE TREATMENT (Fluids/Prop Amounts)		

Min Gas Allowable (165:10-17-7) Gas Purchaser/Measurer _____
 OR
 Oil Allowable (165:10-13-3) First Sales Date _____

INITIAL TEST DATA

INITIAL TEST DATE	NA DISP WELL
OIL-BBL/DAY	
OIL-GRAVITY (API)	
GAS-MCF/DAY	
GAS-OIL RATIO CU FT/BBL	
WATER-BBL/DAY	
PUMPING OR FLOWING	
INITIAL SHUT-IN PRESSURE	
CHOKE SIZE	
FLOW TUBING PRESSURE	

AS SUBMITTED

A record of the formations drilled through, and pertinent remarks are presented on the reverse. I declare that I have knowledge of the contents of this report and am authorized by my organization to make this report, which was prepared by me or under my supervision and direction, with the data and facts stated herein to be true, correct, and complete to the best of my knowledge and belief.

Saleem Nizami
 SIGNATURE NAME (PRINT OR TYPE) SALEEM NIZAMI-CONSULTANT AGENT
 ADDRESS CITY STATE ZIP CUSHING OK 74023-2966
 DATE PHONE NUMBER 12/5/2016 405-513-6055
 EMAIL ADDRESS APECPAEC@MSN.COM

PLEASE TYPE OR USE BLACK INK ONLY

FORMATION RECORD

Give formation names and tops, if available, or descriptions and thickness of formations drilled through. Show intervals cored or drillstem tested.

LEASE NAME FHA SWD

WELL NO. 1-15

NAMES OF FORMATIONS	TOP
MISSISSIPPI	3,850
WILCOX	4,100

FOR COMMISSION USE ONLY

ITD on file YES NO

APPROVED _____ DISAPPROVED _____

2) Reject Codes _____

Were open hole logs run? yes no

Date Last log was run _____

Was CO₂ encountered? yes no at what depths? _____

Was H₂S encountered? yes no at what depths? _____

Were unusual drilling circumstances encountered? yes no
If yes, briefly explain below _____

Other remarks: This well was originally permitted as an open hole Arbuckle disposal well pursuant to UIC permit 1204230083
At the request of UIC Dept. we have set a CIBP above the Arbuckle and filed an amended disp permit application
Application # 1703760062 to dismiss Arbuckle and permit Mississippi and Wilcox
Permit

640 Acres

If more than three drainholes are proposed, attach a separate sheet indicating the necessary information.

Direction must be stated in degrees azimuth. Please note, the horizontal drainhole and its end point must be located within the boundaries of the lease or spacing unit.

Directional surveys are required for all drainholes and directional wells.

640 Acres

BOTTOM HOLE LOCATION FOR DIRECTIONAL HOLE

SEC	TWP	RGE	COUNTY	Spot Location		Feet From 1/4 Sec Lines	FSL	FWL
				1/4	1/4			
Measured Total Depth		True Vertical Depth		BHL From Lease, Unit, or Property Line:				

BOTTOM HOLE LOCATION FOR HORIZONTAL HOLE: (LATERALS)

LATERAL #1

SEC	TWP	RGE	COUNTY	Spot Location		Feet From 1/4 Sec Lines	FSL	FWL
				1/4	1/4			
Depth of Deviation		Radius of Turn		Direction		Total Length		
Measured Total Depth		True Vertical Depth		BHL From Lease, Unit, or Property Line:				

LATERAL #2

SEC	TWP	RGE	COUNTY	Spot Location		Feet From 1/4 Sec Lines	FSL	FWL
				1/4	1/4			
Depth of Deviation		Radius of Turn		Direction		Total Length		
Measured Total Depth		True Vertical Depth		BHL From Lease, Unit, or Property Line:				

LATERAL #3

SEC	TWP	RGE	COUNTY	Spot Location		Feet From 1/4 Sec Lines	FSL	FWL
				1/4	1/4			
Depth of Deviation		Radius of Turn		Direction		Total Length		
Measured Total Depth		True Vertical Depth		BHL From Lease, Unit, or Property Line:				