

Oklahoma Corporation Commission  
 Oil & Gas Conservation Division  
 Post Office Box 52000  
 Oklahoma City, Oklahoma 73152-2000  
 Rule 165: 10-3-25

Form 1002A

API No.: 35017204900001

**Completion Report**

Spud Date: February 28, 1976

OTC Prod. Unit No.:

Drilling Finished Date: March 24, 1976

**Amended**

1st Prod Date: April 10, 1976

Amend Reason: CONVERT TO INJECTION

Completion Date: April 11, 1976

Recomplete Date: November 17, 2016

**Drill Type: STRAIGHT HOLE**

**SERVICE WELL**

Well Name: ROBBERSON 14-7

Purchaser/Measurer:

Location: CANADIAN 14 10N 5W  
 C N2 SW SE  
 990 FSL 660 FWL of 1/4 SEC  
 Derrick Elevation: 0 Ground Elevation: 1182

First Sales Date:

Operator: MID-CON ENERGY OPERATING LLC 23271

2431 E 61ST ST STE 850  
 TULSA, OK 74136-1236

Completion Type	
X	Single Zone
	Multiple Zone
	Commingled

Location Exception
Order No
There are no Location Exception records to display.

Increased Density
Order No
There are no Increased Density records to display.

Casing and Cement							
Type	Size	Weight	Grade	Feet	PSI	SAX	Top of CMT
SURFACE	8 5/8	24		861		600	SURFACE
PRODUCTION	5 1/2	15.5		8780		250	7700

Liner								
Type	Size	Weight	Grade	Length	PSI	SAX	Top Depth	Bottom Depth
There are no Liner records to display.								

**Total Depth: 8780**

Packer	
Depth	Brand & Type
8677	AS1X

Plug	
Depth	Plug Type
There are no Plug records to display.	

Initial Test Data

Test Date	Formation	Oil BBL/Day	Oil-Gravity (API)	Gas MCF/Day	Gas-Oil Ratio Cu FT/BBL	Water BBL/Day	Pumpin or Flowing	Initial Shut-In Pressure	Choke Size	Flow Tubing Pressure
-----------	-----------	-------------	-------------------	-------------	-------------------------	---------------	-------------------	--------------------------	------------	----------------------

There are no Initial Data records to display.

**Completion and Test Data by Producing Formation**

Formation Name: HUNTON

Code: 269HNTN

Class: INJ

**Spacing Orders**

Order No	Unit Size
There are no Spacing Order records to display.	

**Perforated Intervals**

From	To
8747	8770

**Acid Volumes**

There are no Acid Volume records to display.
--

**Fracture Treatments**

There are no Fracture Treatments records to display.
--

Formation	Top
HUNTON	8747

Were open hole logs run? No

Date last log run:

Were unusual drilling circumstances encountered? No

Explanation:

**Other Remarks**

OCC - UIC PERMIT NUMBER 1608680077

**FOR COMMISSION USE ONLY**

1135442

Status: Accepted

API NO. **01720490**  
 OTC PROD.  
 UNIT NO.

PLEASE TYPE OR USE BLACK INK ONLY  
 NOTE:

Attach copy of original 1002A  
 if recompletion or reentry.

OKLAHOMA CORPORATION COMMISSION  
 Oil & Gas Conservation Division  
 Post Office Box 52000  
 Oklahoma City, Oklahoma 73152-2000  
 Rule 165:10-3-25

**RECEIVED**

Form 1002A  
 Rev. 2009

DEC 16 2016

OKLAHOMA CORPORATION  
 COMMISSION

ORIGINAL  
 AMENDED (Reason)

**CONVERT TO INJECTION**

COMPLETION REPORT

TYPE OF DRILLING OPERATION

STRAIGHT HOLE  DIRECTIONAL HOLE  HORIZONTAL HOLE  
 SERVICE WELL

If directional or horizontal, see reverse for bottom hole location.

COUNTY	CANADIAN	SEC	14	TWP	10N	RGE	5W	SPUD DATE	2/28/1976	
LEASE NAME	ROBERSON			WELL NO.	14-7			DRLG FINISHED DATE	3-24-1976	
C	1/4 N2	1/4 SW	1/4 SE	1/4	FSL OF 1/4 SEC	990	FWL OF 1/4 SEC	660	DATE OF WELL COMPLETION	4/11/1976
ELEVATION N Derrick	Ground	1182	Latitude (if known)				Longitude (if known)		1st PROD DATE	4-10-1976
OPERATOR NAME	MID-CON ENERGY OPERATING, LLC				OTC/OCC OPERATOR NO.	23271				
ADDRESS	2341 E 61ST ST., SUITE 850									
CITY	TULSA	STATE	OK	ZIP	74136					

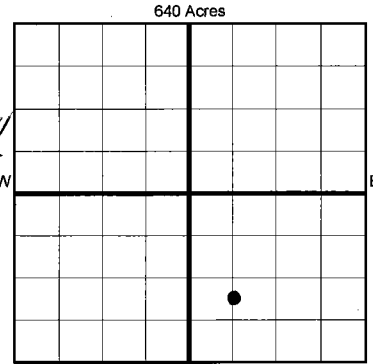

COMPLETION TYPE

SINGLE ZONE  
 MULTIPLE ZONE  
 Application Date  
 COMMINGLED  
 Application Date  
 LOCATION  
 EXCEPTION ORDER  
 INCREASED DENSITY  
 ORDER NO.

CASING & CEMENT (Form 1002C must be attached)

TYPE	SIZE	WEIGHT	GRADE	FEET	PSI	SAX	TOP OF CMT
CONDUCTOR							
SURFACE	8 5/8	24#		861		600	SURF
INTERMEDIATE							
PRODUCTION	5 1/2	15.5#		8780		250	7700
LINER							

PACKER @ 8,677 BRAND & TYPE AS1X PLUG @ \_\_\_\_\_ TYPE \_\_\_\_\_ PLUG @ \_\_\_\_\_ TYPE \_\_\_\_\_  
 PACKER @ \_\_\_\_\_ BRAND & TYPE \_\_\_\_\_ PLUG @ \_\_\_\_\_ TYPE \_\_\_\_\_ PLUG @ \_\_\_\_\_ TYPE \_\_\_\_\_

TOTAL DEPTH **8780'**

COMPLETION & TEST DATA BY PRODUCING FORMATION

FORMATION	HUNTON
SPACING & SPACING ORDER NUMBER	NO SPACING
CLASS: Oil, Gas, Dry, Inj, Disp, Comm Disp, Svc	INJ
PERFORATED INTERVALS	8747' - 8770'
ACID/VOLUME	
FRACTURE TREATMENT (Fluids/Prop Amounts)	

Min Gas Allowable (165:10-17-7) OR  Gas Purchaser/Measurer First Sales Date \_\_\_\_\_  
 Oil Allowable (165:10-13-3)

INITIAL TEST DATA

INITIAL TEST DATE	12/1/2016
OIL-BBL/DAY	
OIL-GRAVITY ( API)	
GAS-MCF/DAY	
GAS-OIL RATIO CU FT/BBL	
WATER-BBL/DAY	
PUMPING OR FLOWING	740 BHPD
INITIAL SHUT-IN PRESSURE	
CHOKE SIZE	
FLOW TUBING PRESSURE	

**AS SUBMITTED**

A record of the formations drilled through, and pertinent remarks are presented on the reverse. I declare that I have knowledge of the contents of this report and am authorized by my organization to make this report, which was prepared by me or under my supervision and direction, with the data and facts stated herein to be true, correct, and complete to the best of my knowledge and belief.

Annie Houchin SIGNATURE  
 2341 E 61ST ST., SUITE 850 ADDRESS  
 TULSA CITY  
 OK STATE  
 74136 ZIP

ANNIE HOUCHIN NAME (PRINT OR TYPE)  
 12/13/2016 DATE  
 918-748-3343 PHONE NUMBER  
 ahouchin@midcon-energy.com EMAIL ADDRESS

PLEASE TYPE OR USE BLACK INK ONLY  
FORMATION RECORD

Give formation names and tops, if available, or descriptions and thickness of formations drilled through. Show intervals cored or drillstem tested.

LEASE NAME ROBBERSON WELL NO. 14-7

NAMES OF FORMATIONS	TOP
HUNTON	8747'

FOR COMMISSION USE ONLY

ITD on file  YES  NO

APPROVED \_\_\_\_\_ DISAPPROVED \_\_\_\_\_

2) Reject Codes

\_\_\_\_\_

\_\_\_\_\_

\_\_\_\_\_

\_\_\_\_\_

Were open hole logs run?  yes  no

Date Last log was run \_\_\_\_\_

Was CO<sub>2</sub> encountered?  yes  no at what depths? \_\_\_\_\_

Was H<sub>2</sub>S encountered?  yes  no at what depths? \_\_\_\_\_

Were unusual drilling circumstances encountered?  yes  no  
If yes, briefly explain below \_\_\_\_\_

Other remarks:  
*Occ - UIC Permit 1608680077*

\_\_\_\_\_

\_\_\_\_\_

\_\_\_\_\_

\_\_\_\_\_

640 Acres

If more than three drainholes are proposed, attach a separate sheet indicating the necessary information.

Direction must be stated in degrees azimuth.  
Please note, the horizontal drainhole and its end point must be located within the boundaries of the lease or spacing unit.

Directional surveys are required for all drainholes and directional wells.

640 Acres

BOTTOM HOLE LOCATION FOR DIRECTIONAL HOLE

SEC	TWP	RGE	COUNTY							
Spot Location				1/4	1/4	1/4	1/4	Feet From 1/4 Sec Lines	FSL	FWL
Measured Total Depth				True Vertical Depth		BHL From Lease, Unit, or Property Line:				

BOTTOM HOLE LOCATION FOR HORIZONTAL HOLE: (LATERALS)

LATERAL #1

SEC	TWP	RGE	COUNTY							
Spot Location				1/4	1/4	1/4	1/4	Feet From 1/4 Sec Lines	FSL	FWL
Depth of Deviation				Radius of Turn		Direction		Total Length		
Measured Total Depth				True Vertical Depth		BHL From Lease, Unit, or Property Line:				

LATERAL #2

SEC	TWP	RGE	COUNTY							
Spot Location				1/4	1/4	1/4	1/4	Feet From 1/4 Sec Lines	FSL	FWL
Depth of Deviation				Radius of Turn		Direction		Total Length		
Measured Total Depth				True Vertical Depth		BHL From Lease, Unit, or Property Line:				

LATERAL #3

SEC	TWP	RGE	COUNTY							
Spot Location				1/4	1/4	1/4	1/4	Feet From 1/4 Sec Lines	FSL	FWL
Depth of Deviation				Radius of Turn		Direction		Total Length		
Measured Total Depth				True Vertical Depth		BHL From Lease, Unit, or Property Line:				