

Oklahoma Corporation Commission  
Oil & Gas Conservation Division  
Post Office Box 52000  
Oklahoma City, Oklahoma 73152-2000  
Rule 165: 10-3-25

Form 1002A

API No.: 35019259230003

**Completion Report**

Spud Date: May 10, 2014

OTC Prod. Unit No.:

Drilling Finished Date: May 25, 2014

**Amended**

1st Prod Date: September 29, 2014

Amend Reason: CONVERT TO INJECTION WELL

Completion Date: September 29, 2014

Recomplete Date: November 23, 2016

**Drill Type: DIRECTIONAL HOLE**

**SERVICE WELL**

Well Name: TFDU MARTIN (SWAN 1-31) 7-36

Purchaser/Measurer:

Location: CARTER 36 5S 2W  
NE NE SE SE  
1100 FSL 100 FEL of 1/4 SEC  
Derrick Elevation: 0 Ground Elevation: 846

First Sales Date:

Operator: MID-CON ENERGY OPERATING LLC 23271

2431 E 61ST ST STE 850  
TULSA, OK 74136-1236

Completion Type	
X	Single Zone
	Multiple Zone
	Commingled

Location Exception	
Order No	
There are no Location Exception records to display.	

Increased Density	
Order No	
There are no Increased Density records to display.	

Casing and Cement							
Type	Size	Weight	Grade	Feet	PSI	SAX	Top of CMT
SURFACE	8 5/8	24	J-55	1387		700	SURFACE
PRODUCTION	5 1/2	17	J-55	7318		500	3940

Liner								
Type	Size	Weight	Grade	Length	PSI	SAX	Top Depth	Bottom Depth
There are no Liner records to display.								

**Total Depth: 7350**

Packer	
Depth	Brand & Type
7148	AS-1X

Plug	
Depth	Plug Type
7232	CEMENT

Initial Test Data

Test Date	Formation	Oil BBL/Day	Oil-Gravity (API)	Gas MCF/Day	Gas-Oil Ratio Cu FT/BBL	Water BBL/Day	Pumpin or Flowing	Initial Shut-In Pressure	Choke Size	Flow Tubing Pressure
Dec 12, 2016	DEESE					612				

**Completion and Test Data by Producing Formation**

Formation Name: DEESE

Code: 404DEESS

Class: INJ

**Spacing Orders**

Order No	Unit Size
563436	UNIT

**Perforated Intervals**

From	To
7155	7165
7191	7196

**Acid Volumes**

19 BARRELS 7 1/2% NEFE

**Fracture Treatments**

There are no Fracture Treatments records to display.

Formation	Top
ZUCKERMAN LIME	2678
DAUBE LIME	3144
ANADARCHE LIME	3604
BAYOU	4413
CHUBBEE	4971
LONE GROVE SERIES	5706
LOWER FUSULINID SAND	6883
STACY SAND	6985
LEEMAN SAND	7034
TUSSY	7105
DORNICK HILLS	7213

Were open hole logs run? No

Date last log run: June 11, 2014

Were unusual drilling circumstances encountered? No

Explanation:

**Other Remarks**

OCC - UIC PERMIT NUMBER 1607490008

**Bottom Holes**

Sec: 36 TWP: 5S RGE: 2W County: CARTER

SW NE SE SE

1041 FSL 210 FEL of 1/4 SEC

Depth of Deviation: 0 Radius of Turn: 0 Direction: 0 Total Length: 0

Measured Total Depth: 7350 True Vertical Depth: 7341 End Pt. Location From Release, Unit or Property Line: 210

**FOR COMMISSION USE ONLY**

1135541



RECEIVED

1002A Rev. 2009

DEC 23 2016

OKLAHOMA CORPORATION COMMISSION

API NO. 019-25923X  
OTC PROD. UNIT NO.

PLEASE TYPE OR USE BLACK INK ONLY  
NOTE: Attach copy of original 1002A if recompletion or rec

OKLAHOMA CORPORATION COMMISSION  
Oil & Gas Conservation Division  
Post Office Box 52000  
Oklahoma City, Oklahoma 73152-2000  
Rule 165:10-3-25

ORIGINAL AMENDED (Reason) CONVERT TO INJ WELL

COMPLETION REPORT

TYPE OF DRILLING OPERATION  
 STRAIGHT HOLE  DIRECTIONAL HOLE  HORIZONTAL HOLE  
 SERVICE WELL  
If directional or horizontal, see reverse for bottom hole location.

SPUD DATE 5/10/2014

DRLG FINISHED DATE 5/25/2014

DATE OF WELL COMPLETION 9/29/2014

1st PROD DATE 9/29/2014

RECOMP DATE 11/23/2016

COUNTY Carter SEC 36 TWP 5S RGE 2W

LEASE NAME TFDU Martin (FKA Swan 1-31) WELL NO. 7-36

NE 1/4 NE 1/4 SE 1/4 SE 1/4 FSL 1100 FWL OF 1/4 SEC FEL100

ELEVATION N Derrick Ground 846 Latitude (if known)

OPERATOR NAME Mid-Con Energy Operating, LLC. OTC/OCC OPERATOR N 23271

ADDRESS 2431 E 61st St., Ste. 850

CITY Tulsa STATE OK ZIP 74136

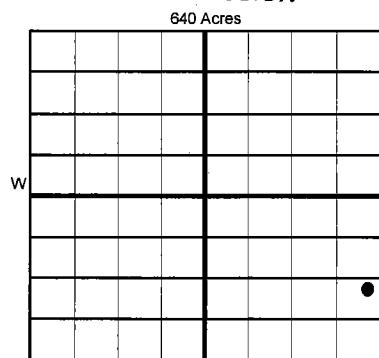

COMPLETION TYPE  
 SINGLE ZONE  
 MULTIPLE ZONE  
Application Date  
 COMMINGLED  
Application Date  
LOCATION  
EXCEPTION ORDER  
INCREASED DENSITY  
ORDER NO.

CASING & CEMENT (Form 1002C must be attached)

TYPE	SIZE	WEIGHT	GRADE	FEET	PSI	SAX	TOP OF CMT
CONDUCTOR							
SURFACE	8 5/8	24#	J55	1387'		700	surface
INTERMEDIATE							
PRODUCTION	5 1/2	17#	J55	7318'		500	3940'
LINER							
TOTAL DEPTH							7350'

PACKER @ 7,148 BRAND & TYPE AS-1X PLUG @ 7232 TYPE Cement PLUG @ TYPE  
PACKER @ BRAND & TYPE PLUG @ TYPE PLUG @ TYPE

COMPLETION & TEST DATA BY PRODUCING FORMATION

FORMATION	Deese						No Frac
SPACING & SPACING ORDER NUMBER	563436 (unit)						
CLASS: Oil, Gas, Dry, Inj, Disp, Comm Disp, Svc	INJ						
PERFORATED INTERVALS	7191'-7196', 7155'-7165'						
	4 spf						
ACID/VOLUME	19 bbls 7 1/2% NE/FE						
FRACTURE TREATMENT (Fluids/Prop Amounts)							

Min Gas Allowable (165:10-17-7)

Gas Purchaser/Measurer

OR

First Sales Date

Oil Allowable (165:10-13-3)

INITIAL TEST DATA

INITIAL TEST DATE	12/12/2016						
OIL-BBL/DAY							
OIL-GRAVITY ( API)							
GAS-MCF/DAY							
GAS-OIL RATIO CU FT/BBL							
WATER-BBL/DAY	612						
PUMPING OR FLOWING							
INITIAL SHUT-IN PRESSURE							
CHOKE SIZE							
FLOW TUBING PRESSURE							

AS SUBMITTED

A record of the formations drilled through, and pertinent remarks are presented on the reverse. I declare that I have knowledge of the contents of this report and am authorized by my organization to make this report, which was prepared by me or under my supervision and direction, with the data and facts stated herein to be true, correct, and complete to the best of my knowledge and belief

Annie Houchin  
SIGNATURE NAME (PRINT OR TYPE) 12/19/16 918-748-3343  
2431 E 61st St. Suite 850 Tulsa Ok 74136  
ADDRESS CITY STA ZIP ahouchin@midcon-energy.com  
EMAIL ADDRESS

PLEASE TYPE OR USE BLACK INK ONLY  
FORMATION RECORD

Give formation names and tops, if available, or descriptions and thickness of formations drilled through. Show intervals cored or drillstem tested.

LEASE NAME TFDU Martin (FKA Swan 1-31) WELL NO. 7-36

NAMES OF FORMATIONS	TOP
Zuckerman Lime	2,678'
Duabe Lime	3,144'
Anadarche Lime	3,604'
Bayou	4,413'
Chubbee	4,971'
Lone Grove Series	5,706'
L/Fusulinid Sand	6,883'
Stacy Sand	6,985'
Leeman Sand	7,034'
Tussy	7,105'
Dornick Hills	7,213'

FOR COMMISSION USE ONLY

ITD on file  YES  NO

APPROVED \_\_\_\_\_ DISAPPROVED \_\_\_\_\_

2) Reject Codes \_\_\_\_\_

\_\_\_\_\_

\_\_\_\_\_

\_\_\_\_\_

\_\_\_\_\_

Were open hole logs run?  yes  no

Date Last log was run 6/11/2014

Was CO<sub>2</sub> encountered?  yes  no at what depths? \_\_\_\_\_

Was H<sub>2</sub>S encountered?  yes  no at what depths? \_\_\_\_\_

Were unusual drilling circumstances encountered?  yes  no  
If yes, briefly explain below \_\_\_\_\_

Other remarks: OCC-ULC permit 1607490008

\_\_\_\_\_

\_\_\_\_\_

\_\_\_\_\_

\_\_\_\_\_

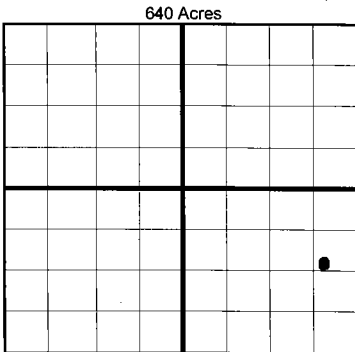

If more than three drainholes are proposed, attach a separate sheet indicating the necessary information.

Direction must be stated in degrees azimuth. Please note, the horizontal drainhole and its end point must be located within the boundaries of the lease or spacing unit.

Directional surveys are required for all drainholes and directional wells.

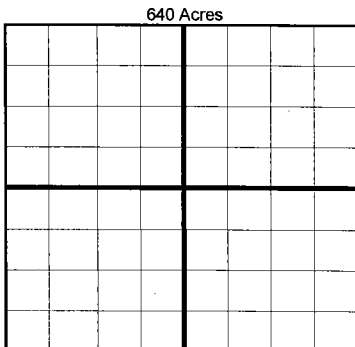

BOTTOM HOLE LOCATION FOR DIRECTIONAL HOLE

SEC 36	TWP	5S	RGE	2W	COUNTY	Carter					
Spot Location					SW 1/4	NE 1/4	SE 1/4	SE 1/4	Feet From 1/4 Sec Lines	FSL 1041'	FWL FEL210'
Measured Total Depth			True Vertical Depth		BHL From Lease, Unit, or Property Line:						
7350'			7341'		210'						

BOTTOM HOLE LOCATION FOR HORIZONTAL HOLE: (LATERALS)

LATERAL #1

SEC	TWP	RGE	COUNTY							
Spot Location				1/4	1/4	1/4	1/4	Feet From 1/4 Sec Lines	FSL	FWL
Depth of Deviation		Radius of Turn		Direction		Total Length				
Measured Total Depth		True Vertical Depth		BHL From Lease, Unit, or Property Line:						

LATERAL #2

SEC	TWP	RGE	COUNTY							
Spot Location				1/4	1/4	1/4	1/4	Feet From 1/4 Sec Lines	FSL	FWL
Depth of Deviation		Radius of Turn		Direction		Total Length				
Measured Total Depth		True Vertical Depth		BHL From Lease, Unit, or Property Line:						

LATERAL #3

SEC	TWP	RGE	COUNTY							
Spot Location				1/4	1/4	1/4	1/4	Feet From 1/4 Sec Lines	FSL	FWL
Depth of Deviation		Radius of Turn		Direction		Total Length				
Measured Total Depth		True Vertical Depth		BHL From Lease, Unit, or Property Line:						