

Oklahoma Corporation Commission
Oil & Gas Conservation Division
Post Office Box 52000
Oklahoma City, Oklahoma 73152-2000
Rule 165: 10-3-25

Form 1002A

API No.: 35037293310001

Completion Report

Spud Date: December 23, 2015

OTC Prod. Unit No.: 037-23366

Drilling Finished Date: December 30, 2015

1st Prod Date: March 10, 2016

Amended

Completion Date: February 19, 2016

Amend Reason: SHOW DATE FIRST PRODUCTION

Drill Type: STRAIGHT HOLE

Min Gas Allowable: Yes

Well Name: AUNDRES 3-18

Purchaser/Measurer: KINDER MORGAN

Location: CREEK 18 15N 8E
NW SE NW NE
1652 FSL 939 FWL of 1/4 SEC
Derrick Elevation: 934 Ground Elevation: 926

First Sales Date: 03/25/2016

Operator: CHIZUM OIL LLC 21860
PO BOX 123
1005 WATERVIEW DR
ANDOVER, KS 67002-0123

Completion Type	
X	Single Zone
	Multiple Zone
	Commingled

Location Exception	
Order No	
There are no Location Exception records to display.	

Increased Density	
Order No	
There are no Increased Density records to display.	

Casing and Cement							
Type	Size	Weight	Grade	Feet	PSI	SAX	Top of CMT
SURFACE	8 5/8	36	J-55	810		410	SURFACE
PRODUCTION	5 1/2	17	J-55	3956		200	2910

Liner								
Type	Size	Weight	Grade	Length	PSI	SAX	Top Depth	Bottom Depth
There are no Liner records to display.								

Total Depth: 4000

Packer	
Depth	Brand & Type
There are no Packer records to display.	

Plug	
Depth	Plug Type
There are no Plug records to display.	

Initial Test Data										
Test Date	Formation	Oil BBL/Day	Oil-Gravity (API)	Gas MCF/Day	Gas-Oil Ratio Cu FT/BBL	Water BBL/Day	Pumpin or Flowing	Initial Shut-In Pressure	Choke Size	Flow Tubing Pressure
Feb 19, 2016	GILCREASE	1		120			FLOWING	580	11/64	600

Completion and Test Data by Producing Formation

Formation Name: GILCREASE

Code: 403GLCR

Class: GAS

Spacing Orders

Order No	Unit Size
There are no Spacing Order records to display.	

Perforated Intervals

From	To
3318	3324

Acid Volumes

There are no Acid Volume records to display.
--

Fracture Treatments

There are no Fracture Treatments records to display.
--

Formation	Top
GILCREASE	3300
MISSISSIPPI LIME	3410
WOODFORD	3710
WILCOX	3850

Were open hole logs run? Yes

Date last log run: January 01, 2016

Were unusual drilling circumstances encountered? No

Explanation:

Other Remarks

There are no Other Remarks.

FOR COMMISSION USE ONLY

1135371

Status: Accepted

037-29331-01

API NO. 147-23507
OTC PROD. UNIT NO. 037-23366

PLEASE TYPE OR USE BLACK INK ONLY
NOTE:

Attach copy of original 1002A
if recompletion or reentry.

OKLAHOMA CORPORATION COMMISSION
Oil & Gas Conservation Division
Post Office Box 52000
Oklahoma City, Oklahoma 73152-2000
Rule 165:10-3-25

RECEIVED

DEC 09 2016

Form 1002A
Rev. 2009

ORIGINAL
 AMENDED (Reason) Show Date 1st Production

COMPLETION REPORT

OKLAHOMA CORPORATION COMMISSION

TYPE OF DRILLING OPERATION
 STRAIGHT HOLE DIRECTIONAL HOLE HORIZONTAL HOLE
 SERVICE WELL
If directional or horizontal, see reverse for bottom hole location.

SPUD DATE 12/23/15
DRLG FINISHED DATE 12/30/15
DATE OF WELL COMPLETION 2/19/16
1st PROD DATE 3/10/16
RECOMP DATE
Longitude (if known)
OTC/OCC OPERATOR NO. 21860

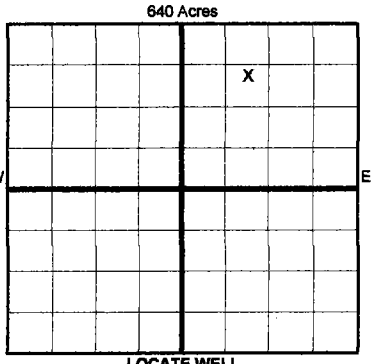

COUNTY Creek SEC 18 TWP 15N RGE 8E
LEASE NAME Aunders WELL NO. 3-18
NW 1/4 SE 1/4 NW 1/4 NE 1/4 FSL OF 1/4 SEC 1652' FWL OF 1/4 SEC 939'
ELEVATION N Derrick 934 Ground 926
OPERATOR NAME Chizum Oil, LLC. ADDRESS P.O. Box 123
CITY Andover STATE KS ZIP 67002

COMPLETION TYPE
 SINGLE ZONE Gilcrease
 MULTIPLE ZONE
Application Date
COMMINGLED
Application Date
LOCATION
EXCEPTION ORDER
INCREASED DENSITY
ORDER NO.

CASING & CEMENT (Form 1002C must be attached)

TYPE	SIZE	WEIGHT	GRADE	FEET	PSI	SAX	TOP OF CMT
CONDUCTOR							
SURFACE	85/8	36#	J-55	810		410	surface
INTERMEDIATE							
PRODUCTION	51/2	17#	J-55	3956'		200	2910
LINER							
							TOTAL DEPTH 4000'

PACKER @ _____ BRAND & TYPE _____ PLUG @ _____ TYPE _____ PLUG @ _____ TYPE _____
PACKER @ _____ BRAND & TYPE _____ PLUG @ _____ TYPE _____ PLUG @ _____ TYPE _____

COMPLETION & TEST DATA BY PRODUCING FORMATION 4036LCR

FORMATION	SPACING & SPACING ORDER NUMBER	CLASS: Oil, Gas, Dry, Inj, Disp, Comm Disp, Svc	PERFORATED INTERVALS	ACID/VOLUME	FRACTURE TREATMENT (Fluids/Prop Amounts)
Gilcrease		<u>Gas</u>	3318 3324	No	No

Min Gas Allowable (165:10-17-7) OR Oil Allowable (165:10-13-3) Gas Purchaser/Measurer Kinder Morgan First Sales Date 3/25/2016

INITIAL TEST DATA

INITIAL TEST DATE	2/19/2016
OIL-BBL/DAY	1 bopd
OIL-GRAVITY (API)	
GAS-MCF/DAY	120 mcf
GAS-OIL RATIO CU FT/BBL	
WATER-BBL/DAY	0
PUMPING OR FLOWING	Flowing
INITIAL SHUT-IN PRESSURE	580#
CHOKE SIZE	11/64
FLOW TUBING PRESSURE	600#

AS SUBMITTED

A record of the formations drilled through, and pertinent remarks are presented on the reverse. I declare that I have knowledge of the contents of this report and am authorized by my organization to make this report, which was prepared by me or under my supervision and direction, with the data and facts stated herein to be true, correct, and complete to the best of my knowledge and belief.
Chizum Oil Completion Engineer SIGNATURE Ryan Kerr (PRINT OR TYPE) DATE 3-01-16 PHONE NUMBER 918-760-8146
P.O. Box 123 Andover KS 67002 EMAIL ADDRESS kerrred@cox.net

PLEASE TYPE OR USE BLACK INK ONLY
FORMATION RECORD

Give formation names and tops, if available, or descriptions and thickness of formations drilled through. Show intervals cored or drillstem tested.

LEASE NAME

Aunders

WELL NO.

3-18

NAMES OF FORMATIONS	TOP
Gilcrease	3,300
Miss Lime	3,410
Woodford	3,710
Wilcox	3,850

FOR COMMISSION USE ONLY

ITD on file YES NO

APPROVED _____ DISAPPROVED _____

2) Reject Codes

Were open hole logs run? yes no

Date Last log was run 1/1/2016

Was CO₂ encountered? yes no at what depths? _____

Was H₂S encountered? yes no at what depths? _____

Were unusual drilling circumstances encountered? yes no
If yes, briefly explain below

Other remarks:

640 Acres

If more than three drainholes are proposed, attach a separate sheet indicating the necessary information.

Direction must be stated in degrees azimuth. Please note, the horizontal drainhole and its end point must be located within the boundaries of the lease or spacing unit.

Directional surveys are required for all drainholes and directional wells.

640 Acres

BOTTOM HOLE LOCATION FOR DIRECTIONAL HOLE

SEC	TWP	RGE	COUNTY							
Spot Location				1/4	1/4	1/4	1/4	Feet From 1/4 Sec Lines	FSL	FWL
Measured Total Depth				True Vertical Depth		BHL From Lease, Unit, or Property Line:				

BOTTOM HOLE LOCATION FOR HORIZONTAL HOLE: (LATERALS)

LATERAL #1

SEC	TWP	RGE	COUNTY							
Spot Location				1/4	1/4	1/4	1/4	Feet From 1/4 Sec Lines	FSL	FWL
Depth of Deviation				Radius of Turn		Direction		Total Length		
Measured Total Depth				True Vertical Depth		BHL From Lease, Unit, or Property Line:				

LATERAL #2

SEC	TWP	RGE	COUNTY							
Spot Location				1/4	1/4	1/4	1/4	Feet From 1/4 Sec Lines	FSL	FWL
Depth of Deviation				Radius of Turn		Direction		Total Length		
Measured Total Depth				True Vertical Depth		BHL From Lease, Unit, or Property Line:				

LATERAL #3

SEC	TWP	RGE	COUNTY							
Spot Location				1/4	1/4	1/4	1/4	Feet From 1/4 Sec Lines	FSL	FWL
Depth of Deviation				Radius of Turn		Direction		Total Length		
Measured Total Depth				True Vertical Depth		BHL From Lease, Unit, or Property Line:				