

Oklahoma Corporation Commission
 Oil & Gas Conservation Division
 Post Office Box 52000
 Oklahoma City, Oklahoma 73152-2000
 Rule 165: 10-3-25

Form 1002A

API No.: 35125238920000

Completion Report

Spud Date: July 15, 2015

OTC Prod. Unit No.:

Drilling Finished Date: July 26, 2015

1st Prod Date: August 01, 2016

Completion Date: August 01, 2016

Drill Type: STRAIGHT HOLE

Well Name: SHAWNEE 4-18

Purchaser/Measurer:

Location: POTTAWATOMIE 18 9N 2E
 C S2 SW NE
 330 FSL 660 FWL of 1/4 SEC
 Derrick Elevation: 928 Ground Elevation: 918

First Sales Date:

Operator: CANNON OPERATING CO LLC 23102

3200 BROADWAY BLVD STE 520
 GARLAND, TX 75043-2500

Completion Type	
X	Single Zone
	Multiple Zone
	Commingled

Location Exception	
Order No	
There are no Location Exception records to display.	

Increased Density	
Order No	
There are no Increased Density records to display.	

Casing and Cement							
Type	Size	Weight	Grade	Feet	PSI	SAX	Top of CMT
SURFACE	8 5/8		J-55	450		300	SURFACE
PRODUCTION	5 1/2	17	J-55	5556	4900	325	4718

Liner								
Type	Size	Weight	Grade	Length	PSI	SAX	Top Depth	Bottom Depth
There are no Liner records to display.								

Total Depth: 5570

Packer	
Depth	Brand & Type
There are no Packer records to display.	

Plug	
Depth	Plug Type
There are no Plug records to display.	

Initial Test Data										
Test Date	Formation	Oil BBL/Day	Oil-Gravity (API)	Gas MCF/Day	Gas-Oil Ratio Cu FT/BBL	Water BBL/Day	Pumpin or Flowing	Initial Shut-In Pressure	Choke Size	Flow Tubing Pressure
Aug 01, 2016	HUNTON	16	23			35	PUMPING	50		

Completion and Test Data by Producing Formation

Formation Name: HUNTON

Code: 269HNTN

Class: OIL

Spacing Orders

Order No	Unit Size
641347	80

Perforated Intervals

From	To
5520	5560

Acid Volumes

10,000 GALLONS

Fracture Treatments

There are no Fracture Treatments records to display.
--

Formation	Top
OSWEGO	5105
SKINNER	5232
BARTLESVILLE	5453
WOODFORD	5487
HUNTON	5541

Were open hole logs run? No

Date last log run:

Were unusual drilling circumstances encountered? No

Explanation:

Other Remarks

OCC - OPERATOR HAD TANK BATTERY FIRE, DELAYED COMPLETION.

FOR COMMISSION USE ONLY

1135368

Status: Accepted

RECEIVED

Form 1002A Rev. 2009

DEC 09 2016

OKLAHOMA CORPORATION COMMISSION

API NO. 125-23892
OTC PROD.
UNIT NO.

PLEASE TYPE OR USE BLACK INK ONLY
NOTE:

Attach copy of original 1002A if recompletion or reentry.

OKLAHOMA CORPORATION COMMISSION
Oil & Gas Conservation Division
Post Office Box 52000
Oklahoma City, Oklahoma 73152-2000
Rule 165:10-3-25

ORIGINAL
 AMENDED (Reason)

COMPLETION REPORT

TYPE OF DRILLING OPERATION

STRAIGHT HOLE DIRECTIONAL HOLE HORIZONTAL HOLE
 SERVICE WELL

If directional or horizontal, see reverse for bottom hole location.

COUNTY Pottawatomie SEC 18 TWP 9N RGE 2E
LEASE NAME Shawnee WELL NO. 4-18
C 1/4 S/2 1/4 SW 1/4 NE 1/4 FSL OF 1/4 SEC 330 FWL OF 1/4 SEC 660
ELEVATIO N Derrick 928 Ground 918 Latitude (if known)
OPERATOR NAME Cannon Operating Co OTC/OCC OPERATOR NO. 23102
ADDRESS 3200 Broadway BLVD STE 520
CITY Garland STATE TX ZIP 75043

SPUD DATE 7/15/2015
DRLG FINISHED DATE 7/26/15
DATE OF WELL COMPLETION 8/1/2016
1st PROD DATE 8/1/2016
RECOMP DATE

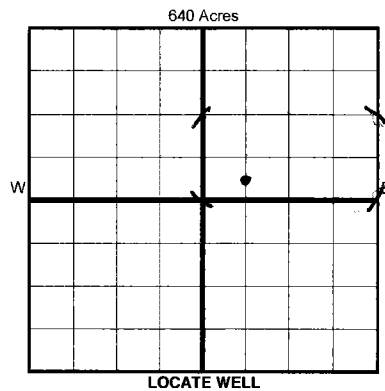

COMPLETION TYPE

SINGLE ZONE
 MULTIPLE ZONE
Application Date
 COMMINGLED
Application Date
LOCATION EXCEPTION ORDER INCREASED DENSITY ORDER NO.

CASING & CEMENT (Form 1002C must be attached)

TYPE	SIZE	WEIGHT	GRADE	FEET	PSI	SAX	TOP OF CMT
CONDUCTOR							
SURFACE	4 1/2		J-55	450		300	Surf
INTERMEDIATE	3 1/2		J-55	5556	4900	325	4718
PRODUCTION	5/2	17	J-55	5556	4900	325	4718
LINER							

PACKER @ _____ BRAND & TYPE _____ PLUG @ _____ TYPE _____ PLUG @ _____ TYPE _____
PACKER @ _____ BRAND & TYPE _____ PLUG @ _____ TYPE _____ PLUG @ _____ TYPE _____
TOTAL DEPTH ~~5570~~ 5570

COMPLETION & TEST DATA BY PRODUCING FORMATION 269 HNTN

FORMATION	Hutton						No Frac
SPACING & SPACING ORDER NUMBER	641347 (80)						
CLASS: Oil, Gas, Dry, Inj, Disp, Comm Disp, Svc	OIL						
PERFORATED INTERVALS	5520-30 5539-60						
ACID/VOLUME	10,000 GAL						
FRACTURE TREATMENT (Fluids/Prop Amounts)							

Min Gas Allowable (165:10-17-7) OR Oil Allowable (165:10-13-3)
Gas Purchaser/Measurer _____
First Sales Date _____

INITIAL TEST DATA

INITIAL TEST DATE	8/1/2016						
OIL-BBL/DAY	16						
OIL-GRAVITY (API)	23						
GAS-MCF/DAY	N/A						
GAS-OIL RATIO CU FT/BBL							
WATER-BBL/DAY	35						
PUMPING OR FLOWING	Pumping						
INITIAL SHUT-IN PRESSURE	50						
CHOKE SIZE	NA						
FLOW TUBING PRESSURE	NA						

AS SUBMITTED

A record of the formations drilled through, and pertinent remarks are presented on the reverse. I declare that I have knowledge of the contents of this report and am authorized by my organization to make this report, which was prepared by me or under my supervision and direction, with the data and facts stated herein to be true, correct, and complete to the best of my knowledge and belief.
SIGNATURE: [Signature] NAME (PRINT OR TYPE) James Gaffney DATE 10/24/2016 PHONE NUMBER 9185279247
ADDRESS 152 W Beech St CITY Slaton STATE OK ZIP 74070 EMAIL ADDRESS James.gaff@gmail.com

PLEASE TYPE OR USE BLACK INK ONLY
FORMATION RECORD

Give formation names and tops, if available, or descriptions and thickness of formations drilled through. Show intervals cored or drillstem tested.

LEASE NAME Shawnee WELL NO. 4-18

NAMES OF FORMATIONS	TOP
Oswego	5105
Skinner	5232
BaerHesville	5453
Woodford	5487
Hunton	5541

FOR COMMISSION USE ONLY

ITD on file YES NO

APPROVED _____ DISAPPROVED _____

2) Reject Codes _____

Were open hole logs run? ___ yes X no

Date Last log was run _____

Was CO₂ encountered? ___ yes X no at what depths? _____

Was H₂S encountered? ___ yes X no at what depths? _____

Were unusual drilling circumstances encountered? ___ yes X no

If yes, briefly explain below _____

Other remarks: OCC Operator had tank battery fire delayed completion

640 Acres

If more than three drainholes are proposed, attach a separate sheet indicating the necessary information.

Direction must be stated in degrees azimuth. Please note, the horizontal drainhole and its end point must be located within the boundaries of the lease or spacing unit.

Directional surveys are required for all drainholes and directional wells.

640 Acres

BOTTOM HOLE LOCATION FOR DIRECTIONAL HOLE

SEC	TWP	RGE	COUNTY
Spot Location			
1/4	1/4	1/4	1/4
Measured Total Depth		True Vertical Depth	BHL From Lease, Unit, or Property Line:
Feet From 1/4 Sec Lines		FSL	FWL

BOTTOM HOLE LOCATION FOR HORIZONTAL HOLE: (LATERALS)

LATERAL #1

SEC	TWP	RGE	COUNTY
Spot Location			
1/4	1/4	1/4	1/4
Measured Total Depth		True Vertical Depth	BHL From Lease, Unit, or Property Line:
Depth of Deviation		Radius of Turn	Direction
Total Length		FSL	

LATERAL #2

SEC	TWP	RGE	COUNTY
Spot Location			
1/4	1/4	1/4	1/4
Measured Total Depth		True Vertical Depth	BHL From Lease, Unit, or Property Line:
Depth of Deviation		Radius of Turn	Direction
Total Length		FSL	

LATERAL #3

SEC	TWP	RGE	COUNTY
Spot Location			
1/4	1/4	1/4	1/4
Measured Total Depth		True Vertical Depth	BHL From Lease, Unit, or Property Line:
Depth of Deviation		Radius of Turn	Direction
Total Length		FSL	