

Oklahoma Corporation Commission
Oil & Gas Conservation Division
Post Office Box 52000
Oklahoma City, Oklahoma 73152-2000
Rule 165: 10-3-25

Form 1002A

API No.: 35059213900001

Completion Report

Spud Date: March 08, 1986

OTC Prod. Unit No.:

Drilling Finished Date: March 30, 1986

Amended

1st Prod Date: May 21, 1986

Amend Reason: RAN AND CEMENTED 7" LINER

Completion Date: April 14, 1986

Recomplete Date: August 10, 2016

Drill Type: STRAIGHT HOLE

Well Name: WOODWARD IODINE 22

Purchaser/Measurer:

Location: HARPER 14 25N 20W
NE SW SW SE
492 FSL 577 FWL of 1/4 SEC
Derrick Elevation: 1993 Ground Elevation: 1970

First Sales Date:

Operator: WOODWARD IODINE CORPORATION 12837
PO BOX 1245
205865 ECR 32
WOODWARD, OK 73802-1245

Completion Type	
X	Single Zone
	Multiple Zone
	Commingled

Location Exception	
Order No	
There are no Location Exception records to display.	

Increased Density	
Order No	
There are no Increased Density records to display.	

Casing and Cement							
Type	Size	Weight	Grade	Feet	PSI	SAX	Top of CMT
CONDUCTOR	20		X-42	115		297	SURFACE
SURFACE	13.375	61	J-55	1049		1000	SURFACE
PRODUCTION	8.625	36	L & S-80	7162		775	4750

Liner								
Type	Size	Weight	Grade	Length	PSI	SAX	Top Depth	Bottom Depth
LINER	7	26	J-55	0	0	270	SURFACE	6777

Total Depth: 7190

Packer	
Depth	Brand & Type
There are no Packer records to display.	

Plug	
Depth	Plug Type
There are no Plug records to display.	

Initial Test Data

Test Date	Formation	Oil BBL/Day	Oil-Gravity (API)	Gas MCF/Day	Gas-Oil Ratio Cu FT/BBL	Water BBL/Day	Pumpin or Flowing	Initial Shut-In Pressure	Choke Size	Flow Tubing Pressure
May 21, 1986	MORROW			126		6000	REDA			

Completion and Test Data by Producing Formation

Formation Name: MORROW

Code: 402MRRW

Class: GAS

Spacing Orders

Order No

Unit Size

There are no Spacing Order records to display.

Perforated Intervals

From

To

6888

7010

Acid Volumes

16,500 GALLONS 10% HCL

Fracture Treatments

There are no Fracture Treatments records to display.

Formation	Top
TORONTO LIME	5265
DOUGLAS SAND	5377
OSWEGO LIME	6350
INOLA LIME	6704
MORROW SHALE	6784
MORROW GAS SAND	6850
MORROW BRINE SAND	6886
CHESTER LIME	7028

Were open hole logs run? Yes

Date last log run: March 26, 1986

Were unusual drilling circumstances encountered? No

Explanation:

Other Remarks

OCC - THIS WELL IS OPERATED FOR BRINE FROM THE MORROW FOR IODINE. THE WELL DOES MAKE A BY PRODUCT OF GAS, AND THEREFORE IS CLASSIFIED AS GAS.

FOR COMMISSION USE ONLY

1135285

Status: Accepted

RECEIVED

Form 1002A Rev. 2009

DEC 02 2016

OKLAHOMA CORPORATION COMMISSION

API NO. 059 21390
OTC PROD. UNIT NO.

PLEASE TYPE OR USE BLACK INK ONLY
NOTE:

Attach copy of original 1002A if recompletion or reentry.

OKLAHOMA CORPORATION COMMISSION
Oil & Gas Conservation Division
Post Office Box 52000
Oklahoma City, Oklahoma 73152-2000
Rule 165:10-3-25

ORIGINAL
 AMENDED (Reason)

Ran & Cemented 7" liner

COMPLETION REPORT

TYPE OF DRILLING OPERATION
 STRAIGHT HOLE DIRECTIONAL HOLE HORIZONTAL HOLE
 SERVICE WELL

SPUD DATE 3-8-1986
DRLG FINISHED DATE 3-30-1986
DATE OF WELL COMPLETION 4-14-1986
1st PROD DATE 5-21-1986
RECOMP DATE 8-10-2016
Longitude (if known)
OTC/OCC OPERATOR NO. 12837 0

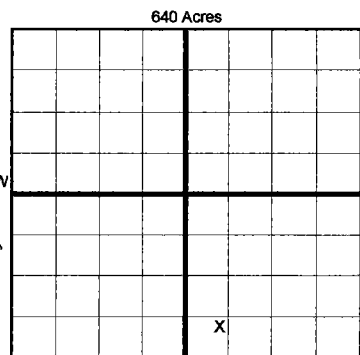

If directional or horizontal, see reverse for bottom hole location.

COUNTY Harper SEC 14 TWP 25N RGE 20W
LEASE NAME Woodward Iodine WELL NO. 22
NE 1/4 SW 1/4 SW 1/4 SE 1/4 FSL OF 1/4 SEC 492 FWL OF 1/4 SEC 577
ELEVATIO N Derrick 1993' Ground 1970' Latitude (if known)
OPERATOR NAME Woodward Iodine Corp. ADDRESS P.O. Box 1245
CITY Woodward STATE Ok ZIP 73802

COMPLETION TYPE
 SINGLE ZONE
 MULTIPLE ZONE
Application Date
 COMMINGLED
Application Date
LOCATION
EXCEPTION ORDER
INCREASED DENSITY
ORDER NO.

CASING & CEMENT (Form 1002C must be attached)

TYPE	SIZE	WEIGHT	GRADE	FEET	PSI	SAX	TOP OF CMT
CONDUCTOR	20"		X-42	115'		297	Surface
SURFACE	13.375	61#	J-55	1049'		1000	Surface
INTERMEDIATE							
PRODUCTION	8.625	36#	L&S 80	7162'		775	4750'
LINER	7"	26#	J-55	6777' - surface		270	Surface
TOTAL DEPTH							7190'

PACKER @ _____ BRAND & TYPE _____ PLUG @ _____ TYPE _____ PLUG @ _____ TYPE _____
PACKER @ _____ BRAND & TYPE _____ PLUG @ _____ TYPE _____ PLUG @ _____ TYPE _____

COMPLETION & TEST DATA BY PRODUCING FORMATION 402 MRRW

FORMATION	SPACING & SPACING ORDER NUMBER	CLASS: Oil, Gas, Dry, Inj, Disp, Comm Disp, Svc	PERFORATED INTERVALS	ACID/VOLUME	FRACTURE TREATMENT (Fluids/Prop Amounts)
Morrow		(Brine Supply) Gas (see remarks)	6888'-7010'	16,500 gal 10% HCL	

Min Gas Allowable (165:10-17-7) OR Oil Allowable (165:10-13-3)
Gas Purchaser/Measurer _____ First Sales Date _____ None

INITIAL TEST DATA

INITIAL TEST DATE	5/21/1986
OIL-BBL/DAY	
OIL-GRAVITY (API)	
GAS-MCF/DAY	126
GAS-OIL RATIO CU FT/BBL	
WATER-BBL/DAY	6000
PUMPING OR FLOWING	Reda Pump
INITIAL SHUT-IN PRESSURE	
CHOKE SIZE	
FLOW TUBING PRESSURE	

AS SUBMITTED

A record of the formations drilled through, and pertinent remarks are presented on the reverse. I declare that I have knowledge of the contents of this report and am authorized by my organization to make this report, which was prepared by me or under my supervision and direction, with the data and facts stated herein to be true, correct, and complete to the best of my knowledge and belief.

Signature: Jack Woodard NAME (PRINT OR TYPE)
P.O. Box 1245 ADDRESS CITY Woodward STATE Ok ZIP 73802
11/28/2016 DATE PHONE NUMBER 580-254-3311
j_woodard@cneconnect.com EMAIL ADDRESS

PLEASE TYPE OR USE BLACK INK ONLY
FORMATION RECORD

Give formation names and tops, if available, or descriptions and thickness of formations drilled through. Show intervals cored or drillstem tested.

LEASE NAME Woodward Iodine WELL NO. 22

NAMES OF FORMATIONS	TOP
Toronto Lime	5265'
Douglas Sand	5377'
Oswego Lime	6350'
Inola lime	6704'
Morrow shale	6,784
Morrow Gas sand	6,850
Morrow Brine Sand	6,886
Chester Lime	7,028

FOR COMMISSION USE ONLY

ITD on file YES NO

APPROVED _____ DISAPPROVED _____

2) Reject Codes _____

Were open hole logs run? yes no

Date Last log was run 3/26/1986

Was CO₂ encountered? yes no at what depths? _____

Was H₂S encountered? yes no at what depths? _____

Were unusual drilling circumstances encountered? yes no
If yes, briefly explain below _____

Other remarks: OCC - This well is operated for brine from the Morrow for Iodine. The well does make a by product of gas and therefore is classified as gas

640 Acres

If more than three drainholes are proposed, attach a separate sheet indicating the necessary information.

Direction must be stated in degrees azimuth. Please note, the horizontal drainhole and its end point must be located within the boundaries of the lease or spacing unit.

Directional surveys are required for all drainholes and directional wells.

640 Acres

BOTTOM HOLE LOCATION FOR DIRECTIONAL HOLE

SEC	TWP	RGE	COUNTY	Feet From 1/4 Sec Lines		FSL	FWL
Spot Location	1/4	1/4	1/4	1/4			
Measured Total Depth	True Vertical Depth		BHL From Lease, Unit, or Property Line:				

BOTTOM HOLE LOCATION FOR HORIZONTAL HOLE: (LATERALS)

LATERAL #1

SEC	TWP	RGE	COUNTY	Feet From 1/4 Sec Lines		FSL	FWL
Spot Location	1/4	1/4	1/4	1/4			
Depth of Deviation	Radius of Turn		Direction		Total Length		
Measured Total Depth	True Vertical Depth		BHL From Lease, Unit, or Property Line:				

LATERAL #2

SEC	TWP	RGE	COUNTY	Feet From 1/4 Sec Lines		FSL	FWL
Spot Location	1/4	1/4	1/4	1/4			
Depth of Deviation	Radius of Turn		Direction		Total Length		
Measured Total Depth	True Vertical Depth		BHL From Lease, Unit, or Property Line:				

LATERAL #3

SEC	TWP	RGE	COUNTY	Feet From 1/4 Sec Lines		FSL	FWL
Spot Location	1/4	1/4	1/4	1/4			
Depth of Deviation	Radius of Turn		Direction		Total Length		
Measured Total Depth	True Vertical Depth		BHL From Lease, Unit, or Property Line:				

RECEIVED

Form 1002A Rev. 2009

DEC 02 2016

API NO. 059 21390
OTC PROD UNIT NO. 059-058771-1

PLEASE TYPE OR USE BLACK INK ONLY NOTE:

Attach copy of original 1002A if recompletion or reentry.

OKLAHOMA CORPORATION COMMISSION
Oil & Gas Conservation Division
Post Office Box 52000
Oklahoma City, Oklahoma 73152-2000
Rule 165.10-3-25

OKLAHOMA CORPORATION COMMISSION

ORIGINAL
 AMENDED (Reason)

Ran & Cemented 7" liner

COMPLETION REPORT

TYPE OF DRILLING OPERATION
 STRAIGHT HOLE DIRECTIONAL HOLE HORIZONTAL HOLE
 SERVICE WELL

SPUD DATE 3-8-1986

DRLG FINISHED DATE 3-30-1986

DATE OF WELL COMPLETION 4-14-1986

1st PROD DATE 5-21-1986

RECOMP DATE 8-10-2016

Longitude (if known)

OTC/OCC OPERATOR NO. 12837 0

COUNTY Harper SEC 14 TWP 25N RGE 20W

LEASE NAME Woodward Iodine WELL NO. 22

NE 1/4 SW 1/4 SW 1/4 SE 1/4 FSL OF 1/4 SEC 492 FWL OF 1/4 SEC 577

ELEVATION 1993' Ground 1970' Latitude (if known)

OPERATOR NAME Woodward Iodine Corp.

ADDRESS P.O. Box 1245

CITY Woodward STATE Ok ZIP 73802

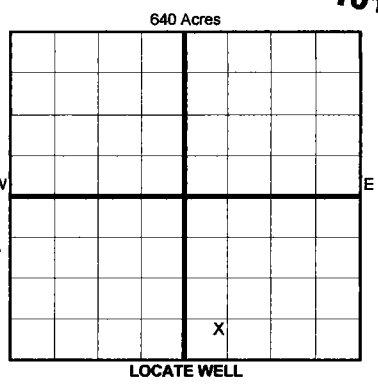

COMPLETION TYPE

Table with completion types: SINGLE ZONE (checked), MULTIPLE ZONE, COMMINGLED, LOCATION EXCEPTION ORDER, INCREASED DENSITY ORDER NO.

CASING & CEMENT (Form 1002C must be attached)

Table with columns: TYPE, SIZE, WEIGHT, GRADE, FEET, PSI, SAX, TOP OF CMT. Rows include CONDUCTOR, SURFACE, INTERMEDIATE, PRODUCTION, LINER.

PACKER @ BRAND & TYPE PLUG @ TYPE PLUG @ TYPE PLUG @ TYPE

COMPLETION & TEST DATA BY PRODUCING FORMATION (402 MRRW)

Table with columns: FORMATION, SPACING & SPACING ORDER NUMBER, PERFORATED INTERVALS, ACID/VOLUME, FRACTURE TREATMENT. Includes handwritten notes like 'Morrow', 'Brine Supply Gas', 'No Frac'.

Min Gas Allowable (165:10-17-7) OR Oil Allowable (165:10-13-3) Gas Purchaser/Measurer First Sales Date

Table with columns: INITIAL TEST DATE, OIL-BBL/DAY, GAS-MCF/DAY, GAS-OIL RATIO CU FT/BBL, WATER-BBL/DAY, PUMPING OR FLOWING, INITIAL SHUT-IN PRESSURE, CHOKER SIZE, FLOW TUBING PRESSURE. Includes handwritten data and a large 'AS SUBMITTED' stamp.

A record of the formations drilled through, and pertinent remarks are presented on the reverse. I declare that I have knowledge of the contents of this report and am authorized by my organization to make this report, which was prepared by me or under my supervision and direction, with the data and facts stated herein to be true, correct, and complete to the best of my knowledge and belief.

Signature: Jack Woodard, Date: 11/28/2016, Phone Number: 580-254-3311, Address: P.O. Box 1245, Woodward, OK 73802, Email: j_woodard@cneconnect.com

Handwritten initials 'E2'

Form 1002A