

Oklahoma Corporation Commission
 Oil & Gas Conservation Division
 Post Office Box 52000
 Oklahoma City, Oklahoma 73152-2000
 Rule 165: 10-3-25

Form 1002A

API No.: 35153235830000

Completion Report

Spud Date: August 15, 2016

OTC Prod. Unit No.: 153-217969

Drilling Finished Date: September 13, 2016

1st Prod Date: November 02, 2016

Completion Date: October 19, 2016

Drill Type: HORIZONTAL HOLE

Min Gas Allowable: Yes

Well Name: PLUMMER 2117 1H-24

Purchaser/Measurer: TARGA PIPELINE MID-CON

Location: WOODWARD 13 21N 17W
 NE SW SE SE
 465 FSL 1880 FWL of 1/4 SEC
 Latitude: 36.29138 Longitude: -98.9633
 Derrick Elevation: 1897 Ground Elevation: 1876

First Sales Date:

Operator: RED MOUNTAIN OPERATING LLC 23694

6832 N ROBINSON AVE
 OKLAHOMA CITY, OK 73116-9039

Completion Type	
X	Single Zone
	Multiple Zone
	Commingled

Location Exception	
Order No	
655887	

Increased Density	
Order No	
There are no Increased Density records to display.	

Casing and Cement							
Type	Size	Weight	Grade	Feet	PSI	SAX	Top of CMT
SURFACE	9 5/8	36	CL-80	1500		555	SURFACE
INTERMEDIATE	7	23	P-110	8871		181	7901
PRODUCTION	5 1/2 / 4 1/2	20 / 11.6	P-110	14426		571	SURFACE

Liner								
Type	Size	Weight	Grade	Length	PSI	SAX	Top Depth	Bottom Depth
There are no Liner records to display.								

Total Depth: 14380

Packer	
Depth	Brand & Type
There are no Packer records to display.	

Plug	
Depth	Plug Type
There are no Plug records to display.	

Initial Test Data

Test Date	Formation	Oil BBL/Day	Oil-Gravity (API)	Gas MCF/Day	Gas-Oil Ratio Cu FT/BBL	Water BBL/Day	Pumpin or Flowing	Initial Shut-In Pressure	Choke Size	Flow Tubing Pressure
Nov 02, 2016	MISS'AN (EX CHESTER)			449		4242	FLOWING	2242	64	145

Completion and Test Data by Producing Formation

Formation Name: MISS'AN (EX CHESTER)

Code: 359MSNLC

Class: GAS

Spacing Orders

Order No	Unit Size
655548	640

Perforated Intervals

From	To
9380	14300

Acid Volumes

2,937 BARRELS 15% HCL

Fracture Treatments

228,388 BARRELS FLUID, 5,047,120 POUNDS SAND
--

Formation	Top
DOUGLAS	5815
COTTAGE GROVE	6720
BIG LIME	7128
OSWEGO	7152
THIRTEEN FINGER	7633
CHESTER	7670
MANNING	8438
MISSISSIPPIAN	8654

Were open hole logs run? Yes

Date last log run: September 13, 2016

Were unusual drilling circumstances encountered? No

Explanation:

Other Remarks

OCC - THIS DOCUMENT IS ACCEPTED BASED ON THE DATA SUBMITTED THE FINAL LOCATION EXCEPTION HAS NOT BEEN ISSUED.

Lateral Holes

Sec: 24 TWP: 21N RGE: 17W County: WOODWARD

SE SW SE SE

93 FSL 1937 FWL of 1/4 SEC

Depth of Deviation: 8388 Radius of Turn: 912 Direction: 180 Total Length: 5272

Measured Total Depth: 14380 True Vertical Depth: 9108 End Pt. Location From Release, Unit or Property Line: 93

FOR COMMISSION USE ONLY

1135281

Status: Accepted

API NO. 153-23583
OTC PROD. UNIT NO. 153-217969

PLEASE TYPE OR USE BLACK INK ONLY
NOTE:

Attach copy of original 1002A if recompletion or reentry.

OKLAHOMA CORPORATION COMMISSION
Oil & Gas Conservation Division
Post Office Box 52000
Oklahoma City, Oklahoma 73152-2000
Rule 165:10-3-25

RECEIVED

Form 1002A
Rev. 2009

DEC 02 2016

OKLAHOMA CORPORATION COMMISSION

ORIGINAL
 AMENDED (Reason)

COMPLETION REPORT

TYPE OF DRILLING OPERATION
 STRAIGHT HOLE DIRECTIONAL HOLE HORIZONTAL HOLE
 SERVICE WELL

If directional or horizontal, see reverse for bottom hole location.

COUNTY Woodward SEC 13 TWP 21N RGE 17W
LEASE NAME Plummer 2117 WELL NO. 1H-24
NE 1/4 SW 1/4 SE 1/4 SE 1/4 FSL OF 1/4 SEC 465' FWL OF 1/4 SEC 1880'
ELEVATIO N Derrick 1897' Ground 1876' Latitude (if known) 36.29138 Longitude (if known) -98.96330
OPERATOR NAME Red Mountain Operating LLC OTC/OCC OPERATOR NO. 23694
ADDRESS 6832 N. Robinson Ave.
CITY Oklahoma City STATE OK ZIP 73116

SPUD DATE 8-15-2016
DRLG FINISHED DATE 9-13-2016
DATE OF WELL COMPLETION 10-19-2016
1st PROD DATE 11-2-2016
RECOMP DATE
Longitude (if known) -98.96330
OPERATOR NO. 23694

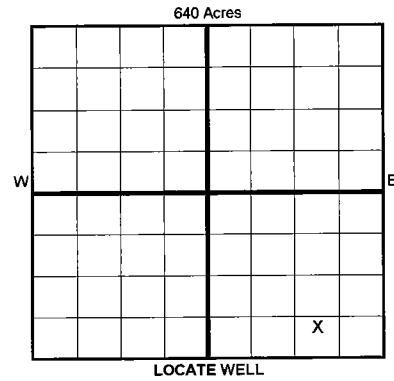

COMPLETION TYPE
 SINGLE ZONE
 MULTIPLE ZONE
LOCATION EXCEPTION ORDER NO. 655887 I.O.
 INCREASED DENSITY ORDER NO.

CASING & CEMENT (Form 1002C must be attached)

TYPE	SIZE	WEIGHT	GRADE	FEET	PSI	SAX	TOP OF CMT
CONDUCTOR							
SURFACE	9 5/8"	36#	CL-80	1500'		555	surface
INTERMEDIATE	7"	23#	P-110	8,871'		181	7901'
PRODUCTION	5 1/2"	20#	P110	8,400'			
LINER	4 1/2"	11.6#	P110	14,426'		571.5	surface
					TOTAL DEPTH		14,380'

PACKER @ _____ BRAND & TYPE _____ PLUG @ _____ TYPE _____ PLUG @ _____ TYPE _____
PACKER @ _____ BRAND & TYPE _____ PLUG @ _____ TYPE _____ PLUG @ _____ TYPE _____

COMPLETION & TEST DATA BY PRODUCING FORMATION *359 MSN LC*

FORMATION	SPACING & SPACING ORDER NUMBER	CLASS: Oil, Gas, Dry, Inj, Disp, Comm Disp, Svc	PERFORATED INTERVALS	ACID/VOLUME	FRACTURE TREATMENT (Fluids/Prop Amounts)
Mississippian (excluding Chester)	655548-640 acres	gas	9,380'-14,300'	2,937 bbl 15% HCL	228,388 bbl fluid 5,047,120 lb sand

Min Gas Allowable (165:10-17-7) OR Oil Allowable (165:10-13-3)
Gas Purchaser/Measurer Targa Pipeline Mid-con
First Sales Date

INITIAL TEST DATA

INITIAL TEST DATE	11/2/2016
OIL-BBL/DAY	0
OIL-GRAVITY (API)	
GAS-MCF/DAY	449
GAS-OIL RATIO CU FT/BBL	
WATER-BBL/DAY	4242
PUMPING OR FLOWING	flowing
INITIAL SHUT-IN PRESSURE	2242
CHOKE SIZE	64
FLOW TUBING PRESSURE	145



A record of the formations drilled through, and pertinent remarks are presented on the reverse. I declare that I have knowledge of the contents of this report and am authorized by my organization to make this report which was prepared by me or under my supervision and direction, with the data and facts stated herein to be true, correct, and complete to the best of my knowledge and belief.

Max Holloway
SIGNATURE NAME (PRINT OR TYPE) Max Holloway
11/29/2016 842-4500 X310
DATE PHONE NUMBER
6832 N. Robinson Ave Oklahoma City OK 73116 mholloway@redmountainenergy.net
ADDRESS CITY STATE ZIP EMAIL ADDRESS

PLEASE TYPE OR USE BLACK INK ONLY

FORMATION RECORD

Give formation names and tops, if available, or descriptions and thickness of formations drilled through. Show intervals cored or drillstem tested.

LEASE NAME _____

WELL NO. _____

NAMES OF FORMATIONS	TOP
Douglas	5,815
Cottage Grove	6,720
Big Lime	7128
Oswego	7,152
Thirteen Finger	7,633
Chester	7,670
Manning	8,438
Mississippian	8,654

FOR COMMISSION USE ONLY

ITD on file YES NO

APPROVED _____ DISAPPROVED _____ 2) Reject Codes _____

Were open hole logs run? yes no

Date Last log was run _____ **9/13/2016**

Was CO₂ encountered? yes no at what depths? _____

Was H₂S encountered? yes no at what depths? _____

Were unusual drilling circumstances encountered? yes no

If yes, briefly explain below.

Other remarks: _____

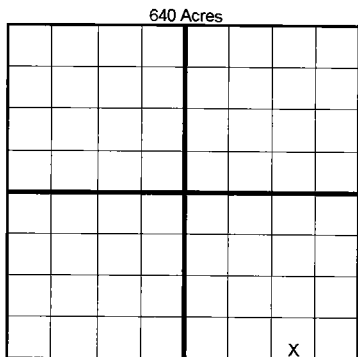

BOTTOM HOLE LOCATION FOR DIRECTIONAL HOLE

SEC	TWP	RGE	COUNTY
Spot Location	1/4	1/4	1/4
Measured Total Depth	True Vertical Depth	BHL From Lease, Unit, or Property Line:	

BOTTOM HOLE LOCATION FOR HORIZONTAL HOLE: (LATERALS)

LATERAL #1

SEC	TWP	RGE	COUNTY
24	21N	17W	Woodward
Spot Location	SE 1/4 SW 1/4 SE 1/4	Feet From 1/4 Sec Lines	FSL 93'
Depth of Deviation	8388'	Radius of Turn	912'
Measured Total Depth	14,380'	True Vertical Depth	9,108'
		BHL From Lease, Unit, or Property Line: 93'	

LATERAL #2

SEC	TWP	RGE	COUNTY
Spot Location	1/4	1/4	1/4
Depth of Deviation	Radius of Turn	Direction	Total Length
Measured Total Depth	True Vertical Depth	BHL From Lease, Unit, or Property Line:	

LATERAL #3

SEC	TWP	RGE	COUNTY
Spot Location	1/4	1/4	1/4
Depth of Deviation	Radius of Turn	Direction	Total Length
Measured Total Depth	True Vertical Depth	BHL From Lease, Unit, or Property Line:	

If more than three drainholes are proposed, attach a separate sheet indicating the necessary information.

Direction must be stated in degrees azimuth. Please note, the horizontal drainhole and its end point must be located within the boundaries of the lease or spacing unit.

Directional surveys are required for all drainholes and directional wells.

