

Oklahoma Corporation Commission
 Oil & Gas Conservation Division
 Post Office Box 52000
 Oklahoma City, Oklahoma 73152-2000
 Rule 165: 10-3-25

Form 1002A

API No.: 35071243170002

Completion Report

Spud Date: June 09, 2009

OTC Prod. Unit No.:

Drilling Finished Date: June 16, 2009

Amended

1st Prod Date: September 01, 2009

Amend Reason: PUT BACK ON PRODUCTION / SHOW PERFORATIONS

Completion Date: August 01, 2009

Recomplete Date: November 10, 2016

Drill Type: STRAIGHT HOLE

Well Name: VICKERY 1-26

Purchaser/Measurer:

Location: KAY 26 28N 4E
 W2 NE SE NE
 990 FSL 2145 FWL of 1/4 SEC
 Derrick Elevation: 0 Ground Elevation: 1150

First Sales Date:

Operator: MACKEY CONSULTING & LEASING LLC 22179
 PO BOX 490
 51110 S 36500 RD
 CLEVELAND, OK 74020-0490

Completion Type	
X	Single Zone
	Multiple Zone
	Commingled

Location Exception
Order No
There are no Location Exception records to display.

Increased Density
Order No
There are no Increased Density records to display.

Casing and Cement							
Type	Size	Weight	Grade	Feet	PSI	SAX	Top of CMT
SURFACE	8.625	27	J-55	214		150	SURFACE
PRODUCTION	5.50	17	J-55	3699		120	2750

Liner								
Type	Size	Weight	Grade	Length	PSI	SAX	Top Depth	Bottom Depth
There are no Liner records to display.								

Total Depth: 3699

Packer	
Depth	Brand & Type
There are no Packer records to display.	

Plug	
Depth	Plug Type
There are no Plug records to display.	

Initial Test Data										
Test Date	Formation	Oil BBL/Day	Oil-Gravity (API)	Gas MCF/Day	Gas-Oil Ratio Cu FT/BBL	Water BBL/Day	Pumpin or Flowing	Initial Shut-In Pressure	Choke Size	Flow Tubing Pressure
Nov 10, 2016	MISSISSIPPI LIME	2	44			7	PUMPING	400		

Completion and Test Data by Producing Formation		
Formation Name: MISSISSIPPI LIME	Code: 351MSSLM	Class: OIL
Spacing Orders		Perforated Intervals
Order No	Unit Size	From To
There are no Spacing Order records to display.		3420 2460
Acid Volumes		Fracture Treatments
1,500 GALLONS		9,000 POUNDS 20/40 SAND, 2,500 BARRELS FLUID

Formation	Top
LAYTON	2315
CHECKERBOARD	2695
BIG LIME	2830
OSWEGO	2945
MISSISSIPPI LIME	3225
SIMPSON SAND	3615
ARBUCKLE	3685

Were open hole logs run? Yes
Date last log run: June 30, 2009

Were unusual drilling circumstances encountered? No
Explanation:

Other Remarks
There are no Other Remarks.

FOR COMMISSION USE ONLY	
Status: Accepted	1135238

RECEIVED

Form 1002A Rev. 2009

NOV 28 2016

OKLAHOMA CORPORATION COMMISSION

API NO. 071-24317
OTC PROD. UNIT NO.

PLEASE TYPE OR USE BLACK INK ONLY
NOTE:

Attach copy of original 1002A if recompletion or reentry.

OKLAHOMA CORPORATION COMMISSION
Oil & Gas Conservation Division
Post Office Box 52000
Oklahoma City, Oklahoma 73152-2000
Rule 165:10-3-25

COMPLETION REPORT

ORIGINAL
 AMENDED (Reason) PUT BACK ON PRODUCTION

TYPE OF DRILLING OPERATION
 STRAIGHT HOLE DIRECTIONAL HOLE HORIZONTAL HOLE
 SERVICE WELL

If directional or horizontal, see reverse for bottom hole location.

COUNTY KAY SEC 26 TWP 28 RGE 4E
LEASE NAME VICKERY WELL NO. 1-26
DATE OF WELL COMPLETION 8-1-09
DATE OF 1st PROD DATE 9-1-09
DATE OF RECOMP DATE 11-10-16
ELEVATIO N Derrick Ground 1150 FSL OF 1/4 SEC 990 FWL OF 1/4 SEC 2145
Longitude (if known)
OPERATOR NAME MACKEY CONSULTING & LEASING LLC OTC/OCC OPERATOR NO. 22179
ADDRESS P.O. Box 490
CITY CLEVELAND STATE OK ZIP 74020

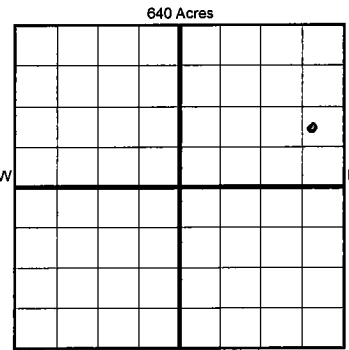

LOCATE WELL

COMPLETION TYPE

SINGLE ZONE
 MULTIPLE ZONE
Application Date
 COMMINGLED
Application Date
LOCATION
EXCEPTION ORDER
INCREASED DENSITY ORDER NO.

CASING & CEMENT (Form 1002C must be attached)

TYPE	SIZE	WEIGHT	GRADE	FEET	PSI	SAX	TOP OF CMT
CONDUCTOR							
SURFACE	8.625	27#	J55	214		150	SURF
INTERMEDIATE							
PRODUCTION	5.50	17#	J55	3699		120	2750
LINER							
						TOTAL DEPTH	3699

PACKER @ _____ BRAND & TYPE _____ PLUG @ _____ TYPE _____ PLUG @ _____ TYPE _____
PACKER @ _____ BRAND & TYPE _____ PLUG @ _____ TYPE _____ PLUG @ _____ TYPE _____

COMPLETION & TEST DATA BY PRODUCING FORMATION

FORMATION 351 MISSISSIPPI
SPACING & SPACING ORDER NUMBER UNSPACED
CLASS: Oil, Gas, Dry, Inj, Disp, Comm Disp, Svc OIL
PERFORATED INTERVALS 3420-3460
ACID/VOLUME 1500 gals
FRACTURE TREATMENT (Fluids/Prop Amounts) 9000# 20/40 sand
2500 BBLs Fluid

Min Gas Allowable (165:10-17-7) OR Oil Allowable (165:10-13-3) Gas Purchaser/Measurer First Sales Date

INITIAL TEST DATA

INITIAL TEST DATE 11-10-16
OIL-BBL/DAY 2
OIL-GRAVITY (API) 44
GAS-MCF/DAY -
GAS-OIL RATIO CU FT/BBL -
WATER-BBL/DAY 7
PUMPING OR FLOWING PUMPING
INITIAL SHUT-IN PRESSURE 400 PSI
CHOKE SIZE -
FLOW TUBING PRESSURE -

AS SUBMITTED

A record of the formations drilled through, and pertinent remarks are presented on the reverse. I declare that I have knowledge of the contents of this report and am authorized by my organization to make this report which was prepared by me or under my supervision and direction, with the data and facts stated herein to be true, correct, and complete to the best of my knowledge and belief.

SIGNATURE Mike Mackey NAME (PRINT OR TYPE) MIKEMACKEY DATE 11-20-16 PHONE NUMBER 9184304443
ADDRESS P.O. Box 490 CITY CLEVELAND STATE OK ZIP 74020 EMAIL ADDRESS MACKEY CONSULTING@yahoo.com

PLEASE TYPE OR USE BLACK INK ONLY
FORMATION RECORD

Give formation names and tops, if available, or descriptions and thickness of formations drilled through. Show intervals cored or drillstem tested.

LEASE NAME VICKERY WELL NO. 1-26

NAMES OF FORMATIONS	TOP
LAYTON	2315
CHESTERBOARD	2695
BIG LIME	2830
OSWEGO	2945
MISS LIME	3225
SIMPSON SAND	3615
ARBUCKLE	3685

FOR COMMISSION USE ONLY

ITD on file YES NO

APPROVED _____ DISAPPROVED _____

2) Reject Codes _____

Were open hole logs run? yes no

Date Last log was run 6-30-09

Was CO₂ encountered? yes no at what depths? _____

Was H₂S encountered? yes no at what depths? _____

Were unusual drilling circumstances encountered? yes no

If yes, briefly explain below _____

Other remarks: _____

640 Acres

If more than three drainholes are proposed, attach a separate sheet indicating the necessary information.

Direction must be stated in degrees azimuth. Please note, the horizontal drainhole and its end point must be located within the boundaries of the lease or spacing unit.

Directional surveys are required for all drainholes and directional wells.

640 Acres

BOTTOM HOLE LOCATION FOR DIRECTIONAL HOLE

SEC	TWP	RGE	COUNTY	Spot Location		Feet From 1/4 Sec Lines	FSL	FWL
				1/4	1/4			
Measured Total Depth		True Vertical Depth		BHL From Lease, Unit, or Property Line:				

BOTTOM HOLE LOCATION FOR HORIZONTAL HOLE: (LATERALS)

LATERAL #1

SEC	TWP	RGE	COUNTY	Spot Location		Feet From 1/4 Sec Lines	FSL	FWL
				1/4	1/4			
Depth of Deviation		Radius of Turn		Direction		Total Length		
Measured Total Depth		True Vertical Depth		BHL From Lease, Unit, or Property Line:				

LATERAL #2

SEC	TWP	RGE	COUNTY	Spot Location		Feet From 1/4 Sec Lines	FSL	FWL
				1/4	1/4			
Depth of Deviation		Radius of Turn		Direction		Total Length		
Measured Total Depth		True Vertical Depth		BHL From Lease, Unit, or Property Line:				

LATERAL #3

SEC	TWP	RGE	COUNTY	Spot Location		Feet From 1/4 Sec Lines	FSL	FWL
				1/4	1/4			
Depth of Deviation		Radius of Turn		Direction		Total Length		
Measured Total Depth		True Vertical Depth		BHL From Lease, Unit, or Property Line:				