

Oklahoma Corporation Commission
 Oil & Gas Conservation Division
 Post Office Box 52000
 Oklahoma City, Oklahoma 73152-2000
 Rule 165: 10-3-25

Form 1002A

API No.: 35063245380001

Completion Report

Spud Date: July 18, 2015

OTC Prod. Unit No.: 063-215896

Drilling Finished Date: August 27, 2015

Amended

1st Prod Date: October 24, 2016

Amend Reason: RECOMPLETED IN BOOCH

Completion Date: August 27, 2015

Recomplete Date: September 28, 2016

Drill Type: HORIZONTAL HOLE

Well Name: BRC (PEGGY 1-4H) 1-9

Purchaser/Measurer:

Location: HUGHES 9 5N 9E
 NW NE NW NW
 2470 FSL 946 FWL of 1/4 SEC
 Latitude: 36.59211 Longitude: 96.33339
 Derrick Elevation: 849 Ground Elevation: 830

First Sales Date:

Operator: TILFORD PINSON EXPLORATION LLC 19944

841 S KELLY AVE STE 130
 EDMOND, OK 73003-5278

Completion Type	
X	Single Zone
	Multiple Zone
	Commingled

Location Exception	
Order No	
655813	

Increased Density	
Order No	
651168	

Casing and Cement							
Type	Size	Weight	Grade	Feet	PSI	SAX	Top of CMT
CONDUCTOR	20			80		200	SURFACE
SURFACE	11 3/4	47	J-55	608	2000	330	SURFACE
PRODUCTION	8 5/8	32	J-55	4462	1500	650	2668

Liner								
Type	Size	Weight	Grade	Length	PSI	SAX	Top Depth	Bottom Depth
There are no Liner records to display.								

Total Depth: 5561

Packer	
Depth	Brand & Type
There are no Packer records to display.	

Plug	
Depth	Plug Type
2950	CEMENT RETAINER
4445	CIBP

Initial Test Data										
Test Date	Formation	Oil BBL/Day	Oil-Gravity (API)	Gas MCF/Day	Gas-Oil Ratio Cu FT/BBL	Water BBL/Day	Pumpin or Flowing	Initial Shut-In Pressure	Choke Size	Flow Tubing Pressure
Oct 24, 2016	BOOCH	3.9	33			10	PUMPING			

Completion and Test Data by Producing Formation														
Formation Name: BOOCH	Code: 404BOCH	Class: OIL												
<table border="1"> <thead> <tr> <th colspan="2">Spacing Orders</th> </tr> <tr> <th>Order No</th> <th>Unit Size</th> </tr> </thead> <tbody> <tr> <td>560461</td> <td>40</td> </tr> </tbody> </table>		Spacing Orders		Order No	Unit Size	560461	40	<table border="1"> <thead> <tr> <th colspan="2">Perforated Intervals</th> </tr> <tr> <th>From</th> <th>To</th> </tr> </thead> <tbody> <tr> <td>2798</td> <td>2812</td> </tr> </tbody> </table>	Perforated Intervals		From	To	2798	2812
Spacing Orders														
Order No	Unit Size													
560461	40													
Perforated Intervals														
From	To													
2798	2812													
<table border="1"> <thead> <tr> <th>Acid Volumes</th> </tr> </thead> <tbody> <tr> <td>1,000 GALLONS 10% MCA</td> </tr> </tbody> </table>		Acid Volumes	1,000 GALLONS 10% MCA	<table border="1"> <thead> <tr> <th>Fracture Treatments</th> </tr> </thead> <tbody> <tr> <td>900 BARRELS 4% KCL LINEAR GELLED WATER, 29,600 POUNDS 20/40 SAND</td> </tr> </tbody> </table>	Fracture Treatments	900 BARRELS 4% KCL LINEAR GELLED WATER, 29,600 POUNDS 20/40 SAND								
Acid Volumes														
1,000 GALLONS 10% MCA														
Fracture Treatments														
900 BARRELS 4% KCL LINEAR GELLED WATER, 29,600 POUNDS 20/40 SAND														

Formation	Top
BOOCH	2668

Were open hole logs run? No

Date last log run:

Were unusual drilling circumstances encountered? No

Explanation:

Other Remarks
LATERAL 1 HAD MECHANICAL ISSUES. SIDETRACKED WELL AND RAN INTO MORE COMPLICATIONS IN THE CURVE. SET CIBP @ 4,445' AND ABANDONED AS DRY HOLE AUGUST 27, 2015. OBTAINED PERMIT TO RECOMPLETE (APPROVED MARCH 7, 2016). PERFORATED SQUEEZE HOLES AT 2,980' - 2,982', SET 8 5/8" CEMENT RETAINER AT 2,950', SQUEEZED WITH 150 SACKS VIA TUBING. RAN CEMENT BOND LOG, TOC @ 2,668'. PERFORATED FOR PRODUCTION 2,798' - 2,804' AND 2,809' - 2,812', ACIDIZED, FRACED, PUT ON PRODUCTION VIA ROD PUMP. FRACFOCUS REPORT SUBMITTED ONLINE. THIS WELL'S PRODUCTION IS COMMINGLED AT TANK BATTERY WITH MERRIMAN 5-9 (API NUMBER 063-24508) SINCE OWNERSHIP IS SAME. BRC 1-9 IS THE SECOND BOOCH PRODUCER IN THE 40 ACRE SPACING UNIT AND SHARES THE SAME OTC PRODUCTION UNIT NUMBER.

Lateral Holes

Sec: 4 TWP: 5N RGE: 9E County: HUGHES

NE SW NW SW

1952 FSL 496 FWL of 1/4 SEC

Depth of Deviation: 4655 Radius of Turn: 1100 Direction: 359 Total Length: 1555

Measured Total Depth: 7310 True Vertical Depth: 5254 End Pt. Location From Release, Unit or Property Line: 496

Sec: 4 TWP: 5N RGE: 9E County: HUGHES

NW SE SW SW

392 FSL 950 FWL of 1/4 SEC

Depth of Deviation: 4655 Radius of Turn: 906 Direction: 359 Total Length: 0

Measured Total Depth: 5561 True Vertical Depth: 5269 End Pt. Location From Release, Unit or Property Line: 392

FOR COMMISSION USE ONLY

1135047

Status: Accepted

RECEIVED

Form 1002A Rev. 2009

NOV 10 2016

OKLAHOMA CORPORATION COMMISSION

API NO. 35-063-24538
OTC PROD UNIT NO. 063 215896

PLEASE TYPE OR USE BLACK INK ONLY
NOTE:

Attach copy of original 1002A if recompletion or reentry.

OKLAHOMA CORPORATION COMMISSION
Oil & Gas Conservation Division
Post Office Box 52000
Oklahoma City, Oklahoma 73152-2000
Rule 165:10-3-25

COMPLETION REPORT

ORIGINAL
 AMENDED (Reason)

Recompleted in Booch

TYPE OF DRILLING OPERATION

STRAIGHT HOLE DIRECTIONAL HOLE HORIZONTAL HOLE
 SERVICE WELL

If directional or horizontal, see reverse for bottom hole location.

COUNTY Hughes SEC 9 TWP 5N RGE 9E
LEASE NAME BRC (formerly Peggy 1-4H) WELL NO. 1-9
NW 1/4 NE 1/4 NW 1/4 NW 1/4 FSL OF 1/4 SEC 2470' FWL OF 1/4 SEC 946'
ELEVATIO N Derrick 849' Ground 830' Latitude (if known) 36.59211
OPERATOR NAME Tilford Pinson Exploration, LLC OTC/OCC OPERATOR NO. 19944 0
ADDRESS 841 South Kelly Avenue, Ste. 130
CITY Edmond STATE OK ZIP 73003

SPUD DATE 7/18/15
DRLG FINISHED DATE 8/27/15
DATE OF WELL COMPLETION 10/23/16
1st PROD DATE 10/24/16
RECOMP DATE 9/28/16
Longitude (if known) 96.33339

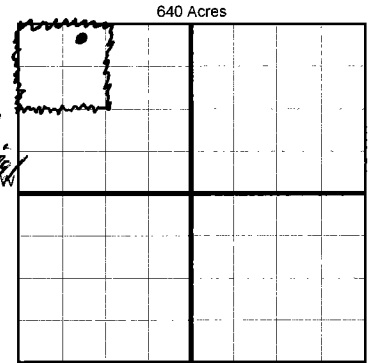

LOCATE WELL

COMPLETION TYPE

SINGLE ZONE
 MULTIPLE ZONE
Application Date
COMINGLED
Application Date
LOCATION 655813
EXCEPTION ORDER INCREASED DENSITY ORDER NO. 651168

CASING & CEMENT (Form 1002C must be attached)

TYPE	SIZE	WEIGHT	GRADE	FEET	PSI	SAX	TOP OF CMT
CONDUCTOR	20"			80'		200	surface
SURFACE	11 3/4"	47#	J-55	608'	2000	330	surface
INTERMEDIATE	8 5/8"	32#	J-55	4462'	1500	650	2668' (CBL)
PRODUCTION							
LINER							

PACKER @ _____ BRAND & TYPE _____ PLUG @ 4445' TYPE CIBP PLUG @ 2950' TYPE Cmt rtmr TOTAL DEPTH 5561'
PACKER @ _____ BRAND & TYPE _____ PLUG @ _____ TYPE _____ PLUG @ _____ TYPE _____

COMPLETION & TEST DATA BY PRODUCING FORMATION

FORMATION	Booch
SPACING & SPACING ORDER NUMBER	40 ac/560461
CLASS Oil, Gas, Dry, Inj, Disp, Comm Disp, Svc	oil
PERFORATED INTERVALS	2798'-2804' 2809'-2812'
ACID/VOLUME	10% MCA/1000 gal 900 bbl 4% KCl linear gelled wtr
FRACTURE TREATMENT (Fluids/Prop Amounts)	29,600# 20/40 sand

Monitor Report to FracFocus

Min Gas Allowable (165:10-17-7) OR Oil Allowable (165:10-13-3)
Gas Purchaser/Measurer N/A
First Sales Date N/A

INITIAL TEST DATA

INITIAL TEST DATE	10/24/2016
OIL-BBL/DAY	3.9
OIL-GRAVITY (API)	33
GAS-MCF/DAY	NM
GAS-OIL RATIO CU FT/BBL	NM
WATER-BBL/DAY	10 BLWPD
PUMPING OR FLOWING	Pumping
INITIAL SHUT-IN PRESSURE	N/A
CHOKE SIZE	None
FLOW TUBING PRESSURE	N/A

AS SUBMITTED

A record of the formations drilled through, and pertinent remarks are presented on the reverse. I declare that I have knowledge of the contents of this report and am authorized by my organization to make this report, which was prepared by me or under my supervision and direction, with the data and facts stated herein to be true, correct, and complete to the best of my knowledge and belief.

SIGNATURE: Richard A. Brown, consulting engineer
NAME (PRINT OR TYPE): Richard A. Brown, consulting engineer
DATE: 11/9/2016
PHONE NUMBER: 405-348-7201
ADDRESS: 841 South Kelly, Ste. 130
CITY: Edmond STATE: OK ZIP: 73003
EMAIL ADDRESS: max@tilfordpinson.com

PLEASE TYPE OR USE BLACK INK ONLY
FORMATION RECORD

Give formation names and tops, if available, or descriptions and thickness of formations drilled through. Show intervals cored or drillstem tested.

LEASE NAME BRC WELL NO. 1-9

NAMES OF FORMATIONS	TOP
Booch	2,668

FOR COMMISSION USE ONLY

ITD on file YES NO

APPROVED _____ DISAPPROVED _____

2) Reject Codes _____

Were open hole logs run? yes no

Date Last log was run _____

Was CO₂ encountered? yes no at what depths? _____

Was H₂S encountered? yes no at what depths? _____

Were unusual drilling circumstances encountered? yes no
If yes, briefly explain below _____

Other remarks: Lateral 1 had mechanical issues. Sidetracked well and ran into more complications in the curve. Set CIBP @ 4445' and abandoned as dry hole 8/27/15. Obtained Permit to Recomplete (approved 3/7/16).
Perf'd squeeze holes at 2980'-82', set 8 5/8" cmt retainer at 2950', sqzd w/ 150 sx via tbq. Ran CBL, TOC @ 2668'.
Perf'd for production 2798'-2804' & 2809'-2812', acidized, fraced, put on production via rod pump.
FracFocus report submitted online. This well's production is commingled at tank battery with Merriman 5-9 (API 063-24508) since ownership is same; BRC 1-9 is the second Booch producer in the 40 acre spacing unit and shares the same OTC Prod Unit No.

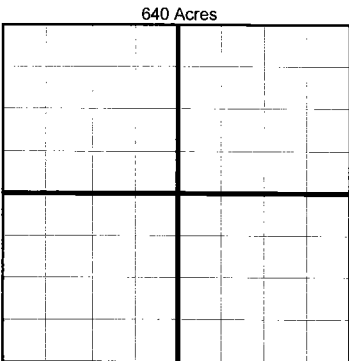

If more than three drainholes are proposed, attach a separate sheet indicating the necessary information.

Direction must be stated in degrees azimuth. Please note, the horizontal drainhole and its end point must be located within the boundaries of the lease or spacing unit.

Directional surveys are required for all drainholes and directional wells.

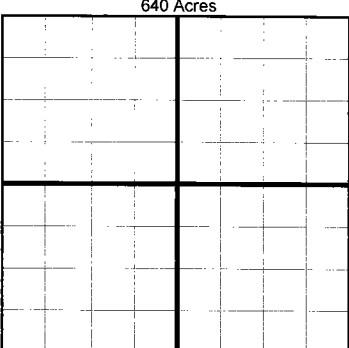

BOTTOM HOLE LOCATION FOR DIRECTIONAL HOLE

SEC	TWP	RGE	COUNTY	Spot Location	Feet From 1/4 Sec Lines	FSL	FWL
				1/4 1/4 1/4 1/4			
				Measured Total Depth	True Vertical Depth	BHL From Lease, Unit, or Property Line:	

BOTTOM HOLE LOCATION FOR HORIZONTAL HOLE: (LATERALS)

per original 1002A

LATERAL #1							
SEC	TWP	RGE	COUNTY	Spot Location	Feet From 1/4 Sec Lines	FSL	FWL
4	SN	9E	Hughes	NE 1/4 SW 1/4 NW 1/4 SW 1/4		1952	496
				Depth of Deviation	Radius of Turn	Direction	Total Length
				4655	1100	359	1555
				Measured Total Depth	True Vertical Depth	BHL From Lease, Unit, or Property Line:	
				7310	5254	496	

LATERAL #2							
SEC	TWP	RGE	COUNTY	Spot Location	Feet From 1/4 Sec Lines	FSL	FWL
4	SN	9E	Hughes	NW 1/4 SE 1/4 SW 1/4 SW 1/4		392	950
				Depth of Deviation	Radius of Turn	Direction	Total Length
				4655	906	359	0
				Measured Total Depth	True Vertical Depth	BHL From Lease, Unit, or Property Line:	
				5561	5269	392	

LATERAL #3							
SEC	TWP	RGE	COUNTY	Spot Location	Feet From 1/4 Sec Lines	FSL	FWL
				1/4 1/4 1/4 1/4			
				Depth of Deviation	Radius of Turn	Direction	Total Length
				Measured Total Depth	True Vertical Depth	BHL From Lease, Unit, or Property Line:	