

Oklahoma Corporation Commission
Oil & Gas Conservation Division
Post Office Box 52000
Oklahoma City, Oklahoma 73152-2000
Rule 165: 10-3-25

Form 1002A

API No.: 35085212720000

Completion Report

Spud Date: January 28, 2016

OTC Prod. Unit No.: 085-217868

Drilling Finished Date: June 29, 2016

1st Prod Date: October 04, 2016

Completion Date: October 04, 2016

Drill Type: HORIZONTAL HOLE

Min Gas Allowable: Yes

Well Name: RONNY 1-33H28X

Purchaser/Measurer: C P ENERGY

Location: LOVE 33 7S 2E
SE NE NE SW
2200 FSL 2570 FWL of 1/4 SEC
Derrick Elevation: 0 Ground Elevation: 839

First Sales Date: 10/04/2016

Operator: XTO ENERGY INC 21003

810 HOUSTON ST
FORT WORTH, TX 76102-6203

Completion Type	
X	Single Zone
	Multiple Zone
	Commingled

Location Exception	
Order No	
	649983
	650375

Increased Density	
Order No	
There are no Increased Density records to display.	

Casing and Cement							
Type	Size	Weight	Grade	Feet	PSI	SAX	Top of CMT
CONDUCTOR	20	169	J-55	107			SURFACE
SURFACE	9 5/8	36	J-55	2000		890	SURFACE
PRODUCTION	7	32	P-110	17080		580	13250

Liner								
Type	Size	Weight	Grade	Length	PSI	SAX	Top Depth	Bottom Depth
LINER	4 1/2	15.1	P-110	7431	0	615	15003	22434

Total Depth: 22447

Packer	
Depth	Brand & Type
There are no Packer records to display.	

Plug	
Depth	Plug Type
There are no Plug records to display.	

Initial Test Data										
Test Date	Formation	Oil BBL/Day	Oil-Gravity (API)	Gas MCF/Day	Gas-Oil Ratio Cu FT/BBL	Water BBL/Day	Pumpin or Flowing	Initial Shut-In Pressure	Choke Size	Flow Tubing Pressure
Oct 25, 2016	CANEY	620	46	1669	2692	1453	FLOWING		18/64	3700

Completion and Test Data by Producing Formation										
Formation Name: CANEY			Code: 354CNEY			Class: OIL				
Spacing Orders				Perforated Intervals						
Order No	Unit Size			From			To			
126835	640			16805			22275			
651449	MULTIUNIT									
Acid Volumes				Fracture Treatments						
112224 GALLONS				28 STAGES - 315,815 BTW, 972,480 POUNDS 100 MESH, 8,795,620 POUNDS 40/70, 4,003,160 POUNDS PRIME PLUS 40/70						

Formation	Top
CANEY	16338

Were open hole logs run? No

Date last log run:

Were unusual drilling circumstances encountered? No

Explanation:

Other Remarks
IRREGULAR SECTION. LINER STARTS @ 14,999'. RAN 4 1/2" TIE BACK LINER FROM SURFACE TO 14,999'.

Lateral Holes
Sec: 28 TWP: 7S RGE: 2E County: LOVE SW SE SW NW 2576 FNL 926 FWL of 1/4 SEC Depth of Deviation: 16080 Radius of Turn: 523 Direction: 344 Total Length: 6013 Measured Total Depth: 22447 True Vertical Depth: 16496 End Pt. Location From Release, Unit or Property Line: 2576

FOR COMMISSION USE ONLY
Status: Accepted
1134864

RECEIVED

OCT 28 2016

Form 1002A Rev. 2009

OKLAHOMA CORPORATION COMMISSION

API NO. 085-21272
OTC PROD. UNIT NO. 085-217868

PLEASE TYPE OR USE BLACK INK ONLY
NOTE:

Attach copy of original 1002A if recompletion or reentry.

OKLAHOMA CORPORATION COMMISSION
Oil & Gas Conservation Division
Post Office Box 52000
Oklahoma City, Oklahoma 73152-2000
Rule 165:10-3-25

ORIGINAL
AMENDED (Reason)

COMPLETION REPORT

TYPE OF DRILLING OPERATION
STRAIGHT HOLE
DIRECTIONAL HOLE
HORIZONTAL HOLE

SPUD DATE 1/28/2016
DRLG FINISHED DATE 6/29/16
DATE OF WELL COMPLETION 10/4/2016
1st PROD DATE 10/4/2016

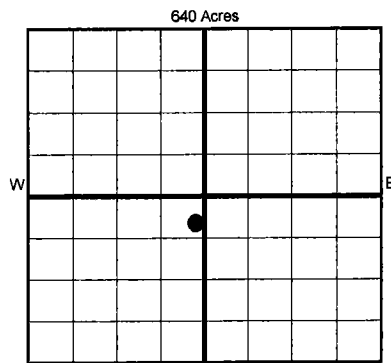

COUNTY Love SEC 33 TWP 7S RGE 2E
LEASE NAME Ronny 1-33H28X
SE 1/4 NE 1/4 NE 1/4 SW 1/4 FSL OF 1/4 SEC 2200 FWL 1/4 SEC 2570'
ELEVATION 839'
OPERATOR XTO Energy Inc.
ADDRESS 210 Park Avenue, Suite 2350
CITY Oklahoma City STATE Oklahoma ZIP 73102

COMPLETION TYPE
SINGLE ZONE
MULTIPLE ZONE
COMMINGLED
LOCATION EXCEPTION ORDER NO. 650375, 649983 I.D.

Table with columns: TYPE, SIZE, WEIGHT, GRADE, FEET, PSI, SAX, TOP OF CMT. Rows include CONDUCTOR, SURFACE, INTERMEDIATE, PRODUCTION, LINER.

PACKER @ BRAND & TYPE PLUG @ TYPE PLUG @ TYPE

COMPLETION & TEST DATA BY PRODUCING FORMATION 354 CNEY

Table with columns: FORMATION, SPACING & SPACING ORDER NUMBER, CLASS, PERFORATED INTERVALS, ACID/VOLUME, FRACTURE TREATMENT.

Min Gas Allowable (165:10-17-7)
OR
Oil Allowable (165:10-13-3)

Gas Purchaser/Measurer
First Sales Date

CP Energy - Per Debbie
10/4/2016

INITIAL TEST DATA

Table with columns: INITIAL TEST DATE, OIL-BBL/DAY, OIL-GRAVITY (API), GAS-MCF/DAY, GAS-OIL RATIO CU FT/BBL, WATER-BBL/DAY, PUMPING OR FLOWING, INITIAL SHUT-IN PRESSURE, CHOKE SIZE, FLOW TUBING PRESSURE.

AS SUBMITTED

A record of the formations drilled through, and pertinent remarks are presented on the reverse. I declare that I have knowledge of the contents of this report and am authorized by my organization to make this report, which was prepared by me or under my supervision and direction, with the data and facts stated herein to be true, correct, and complete to the best of my knowledge and belief.
Signature: Debbie Waggoner
Name: Debbie Waggoner
Date: 10/27/2016
Phone Number: 405-319-3243
Address: 210 Park Avenue, Suite 2350, Oklahoma City, OK 73102
Email Address: debbie_waggoner@xtoenergy.com

PLEASE TYPE OR USE BLACK INK ONLY
FORMATION RECORD

Give formation names and tops, if available, or descriptions and thickness of formations drilled through. Show intervals cored or drillstem tested.

LEASE NAME RONNY WELL NO. 1-33H28X

NAMES OF FORMATIONS	TOP
CANEY	16,338'

FOR COMMISSION USE ONLY

ITD on file YES NO

APPROVED _____ DISAPPROVED _____

2) Reject Codes _____

Were open hole logs run? _____ yes no

Date Last log was run _____

Was CO₂ encountered? _____ yes no at what depths? _____

Was H₂S encountered? _____ yes no at what depths? _____

Were unusual drilling circumstances encountered? _____ yes no

If yes, briefly explain below: _____

Other remarks: Irregular Section

Liner starts @ 14,999'. Ran 4 1/2" tie back liner from surface to 14,999'.

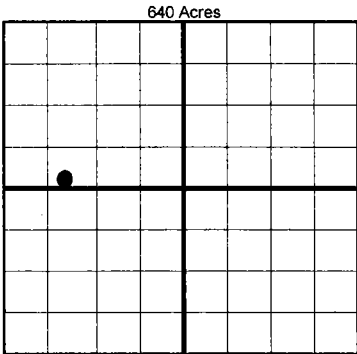

BOTTOM HOLE LOCATION FOR DIRECTIONAL HOLE

SEC	TWP	RGE	COUNTY
Spot Location			
1/4	1/4	1/4	1/4
Measured Total Depth		True Vertical Depth	BHL From Lease, Unit, or Property Line:

BOTTOM HOLE LOCATION FOR HORIZONTAL HOLE: (LATERALS)

LATERAL #1

SEC	TWP	RGE	COUNTY
28	7S	2E	Love
Spot Location			
SW 1/4	SE 1/4	SW 1/4	NW 1/4
Depth of Deviation		Radius of Turn	Direction
16,080		523.3	344.1°
Measured Total Depth		True Vertical Depth	BHL From Lease, Unit, or Property Line:
22,447		16,496	2576 FNL & 926 FWL

LATERAL #2

SEC	TWP	RGE	COUNTY
Spot Location			
1/4	1/4	1/4	1/4
Depth of Deviation		Radius of Turn	Direction
Measured Total Depth		True Vertical Depth	BHL From Lease, Unit, or Property Line:

LATERAL #3

SEC	TWP	RGE	COUNTY
Spot Location			
1/4	1/4	1/4	1/4
Depth of Deviation		Radius of Turn	Direction
Measured Total Depth		True Vertical Depth	BHL From Lease, Unit, or Property Line:

If more than three drainholes are proposed, attach a separate sheet indicating the necessary information.

Direction must be stated in degrees azimuth. Please note, the horizontal drainhole and its end point must be located within the boundaries of the lease or spacing unit.

Directional surveys are required for all drainholes and directional wells.

