

Oklahoma Corporation Commission
Oil & Gas Conservation Division
Post Office Box 52000
Oklahoma City, Oklahoma 73152-2000
Rule 165: 10-3-25

Form 1002A

API No.: 35019060580001

Completion Report

Spud Date: August 24, 1954

OTC Prod. Unit No.: 019-028650

Drilling Finished Date: August 26, 1954

1st Prod Date: September 04, 1954

Amended

Completion Date: September 04, 1954

Amend Reason: CHANGE WELL NAME / CORRECT CASING DEPTH / ADD NEW PERFORATIONS 970' - 972'

Recomplete Date: October 24, 2016

Drill Type: STRAIGHT HOLE

Well Name: OIL CITY UNIT (W E CALDWELL) 25

Purchaser/Measurer:

Location: CARTER 27 3S 2W
SW SW SW SE
165 FSL 165 FWL of 1/4 SEC
Derrick Elevation: 962 Ground Elevation: 959

First Sales Date:

Operator: KODIAK OIL & GAS INC 23226

204 N WALNUT ST
MUNSTER, TX 76252-2766

Completion Type	
X	Single Zone
	Multiple Zone
	Commingled

Location Exception
Order No
There are no Location Exception records to display.

Increased Density
Order No
There are no Increased Density records to display.

Casing and Cement							
Type	Size	Weight	Grade	Feet	PSI	SAX	Top of CMT
PRODUCTION	5 1/2			972		75	

Liner								
Type	Size	Weight	Grade	Length	PSI	SAX	Top Depth	Bottom Depth
There are no Liner records to display.								

Total Depth: 972

Packer	
Depth	Brand & Type
There are no Packer records to display.	

Plug	
Depth	Plug Type
There are no Plug records to display.	

Initial Test Data										
Test Date	Formation	Oil BBL/Day	Oil-Gravity (API)	Gas MCF/Day	Gas-Oil Ratio Cu FT/BBL	Water BBL/Day	Pumpin or Flowing	Initial Shut-In Pressure	Choke Size	Flow Tubing Pressure
Oct 24, 2016	PONTOTOC	2	22				PUMPING			

Completion and Test Data by Producing Formation										
Formation Name: PONTOTOC			Code: 419PNTC			Class: OIL				
Spacing Orders				Perforated Intervals						
Order No		Unit Size		From			To			
There are no Spacing Order records to display.				704			972			
Acid Volumes				Fracture Treatments						
There are no Acid Volume records to display.				There are no Fracture Treatments records to display.						

Formation	Top
SEE ORIGINAL	0

Were open hole logs run? Yes
Date last log run: August 26, 1954

Were unusual drilling circumstances encountered? No
Explanation:

Other Remarks
There are no Other Remarks.

FOR COMMISSION USE ONLY	
Status: Accepted	1134857

RECEIVED

Form 1002A Rev. 2009

OCT 31 2016

OKLAHOMA CORPORATION COMMISSION

API NO. 019-06058
OTC PROD. 819
UNIT NO. 228650

PLEASE TYPE OR USE BLACK INK ONLY
NOTE:

Attach copy of original 1002A if recompletion or reentry.

OKLAHOMA CORPORATION COMMISSION
Oil & Gas Conservation Division
Post Office Box 52000
Oklahoma City, Oklahoma 73152-2000
Rule 165:10-3-25

COMPLETION REPORT

ORIGINAL
 AMENDED (Reason) - CORRECT CASING DEPTH - ADD NEW PERFORATIONS

TYPE OF DRILLING OPERATION
 STRAIGHT HOLE DIRECTIONAL HOLE HORIZONTAL HOLE
 SERVICE WELL

SPUD DATE 8/24/54
DRLG FINISHED DATE 8/26/54

COUNTY CARTER SEC 27 TWP 35 RGE 2W

DATE OF WELL COMPLETION 9/4/54

LEASE NAME OIL CITY UNIT

WELL NO. 25

1st PROD DATE 9/4/54

SW 1/4 SW 1/4 SW 1/4 SE 1/4

FSL OF 1/4 SEC 165

FWL OF 1/4 SEC 165

RECOMP DATE 10/24/16

ELEVATIO N Demick 962 Ground 959

Latitude (if known)

Longitude (if known)

OPERATOR NAME KODIAK OIL & GAS, INC.

OTC/OCC OPERATOR NO. 23226-0

ADDRESS 204 N. WALNUT ST.

CITY MÜNSTER

STATE TX

ZIP 76252

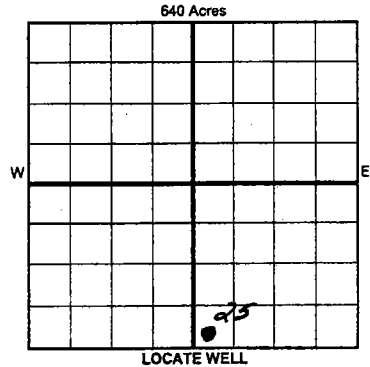

COMPLETION TYPE

SINGLE ZONE
 MULTIPLE ZONE
Application Date
 COMMINGLED
Application Date
LOCATION
EXCEPTION ORDER
INCREASED DENSITY
ORDER NO.

CASING & CEMENT (Form 1002C must be attached)

TYPE	SIZE	WEIGHT	GRADE	FEET	PSI	SAX	TOP OF CMT
CONDUCTOR							
SURFACE							
INTERMEDIATE							
PRODUCTION	5 1/2			972		75	
LINER							

PACKER @ _____ BRAND & TYPE _____ PLUG @ _____ TYPE _____ PLUG @ _____ TYPE _____
PACKER @ _____ BRAND & TYPE _____ PLUG @ _____ TYPE _____ PLUG @ _____ TYPE _____

TOTAL DEPTH 972

COMPLETION & TEST DATA BY PRODUCING FORMATION 419 PNTC

FORMATION	SPACING & SPACING ORDER NUMBER	CLASS: Oil, Gas, Dry, Inj, Disp, Comm Disp, Svc	PERFORATED INTERVALS	ACID/VOLUME	FRACTURE TREATMENT (Fluids/Prop Amounts)
PONTOTOC		OIL	704-717 812-28 970-972		

Min Gas Allowable (165:10-17-7) OR Oil Allowable (165:10-13-3)
Gas Purchaser/Measurer _____ First Sales Date _____

INITIAL TEST DATA

INITIAL TEST DATE	10/24/16
OIL-BBL/DAY	2
OIL-GRAVITY (API)	22
GAS-MCF/DAY	
GAS-OIL RATIO CU FT/BBL	
WATER-BBL/DAY	
PUMPING OR FLOWING	Pumping
INITIAL SHUT-IN PRESSURE	
CHOKE SIZE	
FLOW TUBING PRESSURE	

AS SUBMITTED

A record of the formations drilled through and pertinent remarks are presented on the reverse. I declare that I have knowledge of the contents of this report and am authorized by my organization to make this report, which was prepared by me or under my supervision and direction, with the data and facts stated herein to be true, correct, and complete to the best of my knowledge and belief.

SIGNATURE JOHN R. LAWS DATE 10/24/16 PHONE NUMBER 580-220-8455
ADDRESS 1515 WARD RD., ARDMORE OK. 73401 EMAIL ADDRESS JRLAWS@HOTMAIL.COM

PLEASE TYPE OR USE BLACK INK ONLY
FORMATION RECORD

Give formation names and tops, if available, or descriptions and thickness of formations drilled through. Show intervals cored or drillstem tested.

LEASE NAME OIL CITY UNIT WELL NO. 25

NAMES OF FORMATIONS	TOP
<i>SEE ORIGINAL</i>	

FOR COMMISSION USE ONLY

ITD on file YES NO

APPROVED _____ DISAPPROVED _____

2) Reject Codes

Were open hole logs run? yes no

Date Last log was run 8/26/54

Was CO₂ encountered? yes no at what depths? _____

Was H₂S encountered? yes no at what depths? _____

Were unusual drilling circumstances encountered? yes no
If yes, briefly explain below

Other remarks:

640 Acres

If more than three drainholes are proposed, attach a separate sheet indicating the necessary information.

Direction must be stated in degrees azimuth. Please note, the horizontal drainhole and its end point must be located within the boundaries of the lease or spacing unit.

Directional surveys are required for all drainholes and directional wells.

640 Acres

BOTTOM HOLE LOCATION FOR DIRECTIONAL HOLE

SEC	TWP	RGE	COUNTY							
Spot Location				1/4	1/4	1/4	1/4	Feet From 1/4 Sec Lines	FSL	FWL
Measured Total Depth			True Vertical Depth		BHL From Lease, Unit, or Property Line:					

BOTTOM HOLE LOCATION FOR HORIZONTAL HOLE: (LATERALS)

LATERAL #1

SEC	TWP	RGE	COUNTY							
Spot Location				1/4	1/4	1/4	1/4	Feet From 1/4 Sec Lines	FSL	FWL
Depth of Deviation		Radius of Turn		Direction		Total Length				
Measured Total Depth			True Vertical Depth		BHL From Lease, Unit, or Property Line:					

LATERAL #2

SEC	TWP	RGE	COUNTY							
Spot Location				1/4	1/4	1/4	1/4	Feet From 1/4 Sec Lines	FSL	FWL
Depth of Deviation		Radius of Turn		Direction		Total Length				
Measured Total Depth			True Vertical Depth		BHL From Lease, Unit, or Property Line:					

LATERAL #3

SEC	TWP	RGE	COUNTY							
Spot Location				1/4	1/4	1/4	1/4	Feet From 1/4 Sec Lines	FSL	FWL
Depth of Deviation		Radius of Turn		Direction		Total Length				
Measured Total Depth			True Vertical Depth		BHL From Lease, Unit, or Property Line:					