

Oklahoma Corporation Commission  
Oil & Gas Conservation Division  
Post Office Box 52000  
Oklahoma City, Oklahoma 73152-2000  
Rule 165: 10-3-25

Form 1002A

API No.: 35087220470001

**Completion Report**

Spud Date: June 01, 2016

OTC Prod. Unit No.: 087-217784

Drilling Finished Date: June 10, 2016

1st Prod Date: August 25, 2016

Completion Date: October 14, 2016

**Drill Type: STRAIGHT HOLE**

Well Name: J R RANCH 1-19

Purchaser/Measurer: ONEOK

Location: MCCLAIN 19 6N 2W  
SE SW SE SW  
250 FSL 820 FEL of 1/4 SEC  
Latitude: 34.97231 Longitude: -97.45322  
Derrick Elevation: 1099 Ground Elevation: 1084

First Sales Date: 08/27/2016

Operator: CHARTER OAK PRODUCTION CO LLC 21672

13929 QUAIL POINTE DR  
OKLAHOMA CITY, OK 73134-1037

Completion Type	
X	Single Zone
	Multiple Zone
	Commingled

Location Exception	
Order No	
654624	

Increased Density	
Order No	
There are no Increased Density records to display.	

Casing and Cement							
Type	Size	Weight	Grade	Feet	PSI	SAX	Top of CMT
CONDUCTOR	16			40			SURFACE
SURFACE	8 5/8	24	J-55	418		200	SURFACE
PRODUCTION	5 1/2	17	P-110	8887		400	6262

Liner								
Type	Size	Weight	Grade	Length	PSI	SAX	Top Depth	Bottom Depth
There are no Liner records to display.								

**Total Depth: 8900**

Packer	
Depth	Brand & Type
There are no Packer records to display.	

Plug	
Depth	Plug Type
8750	CIBP
8764	CIBP
8790	CIBP

Initial Test Data										
Test Date	Formation	Oil BBL/Day	Oil-Gravity (API)	Gas MCF/Day	Gas-Oil Ratio Cu FT/BBL	Water BBL/Day	Pumpin or Flowing	Initial Shut-In Pressure	Choke Size	Flow Tubing Pressure
Aug 20, 2016	BROMIDE MASSIVE					23	SWAB			
Oct 14, 2016	1ST BROMIDE	160	30	127	794	8	PUMPING	800		

Completion and Test Data by Producing Formation										
Formation Name: BROMIDE MASSIVE			Code: 202BRMMS			Class: DRY				
<b>Spacing Orders</b>				<b>Perforated Intervals</b>						
<b>Order No</b>	<b>Unit Size</b>			<b>From</b>	<b>To</b>					
62546	80			8755	8757					
				8777	8779					
				8796	8800					
<b>Acid Volumes</b>				<b>Fracture Treatments</b>						
There are no Acid Volume records to display.				There are no Fracture Treatments records to display.						

Formation Name: 1ST BROMIDE			Code: 202BRMD1			Class: OIL				
<b>Spacing Orders</b>				<b>Perforated Intervals</b>						
<b>Order No</b>	<b>Unit Size</b>			<b>From</b>	<b>To</b>					
54965	80			8708	8710					
<b>Acid Volumes</b>				<b>Fracture Treatments</b>						
There are no Acid Volume records to display.				There are no Fracture Treatments records to display.						

Formation	Top
BASAL PENN	7610
WOODFORD	7736
HUNTON	7785
SYLVAN	8080
VIOLA	8216
1ST BROMIDE	8706
MASSIVE BROMIDE	8748

Were open hole logs run? Yes  
Date last log run: June 11, 2016

Were unusual drilling circumstances encountered? No  
Explanation:

Other Remarks
There are no Other Remarks.

**FOR COMMISSION USE ONLY**

1134849

Status: Accepted

RECEIVED

Form 1002A Rev. 2009

OCT 28 2016

OKLAHOMA CORPORATION COMMISSION

API NO. 35-087-22047  
OTC PROD. UNIT NO. 087-217784

PLEASE TYPE OR USE BLACK INK ONLY  
NOTE:

Attach copy of original 1002A if recompletion or reentry.

OKLAHOMA CORPORATION COMMISSION  
Oil & Gas Conservation Division  
Post Office Box 52000  
Oklahoma City, Oklahoma 73152-2000  
Rule 165:10-3-25

ORIGINAL  
 AMENDED (Reason)

COMPLETION REPORT

TYPE OF DRILLING OPERATION

STRAIGHT HOLE  DIRECTIONAL HOLE  HORIZONTAL HOLE  
 SERVICE WELL

If directional or horizontal, see reverse for bottom hole location.

SPUD DATE 6/1/16  
DRLG FINISHED DATE 6/10/16  
DATE OF WELL COMPLETION 10/14/16  
1st PROD DATE 8/25/16  
RECOMP DATE  
ELEVATION N Derrick 1099' Ground 1084'  
Latitude (if known) 34.97231 Longitude (if known) -97.45322  
OPERATOR NAME Charter Oak Production Co., LLC OTC/OCC OPERATOR NO. 21672  
ADDRESS 13929 Quail Pointe Dr.  
CITY Oklahoma City STATE OK ZIP 73134

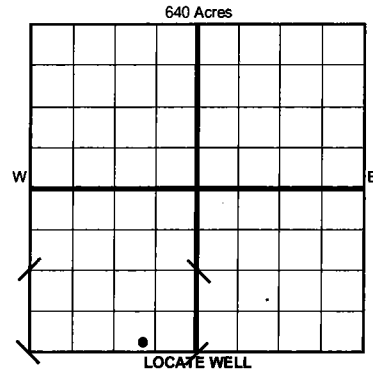

COMPLETION TYPE

SINGLE ZONE  
 MULTIPLE ZONE  
 COMMINGLED  
LOCATION 654624  
EXCEPTION ORDER  
INCREASED DENSITY ORDER NO. N/A

CASING & CEMENT (Form 1002C must be attached)

TYPE	SIZE	WEIGHT	GRADE	FEET	PSI	SAX	TOP OF CMT
CONDUCTOR	16"			40'			Surface
SURFACE	8 5/8"	24#	J-55	418'		200	Surface
INTERMEDIATE							
PRODUCTION	5 1/2"	17#	P-110	8887'		400	6262'
LINER							

PACKER @ \_\_\_\_\_ BRAND & TYPE \_\_\_\_\_ PLUG @ 8750' TYPE CIBP \_\_\_\_\_ PLUG @ 8790' TYPE CIBP \_\_\_\_\_ TOTAL DEPTH 8900'  
PACKER @ \_\_\_\_\_ BRAND & TYPE \_\_\_\_\_ PLUG @ 8764' TYPE CIBP \_\_\_\_\_ PLUG @ \_\_\_\_\_ TYPE \_\_\_\_\_

COMPLETION & TEST DATA BY PRODUCING FORMATION *202 BRMMS 202 BRMD1*

FORMATION	Massive Bromide	1st Bromide Sand					
SPACING & SPACING ORDER NUMBER	80 Ac. - 62546	80 Ac. - 54965					No Frac
CLASS: Oil, Gas, Dry, Inj, Disp, Comm Disp, Svc	Dry	Oil					
PERFORATED INTERVALS	8755' - 8757'	8708' - 8710'					
	8777' - 8779'						
	8796' - 8800'						
ACID/VOLUME	N/A	N/A					
FRACTURE TREATMENT (Fluids/Prop Amounts)	N/A	N/A					

Min Gas Allowable (165:10-17-7) OR  Oil Allowable (165:10-13-3)  
Gas Purchaser/Measurer \_\_\_\_\_ ONEOK  
First Sales Date 8/27/16

INITIAL TEST DATA

INITIAL TEST DATE	8/20/16	10/14/16					
OIL-BBL/DAY	0	160					
OIL-GRAVITY ( API)	N/A	30.0					
GAS-MCF/DAY	0	127					
GAS-OIL RATIO CU FT/BBL	N/A	794					
WATER-BBL/DAY	23	8					
PUMPING OR FLOWING	Swab	Pumping					
INITIAL SHUT-IN PRESSURE	0 psi	800 psi					
CHOKE SIZE	N/A	N/A					
FLOW TUBING PRESSURE	N/A	N/A					

**AS SUBMITTED**

A record of the formations drilled through, and pertinent remarks are presented on the reverse. I declare that I have knowledge of the contents of this report and am authorized by my organization to make this report, which was prepared by me or under my supervision and direction, with the data and facts stated herein to be true, correct, and complete to the best of my knowledge and belief.

SIGNATURE *JC Brevetti* NAME (PRINT OR TYPE) JC Brevetti, Engineering Tech. DATE 10/27/16 PHONE NUMBER (405) 286-0361  
13929 Quail Pointe Dr. Oklahoma City OK 73134 breveti@charteroakproduction.com  
ADDRESS CITY STATE ZIP EMAIL ADDRESS

**PLEASE TYPE OR USE BLACK INK ONLY**  
FORMATION RECORD

Give formation names and tops, if available, or descriptions and thickness of formations drilled through. Show intervals cored or drillstem tested.

LEASE NAME J.R. Ranch

WELL NO. 1-19

NAMES OF FORMATIONS	TOP
Basal Penn	7610'
Woodford	7736'
Hunton	7785'
Sylvan	8080'
Viola	8216'
1st Bromide	8706'
Massive Bromide	8748'

**FOR COMMISSION USE ONLY**

ITD on file  YES  NO

APPROVED \_\_\_\_\_ DISAPPROVED \_\_\_\_\_

2) Reject Codes

---



---



---



---

Were open hole logs run?  yes  no

Date Last log was run June 11, 2016

Was CO<sub>2</sub> encountered?  yes  no at what depths? \_\_\_\_\_

Was H<sub>2</sub>S encountered?  yes  no at what depths? \_\_\_\_\_

Were unusual drilling circumstances encountered?  yes  no  
If yes, briefly explain below

Other remarks:

---



---



---



---

640 Acres

If more than three drainholes are proposed, attach a separate sheet indicating the necessary information.

Direction must be stated in degrees azimuth. Please note, the horizontal drainhole and its end point must be located within the boundaries of the lease or spacing unit.

Directional surveys are required for all drainholes and directional wells.

640 Acres

**BOTTOM HOLE LOCATION FOR DIRECTIONAL HOLE**

SEC	TWP	RGE	COUNTY		
Spot Location		Feet From 1/4 Sec Lines		FSL	FWL
1/4	1/4	1/4	1/4		
Measured Total Depth		True Vertical Depth		BHL From Lease, Unit, or Property Line:	

**BOTTOM HOLE LOCATION FOR HORIZONTAL HOLE: (LATERALS)**

**LATERAL #1**

SEC	TWP	RGE	COUNTY		
Spot Location		Feet From 1/4 Sec Lines		FSL	FWL
1/4	1/4	1/4	1/4		
Depth of Deviation	Radius of Turn		Direction	Total Length	
Measured Total Depth	True Vertical Depth		BHL From Lease, Unit, or Property Line:		

**LATERAL #2**

SEC	TWP	RGE	COUNTY		
Spot Location		Feet From 1/4 Sec Lines		FSL	FWL
1/4	1/4	1/4	1/4		
Depth of Deviation	Radius of Turn		Direction	Total Length	
Measured Total Depth	True Vertical Depth		BHL From Lease, Unit, or Property Line:		

**LATERAL #3**

SEC	TWP	RGE	COUNTY		
Spot Location		Feet From 1/4 Sec Lines		FSL	FWL
1/4	1/4	1/4	1/4		
Depth of Deviation	Radius of Turn		Direction	Total Length	
Measured Total Depth	True Vertical Depth		BHL From Lease, Unit, or Property Line:		