

Oklahoma Corporation Commission
Oil & Gas Conservation Division
Post Office Box 52000
Oklahoma City, Oklahoma 73152-2000
Rule 165: 10-3-25

Form 1002A

API No.: 35137272920000

Completion Report

Spud Date: October 01, 2014

OTC Prod. Unit No.: 137-08889

Drilling Finished Date: October 04, 2014

1st Prod Date:

Completion Date: November 08, 2016

Drill Type: STRAIGHT HOLE

Well Name: SANNER (EAST) 28

Purchaser/Measurer:

Location: STEPHENS 22 1S 5W
SW SE SE SW
167 FSL 2147 FWL of 1/4 SEC
Latitude: 34.44947 Longitude: -97.71218
Derrick Elevation: 0 Ground Elevation: 980

First Sales Date:

Operator: PRUITT OPERATING COMPANY LLC 17710

304805 BRISCOE RD
RATLIFF CITY, OK 73481-5802

Completion Type	
<input type="checkbox"/>	Single Zone
<input type="checkbox"/>	Multiple Zone
<input type="checkbox"/>	Commingled

Location Exception
Order No
There are no Location Exception records to display.

Increased Density
Order No
There are no Increased Density records to display.

Casing and Cement							
Type	Size	Weight	Grade	Feet	PSI	SAX	Top of CMT
PRODUCTION	5 1/2	15.5	J-55	730		300	SURFACE

Liner								
Type	Size	Weight	Grade	Length	PSI	SAX	Top Depth	Bottom Depth
There are no Liner records to display.								

Total Depth: 757

Packer	
Depth	Brand & Type
There are no Packer records to display.	

Plug	
Depth	Plug Type
There are no Plug records to display.	

Initial Test Data

Test Date	Formation	Oil BBL/Day	Oil-Gravity (API)	Gas MCF/Day	Gas-Oil Ratio Cu FT/BBL	Water BBL/Day	Pumpin or Flowing	Initial Shut-In Pressure	Choke Size	Flow Tubing Pressure
There are no Initial Data records to display.										

Completion and Test Data by Producing Formation

Formation Name: N/A	Code:	Class: TA
---------------------	-------	-----------

Formation	Top
PERMIAN	350
PERMIAN	570

Were open hole logs run? Yes

Date last log run: October 04, 2014

Were unusual drilling circumstances encountered? No

Explanation:

Other Remarks
CEMENT BOND LOG WILL BE RUN BEFORE COMPLETION.

FOR COMMISSION USE ONLY

Status: Accepted	1134727
------------------	---------

RECEIVED

Form 1002A Rev. 2009

OCT 19 2016

OKLAHOMA CORPORATION COMMISSION

API NO. 137-27292
OTC PROD. UNIT NO. 137-08889

PLEASE TYPE OR USE BLACK INK ONLY
NOTE:

Attach copy of original 1002A if recompletion or reentry.

OKLAHOMA CORPORATION COMMISSION
Oil & Gas Conservation Division
Post Office Box 52000
Oklahoma City, Oklahoma 73152-2000
Rule 165:10-3-25

ORIGINAL
 AMENDED (Reason)

COMPLETION REPORT

TYPE OF DRILLING OPERATION
 STRAIGHT HOLE DIRECTIONAL HOLE HORIZONTAL HOLE
 SERVICE WELL

SPUD DATE 10-1-14
DRLG FINISHED DATE 10-4-14

COUNTY Stephens SEC 22 TWP 15 RGE SW
LEASE NAME East Sanner (East) WELL NO. 28
SW 1/4 SE 1/4 SE 1/4 SW 1/4 FSL OF 1/4 SEC 167 FWL OF 1/4 SEC 2147
ELEVATION N Derrick Ground 980 Latitude (if known) Longitude (if known)

DATE OF WELL COMPLETION Pending 1/8-2016
1st PROD DATE
RECOMP DATE

OPERATOR NAME Pruitt Operating Co, LLC OTC/OCC OPERATOR NO. 17710
ADDRESS 30480S Briscoe Rd.
CITY Ratliff City STATE OK ZIP 73481

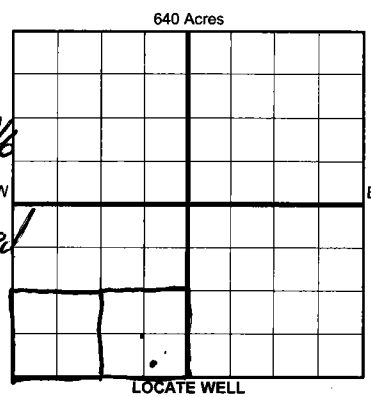

COMPLETION TYPE

<input type="checkbox"/> SINGLE ZONE
<input type="checkbox"/> MULTIPLE ZONE Application Date
<input type="checkbox"/> COMMINGLED Application Date
LOCATION EXCEPTION ORDER INCREASED DENSITY ORDER NO.

CASING & CEMENT (Form 1002C must be attached)

TYPE	SIZE	WEIGHT	GRADE	FEET	PSI	SAX	TOP OF CMT
CONDUCTOR							
SURFACE							
INTERMEDIATE							
PRODUCTION	5 1/2	15.5*	J-55	730'		300	Surface
LINER							

PACKER @ _____ BRAND & TYPE _____ PLUG @ _____ TYPE _____ PLUG @ _____ TYPE _____ TOTAL DEPTH 757
PACKER @ _____ BRAND & TYPE _____ PLUG @ _____ TYPE _____ PLUG @ _____ TYPE _____

COMPLETION & TEST DATA BY PRODUCING FORMATION

FORMATION							
SPACING & SPACING ORDER NUMBER							
CLASS: Oil, Gas, Dry, Inj, Disp, Comm Disp, Svc	TA						
PERFORATED INTERVALS	Pending Completion						
ACID/VOLUME							
FRACTURE TREATMENT (Fluids/Prop Amounts)							

Min Gas Allowable (165:10-17-7) OR Gas Purchaser/Measurer First Sales Date
 Oil Allowable (165:10-13-3)

INITIAL TEST DATA

INITIAL TEST DATE							
OIL-BBL/DAY							
OIL-GRAVITY (API)							
GAS-MCF/DAY							
GAS-OIL RATIO CU FT/BBL							
WATER-BBL/DAY							
PUMPING OR FLOWING							
INITIAL SHUT-IN PRESSURE							
CHOKE SIZE							
FLOW TUBING PRESSURE							

AS SUBMITTED

A record of the formations drilled through, and pertinent remarks are presented on the reverse. I declare that I have knowledge of the contents of this report and am authorized by my organization to make this report, which was prepared by me or under my supervision and direction, with the data and facts stated herein to be true, correct, and complete to the best of my knowledge and belief.
Mickey L. Pruitt SIGNATURE Mickey L. Pruitt NAME (PRINT OR TYPE) 10/13/16 580-856-2155 DATE PHONE NUMBER
30480S Briscoe Rd ADDRESS Ratliff City CITY OK 73481 ZIP mlcdpruit@gmail.com EMAIL ADDRESS

PLEASE TYPE OR USE BLACK INK ONLY
FORMATION RECORD

Give formation names and tops, if available, or descriptions and thickness of formations drilled through. Show intervals cored or drillstem tested.

LEASE NAME Sanner (East) WELL NO. 28

NAMES OF FORMATIONS	TOP
Permian	350'
Permian	570'

FOR COMMISSION USE ONLY

ITD on file YES NO

APPROVED _____ DISAPPROVED _____

2) Reject Codes _____

Were open hole logs run? yes no

Date Last log was run 10/4/14

Was CO₂ encountered? yes no at what depths? _____

Was H₂S encountered? yes no at what depths? _____

Were unusual drilling circumstances encountered? yes no

If yes, briefly explain below _____

Other remarks: CBL will be ran before completion

640 Acres

If more than three drainholes are proposed, attach a separate sheet indicating the necessary information.

Direction must be stated in degrees azimuth. Please note, the horizontal drainhole and its end point must be located within the boundaries of the lease or spacing unit.

Directional surveys are required for all drainholes and directional wells.

640 Acres

BOTTOM HOLE LOCATION FOR DIRECTIONAL HOLE

SEC	TWP	RGE	COUNTY							
Spot Location				1/4	1/4	1/4	1/4	Feet From 1/4 Sec Lines	FSL	FWL
Measured Total Depth			True Vertical Depth		BHL From Lease, Unit, or Property Line:					

BOTTOM HOLE LOCATION FOR HORIZONTAL HOLE: (LATERALS)

LATERAL #1

SEC	TWP	RGE	COUNTY							
Spot Location				1/4	1/4	1/4	1/4	Feet From 1/4 Sec Lines	FSL	FWL
Depth of Deviation			Radius of Turn		Direction		Total Length			
Measured Total Depth			True Vertical Depth		BHL From Lease, Unit, or Property Line:					

LATERAL #2

SEC	TWP	RGE	COUNTY							
Spot Location				1/4	1/4	1/4	1/4	Feet From 1/4 Sec Lines	FSL	FWL
Depth of Deviation			Radius of Turn		Direction		Total Length			
Measured Total Depth			True Vertical Depth		BHL From Lease, Unit, or Property Line:					

LATERAL #3

SEC	TWP	RGE	COUNTY							
Spot Location				1/4	1/4	1/4	1/4	Feet From 1/4 Sec Lines	FSL	FWL
Depth of Deviation			Radius of Turn		Direction		Total Length			
Measured Total Depth			True Vertical Depth		BHL From Lease, Unit, or Property Line:					