

Oklahoma Corporation Commission
Oil & Gas Conservation Division
Post Office Box 52000
Oklahoma City, Oklahoma 73152-2000
Rule 165: 10-3-25

Form 1002A

API No.: 35045236150000

Completion Report

Spud Date: August 18, 2016

OTC Prod. Unit No.:

Drilling Finished Date: October 12, 2016

1st Prod Date:

Completion Date: October 15, 2016

Drill Type: HORIZONTAL HOLE

Well Name: STATE 16-19-21 1H

Purchaser/Measurer:

Location: ELLIS 16 19N 21W
SW SE SE SW
220 FSL 1981 FWL of 1/4 SEC
Latitude: 36.1162708 Longitude: -99.4463303
Derrick Elevation: 2277 Ground Elevation: 2247

First Sales Date:

Operator: TAPSTONE ENERGY LLC 23467

100 E MAIN ST
OKLAHOMA CITY, OK 73104-2509

Completion Type	
<input type="checkbox"/>	Single Zone
<input type="checkbox"/>	Multiple Zone
<input type="checkbox"/>	Commingled

Location Exception	
Order No	
654896	

Increased Density	
Order No	
There are no Increased Density records to display.	

Casing and Cement							
Type	Size	Weight	Grade	Feet	PSI	SAX	Top of CMT
SURFACE	9 5/8	36	J-55	1471	889	515	SURFACE
PRODUCTION	7	26	P-110	12465	1600	730	1300

Liner								
Type	Size	Weight	Grade	Length	PSI	SAX	Top Depth	Bottom Depth
There are no Liner records to display.								

Total Depth: 17141

Packer	
Depth	Brand & Type
There are no Packer records to display.	

Plug	
Depth	Plug Type
There are no Plug records to display.	

Initial Test Data										
Test Date	Formation	Oil BBL/Day	Oil-Gravity (API)	Gas MCF/Day	Gas-Oil Ratio Cu FT/BBL	Water BBL/Day	Pumpin or Flowing	Initial Shut-In Pressure	Choke Size	Flow Tubing Pressure
There are no Initial Data records to display.										

Completion and Test Data by Producing Formation		
Formation Name: N/A	Code:	Class: PLUG AND ABANDON

Formation	Top
BASE HEEBNER	7018
TONKAWA	7500
COTTAGE GROVE	7965
HOGSHOOTER	8196
OSWEGO LIMESTONE	8750
ATOKA	9770
MISSISSIPPIAN	10910

Were open hole logs run? No
Date last log run:
Was H2S Encountered? Yes Depth Encountered: 13183
Were unusual drilling circumstances encountered? Yes
Explanation: H2S ENCOUNTERED. PARTED DRILL STRING. JUNKED AND ABANDONED WELL.

Other Remarks
There are no Other Remarks.

Lateral Holes
Sec: 16 TWP: 19N RGE: 21W County: ELLIS N2 S2 NE NW 845 FNL 1988 FWL of 1/4 SEC Depth of Deviation: 12316 Radius of Turn: 1389 Direction: 1 Total Length: 3436 Measured Total Depth: 17141 True Vertical Depth: 13183 End Pt. Location From Release, Unit or Property Line: 845

FOR COMMISSION USE ONLY	
Status: Accepted	1134780

RECEIVED

Form 1002A Rev. 2009

OCT 24 2016

OKLAHOMA CORPORATION COMMISSION

API NO. 3504523615
OTC PROD. UNIT NO. NA

PLEASE TYPE OR USE BLACK INK ONLY
NOTE:

Attach copy of original 1002A if recompletion or reentry.

OKLAHOMA CORPORATION COMMISSION
Oil & Gas Conservation Division
Post Office Box 52000
Oklahoma City, Oklahoma 73152-2000
Rule 165:10-3-25

COMPLETION REPORT

ORIGINAL AMENDED (Reason)

TYPE OF DRILLING OPERATION
STRAIGHT HOLE DIRECTIONAL HOLE HORIZONTAL HOLE
SERVICE WELL

SPUD DATE 8/18/2016
DRLG FINISHED DATE 10/12/2016

If directional or horizontal, see reverse for bottom hole location.

COUNTY ELLIS SEC 16 TWP 19N RGE 21W
LEASE NAME STATE 16-19-21 WELL NO. 1H
DATE OF WELL COMPLETION 10-15-2016
1st PROD DATE
RECOMP DATE
ELEVATIO N Derrick 2277' Ground 2247' FSL OF 1/4 SEC 220' FWL OF 1/4 SEC 1981'
Longitude -99.44633030
OPERATOR NAME Tapstone Energy, LLC OTC/OCC OPERATOR NO. 23467
ADDRESS PO Box 1608
CITY Oklahoma City STATE OK ZIP 73101-1608

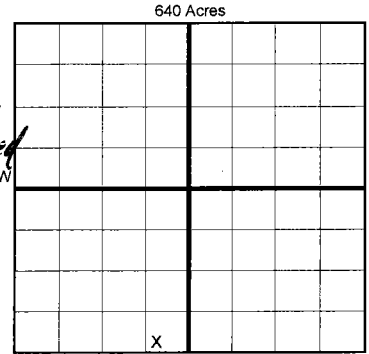

COMPLETION TYPE
SINGLE ZONE
MULTIPLE ZONE
COMMINGLED
LOCATION 654896 (Interim)

Table with columns: TYPE, SIZE, WEIGHT, GRADE, FEET, PSI, SAX, TOP OF CMT. Rows include CONDUCTOR, SURFACE (9 5/8", 36, J-55, 1471', 889, 515, SURFACE), INTERMEDIATE (7", 26, P-110, 12,465', 1600, 730, 1300'), PRODUCTION, LINER.

PACKER @ BRAND & TYPE PLUG @ TYPE PLUG @ TYPE
PACKER @ BRAND & TYPE PLUG @ TYPE PLUG @ TYPE

TOTAL DEPTH 17,141'

COMPLETION & TEST DATA BY PRODUCING FORMATION

Table with columns: FORMATION, SPACING & SPACING ORDER NUMBER, CLASS, PERFORATED INTERVALS, ACID/VOLUME, FRACTURE TREATMENT. Includes handwritten notes: MISSISSIPPIAN, 640 Acre - 054306, Dry PFA.

Min Gas Allowable (165:10-17-7) Gas Purchaser/Measurer NA
OR First Sales Date NA
Oil Allowable (165:10-13-3)

INITIAL TEST DATA

Table with columns: INITIAL TEST DATE, OIL-BBL/DAY, OIL-GRAVITY (API), GAS-MCF/DAY, GAS-OIL RATIO CU FT/BBL, WATER-BBL/DAY, PUMPING OR FLOWING, INITIAL SHUT-IN PRESSURE, CHOKE SIZE, FLOW TUBING PRESSURE.

AS SUBMITTED

A record of the formations drilled through, and pertinent remarks are presented on the reverse. I declare that I have knowledge of the contents of this report and am authorized by my organization to make this report, which was prepared by me or under my supervision and direction, with the data and facts stated herein to be true, correct, and complete to the best of my knowledge and belief.
Signature: Bryan Rother
NAME (PRINT OR TYPE): Bryan Rother
DATE: 10-21-16
PHONE NUMBER: 405-702-1600
ADDRESS: PO Box 1608, Oklahoma City, OK 73101-1608
EMAIL ADDRESS: brother@tapstoneenergy.com

