

Oklahoma Corporation Commission
Oil & Gas Conservation Division
Post Office Box 52000
Oklahoma City, Oklahoma 73152-2000
Rule 165: 10-3-25

Form 1002A

API No.: 35011236130000

Completion Report

Spud Date: July 06, 2016

OTC Prod. Unit No.:

Drilling Finished Date: July 27, 2016

1st Prod Date: September 01, 2016

Completion Date: August 26, 2016

Drill Type: HORIZONTAL HOLE

Min Gas Allowable: Yes

Well Name: HEATH 3-1H

Purchaser/Measurer: DCP MIDSTREAM / MUSTANG

Location: BLAINE 34 19N 12W
SW SE SE SW
250 FSL 2185 FWL of 1/4 SEC
Derrick Elevation: 23 Ground Elevation: 1549

First Sales Date: 09/02/2016

Operator: CARRERA ENERGY LLC 23514
PO BOX 5036
901 W MISSOURI AVE
MIDLAND, TX 79704-5036

Completion Type	
X	Single Zone
	Multiple Zone
	Commingled

Location Exception	
Order No	
657060	

Increased Density	
Order No	
There are no Increased Density records to display.	

Casing and Cement							
Type	Size	Weight	Grade	Feet	PSI	SAX	Top of CMT
CONDUCTOR	24	63.5	H-40	126			PRESET
SURFACE	9 5/8	36	J-55	1055		410	SURFACE
PRODUCTION	7	29	HC-P	9175		785	7480

Liner								
Type	Size	Weight	Grade	Length	PSI	SAX	Top Depth	Bottom Depth
LINER	4 1/2	11.6	HC-P	5616	0	400	8470	14086

Total Depth: 14091

Packer	
Depth	Brand & Type
There are no Packer records to display.	

Plug	
Depth	Plug Type
There are no Plug records to display.	

Initial Test Data

Test Date	Formation	Oil BBL/Day	Oil-Gravity (API)	Gas MCF/Day	Gas-Oil Ratio Cu FT/BBL	Water BBL/Day	Pumpin or Flowing	Initial Shut-In Pressure	Choke Size	Flow Tubing Pressure
Oct 19, 2016	MISSISSIPPIAN	93	41.7	2713	29172	2653	FLOWING		64/64	540

Completion and Test Data by Producing Formation

Formation Name: MISSISSIPPIAN

Code: 359MSSP

Class: GAS

Spacing Orders

Order No	Unit Size
644764	640

Perforated Intervals

From	To
9223	13974

Acid Volumes

42,000 GALLONS 15% HCL

Fracture Treatments

7,885,250 POUNDS 40/70, 2,197,580 POUNDS 100 MESH, 284,734 BARRELS LOAD

Formation	Top
DOUGLAS	5802
TONKAWA	6315
AVANT	6869
COTTAGE GROVE	6931
HOGSHOOTER	7128
CHECKERBOARD	7358
CLEVELAND	7463
BIG LIME	7530
OSWEGO	7596
CHEROKEE MARKER	7718
PINK LIME	7868
RED FORK	7928
INOLA	8018
ATOKA	8094
MORROW	8100
CHESTER A	8212
CHESTER B	8289
CHESTER C	8350
CHESTER D	8562
MANNING	8715
MERAMEC	8988

Were open hole logs run? No

Date last log run:

Were unusual drilling circumstances encountered? No

Explanation:

Other Remarks

There are no Other Remarks.

Lateral Holes

Sec: 3 TWP: 18N RGE: 12W County: BLAINE

SW SE SE SW

200 FSL 2197 FWL of 1/4 SEC

Depth of Deviation: 8471 Radius of Turn: 559 Direction: 180 Total Length: 4735

Measured Total Depth: 14091 True Vertical Depth: 9094 End Pt. Location From Release, Unit or Property Line: 200

FOR COMMISSION USE ONLY

1134779

Status: Accepted

RECEIVED

OCT 24 2016

OKLAHOMA CORPORATION COMMISSION

640 Acres

API NO. 35 011 23613
OTC PROD. UNIT NO.

PLEASE TYPE OR USE BLACK INK ONLY
NOTE:

Attach copy of original 1002A if recompletion or reentry.

OKLAHOMA CORPORATION COMMISSION
Oil & Gas Conservation Division
Post Office Box 52000
Oklahoma City, Oklahoma 73152-2000
Rule 165:10-3-25

COMPLETION REPORT

ORIGINAL
 AMENDED (Reason)

TYPE OF DRILLING OPERATION
 STRAIGHT HOLE DIRECTIONAL HOLE HORIZONTAL HOLE
 SERVICE WELL

If directional or horizontal, see reverse for bottom hole location.

COUNTY	Blaine	SEC	34	TWP	19N	RGE	12W	SPUD DATE	7-6-2016
LEASE NAME	Heath	WELL NO.	3-#1H	DRLG FINISHED DATE	7-27-2016	DATE OF WELL COMPLETION	8-26-2016	1st PROD DATE	9-1-2016
SW 1/4	SE 1/4	SE 1/4	SW 1/4	FSL OF 1/4 SEC.	250	FWL OF 1/4 SEC.	2185 ft	RECOMP DATE	
ELEVATIO N Derrick	23	Ground	1549	Latitude (if known)	36.072434118 N	Longitude (if known)	98.468880090 W		
OPERATOR NAME	Carrera Energy, LLC			OTC/OCC OPERATOR NO.	23514				
ADDRESS	901 Missouri								
CITY	Midland	STATE	Texas	ZIP	79701				

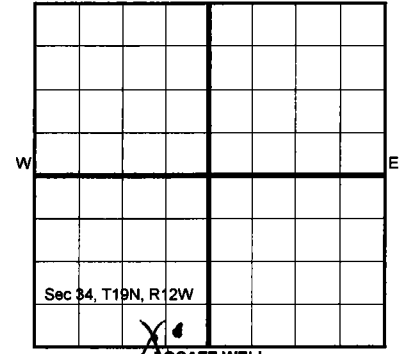

COMPLETION TYPE

SINGLE ZONE
 MULTIPLE ZONE
 COMMINGLED

LOCATION EXCEPTION ORDER INCREASED DENSITY ORDER NO. *645272 657060*

CASING & CEMENT (Form 1002C must be attached)

TYPE	SIZE	WEIGHT	GRADE	FEET	PSI	SAX	TOP OF CMT
CONDUCTOR	24	63.5	H-40	126			Preset
SURFACE	9-5/8	36	J-55	1055		410	Circulated
INTERMEDIATE							
PRODUCTION	7	29	HC-P	9175		785	7480 CBL
LINER	4-1/2	11.6	HC-P	8470-14086		400	8470
						TOTAL DEPTH	14091

PACKER @ _____ BRAND & TYPE _____ PLUG @ _____ TYPE _____ PLUG @ _____ TYPE _____
PACKER @ _____ BRAND & TYPE _____ PLUG @ _____ TYPE _____ PLUG @ _____ TYPE _____

COMPLETION & TEST DATA BY PRODUCING FORMATION *359MSSP*

FORMATION	Mississippian						
SPACING & ORDER NUMBER	644764 (640)						
CLASS: Oil, Gas, Dry, Inj, Disp, Comm Disp, Svc	<i>Oil Gas per GOR</i>						<i>Reported to Frac Focus</i>
PERFORATED INTERVALS	13,974-9,223 TVD avg 9094 ft						
ACID/VOLUME	15% HCL 42,000 gals						
FRACTURE TREATMENT (Fluids/Prop Amounts)	7,885,250 lbs 40/70 2,197,580 lbs 100 mesh 284,734 bbls load						

Min Gas Allowable (165:10-17-7) OR Gas Purchaser/Measurer DCP Midstream/Mustang
 Oil Allowable (165:10-13-3) First Sales Date 9-2-2016

INITIAL TEST DATA

INITIAL TEST DATE	10-19-2016				
OIL-BBL/DAY	93				
OIL-GRAVITY (API)	41.7° Corrected				
GAS-MCF/DAY	2713				
GAS-OIL RATIO CU FT/BBL	29,204 29172				
WATER-BBL/DAY	2653				
PUMPING OR FLOWING	Flowing				
INITIAL SHUT-IN PRESSURE					
CHOKE SIZE	64/64				
FLOW TUBING PRESSURE	540				

AS SUBMITTED

A record of the formations drilled through, and pertinent remarks are presented on the reverse. I declare that I have knowledge of the contents of this report and am authorized by my organization to make this report, which was prepared by me or under my supervision and direction, with the data and facts stated herein to be true, correct, and complete to the best of my knowledge and belief.

Richard L. Wright
SIGNATURE NAME (PRINT OR TYPE) DATE 10-20-2016 PHONE NUMBER 432 695 6970
901 Missouri Midland, Texas 79701 rwright@carreraenergy.com
ADDRESS CITY STATE ZIP EMAIL ADDRESS

Per Richard Wright

Per Richard Wright

PLEASE TYPE OR USE BLACK INK ONLY

FORMATION RECORD

Give formation names and tops, if available, or descriptions and thickness of formations drilled through. Show intervals cored or drillstem tested.

LEASE NAME Heath WELL NO. 3-1H

NAMES OF FORMATIONS	TOP
Douglas	5802
Tonkawa	6315
Avant	6869
Cottage Grove	6931
Hogshooter	7128
Checkerboard	7358
Cleveland	7463
Big Lime	7530
Oswego	7596
Cherokee Marker	7718
Pink Lime	7868
Red Fork	7928
Inola	8018
Atoka	8094
Morrow	8100
Chester A	8212
Chester B	8289
Chester C	8350
Chester D	8562
Manning	8715
Meramec	8988

FOR COMMISSION USE ONLY

ITD on file YES NO

APPROVED _____ DISAPPROVED _____

2) Reject Codes _____

Were open hole logs run? _____ yes no

Date Last log was run _____

Was CO₂ encountered? _____ yes no at what depths? _____

Was H₂S encountered? _____ yes no at what depths? _____

Were unusual drilling circumstances encountered? _____ yes no
If yes, briefly explain below _____

Other remarks: _____

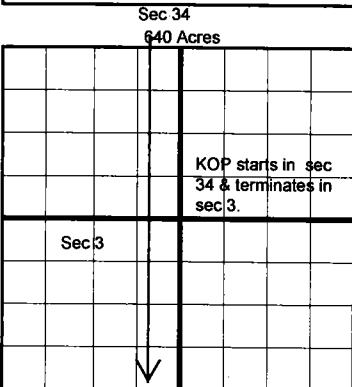

If more than three drainholes are proposed, attach a separate sheet indicating the necessary information.

Direction must be stated in degrees azimuth. Please note, the horizontal drainhole and its end point must be located within the boundaries of the lease or spacing unit.

Directional surveys are required for all drainholes and directional wells.

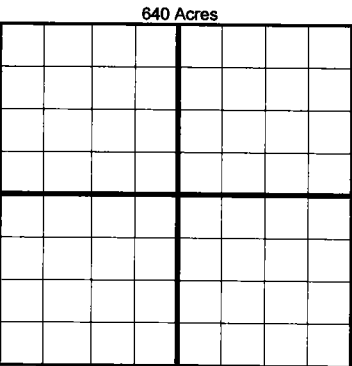

BOTTOM HOLE LOCATION FOR DIRECTIONAL HOLE

SEC	TWP	RGE	COUNTY
Spot Location			
1/4	1/4	1/4	1/4
Measured Total Depth		True Vertical Depth	BHL From Lease, Unit, or Property Line:

BOTTOM HOLE LOCATION FOR HORIZONTAL HOLE: (LATERALS)

LATERAL #1

SEC	TWP	RGE	COUNTY
3	T18N	12W	Blaine
Spot Location			
SW 1/4	SE 1/4	SE 1/4	SW 1/4
Depth of Deviation 8471 ft		Radius of Turn 559 ft	Direction 180.1°
Measured Total Depth 14,091 ft		True Vertical Depth 9094 Avg	Total Length 4,735 ft
BHL From Lease, Unit, or Property Line: 200 FSL & 2197 FWL, Sec 3, T18N, R12W, Blaine County			

LATERAL #2

SEC	TWP	RGE	COUNTY
Spot Location			
1/4	1/4	1/4	1/4
Depth of Deviation		Radius of Turn	Direction
Measured Total Depth		True Vertical Depth	Total Length
BHL From Lease, Unit, or Property Line:			

LATERAL #3

SEC	TWP	RGE	COUNTY
Spot Location			
1/4	1/4	1/4	1/4
Depth of Deviation		Radius of Turn	Direction
Measured Total Depth		True Vertical Depth	Total Length
BHL From Lease, Unit, or Property Line:			

Per Richard Wright