

Oklahoma Corporation Commission
Oil & Gas Conservation Division
Post Office Box 52000
Oklahoma City, Oklahoma 73152-2000
Rule 165: 10-3-25

Form 1002A

API No.: 35151244250001

Completion Report

Spud Date: December 13, 2015

OTC Prod. Unit No.: 151-217426

Drilling Finished Date: January 28, 2016

1st Prod Date: April 17, 2016

Amended

Completion Date: April 14, 2016

Amend Reason: AMENDED TO CORRECT PERFORATION INTERVAL

Drill Type: HORIZONTAL HOLE

Min Gas Allowable: Yes

Well Name: GOUCHER 2514 2H-17 DD

Purchaser/Measurer: SEMGAS

Location: WOODS 20 25N 14W
NE NW NE NW
230 FNL 1665 FWL of 1/4 SEC
Derrick Elevation: 0 Ground Elevation: 1520

First Sales Date: 05/04/2016

Operator: MIDSTATES PETROLEUM COMPANY LLC 23079

321 S BOSTON AVE STE 1000
TULSA, OK 74103-3322

Completion Type	
X	Single Zone
	Multiple Zone
	Commingled

Location Exception
Order No
657061

Increased Density
Order No
645998

Casing and Cement							
Type	Size	Weight	Grade	Feet	PSI	SAX	Top of CMT
SURFACE	9 5/8	36	J-55	1187		530	SURFACE
PRODUCTION	7	26	P-110	6481		175	5129

Liner								
Type	Size	Weight	Grade	Length	PSI	SAX	Top Depth	Bottom Depth
LINER	4.5	11.6	P-110	5526	0	605	6391	11917

Total Depth: 11917

Packer	
Depth	Brand & Type
There are no Packer records to display.	

Plug	
Depth	Plug Type
There are no Plug records to display.	

Initial Test Data										
Test Date	Formation	Oil BBL/Day	Oil-Gravity (API)	Gas MCF/Day	Gas-Oil Ratio Cu FT/BBL	Water BBL/Day	Pumpin or Flowing	Initial Shut-In Pressure	Choke Size	Flow Tubing Pressure
May 12, 2016	MISSISSIPPI LIME	73	29	325	4452	3059	PUMPING	54	64/64	216

Completion and Test Data by Producing Formation			
Formation Name: MISSISSIPPI LIME	Code: 351MSSLM	Class: OIL	
Spacing Orders		Perforated Intervals	
Order No	Unit Size	From	To
161084	640	7013	11821
Acid Volumes		Fracture Treatments	
5,095 BARRELS 15% GELLED AND RET ACID, 768 BARRELS 15% HCL		95,879 BARRELS SLICK WATER, 168,092 POUNDS ROCK SALT	

Formation	Top
HEEBNER	4726
TONKAWA	5062
AVANT LIME	5416
COTTAGE GROVE	5505
HOGSHOOTER	5567
OSWEGO	5739
CHEROKEE	5865
MISSISSIPPI	6112

Were open hole logs run? No

Date last log run:

Were unusual drilling circumstances encountered? No

Explanation:

Other Remarks
There are no Other Remarks.

Lateral Holes

Sec: 17 TWP: 25N RGE: 14W County: WOODS

NE NE NE NW

166 FNL 2318 FWL of 1/4 SEC

Depth of Deviation: 7218 Radius of Turn: 1025 Direction: 1 Total Length: 5436

Measured Total Depth: 11917 True Vertical Depth: 6456 End Pt. Location From Release, Unit or Property Line: 166

FOR COMMISSION USE ONLY

1134707

Status: Accepted

RECEIVED

Form 1002A Rev. 2009

OCT 17 2016

OKLAHOMA CORPORATION COMMISSION

API NO. 151 24425
OTC PROD. UNIT NO. 151 217426

PLEASE TYPE OR USE BLACK INK ONLY
NOTE:

Attach copy of original 1002A if recompletion or reentry.

OKLAHOMA CORPORATION COMMISSION
Oil & Gas Conservation Division
Post Office Box 52000
Oklahoma City, Oklahoma 73152-2000
Rule 165:10-3-25

ORIGINAL
 AMENDED (Reason) Amended to correct perf interval.

COMPLETION REPORT

TYPE OF DRILLING OPERATION
 STRAIGHT HOLE DIRECTIONAL HOLE HORIZONTAL HOLE
 SERVICE WELL

SPUD DATE 12/13/2015
DRLG FINISHED DATE 01/28/2016
DATE OF WELL COMPLETION 04/14/2016
1st PROD DATE 04/17/2016

If directional or horizontal, see reverse for bottom hole location.

COUNTY Woods SEC 20 TWP 25N RGE 14W
LEASE NAME Goucher 2514 WELL NO. 2H-17 DD

NE 1/4 NW 1/4 NE 1/4 NW 1/4 ~~1/4~~ OF 230N FWL OF 1665
ELEVATION N Derrick Ground 1520 Latitude (if known) Longitude (if known)

OPERATOR NAME Midstates Petroleum Company LLC OTC/OCC OPERATOR NO. 23079

ADDRESS 321 South Boston, Suite 1000

CITY Tulsa STATE OK ZIP 74103

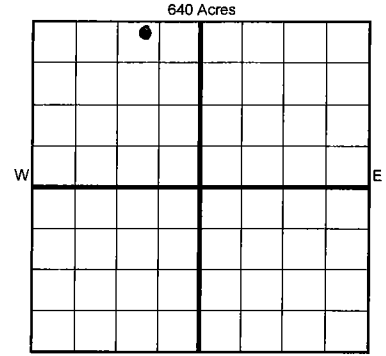

COMPLETION TYPE
 SINGLE ZONE
 MULTIPLE ZONE Application Date
 COMMINGLED Application Date
LOCATION
EXCEPTION ORDER 646074 657061.F.O.
INCREASED DENSITY ORDER NO. 645998

CASING & CEMENT (Form 1002C must be attached)

TYPE	SIZE	WEIGHT	GRADE	FEET	PSI	SAX	TOP OF CMT
CONDUCTOR							
SURFACE							
INTERMEDIATE	9-5/8	36#	J-55	1,187'		530	surface
PRODUCTION	7	26#	P-110	6,481'		175	5,129
LINER	4.5	11.6#	P-110	6,391'	11,917'	605	6,401'
							TOTAL DEPTH 11,917'

PACKER @ _____ BRAND & TYPE _____ PLUG @ _____ TYPE _____ PLUG @ _____ TYPE _____
PACKER @ _____ BRAND & TYPE _____ PLUG @ _____ TYPE _____ PLUG @ _____ TYPE _____

COMPLETION & TEST DATA BY PRODUCING FORMATION 351M55LM

FORMATION	Mississippi Lime						
SPACING & SPACING ORDER NUMBER	640/161084						
CLASS: Oil, Gas, Dry, Inj, Disp, Comm Disp, Svc	Oil						
PERFORATED INTERVALS	7,013'-11,821'						
ACID/VOLUME	5095 bbls 15% gelled & ret acid	768 bbls 15% HCl					
FRACTURE TREATMENT (Fluids/Prop Amounts)	95,879 bbls slk wtr						
	168,092# rock salt						

Min Gas Allowable (165:10-17-7) OR Oil Allowable (165:10-13-3)
Gas Purchaser/Measurer SemGas
First Sales Date 05/04/2016

INITIAL TEST DATA

INITIAL TEST DATE	05/12/2016						
OIL-BBL/DAY	73						
OIL-GRAVITY (API)	29						
GAS-MCF/DAY	325						
GAS-OIL RATIO CU FT/BBL	4,452						
WATER-BBL/DAY	3,059						
PUMPING OR FLOWING	Pumping						
INITIAL SHUT-IN PRESSURE	54						
CHOKE SIZE	64/64						
FLOW TUBING PRESSURE	216						

AS SUBMITTED

A record of the formations drilled through, and pertinent remarks are presented on the reverse. I declare that I have knowledge of the contents of this report and am authorized by my organization to make this report, which was prepared by me or under my supervision and direction, with the data and facts stated herein to be true, correct, and complete to the best of my knowledge and belief.
05/12/2016 918-947-4647
SIGNATURE Chelce Rouse NAME (PRINT OR TYPE)
DATE PHONE NUMBER
321 South Boston, Suite 1000 Tulsa, OK 74103 chelce.rouse@midstatespetroleum.com
ADDRESS CITY STATE ZIP EMAIL ADDRESS

PLEASE TYPE OR USE BLACK INK ONLY
FORMATION RECORD

Give formation names and tops, if available, or descriptions and thickness of formations drilled through. Show intervals cored or drillstem tested.

LEASE NAME Goucher 2514 WELL NO. 2H-17 DD

NAMES OF FORMATIONS	TOP
Heebner	4726
Tonkawa	5062
Avant Lm	5416
Cottage Grove	5505
Hogshooter	5567
Oswego	5739
Cherokee	5865
Mississippi	6112

FOR COMMISSION USE ONLY

ITD on file YES NO

APPROVED _____ DISAPPROVED _____

2) Reject Codes _____

Were open hole logs run? yes no

Date Last log was run N/A

Was CO₂ encountered? yes no at what depths? _____

Was H₂S encountered? yes no at what depths? _____

Were unusual drilling circumstances encountered? yes no
If yes, briefly explain below

Other remarks:

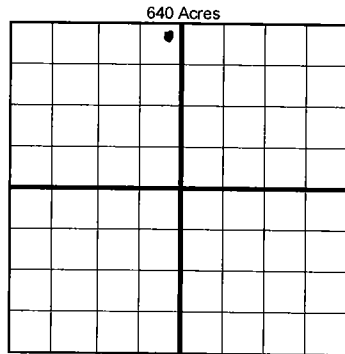

If more than three drainholes are proposed, attach a separate sheet indicating the necessary information.

Direction must be stated in degrees azimuth. Please note, the horizontal drainhole and its end point must be located within the boundaries of the lease or spacing unit.

Directional surveys are required for all drainholes and directional wells.

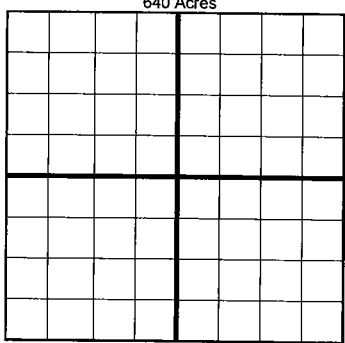

BOTTOM HOLE LOCATION FOR DIRECTIONAL HOLE

SEC	TWP	RGE	COUNTY				
Spot Location	1/4	1/4	1/4	1/4	Feet From 1/4 Sec Lines	FSL	FWL
Measured Total Depth	True Vertical Depth		BHL From Lease, Unit, or Property Line:				

BOTTOM HOLE LOCATION FOR HORIZONTAL HOLE: (LATERALS)

per LE exhibit

LATERAL #1

SEC	TWP	RGE	COUNTY					
17	25N	14W	Woods					
Spot Location	NE 1/4	NE 1/4	NE 1/4	NW 1/4	1/4	Feet From 1/4 Sec Lines	FSL <u>166FNL</u>	FWL 2318
Depth of Deviation	7,218	Radius of Turn	1,025	Direction	1.40	Total Length	5,436	
Measured Total Depth	11,917'		True Vertical Depth	6,456		BHL From Lease, Unit, or Property Line: <u>16T 166</u>		

LATERAL #2

SEC	TWP	RGE	COUNTY				
Spot Location	1/4	1/4	1/4	1/4	Feet From 1/4 Sec Lines	FSL	FWL
Depth of Deviation	Radius of Turn		Direction		Total Length		
Measured Total Depth	True Vertical Depth		BHL From Lease, Unit, or Property Line:				

LATERAL #3

SEC	TWP	RGE	COUNTY				
Spot Location	1/4	1/4	1/4	1/4	Feet From 1/4 Sec Lines	FSL	FWL
Depth of Deviation	Radius of Turn		Direction		Total Length		
Measured Total Depth	True Vertical Depth		BHL From Lease, Unit, or Property Line:				