

Oklahoma Corporation Commission
Oil & Gas Conservation Division
Post Office Box 52000
Oklahoma City, Oklahoma 73152-2000
Rule 165: 10-3-25

Form 1002A

API No.: 35093250280000

Completion Report

Spud Date: July 02, 2016

OTC Prod. Unit No.: 093-217917

Drilling Finished Date: August 01, 2016

1st Prod Date: September 13, 2016

Completion Date: August 28, 2016

Drill Type: HORIZONTAL HOLE

Min Gas Allowable: Yes

Well Name: NICKELSON 17-22-15 1H

Purchaser/Measurer: CHESAPEAKE OPERATING LLC

Location: MAJOR 17 22N 15W
SE SW SE SE
225 FSL 755 FEL of 1/4 SEC
Derrick Elevation: 1470 Ground Elevation: 1447

First Sales Date: 09/13/2016

Operator: CHESAPEAKE OPERATING LLC 17441
PO BOX 18496
6100 N WESTERN AVE
OKLAHOMA CITY, OK 73154-0496

Completion Type	
X	Single Zone
	Multiple Zone
	Commingled

Location Exception
Order No
657198

Increased Density
Order No
653831

Casing and Cement							
Type	Size	Weight	Grade	Feet	PSI	SAX	Top of CMT
SURFACE	9 5/8	36	J-55	1524		822	SURFACE
PRODUCTION	7	29	P-110EC	8713		617	4611

Liner								
Type	Size	Weight	Grade	Length	PSI	SAX	Top Depth	Bottom Depth
LINER	4 1/2	13.5	P-110EC	4918	0	522	8467	13385

Total Depth: 13385

Packer	
Depth	Brand & Type
8405	AS-3

Plug	
Depth	Plug Type
13246	CIBP

Initial Test Data										
Test Date	Formation	Oil BBL/Day	Oil-Gravity (API)	Gas MCF/Day	Gas-Oil Ratio Cu FT/BBL	Water BBL/Day	Pumpin or Flowing	Initial Shut-In Pressure	Choke Size	Flow Tubing Pressure
Oct 02, 2016	MISSISSIPPI LIME			41		1837	ARTIFICIA			213

Completion and Test Data by Producing Formation										
Formation Name: MISSISSIPPI LIME			Code: 351MSSLM			Class: GAS				
Spacing Orders				Perforated Intervals						
Order No	Unit Size			From			To			
93778	640			8560			13236			
Acid Volumes				Fracture Treatments						
5,000 GALLONS HCL ACID				243,815 BARRELS FRAC FLUID, 14,459,222 POUNDS PROPPANT						

Formation	Top
MISSISSIPPI LIME	8432

Were open hole logs run? No

Date last log run:

Were unusual drilling circumstances encountered? No

Explanation:

Other Remarks
There are no Other Remarks.

Lateral Holes
Sec: 17 TWP: 22N RGE: 15W County: MAJOR
NW NW NE NE
53 FNL 1154 FEL of 1/4 SEC
Depth of Deviation: 8089 Radius of Turn: 189 Direction: 2 Total Length: 4953
Measured Total Depth: 13385 True Vertical Depth: 8278 End Pt. Location From Release, Unit or Property Line: 53

FOR COMMISSION USE ONLY
Status: Accepted
1134697

9/13/16

API NO. 35-093-25028
OTC PROD. UNIT NO. 093-217917

PLEASE TYPE OR USE BLACK INK ONLY
NOTE: Attach copy of original 1002A if recompletion or reentry.

OKLAHOMA CORPORATION COMMISSION
Oil & Gas Conservation Division
Post Office Box 52000
Oklahoma City, Oklahoma 73152-2000
Rule 165-10-3-25

RECEIVED
OCT 14 2016 1016EZ

ORIGINAL AMENDED Reason Amended
A: 124211 # -> S

COMPLETION REPORT

TYPE OF DRILLING OPERATION
 STRAIGHT HOLE DIRECTIONAL HOLE HORIZONTAL HOLE
If directional or horizontal, see reverse for bottom hole location.
COUNTY MAJOR SEC 17 TWP 22N RGE 15W
LEASE NAME NICKELSON 17-22-15 WELL NO 1H
SHL SE 1/4 SW 1/4 SE 1/4 SE 1/4 225 1/4 SEC 755
ELEVATION 1,470 Ground 1,447
Derrick Ft 1,470 Ground 1,447
OPERATOR NAME CHESAPEAKE OPERATING, L.L.C. OTC/OCC OPERATOR NO. 17441
ADDRESS P.O. BOX 18496
CITY OKLAHOMA CITY STATE OK ZIP 73154

SPUD DATE 7/2/2016
DRLG FINISHED DATE 8/1/2016
DATE OF WELL COMPLETION 8/28/2016
1ST PROD DATE 9/13/2016
RECOMP DATE
Longitude (if Known)
OTC/OCC OPERATOR NO. 17441

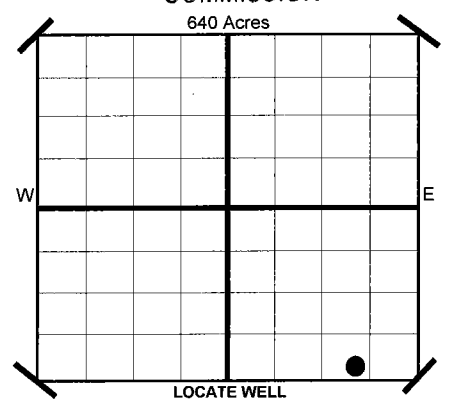

COMPLETION TYPE
 SINGLE ZONE
 MULTIPLE ZONE
Application Date
COMMINGLED
Application Date 65798 F.O.
LOCATION EXCEPTION ORDER NO. 653832 (INTERIM)
INCREASED DENSITY ORDER NO. 653831

CASING & CEMENT (Form 1002C must be attached)

TYPE	SIZE	WEIGHT	GRADE	FEET	PSI	SAX	TOP
CONDUCTOR							
SURFACE	9 5/8"	36#	J-55	1,524		822	SURFACE
INTERMEDIATE							
PRODUCTION	7"	29#	P-110EC	8,713		617	4,611
LINER	4 1/2"	13.5#	P-110EC	8,467-13,385		522	8,504
							13,385

PACKER @ 8.405 BRAND & TYPE AS-3 PLUG @ TYPE PLUG @ 13,246 TYPE CIBP
PACKER @ BRAND & TYPE PLUG @ TYPE PLUG @ TYPE

COMPLETION & TEST DATA BY PRODUCING FORMATION
351 MSSLM

FORMATION	MISSISSIPPI LIME								
SPACING & SPACING ORDER NUMBER	640 93778								
CLASS: Oil, Gas, Dry, Inj. Disp, Comm Disp, Svc	GAS								
PERFORATED INTERVALS	8,560-13,236								
ACID/VOLUME	HCL Acid 5,000 GALS Frac Fluid 243,815 BBLs Proppant 14,459,222 LBS								
FRACTURE TREATMENT (Fluids/Prop Amounts)									

Reported to Frac Focus

Minimum Gas Allowable (165-10-17) Gas Purchaser/Measurer Chesapeake Operating, L.L.C.
 OR Oil Allowable (165-10-13-3) 1st Sales Date 9/13/2016

INITIAL TEST DATA

INITIAL TEST DATE	10/2/2016				
OIL-BBL/DAY	0				
OIL-GRAVITY (API)					
GAS-MCF/DAY	41				
GAS-OIL RATIO CU FT/BBL					
WATER-BBL/DAY	1837				
PUMPING OR FLOWING	ARTIFICIAL LIFT				
INITIAL SHUT-IN PRESSURE					
CHOKE SIZE	1				
FLOW TUBING PRESSURE	213				

AS SUBMITTED

SCANNED

A record of the formations drilled through, and pertinent remarks are presented on the reverse. I declare that I have knowledge of the contents of this report and am authorized by my organization to make this report, which was prepared by me or under my supervision and direction, with the data and facts stated herein to be true, correct, and complete to the best of my knowledge and belief.

JP Powell, Sr. Regulatory Analyst
10/12/2016 405-848-8000
P.O. BOX 18496 OKLAHOMA CITY OK 73154
ip.powell@chk.com

FR