

Oklahoma Corporation Commission
Oil & Gas Conservation Division
Post Office Box 52000
Oklahoma City, Oklahoma 73152-2000
Rule 165: 10-3-25

Form 1002A

API No.: 35051240300000

Completion Report

Spud Date: April 06, 2016

OTC Prod. Unit No.: 051-217865-0-0000

Drilling Finished Date: July 04, 2016

1st Prod Date: September 17, 2016

Completion Date: August 22, 2016

Drill Type: HORIZONTAL HOLE

Well Name: PARKS 3-14X23H

Purchaser/Measurer: 23439

Location: GRADY 14 4N 6W
SE SE SW NE
2385 FNL 1590 FEL of 1/4 SEC
Latitude: -97.79621446 Longitude: 34.82010356
Derrick Elevation: 0 Ground Elevation: 0

First Sales Date: 9/17/2016

Operator: VITRUVIAN II WOODFORD LLC 23144

4 WATERWAY SQ PL STE 400
THE WOODLANDS, TX 77380-2692

Completion Type	
X	Single Zone
	Multiple Zone
	Commingled

Location Exception	
Order No	
	650481
	650246
	657111

Increased Density	
Order No	
	649789
	650080

Casing and Cement							
Type	Size	Weight	Grade	Feet	PSI	SAX	Top of CMT
SURFACE	20	106.5	J-55	722		805	SURFACE
SURFACE	13.38	68	J-55	3600		1580	SURFACE
INTERMEDIATE	9.58	40	P-110	13203		2025	7927
PRODUCTION	5.5	23	P-110	23251		2065	12246

Liner								
Type	Size	Weight	Grade	Length	PSI	SAX	Top Depth	Bottom Depth
There are no Liner records to display.								

Total Depth: 23257

Packer	
Depth	Brand & Type
There are no Packer records to display.	

Plug	
Depth	Plug Type
There are no Plug records to display.	

Initial Test Data										
Test Date	Formation	Oil BBL/Day	Oil-Gravity (API)	Gas MCF/Day	Gas-Oil Ratio Cu FT/BBL	Water BBL/Day	Pumpin or Flowing	Initial Shut-In Pressure	Choke Size	Flow Tubing Pressure
Sep 23, 2016	WOODFORD	493	56	6704	13598	3418	FLOWING	2488	40	

Completion and Test Data by Producing Formation										
Formation Name: WOODFORD			Code: 319WDFD			Class: OIL				
Spacing Orders				Perforated Intervals						
Order No	Unit Size			From			To			
651454	MULTIUNIT			15700			23106			
212972	640									
389202	640									
Acid Volumes				Fracture Treatments						
2095 BBLS				233777 BBLS SLICK, 6305636# PROP						

Formation	Top
SYCAMORE	15044
WOODFORD	15278
HUNTON	15535

Were open hole logs run? No

Date last log run:

Were unusual drilling circumstances encountered? No

Explanation:

Other Remarks
OCC: FLE ORDER HAS NOT BEEN ISSUED. WE HAVE ACCEPTED OPERATORS DATA AS SUBMITTED. IRREGULAR SECTION.

Lateral Holes
Sec: 23 TWP: 4N RGE: 6W County: GRADY
S2 SE SW SE
25 FSL 1650 FEL of 1/4 SEC
Depth of Deviation: 14924 Radius of Turn: 806 Direction: 181 Total Length: 7560
Measured Total Depth: 23257 True Vertical Depth: 14966 End Pt. Location From Release, Unit or Property Line: 25

FOR COMMISSION USE ONLY
Status: Accepted
1134457

VITRUVIAN *Well Location Plat*

S.H.L. Sec. 14-4N-6W I.M.
B.H.L. Sec. 23-4N-6W I.M.

Operator: VITRUVIAN II WOODFORD, LLC
 Lease Name and No. : PARKS #3-14X23H
 Footage : 2385' FNL - 1590' FEL GR. ELEVATION : 1168' Good Site? YES
 Lease Name and No. : PARKS #4-14X23H
 Footage : 2385' FNL - 1610' FEL GR. ELEVATION : 1168' Good Site? YES
 Section : 14 Township: 4N Range 6W I.M.
 County : Grady State of Oklahoma
 Alternate Loc. : N/A
 Terrain at Loc. : Location fell in a prairie grass field, south of pond, scattered brush and briars.
 Accessibility : From the East.
 Directions : From the intersection of State Highway 76 and "EW 152 Rd." in the town of Erin Springs, OK, go 11.0 miles West on "EW 152 Rd." to the Southeast Corner of Section 14-4N-6W.

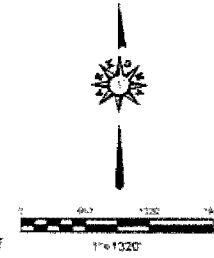

GPS DATUM
NAD - 27
OK SOUTH ZONE

Quarter Section distances may be assumed from a Government Survey Plat or assumed at a proportionate distance from adjoining section corners, or occupant thereof, and may not have been measured on the ground, and further, does not represent a true boundary survey.

Please note that this location was staked on the ground under the supervision of a Licensed Professional Land Surveyor, but the accuracy of this survey is not guaranteed. Please contact Arkoma Surveying and Mapping promptly if any inaccuracy is determined. GPS data is observed from RTK - GPS.

NOTE: X and Y data shown herein for Section Corners may NOT have been surveyed on the ground, and further, does NOT represent a true Boundary Survey.

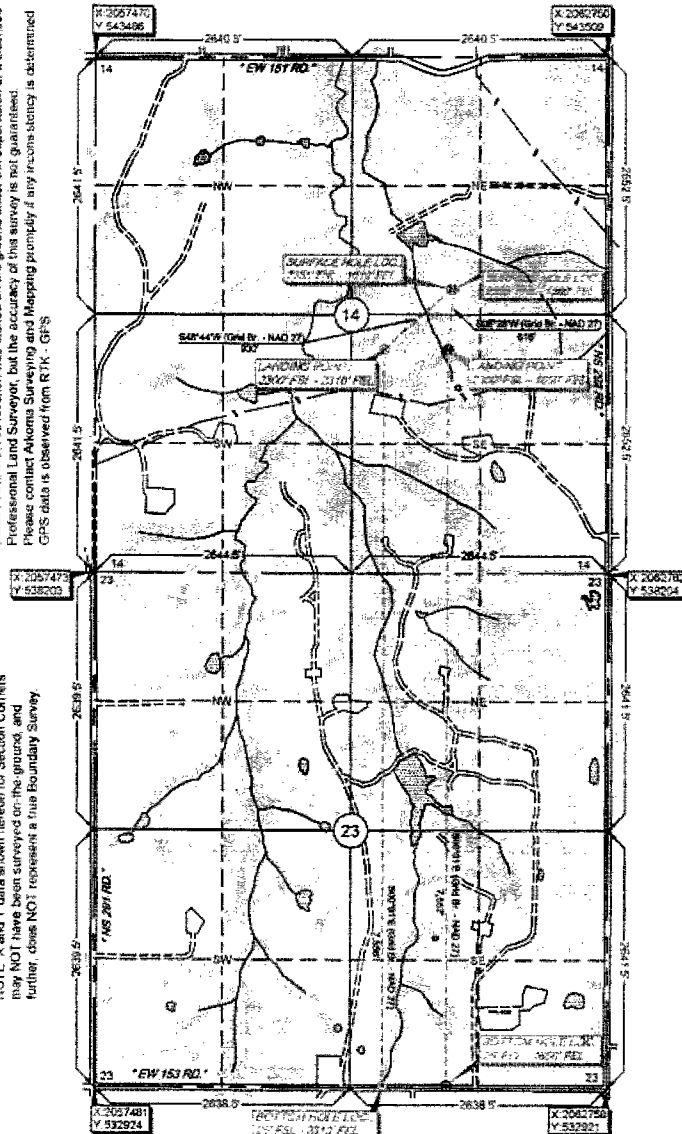

PARKS #3-14X23H	
Surface Hole Loc	Lat: 34.82010355
	Lon: -97.79621446
	X: 2061185
	Y: 5405117
Landing Point	
	Lat: 34.81841895
	Lon: -97.79641407
	X: 2061107
	Y: 540503
Bottom Hole Loc	
	Lat: 34.79765444
	Lon: -97.79646051
	X: 2061106
	Y: 532947
PARKS #4-14X23H	
Surface Hole Loc	Lat: 34.82010343
	Lon: -97.79620110
	X: 2061146
	Y: 541117
Landing Point	
	Lat: 34.81842232
	Lon: -97.79661296
	X: 2060447
	Y: 540563
Bottom Hole Loc	
	Lat: 34.79765914
	Lon: -97.79666887
	X: 2060448
	Y: 532947

Survey and plat by:
Arkoma Surveying and Mapping, PLLC
 P.O. Box 238 Wilburton, OK 74578
 Ph. 918-465-5711 Fax 918-465-5030
 Certificate of Authorization No. 5248
 Expires June 30, 2018
 Invoice #5749-A, 5749-B
 Date Staked 08/12/15 By: H.N.
 Date Drawn : 08/19/15 By: K.M.
 Added LP & BHL : 09/10/15 By: R.S.

Certification:
 This is to certify that this Well Location Plat represents the results of a survey made on the ground performed under the supervision of the undersigned

Lance G Mathis
 LANCE G MATHIS OK LPLS 1664

