

Oklahoma Corporation Commission  
 Oil & Gas Conservation Division  
 Post Office Box 52000  
 Oklahoma City, Oklahoma 73152-2000  
 Rule 165: 10-3-25

Form 1002A

API No.: 35053229400001

**Completion Report**

Spud Date: April 01, 2012

OTC Prod. Unit No.:

Drilling Finished Date: April 17, 2012

**Amended**

1st Prod Date:

Amend Reason: RECOMPLETE IN MISSISSIPPIAN / CHANGE WELL CLASSIFICATION /  
 CHANGE OPERATOR

Completion Date: April 17, 2012

Recomplete Date: March 05, 2016

**Drill Type: STRAIGHT HOLE**

**SERVICE WELL**

Well Name: GEORGE 1 SWD

Purchaser/Measurer:

Location: GRANT 22 27N 8W  
 C E2 SE SE  
 660 FSL 330 FEL of 1/4 SEC  
 Latitude: 36.798528 Longitude: -98.038658  
 Derrick Elevation: 1136 Ground Elevation: 1124

First Sales Date:

Operator: EAGLE EXPLORATION PRODUCTION LLC 23413

6100 S YALE AVE STE 700  
 TULSA, OK 74136-1935

Completion Type	
X	Single Zone
	Multiple Zone
	Commingled

Location Exception
Order No
There are no Location Exception records to display.

Increased Density
Order No
There are no Increased Density records to display.

Casing and Cement							
Type	Size	Weight	Grade	Feet	PSI	SAX	Top of CMT
SURFACE	9.625	36	J-55	985		400	SURFACE
INTERMEDIATE	7	26	P-110	6134		515	3137

Liner								
Type	Size	Weight	Grade	Length	PSI	SAX	Top Depth	Bottom Depth
There are no Liner records to display.								

**Total Depth: 7396**

Packer	
Depth	Brand & Type
5493	AS-1X

Plug	
Depth	Plug Type
6100	CIBP

Initial Test Data										
Test Date	Formation	Oil BBL/Day	Oil-Gravity (API)	Gas MCF/Day	Gas-Oil Ratio Cu FT/BBL	Water BBL/Day	Pumpin or Flowing	Initial Shut-In Pressure	Choke Size	Flow Tubing Pressure
There are no Initial Data records to display.										

Completion and Test Data by Producing Formation										
Formation Name: MISSISSIPPIAN			Code: 359MSSP				Class: DISP			
<b>Spacing Orders</b>					<b>Perforated Intervals</b>					
<b>Order No</b>		<b>Unit Size</b>			<b>From</b>			<b>To</b>		
There are no Spacing Order records to display.					5520			5660		
<b>Acid Volumes</b>					<b>Fracture Treatments</b>					
119 BARRELS 15% HCL					There are no Fracture Treatments records to display.					

Formation	Top
MISSISSIPPIAN	5165
ARBUCKLE	6136

Were open hole logs run? No

Date last log run:

Were unusual drilling circumstances encountered? No

Explanation:

Other Remarks
OCC - UIC PERMIT NUMBER 1605540126

FOR COMMISSION USE ONLY	
Status: Accepted	1134668

RECEIVED

Form 1002A Rev. 2009

OCT 11 2016

OKLAHOMA CORPORATION COMMISSION

API NO. 35-053-22940  
OTC PROD.  
UNIT NO.

PLEASE TYPE OR USE BLACK INK ONLY  
NOTE:

Attach copy of original 1002A if recompletion or reentry.

OKLAHOMA CORPORATION COMMISSION  
Oil & Gas Conservation Division  
Post Office Box 52000  
Oklahoma City, Oklahoma 73152-2000  
Rule 165:10-3-25

ORIGINAL  
 AMENDED (Reason)

Recomplete in Mississippian/change well classification/change operator

COMPLETION REPORT

TYPE OF DRILLING OPERATION

STRAIGHT HOLE  DIRECTIONAL HOLE  HORIZONTAL HOLE  
 SERVICE WELL

If directional or horizontal, see reverse for bottom hole location.

SPUD DATE 4/1/2012  
DRLG FINISHED DATE 4/17/2012  
DATE OF WELL COMPLETION 4/17/2012  
1st PROD DATE ~~3/12/2016~~  
RECOMP DATE 3/5/2016  
OTC/OCC OPERATOR NO. 23413

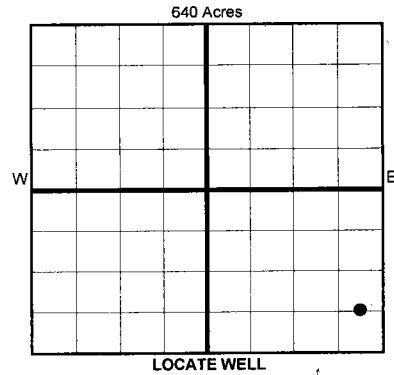

COUNTY Grant SEC 22 TWP 27N RGE 8W  
LEASE NAME George  
WELL NO. 1 SWD  
C 1/4 E2 1/4 SE 1/4 SE 1/4 FSL 1/4 SEC 660' FEL 1/4 SEC 330'  
ELEVATIO N Derrick 1136' Ground 1124' Latitude (if known) 36.798528 Longitude (if known) 98.039119  
OPERATOR NAME Eagle Exploration Production, LLC  
ADDRESS 6100 S. Yale Ave. Ste 700  
CITY Tulsa STATE OK ZIP 74136

COMPLETION TYPE

SINGLE ZONE  
 MULTIPLE ZONE  
Application Date  
COMMINGLED  
Application Date  
LOCATION  
EXCEPTION ORDER  
INCREASED DENSITY  
ORDER NO.

CASING & CEMENT (Form 1002C must be attached)

TYPE	SIZE	WEIGHT	GRADE	FEET	PSI	SAX	TOP OF CMT
CONDUCTOR							
SURFACE	9.625"	36	J55	985'		400	Surface
SURFACE							
INTERMEDIATE	7"	26	P110	6134'		515	3137'
TUBING	4.5"	11.6	J55				
							7396'

PACKER @ 5493' BRAND & TYPE AS-1X PLUG @ 6100' TYPE CIBP PLUG @ \_\_\_\_\_ TYPE \_\_\_\_\_  
PACKER @ \_\_\_\_\_ BRAND & TYPE \_\_\_\_\_ PLUG @ \_\_\_\_\_ TYPE \_\_\_\_\_ PLUG @ \_\_\_\_\_ TYPE \_\_\_\_\_

TOTAL DEPTH 7396'

COMPLETION & TEST DATA BY PRODUCING FORMATION

FORMATION	SPACING & SPACING ORDER NUMBER	CLASS: Oil, Gas, Dry, Inj, Disp, Comm Disp, Svc	PERFORATED INTERVALS	ACID/VOLUME	FRACTURE TREATMENT (Fluids/Prop Amounts)
Mississippian		Disp	5660' - 5640' 5610' - 5590' 5540' - 5520'	119 bbls 15% HCL	

Min Gas Allowable (165:10-17-7) OR Oil Allowable (165:10-13-3) Gas Purchaser/Measurer First Sales Date

INITIAL TEST DATA

INITIAL TEST DATE	
OIL-BBL/DAY	
OIL-GRAVITY ( API)	
GAS-MCF/DAY	
GAS-OIL RATIO CU FT/BBL	
WATER-BBL/DAY	
PUMPING OR FLOWING	
INITIAL SHUT-IN PRESSURE	
CHOKE SIZE	
FLOW TUBING PRESSURE	

AS SUBMITTED

A record of the formations drilled through, and pertinent remarks are presented on the reverse. I declare that I have knowledge of the contents of this report and am authorized by my organization to make this report, which was prepared by me or under my supervision and direction, with the data and facts stated herein to be true, correct, and complete to the best of my knowledge and belief.  
SIGNATURE: *Heather Shearer* NAME (PRINT OR TYPE): HEATHER SHEARER DATE: 10/5/16 PHONE NUMBER: 918-746-1391  
ADDRESS: 6100 S. Yale Ave. Ste. 700 CITY: Tulsa STATE: OK ZIP: 74136 EMAIL ADDRESS: hshearer@eeexploration.com

PLEASE TYPE OR USE BLACK INK ONLY  
FORMATION RECORD

Give formation names and tops, if available, or descriptions and thickness of formations drilled through. Show intervals cored or drillstem tested.

NAMES OF FORMATIONS	TOP
Arbuckle	6136'
Mississippian	5165'

LEASE NAME George WELL NO. 1 SWD

FOR COMMISSION USE ONLY	
ITD on file	<input type="checkbox"/> YES <input type="checkbox"/> NO
APPROVED	DISAPPROVED
2) Reject Codes	

Were open hole logs run?  yes  no

Date Last log was run \_\_\_\_\_

Was CO<sub>2</sub> encountered?  yes  no at what depths? \_\_\_\_\_

Was H<sub>2</sub>S encountered?  yes  no at what depths? \_\_\_\_\_

Were unusual drilling circumstances encountered?  yes  no  
If yes, briefly explain below

Other remarks: OCC - UIC permit # 1605540126

640 Acres

If more than three drainholes are proposed, attach a separate sheet indicating the necessary information.

Direction must be stated in degrees azimuth. Please note, the horizontal drainhole and its end point must be located within the boundaries of the lease or spacing unit.

Directional surveys are required for all drainholes and directional wells.

640 Acres

BOTTOM HOLE LOCATION FOR DIRECTIONAL HOLE

SEC	TWP	RGE	COUNTY
Spot Location	1/4	1/4	1/4
Measured Total Depth	True Vertical Depth		BHL From Lease, Unit, or Property Line:
Feet From 1/4 Sec Lines	FSL	FWL	

BOTTOM HOLE LOCATION FOR HORIZONTAL HOLE: (LATERALS)

LATERAL #1

SEC	TWP	RGE	COUNTY
Spot Location	1/4	1/4	1/4
Depth of Deviation	Radius of Turn	Direction	Total Length
Measured Total Depth	True Vertical Depth		BHL From Lease, Unit, or Property Line:
Feet From 1/4 Sec Lines	FSL	FWL	

LATERAL #2

SEC	TWP	RGE	COUNTY
Spot Location	1/4	1/4	1/4
Depth of Deviation	Radius of Turn	Direction	Total Length
Measured Total Depth	True Vertical Depth		BHL From Lease, Unit, or Property Line:
Feet From 1/4 Sec Lines	FSL	FWL	

LATERAL #3

SEC	TWP	RGE	COUNTY
Spot Location	1/4	1/4	1/4
Depth of Deviation	Radius of Turn	Direction	Total Length
Measured Total Depth	True Vertical Depth		BHL From Lease, Unit, or Property Line:
Feet From 1/4 Sec Lines	FSL	FWL	