

Oklahoma Corporation Commission
Oil & Gas Conservation Division
Post Office Box 52000
Oklahoma City, Oklahoma 73152-2000
Rule 165: 10-3-25

Form 1002A

API No.: 35047250720000

Completion Report

Spud Date: September 27, 2016

OTC Prod. Unit No.:

Drilling Finished Date: October 07, 2016

1st Prod Date:

Completion Date: October 09, 2016

Drill Type: STRAIGHT HOLE

Well Name: ARCO 1-19

Purchaser/Measurer:

Location: GARFIELD 19 22N 3W
SW NE NE SE
2167 FSL 2287 FWL of 1/4 SEC
Derrick Elevation: 1066 Ground Elevation: 1056

First Sales Date:

Operator: GLB EXPLORATION INC 18634

7716 MELROSE LN
OKLAHOMA CITY, OK 73127-6002

Completion Type	
<input type="checkbox"/>	Single Zone
<input type="checkbox"/>	Multiple Zone
<input type="checkbox"/>	Commingled

Location Exception
Order No
There are no Location Exception records to display.

Increased Density
Order No
There are no Increased Density records to display.

Casing and Cement							
Type	Size	Weight	Grade	Feet	PSI	SAX	Top of CMT
CONDUCTOR	16	42	J-55	60		6	SURFACE
SURFACE	8 5/8	24	J-55	316	400	200	SURFACE

Liner								
Type	Size	Weight	Grade	Length	PSI	SAX	Top Depth	Bottom Depth
There are no Liner records to display.								

Total Depth: 5900

Packer	
Depth	Brand & Type
There are no Packer records to display.	

Plug	
Depth	Plug Type
There are no Plug records to display.	

Initial Test Data										
Test Date	Formation	Oil BBL/Day	Oil-Gravity (API)	Gas MCF/Day	Gas-Oil Ratio Cu FT/BBL	Water BBL/Day	Pumpin or Flowing	Initial Shut-In Pressure	Choke Size	Flow Tubing Pressure
There are no Initial Data records to display.										

Completion and Test Data by Producing Formation		
Formation Name: N/A	Code:	Class: DRY

Formation	Top
UPPER LAYTON	4233
OSWEGO	4793
MISSISSIPPI CHAT	5116
MISSISSIPPI LIME	5307
WOODFORD	5488
VIOLA	5558
1ST WILCOX	5626
2ND WILCOX	5689

Were open hole logs run? Yes
Date last log run: October 07, 2016

Were unusual drilling circumstances encountered? No
Explanation:

Other Remarks
There are no Other Remarks.

FOR COMMISSION USE ONLY	
Status: Accepted	1134667

RECEIVED

Form 1002A Rev. 2009

OCT 12 2016

API NO. 047-25072

PLEASE TYPE OR USE BLACK INK ONLY
NOTE: Attach copy of original 1002A if recompletion or rec

OKLAHOMA CORPORATION COMMISSION
Oil & Gas Conservation Division
Post Office Box 52000
Oklahoma City, Oklahoma 73152-2000
Rule 165:10-3-25

OKLAHOMA CORPORATION COMMISSION

COMPLETION REPORT

ORIGINAL AMENDED (Reason)

TYPE OF DRILLING OPERATION
STRAIGHT HOLE [X] DIRECTIONAL HOLE [] HORIZONTAL HOLE []
SERVICE WELL []

SPUD DATE 9/27/16
DRLG FINISHED DATE 10/7/16
DATE OF WELL COMPLETION 10/9/16
1st PROD DATE
RECOMP DATE
ELEVATIO N Demick 1066 Ground 1056
Latitude (if known) Longitude (if known)

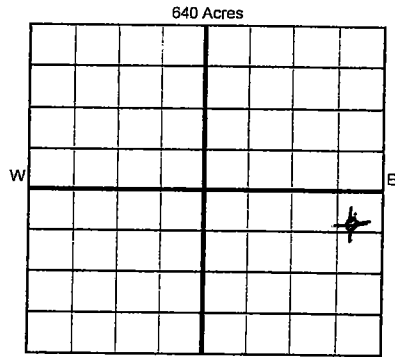

COUNTY GARFIELD SEC 19 TWP 22N RGE 3W
LEASE NAME ARLO WELL NO. 1-19
SW 1/4 NE 1/4 NE 1/4 SE 1/4 FSL 2167 FWL OF 1/4 SEC 2287
OPERATOR NAME GLB EXPLORATION, INC. OTC/OCC OPERATOR N 18634-0
ADDRESS 7716 MELROSE LANE
CITY OKLAHOMA CITY STATE OK ZIP 73127

COMPLETION TYPE
SINGLE ZONE []
MULTIPLE ZONE []
COMMINGLED []
LOCATION EXCEPTION ORDER []
INCREASED DENSITY ORDER NO. []

CASING & CEMENT (Form 1002C must be attached)
Table with columns: TYPE, SIZE, WEIGHT, GRADE, FEET, PSI, SAX, TOP OF CMT.
Rows: CONDUCTOR (16, 42, J-55, 60, -, 6 1/2, SURFACE), SURFACE (8 5/8, 24, J-55, 316, 400, 200, SURFACE), INTERMEDIATE, PRODUCTION, LINER.

PACKER @ BRAND & TYPE PLUG @ TYPE PLUG @ TYPE PLUG @ TYPE
TOTAL DEPTH 5900

COMPLETION & TEST DATA BY PRODUCING FORMATION
Table with columns: FORMATION, SPACING & SPACING ORDER NUMBER, CLASS, PERFORATED INTERVALS, ACID/VOLUME, FRACTURE TREATMENT.
Handwritten entries: NONE, Dcy.
Large stamp: AS SUBMITTED

Min Gas Allowable (165:10-17-7) OR Gas Purchaser/Measurer
Oil Allowable (165:10-13-3) First Sales Date

INITIAL TEST DATA
Table with columns: INITIAL TEST DATE, OIL-BBL/DAY, OIL-GRAVITY (API), GAS-MCF/DAY, GAS-OIL RATIO CU FT/BBL, WATER-BBL/DAY, PUMPING OR FLOWING, INITIAL SHUT-IN PRESSURE, CHOKE SIZE, FLOW TUBING PRESSURE.

A record of the formations drilled through, and pertinent remarks are presented on the reverse. I declare that I have knowledge of the contents of this report and am authorized by my organization to make this report, which was prepared by me or under my supervision and direction, with the data and facts stated herein to be true, correct, and complete to the best of my knowledge and belief.
Signature: GLENN BLUMSTEIN
Date: 10/10/16
Phone Number: 405-757-0049
Address: 7716 MELROSE LANE, OKC OK 73127
Email Address: glbexplorationinc.com

PLEASE TYPE OR USE BLACK INK ONLY
FORMATION RECORD

Give formation names and tops, if available, or descriptions and thickness of formations drilled through. Show intervals cored or drillstem tested.

LEASE NAME ARLO

WELL NO. 1-19

NAMES OF FORMATIONS	TOP
UPPER LAYTON	4233
OSWEGO	4793
MISSISSIPPI CHAT	5116
MISSISSIPPI LIME	5307
WOODFORD	5488
VIOLA	5558
1ST WILCOX	5626
2ND WILCOX	5689

FOR COMMISSION USE ONLY

ITD on file YES NO

APPROVED _____ DISAPPROVED _____

2) Reject Codes _____

Were open hole logs run? yes no

Date Last log was run 10/7/16

Was CO₂ encountered? yes no at what depths? _____

Was H₂S encountered? yes no at what depths? _____

Were unusual drilling circumstances encountered? yes no
If yes, briefly explain below _____

Other remarks: _____

640 Acres

If more than three drainholes are proposed, attach a separate sheet indicating the necessary information.

Direction must be stated in degrees azimuth. Please note, the horizontal drainhole and its end point must be located within the boundaries of the lease or spacing unit.

Directional surveys are required for all drainholes and directional wells.

640 Acres

BOTTOM HOLE LOCATION FOR DIRECTIONAL HOLE

SEC	TWP	RGE	COUNTY							
Spot Location				1/4	1/4	1/4	1/4	Feet From 1/4 Sec Lines	FSL	FWL
Measured Total Depth				True Vertical Depth		BHL From Lease, Unit, or Property Line:				

BOTTOM HOLE LOCATION FOR HORIZONTAL HOLE: (LATERALS)

LATERAL #1

SEC	TWP	RGE	COUNTY							
Spot Location				1/4	1/4	1/4	1/4	Feet From 1/4 Sec Lines	FSL	FWL
Depth of Deviation				Radius of Turn		Direction		Total Length		
Measured Total Depth				True Vertical Depth		BHL From Lease, Unit, or Property Line:				

LATERAL #2

SEC	TWP	RGE	COUNTY							
Spot Location				1/4	1/4	1/4	1/4	Feet From 1/4 Sec Lines	FSL	FWL
Depth of Deviation				Radius of Turn		Direction		Total Length		
Measured Total Depth				True Vertical Depth		BHL From Lease, Unit, or Property Line:				

LATERAL #3

SEC	TWP	RGE	COUNTY							
Spot Location				1/4	1/4	1/4	1/4	Feet From 1/4 Sec Lines	FSL	FWL
Depth of Deviation				Radius of Turn		Direction		Total Length		
Measured Total Depth				True Vertical Depth		BHL From Lease, Unit, or Property Line:				