

Oklahoma Corporation Commission
Oil & Gas Conservation Division
Post Office Box 52000
Oklahoma City, Oklahoma 73152-2000
Rule 165: 10-3-25

Form 1002A

API No.: 35151244580000

Completion Report

Spud Date: June 10, 2016

OTC Prod. Unit No.: 151-217825

Drilling Finished Date: July 14, 2016

1st Prod Date: August 18, 2016

Completion Date: August 17, 2016

Drill Type: HORIZONTAL HOLE

Min Gas Allowable: Yes

Well Name: WIEBENER 2515 1H-12 B

Purchaser/Measurer: SEMGAS

Location: WOODS 12 25N 15W
NW NE NW NW
280 FNL 930 FWL of 1/4 SEC
Derrick Elevation: 0 Ground Elevation: 1495

First Sales Date: 09/01/2016

Operator: MIDSTATES PETROLEUM COMPANY LLC 23079

321 S BOSTON AVE STE 1000
TULSA, OK 74103-3322

Completion Type	
X	Single Zone
	Multiple Zone
	Commingled

Location Exception
Order No
650678

Increased Density
Order No
There are no Increased Density records to display.

Casing and Cement							
Type	Size	Weight	Grade	Feet	PSI	SAX	Top of CMT
SURFACE	9 5/8	36	J-55	1213		555	SURFACE
PRODUCTION	7	26	P-110	6933		350	4800

Liner								
Type	Size	Weight	Grade	Length	PSI	SAX	Top Depth	Bottom Depth
LINER	4.5	11.6	P-110	5276	0	575	6571	11847

Total Depth: 11847

Packer	
Depth	Brand & Type
There are no Packer records to display.	

Plug	
Depth	Plug Type
There are no Plug records to display.	

Initial Test Data										
Test Date	Formation	Oil BBL/Day	Oil-Gravity (API)	Gas MCF/Day	Gas-Oil Ratio Cu FT/BBL	Water BBL/Day	Pumpin or Flowing	Initial Shut-In Pressure	Choke Size	Flow Tubing Pressure
Sep 08, 2016	MISSISSIPPI LIME	98	33	1120	11429	4680	PUMPING	61	64/64	220

Completion and Test Data by Producing Formation			
Formation Name: MISSISSIPPI LIME	Code: 351MSSLM	Class: OIL	
Spacing Orders		Perforated Intervals	
Order No	Unit Size	From	To
146907	640	6963	11745
Acid Volumes		Fracture Treatments	
5,153 BARRELS 15% GELLED AND RET ACID, 885 BARRELS 15% HCL		102,710 BARRELS SLICK WATER, 179,444 POUNDS ROCK SALT	

Formation	Top
HEEBNER SHALE	4657
ENDICOTT	4685
TONKAWA	5016
AVANT	5332
HOGSHOOTER	5484
OSWEGO	5643
CHEROKEE	5768
MISSISSIPPI	6092

Were open hole logs run? No

Date last log run:

Were unusual drilling circumstances encountered? No

Explanation:

Other Remarks
OCC - THIS DOCUMENT IS ACCEPTED BASED ON THE DATA SUBMITTED THE FINAL LOCATION EXCEPTION HAS NOT BEEN ISSUED.

Lateral Holes

Sec: 12 TWP: 25N RGE: 15W County: WOODS

SW SE SE SW

170 FSL 1993 FWL of 1/4 SEC

Depth of Deviation: 7018 Radius of Turn: 1174 Direction: 178 Total Length: 4914

Measured Total Depth: 11847 True Vertical Depth: 6246 End Pt. Location From Release, Unit or Property Line: 170

FOR COMMISSION USE ONLY

1134423

Status: Accepted

RECEIVED

Form 1002A Rev. 2009

SEP 12 2016

OKLAHOMA CORPORATION COMMISSION

API NO 151 24458
OTC PROD UNIT NO 151 217825

PLEASE TYPE OR USE BLACK INK ONLY
NOTE:

Attach copy of original 1002A if recompletion or reentry.

OKLAHOMA CORPORATION COMMISSION
Oil & Gas Conservation Division
Post Office Box 52000
Oklahoma City, Oklahoma 73152-2000
Rule 165:10-3-25

COMPLETION REPORT

ORIGINAL
AMENDED (Reason)

TYPE OF DRILLING OPERATION
STRAIGHT HOLE
DIRECTIONAL HOLE
HORIZONTAL HOLE

SPUD DATE 06/10/2016
DRLG FINISHED DATE 07/14/2016

COUNTY Woods SEC 12 TWP 25N RGE 15W
DATE OF WELL COMPLETION 08/17/2016

LEASE NAME Wiebener 2515 WELL NO. 1H-12 B
1st PROD DATE 08/18/2016

NW 1/4 NE 1/4 NW 1/4 NW 1/4 FSL OF 1/4 SEC 280N FWL OF 1/4 SEC 930
RECOMP DATE

ELEVATIO N Derrick Ground 1495 Latitude (if known) 36.666344765N Longitude (if known) -98.770204389W
OPERATOR NAME Midstates Petroleum Company LLC OTC/OCC OPERATOR NO. 23079

ADDRESS 321 South Boston, Suite 1000
CITY Tulsa STATE OK ZIP 74103

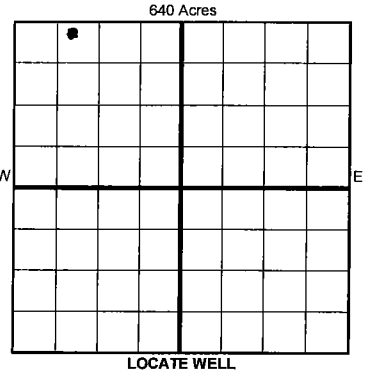

COMPLETION TYPE
SINGLE ZONE
MULTIPLE ZONE
COMMINGLED
LOCATION EXCEPTION ORDER 650678 I.O.
INCREASED DENSITY ORDER NO. N/A

Table with columns: TYPE, SIZE, WEIGHT, GRADE, FEET, PSI, SAX, TOP OF CMT. Rows include CONDUCTOR, SURFACE, INTERMEDIATE, PRODUCTION, LINER.

PACKER @ BRAND & TYPE PLUG @ TYPE PLUG @ TYPE
PACKER @ BRAND & TYPE PLUG @ TYPE PLUG @ TYPE

COMPLETION & TEST DATA BY PRODUCING FORMATION 351MSSLW

Table with columns: FORMATION, SPACING & SPACING ORDER NUMBER, CLASS, PERFORATED INTERVALS, ACID/VOLUME, FRACTURE TREATMENT. Includes handwritten notes like 'Monitor Report to FracFocus'.

Min Gas Allowable (165:10-17-7) Gas Purchaser/Measurer SemGas
OR First Sales Date 09/01/2016
Oil Allowable (165:10-13-3)

Table with columns: INITIAL TEST DATE, OIL-BBL/DAY, OIL-GRAVITY (API), GAS-MCF/DAY, GAS-OIL RATIO CU FT/BBL, WATER-BBL/DAY, PUMPING OR FLOWING, INITIAL SHUT-IN PRESSURE, CHOKE SIZE, FLOW TUBING PRESSURE.

AS SUBMITTED

A record of the formations drilled through and pertinent remarks are presented on the reverse. I declare that I have knowledge of the contents of this report and am authorized by my organization to make this report, which was prepared by me or under my supervision and direction, with the data and facts stated herein to be true, correct, and complete to the best of my knowledge and belief.
Signature: Chelce Rouse
Date: 09/01/2016
Phone Number: 918-947-4647
Address: 321 South Boston, Suite 1000 Tulsa, OK 74103
Email: chelce.rouse@midstatespetroleum.com

PLEASE TYPE OR USE BLACK INK ONLY
FORMATION RECORD

Give formation names and tops, if available, or descriptions and thickness of formations drilled through. Show intervals cored or drillstem tested.

LEASE NAME Wiebener 2515

WELL NO. 1H-12 B

NAMES OF FORMATIONS	TOP
HEEBNER SHALE	4,657
ENDICOTT	4,685
TONKAWA	5,016
AVANT	5,332
HOGSHOOTER	5,484
OSWEGO	5,643
CHEROKEE	5,768
MISSISSIPPI	6,092

FOR COMMISSION USE ONLY

ITD on file YES NO

APPROVED _____ DISAPPROVED _____

2) Reject Codes _____

Were open hole logs run? yes no

Date Last log was run N/A

Was CO₂ encountered? yes no at what depths? _____

Was H₂S encountered? yes no at what depths? _____

Were unusual drilling circumstances encountered? yes no

If yes, briefly explain below _____

Other remarks: _____

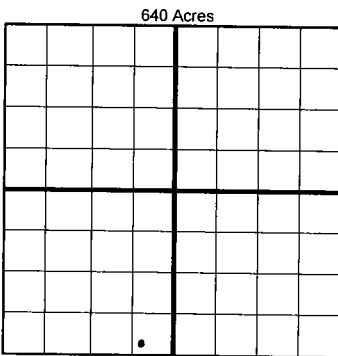

If more than three drainholes are proposed, attach a separate sheet indicating the necessary information.

Direction must be stated in degrees azimuth. Please note, the horizontal drainhole and its end point must be located within the boundaries of the lease or spacing unit.

Directional surveys are required for all drainholes and directional wells.

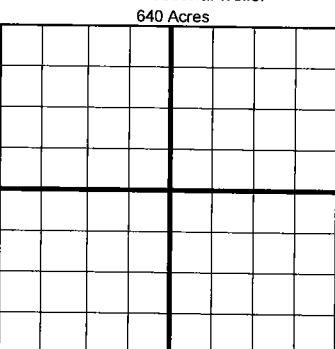

BOTTOM HOLE LOCATION FOR DIRECTIONAL HOLE

SEC	TWP	RGE	COUNTY
Spot Location			
1/4	1/4	1/4	1/4
Measured Total Depth	True Vertical Depth	BHL From Lease, Unit, or Property Line:	

BOTTOM HOLE LOCATION FOR HORIZONTAL HOLE: (LATERALS)

LATERAL #1

SEC	TWP	RGE	COUNTY
12	25N	15W	Woods
Spot Location			
SE 1/4 SW 1/4	SE 1/4	SW 1/4	SW 1/4
Depth of Deviation	Radius of Turn	Direction	Total Length
7,018	1,174	182° 178'	4,914
Measured Total Depth	True Vertical Depth	BHL From Lease, Unit, or Property Line:	
11,847	6,246	170	

LATERAL #2

SEC	TWP	RGE	COUNTY
Spot Location			
1/4	1/4	1/4	1/4
Depth of Deviation	Radius of Turn	Direction	Total Length
Measured Total Depth	True Vertical Depth	BHL From Lease, Unit, or Property Line:	

LATERAL #3

SEC	TWP	RGE	COUNTY
Spot Location			
1/4	1/4	1/4	1/4
Depth of Deviation	Radius of Turn	Direction	Total Length
Measured Total Depth	True Vertical Depth	BHL From Lease, Unit, or Property Line:	