

Oklahoma Corporation Commission
 Oil & Gas Conservation Division
 Post Office Box 52000
 Oklahoma City, Oklahoma 73152-2000
 Rule 165: 10-3-25

Form 1002A

API No.: 35073252580000

Completion Report

Spud Date: March 19, 2016

OTC Prod. Unit No.: 073-217632

Drilling Finished Date: June 03, 2016

1st Prod Date: July 10, 2016

Completion Date: July 02, 2016

Drill Type: HORIZONTAL HOLE

Min Gas Allowable: Yes

Well Name: LORAIN 1H-2X

Purchaser/Measurer: NEWFIELD

Location: KINGFISHER 35 18N 7W
 NW SW SE SW
 350 FSL 1370 FWL of 1/4 SEC
 Latitude: 35.98713 Longitude: -97.92113
 Derrick Elevation: 1061 Ground Elevation: 1033

First Sales Date: 07/10/2016

Operator: NEWFIELD EXPLORATION MID-CON INC 20944

24 WATERWAY AVE STE 900
 THE WOODLANDS, TX 77380-3197

Completion Type	
X	Single Zone
	Multiple Zone
	Commingled

Location Exception
Order No
651507

Increased Density
Order No
There are no Increased Density records to display.

Casing and Cement							
Type	Size	Weight	Grade	Feet	PSI	SAX	Top of CMT
SURFACE	9 5/8	40	J-55	670	800	260	SURFACE
PRODUCTION	5 1/2	20	P-110	18117	1000	2380	1747

Liner								
Type	Size	Weight	Grade	Length	PSI	SAX	Top Depth	Bottom Depth
There are no Liner records to display.								

Total Depth: 18128

Packer	
Depth	Brand & Type
There are no Packer records to display.	

Plug	
Depth	Plug Type
There are no Plug records to display.	

Initial Test Data										
Test Date	Formation	Oil BBL/Day	Oil-Gravity (API)	Gas MCF/Day	Gas-Oil Ratio Cu FT/BBL	Water BBL/Day	Pumpin or Flowing	Initial Shut-In Pressure	Choke Size	Flow Tubing Pressure
Aug 19, 2016	MISSISSIPPIAN (LESS CHESTER)	328	43	980	2988	1045	FLOWING	1000	64	219

Completion and Test Data by Producing Formation										
Formation Name: MISSISSIPPIAN (LESS CHESTER)			Code: 359MSNLC			Class: OIL				
Spacing Orders				Perforated Intervals						
Order No		Unit Size		From			To			
646503		640		7684			18128			
651053		640								
651506		MULTIUNIT								
Acid Volumes				Fracture Treatments						
20,244 GALLONS 15% HCL				24,729,340 # PROPPANT						
				72,045 BLWTR						

Formation	Top
MISSISSIPPIAN	7340
MANNING	7078
ATOKA	6990

Were open hole logs run? No

Date last log run:

Were unusual drilling circumstances encountered? No

Explanation:

Other Remarks
OCC: FLE ORDER HAS NOT BEEN ISSUED. WE HAVE ACCEPTED OPERATORS DATA AS SUBMITTED. IRREGULAR SECTION.

Lateral Holes

Sec: 11 TWP: 17N RGE: 7W County: KINGFISHER

SE SE SW SW

98 FSL 1298 FWL of 1/4 SEC

Depth of Deviation: 1987 Radius of Turn: 7904 Direction: 360 Total Length: 10512

Measured Total Depth: 18128 True Vertical Depth: 7536 End Pt. Location From Release, Unit or Property Line: 98

FOR COMMISSION USE ONLY

1134151

Status: Accepted

Well Location Plat

M & M Land Surveying, Inc.

520 "E" Street NW. Ardmore, OK. 73401
 Office 580-226-0446 Mobile 580-221-4999 Fax 580-226-7158

Company Name: Newfield Exploration Mid-Continent, Inc. Lease Name: Loraine #1H-2X
 Section 35 Township 18 North Range 7 West County Kingfisher Oklahoma
 Surface Location 350' FSL - 1370' FWL Elevation 1033' Good Location? Yes Topography _____
 Location fell in hayfield _____

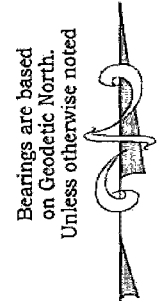
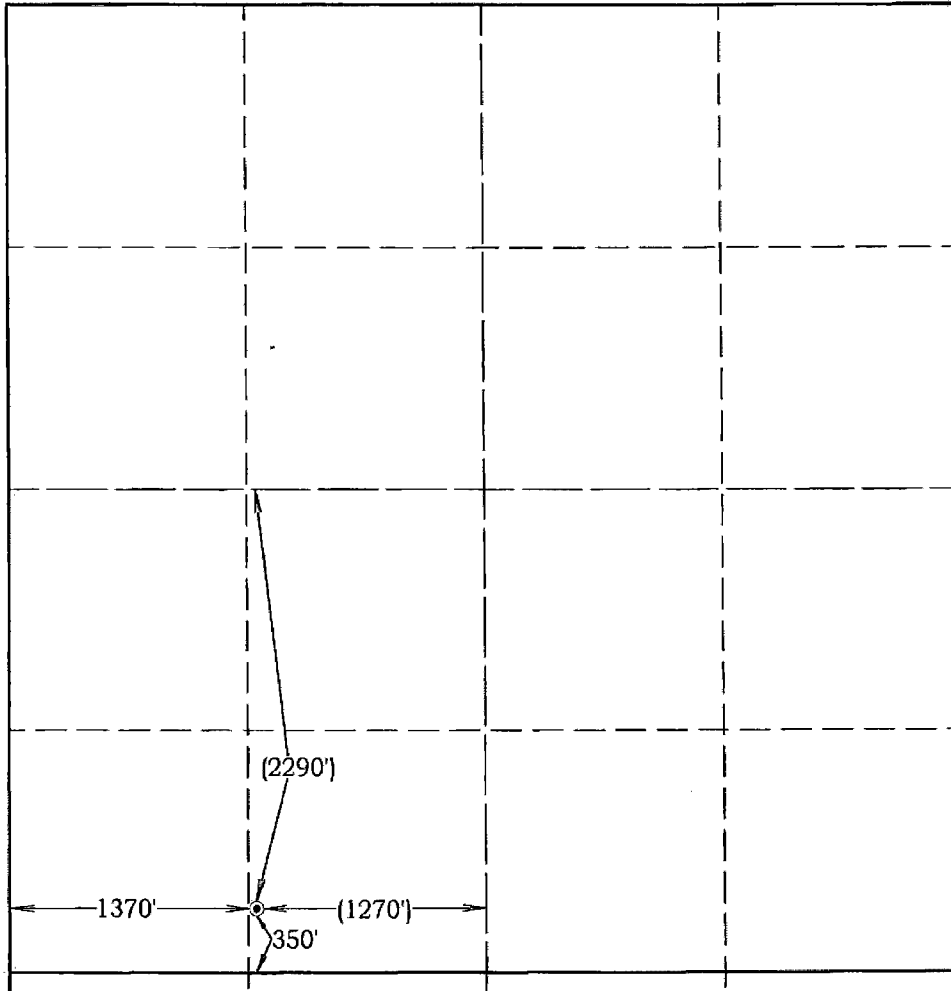

Scale: 1" = 1000'
 Invoice #15342
 Date 8/18/15
 Elevations of Proposed Pad Corners
 NW/C - N/A
 NE/C - N/A
 SE/C - N/A
 SW/C - N/A

Coordinates were derived from GPS RTK methods and are only accurate within ±10 feet

Location GPS NAD 27 Oklahoma North
 Surface Location
 Latitude: 35.98712°
 Longitude: 97.92071°
 Y= 359,329'
 X = 2,023,457'

Location NAD 83
 Surface Location
 Latitude: 35.98716°
 Longitude: 97.92105°
 Y= 359,352'
 X= 1,991,857'

Best Accessibility to Location From the Southeast

Distance & Direction From From Dover OK. go 0.5 miles North on US. #81, then 0.4 miles West on County road to the Southeast Corner of the SW/4 of section 35.
 Highway or Town _____

CERTIFICATE:

I, D. Harry McClintick, a Registered Land Surveyor in the state of Oklahoma, do hereby certify that the above described Well Location was surveyed and staked on the ground as shown.

[Signature] 9/25/15
 D. Harry McClintick, R.P.L.S. # 1367, CA # 3093

This location has been staked according to the best official survey records available to us, but its accuracy is not guaranteed. Please review this plat and notify us immediately of any discrepancy.

The distances shown in parenthesis () are calculated distances based on the quarter section being 2640' and have not been measured.

