

Oklahoma Corporation Commission
Oil & Gas Conservation Division
Post Office Box 52000
Oklahoma City, Oklahoma 73152-2000
Rule 165: 10-3-25

Form 1002A

API No.: 35047249850001

Completion Report

Spud Date: November 18, 2015

OTC Prod. Unit No.:

Drilling Finished Date: December 04, 2015

1st Prod Date: December 17, 2015

Completion Date: December 17, 2015

Drill Type: HORIZONTAL HOLE

Min Gas Allowable: Yes

Well Name: REDWOOD 2105 1MH-3

Purchaser/Measurer: MUSTANG

Location: GARFIELD 3 21N 5W
NW NE NW NW
250 FNL 665 FWL of 1/4 SEC
Derrick Elevation: 1167 Ground Elevation: 1144

First Sales Date: 12/31/2015

Operator: CHAPARRAL ENERGY LLC 16896

701 CEDAR LAKE BLVD
OKLAHOMA CITY, OK 73114-7800

Completion Type	
X	Single Zone
	Multiple Zone
	Commingled

Location Exception
Order No
633966

Increased Density
Order No
There are no Increased Density records to display.

Casing and Cement							
Type	Size	Weight	Grade	Feet	PSI	SAX	Top of CMT
SURFACE	9 5/8	36	J-55	630		255	SURFACE
PRODUCTION	7	26	P-110	6301		250	4308

Liner								
Type	Size	Weight	Grade	Length	PSI	SAX	Top Depth	Bottom Depth
LINER	4 1/2	11.6	P-110	4575	0	0	6165	10740

Total Depth: 10750

Packer	
Depth	Brand & Type
There are no Packer records to display.	

Plug	
Depth	Plug Type
There are no Plug records to display.	

Initial Test Data										
Test Date	Formation	Oil BBL/Day	Oil-Gravity (API)	Gas MCF/Day	Gas-Oil Ratio Cu FT/BBL	Water BBL/Day	Pumpin or Flowing	Initial Shut-In Pressure	Choke Size	Flow Tubing Pressure
Dec 29, 2016	MISSISSIPPIAN	433	40.5	1206	2783	1161	FLOWING			200

Completion and Test Data by Producing Formation										
Formation Name: MISSISSIPPIAN			Code: 359MSSP			Class: OIL				
Spacing Orders				Perforated Intervals						
Order No	Unit Size			From			To			
633965	640			There are no Perf. Intervals records to display.						
Acid Volumes				Fracture Treatments						
17,010 GALLONS 15% HCL				127,186 BARRELS TFW, 3,147,050 POUNDS 30/50 WHITE, 550,000 POUNDS 30/50 PREFERRED GARNET RC, 22,000 POUNDS 100 MESH WHITE						

Formation	Top
MISSISSIPPI	6361

Were open hole logs run? No

Date last log run:

Were unusual drilling circumstances encountered? No

Explanation:

Other Remarks
THIS IS AN OPEN HOLE COMPLETION (NON-CEMENTED LINER). OCC - THIS WELL IS AN OPEN HOLE COMPLETION FROM BOTTOM OF THE 7" CASING AT 6,301' TO TERMINUS AT 10,750'. THE 4 1/2" LINER IS NOT CEMENTED. THIS DOCUMENT IS ACCEPTED BASED ON THE DATA SUBMITTED THE FINAL LOCATION EXCEPTION HAS NOT BEEN APPROVED.

Lateral Holes
Sec: 3 TWP: 21N RGE: 5W County: GARFIELD
SW SE SW SW
180 FSL 675 FWL of 1/4 SEC
Depth of Deviation: 5623 Radius of Turn: 479 Direction: 178 Total Length: 4465
Measured Total Depth: 10750 True Vertical Depth: 6164 End Pt. Location From Release, Unit or Property Line: 180

FOR COMMISSION USE ONLY
Status: Accepted
1134336

API NO. **047-24985**
 OTC PROD. UNIT NO.

PLEASE TYPE OR USE BLACK INK ONLY
 NOTE:
 Attach copy of original 1002A if recompletion or reentry.

OKLAHOMA CORPORATION COMMISSION
 Oil & Gas Conservation Division
 Post Office Box 52000
 Oklahoma City, Oklahoma 73152-2000
 Rule 165:10-3-25

Form 1002A
 2007
RECEIVED

SEP 0 1 2016

ORIGINAL
 AMENDED
 Reason Amended _____
 TYPE OF DRILLING OPERATION
 STRAIGHT HOLE DIRECTIONAL HOLE HORIZONTAL HOLE
 SERVICE WELL

COMPLETION REPORT

SPUD DATE **11/18/2015**
 DRLG FINISHED **12/4/2015**
 WELL COMPLETION **12/17/2015**
 1ST PROD DATE **12/17/2015**
 RECOMP DATE **12/17/2015**

OKLAHOMA CORPORATION COMMISSION

If directional or horizontal, see reverse for bottom hole location.

COUNTY **Garfield** SEC **3** TWP **21N** RGE **5W**
 LEASE NAME **Redwood 2105** WELL NO. **1MH-3**
 SHL **NW 1/4 NE 1/4 NW 1/4 NW 1/4** FWL OF 1/4 SEC **250** **665**
 ELEVATION **1167** Ground **1144** Latitude if Known
 Derrick Fl **1167** Ground **1144** Longitude if Known
 OPERATOR NAME **CHAPARRAL ENERGY, L.L.C.** OTC/OCC OPERATOR NO. **16896**
 ADDRESS **701 CEDAR LAKE BLVD.**
 CITY **OKLAHOMA CITY** STATE **OK** ZIP **73114**

COMPLETION TYPE
 SINGLE ZONE
 MULTIPLE ZONE
 Application Date _____
 COMMINGLED
 Application Date _____
 LOCATION EXCEPTION ORDER NO. **633966 J.D. 633966**
 INCREASED DENSITY ORDER NO.

CASING & CEMENT (Form 1002C must be attached)

TYPE	SIZE	WEIGHT	GRADE	FEET	PSI	SAX	TOP	
Conductor								
Surface	9 5/8	36	J-55	630		255	surface	
Intermediate	7	26	P-110	6301		250	4308	
Production								
Liner	4 1/2	11.6	P-110	10,740 - 6165		0	6165	
							TOTAL DEPTH	10,750

PACKER @ _____ BRAND & TYPE _____
 PLUG @ _____ TYPE _____
 PLUG @ _____ TYPE _____
 PLUG @ _____ TYPE _____

COMPLETION & TEST DATA BY PRODUCING FORMATION

FORMATION	Mississippi an								
SPACING & SPACING ORDER NUMBER	640 / 633965								
CLASS: Oil, Gas, Dry, Inj, Disp, Comm Disp, Svc	Oil								
PERFORATED INTERVALS	6361-10750 open hole								
ACID/VOLUME Fracture Treatment (Fluids/Prop Amounts)	17010 gal 15% HCL 127186 bbl TFW 3147050# 30/50 White 550000# 30/50 Preferred Garnet RC	22000# 100 Mesh White							

Reported to Flow Focus

INITIAL TEST DATA
 Request minimum of allowable (165:10-17-7) **oil**
 Gas Purchaser/Measurer **Mustang** 1st Sales Date **12/31/2015**

INITIAL TEST DATE	12/29/2016
OIL-BBL/DAY	433
OIL-GRAVITY (API)	40.5
GAS-MCF/DAY	1206
GAS-OIL RATIO CU FT/BBL	2783
WATER-BBL/DAY	1161
PUMPING OR FLOWING	Flowing via GL
INITIAL SHUT-IN PRESSURE	
CHOKE SIZE	
FLOW TUBING PRESSURE	200 psi

AS SUBMITTED

A record of the formations drilled through, and pertinent remarks are presented on the reverse. I declare that I have knowledge of the contents of this report and am authorized by my organization to make this report, which was prepared by me or under my supervision and direction, with the data and facts stated herein to be true, correct, and complete to the best of my knowledge and belief.

Chacie Norton
 SIGNATURE Chacie Norton - Engineer Tech NAME (PRINT OR TYPE) DATE 405.478.8770 PHONE NUMBER
 701 CEDAR LAKE BLVD., OKLAHOMA CITY OK 73114 *chacie.norton@chaparralenergy.com* EMAIL ADDRESS
 ADDRESS CITY STATE ZIP

PLEASE TYPE OR USE BLACK INK ONLY
FORMATION RECORD

Give formation names and tops, if available, or descriptions and thickness of formations drilled through. Show intervals cored or drillstem tested.

LEASE NAME

Redwood 2105

WELL NO.

1MH-3

NAMES OF FORMATIONS	TOP
Mississippi	6361

FOR COMMISSION USE ONLY

ITD on file YES NO

APPROVED _____ DISAPPROVED _____

2) Reject Codes

Were open hole logs run? yes no

Date Last log was _____

Was CO₂ encountered? yes no at what depths? _____

Was H₂S encountered? yes no at what depths? _____

Were unusual drilling circumstances encountered? _____ yes no
If yes, briefly explain. _____

THIS IS AN OPEN-HOLE COMPLETION (NON-CEMENTED LINER) FROM 6,361-10750' (TERMINUS) *wrong*

This well is an open hole completion from bottom of the 7" casing at 6301' to terminus at 10750'. The 4 1/2" liner is not cemented

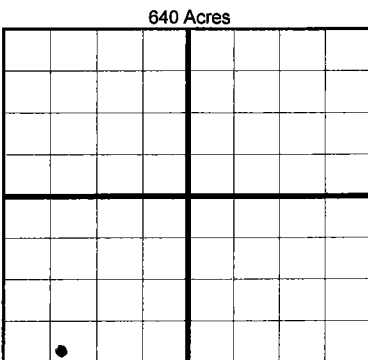

BOTTOM HOLE LOCATION FOR DIRECTIONAL HOLE

SEC	TWP	RGE	COUNTY	Feet From 1/4 Sec Lines		
Spot Location	1/4	1/4	1/4	1/4	FSL	FWL
Measured Total Depth	True Vertical Depth		BHL From Lease, Unit, or Property Line:			

BOTTOM HOLE LOCATION FOR HORIZONTAL HOLE: (LATERALS)

LATERAL #1

SEC	TWP	RGE	COUNTY	Feet From 1/4 Sec Lines		
3	21N	5W	Garfield	180	675	FWL
Spot Location	SW 1/4	SE 1/4	SW 1/4	SW 1/4	Total Length	
Depth of Deviation	5623		Radius of Turn	479	178.6	4465
Measured Total Depth	True Vertical Depth		End Pt Location From Lease, Unit or Property Line:			
10,825	10750		6,164		180	

If more than three drainholes are proposed, attach a separate sheet indicating the necessary information.

Direction must be stated in degrees azimuth. Please note, the horizontal drainhole and its end point must be located within the boundaries of the lease or spacing unit.

Directional surveys are required for all drainholes and directional wells.

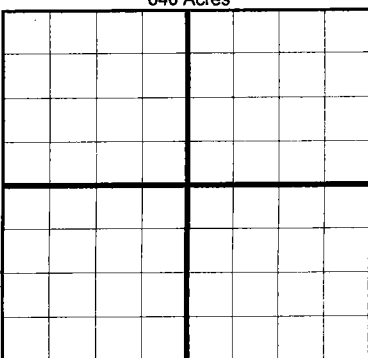

LATERAL #2

SEC	TWP	RGE	COUNTY	Feet From 1/4 Sec Lines		
Spot Location	1/4	1/4	1/4	1/4	FSL	FWL
Depth of Deviation	Radius of Turn		Direction		Total Length	
Measured Total Depth	True Vertical Depth		End Pt Location From Lease, Unit or Property Line:			

LATERAL #3

SEC	TWP	RGE	COUNTY	Feet From 1/4 Sec Lines		
Spot Location	1/4	1/4	1/4	1/4	FSL	FWL
Depth of Deviation	Radius of Turn		Direction		Total Length	
Measured Total Depth	True Vertical Depth		End Pt Location From Lease, Unit or Property Line:			