

Oklahoma Corporation Commission
Oil & Gas Conservation Division
Post Office Box 52000
Oklahoma City, Oklahoma 73152-2000
Rule 165: 10-3-25

Form 1002A

API No.: 35073250930000

Completion Report

Spud Date: June 19, 2015

OTC Prod. Unit No.:

Drilling Finished Date: July 10, 2015

1st Prod Date: November 25, 2015

Completion Date: November 25, 2015

Drill Type: HORIZONTAL HOLE

Min Gas Allowable: Yes

Well Name: DOVER UNIT (BLUEJAY) 1807 4UMH-22

Purchaser/Measurer: MUSTANG GAS

Location: KINGFISHER 15 18N 7W
SE SE SW SE
300 FSL 1565 FEL of 1/4 SEC
Derrick Elevation: 1089 Ground Elevation: 1067

First Sales Date: 12/01/2015

Operator: CHAPARRAL ENERGY LLC 16896

701 CEDAR LAKE BLVD
OKLAHOMA CITY, OK 73114-7800

Completion Type	
X	Single Zone
	Multiple Zone
	Commingled

Location Exception
Order No
There are no Location Exception records to display.

Increased Density
Order No
There are no Increased Density records to display.

Casing and Cement							
Type	Size	Weight	Grade	Feet	PSI	SAX	Top of CMT
SURFACE	9 5/8	36	J-55	438		190	SURFACE
PRODUCTION	7	26	P-110	7683		335	3300

Liner								
Type	Size	Weight	Grade	Length	PSI	SAX	Top Depth	Bottom Depth
LINER	4 1/2	11.6	J-55	5229	0	0	7368	12597

Total Depth: 12600

Packer	
Depth	Brand & Type
There are no Packer records to display.	

Plug	
Depth	Plug Type
There are no Plug records to display.	

Initial Test Data										
Test Date	Formation	Oil BBL/Day	Oil-Gravity (API)	Gas MCF/Day	Gas-Oil Ratio Cu FT/BBL	Water BBL/Day	Pumpin or Flowing	Initial Shut-In Pressure	Choke Size	Flow Tubing Pressure
Dec 04, 2015	MISSISSIPPI SOLID	234	41	752	3210	1918	PUMPING			

Completion and Test Data by Producing Formation										
Formation Name: MISSISSIPPI SOLID			Code: 351MSSSD			Class: OIL				
Spacing Orders				Perforated Intervals						
Order No	Unit Size			From			To			
62502	UNIT			There are no Perf. Intervals records to display.						
Acid Volumes				Fracture Treatments						
47,082 GALLONS 15% HCL				143,593 BARRELS TFW, 3,314,030 POUNDS 30/50 WHITE						

Formation	Top
MISSISSIPPI	7790

Were open hole logs run? No

Date last log run:

Were unusual drilling circumstances encountered? No

Explanation:

Other Remarks
OCC - THIS WELL IS AN OPEN HOLE COMPLETION FROM THE BOTTOM OF THE 7" CASING AT 7,683' TO TERMINUS AT 12,600'. THE 4 1/2" LINER IS NOT CEMENTED. THE LATERAL IS AT A LEGAL DISTANCE FROM THE OUTSIDE BOUNDARY OF THE UNIT.

Lateral Holes
Sec: 22 TWP: 18N RGE: 7W County: KINGFISHER
SE SW SE SE
76 FSL 931 FEL of 1/4 SEC
Depth of Deviation: 6784 Radius of Turn: 1104 Direction: 161 Total Length: 4810
Measured Total Depth: 12600 True Vertical Depth: 7384 End Pt. Location From Release, Unit or Property Line: 76

FOR COMMISSION USE ONLY
Status: Accepted
1134329

API NO. **073-25093**
 OTC PROD. UNIT NO.

PLEASE TYPE OR USE BLACK INK ONLY
 NOTE:
 Attach copy of original 1002A if recompletion or reentry.

OKLAHOMA CORPORATION COMMISSION
 Oil & Gas Conservation Division
 Post Office Box 52000
 Oklahoma City, Oklahoma 73152-2000
 Rule 165:10-3-25

RECEIVED Form 1002A
 Rev. 2007

SEP 01 2016

OKLAHOMA CORPORATION
 COMMISSION

ORIGINAL
 AMENDED
 Reason Amended _____
 TYPE OF DRILLING OPERATION
 STRAIGHT HOLE DIRECTIONAL HOLE HORIZONTAL HOLE
 SERVICE WELL

COMPLETION REPORT

SPUD DATE **6/19/2015**
 DRLG FINISHED **7/10/2015**
 WELL COMPLETION **11/25/2015**
 1ST PROD DATE **11/25/2015**
 RECOMP DATE **11/25/2015**
 Longitude if Known _____

If directional or horizontal, see reverse for bottom hole location.
 COUNTY **Kingfisher** SEC **15** TWP **18N** RGE **7W**
 LEASE NAME **Dover Unit (Bluejv) 1807** WELL NO. **4UMH-22**
 SHL **SE 1/4 SE 1/4 SW 1/4 SE 1/4** FSL **FEL OF 1/4 SEC**
 ELEVATION **300** Latitude if Known **1565**
 Derrick Fl **1089** Ground **1067** Longitude if Known _____
 OPERATOR NAME **CHAPARRAL ENERGY, L.L.C.** OTC/OCC OPERATOR NO. _____
 ADDRESS **701 CEDAR LAKE BLVD.** **16896**
 CITY **OKLAHOMA CITY** STATE **OK** ZIP **73114**

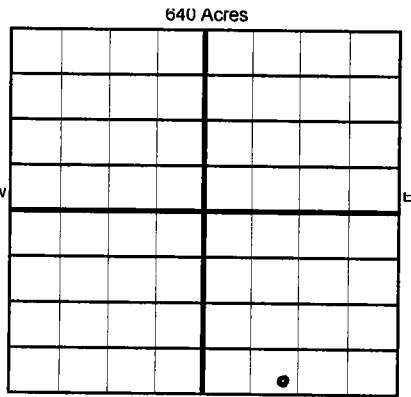

COMPLETION TYPE
 SINGLE ZONE
 MULTIPLE ZONE
 Application Date _____
 COMMINGLED
 Application Date _____
 LOCATION EXCEPTION ORDER NO. _____
 INCREASED DENSITY ORDER NO. _____

CASING & CEMENT (Form 1002C must be attached)

TYPE	SIZE	WEIGHT	GRADE	FEET	PSI	SAX	TOP	
Conductor								
Surface	9 5/8	36	J-55	438		190	surface	
Intermediate	7	26	P-110	7683		335	3300	
Production								
Liner	4 1/2	11.6	J-55	12597- 7368		0	7368 TOL	
							TOTAL DEPTH	12600

PACKER @ _____ BRAND & TYPE _____ PLUG @ _____ TYPE _____
 PACKER @ _____ BRAND & TYPE _____ PLUG @ _____ TYPE _____
 PLUG @ _____ TYPE _____ PLUG @ _____ TYPE _____

COMPLETION & TEST DATA BY PRODUCING FORMATION **319MSSD**

FORMATION	Mississippi <i>Solid</i>								
SPACING & SPACING ORDER NUMBER	unit / 62502								
CLASS: Oil, Gas, Dry, Inj, Disp, Comm Disp, Svc	Oil								
PERFORATED INTERVALS	7700-12600 <i>open hole</i>								
ACID/VOLUME Fracture Treatment (Fluids/Prop Amounts)	47082 gal 15% HCL 143593 bbl TFW 3314030# 30/50 White								

Reported to Frac Focus

INITIAL TEST DATA Request minimum gas allowable (165:10-17-7) Gas Purchaser/Measurer **Mustang Gas** 1st Sales Date **12/1/2015**

INITIAL TEST DATE	12/4/2015
OIL-BBL/DAY	234
OIL-GRAVITY (API)	41
GAS-MCF/DAY	752
GAS-OIL RATIO CU FT/BBL	3210
WATER-BBL/DAY	1918
PUMPING OR FLOWING	Pumping
INITIAL SHUT-IN PRESSURE	
CHOKE SIZE	
FLOW TUBING PRESSURE	

AS SUBMITTED

A record of the formations drilled through, and pertinent remarks are presented on the reverse. I declare that I have knowledge of the contents of this report and am authorized by my organization to make this report, which was prepared by me or under my supervision and direction, with the data and facts stated herein to be true, correct, and complete to the best of my knowledge and belief.

Chacie Norton
 SIGNATURE Chacie Norton - Engineer Tech DATE _____ 405.478.8770 PHONE NUMBER
 NAME (PRINT OR TYPE)

701 CEDAR LAKE BLVD., OKLAHOMA CITY OK 73114 *chacie.norton@chaparralenergy.com*
 ADDRESS CITY STATE ZIP EMAIL ADDRESS

PLEASE TYPE OR USE BLACK INK ONLY
FORMATION RECORD

Give formation names and tops, if available, or descriptions and thickness of formations drilled through. Show intervals cored or drillstem tested.

LEASE NAME Dover Unit (Bluejay) 1807 WELL NO. 4UMH-22

NAMES OF FORMATIONS	TOP
Mississippi	7790

FOR COMMISSION USE ONLY	
ITD on file <input type="checkbox"/> YES <input type="checkbox"/> NO	
APPROVED _____ DISAPPROVED _____	2) Reject Codes

Were open hole logs run? _____ yes <input checked="" type="checkbox"/> no
Date Last log was _____
Was CO ₂ encountered? _____ yes <input checked="" type="checkbox"/> no at what deptns? _____
Was H ₂ S encountered? _____ yes <input checked="" type="checkbox"/> no at what deptns? _____
Were unusual drilling circumstances encountered? _____ yes _____ no If yes, briefly explain _____

OCC - This well is an open hole completion from the bottom of the 7" casing at 7683' to terminus at 12,600'. The 4 1/2" liner is not cemented

640 Acres

If more than three drainholes are proposed, attach a separate sheet indicating the necessary information.

Direction must be stated in degrees azimuth. Please note, the horizontal drainhole and its end point must be located within the boundaries of the lease or spacing unit.

Directional surveys are required for all drainholes and directional wells.

640 Acres

BOTTOM HOLE LOCATION FOR DIRECTIONAL HOLE								
SEC	TWP	RGE	COUNTY					
Spot Location			Feet From 1/4 Sec Lines			FSL	FWL	
1/4	1/4	1/4	1/4	1/4	1/4			
Measured Total Depth		True Vertical Depth		BHL From Lease, Unit, or Property Line:				

BOTTOM HOLE LOCATION FOR HORIZONTAL HOLE: (LATERALS)										
LATERAL #1										
SEC	TWP	RGE	COUNTY							
22	18N	7W	Kingfisher							
Spot Location			Feet From 1/4 Sec Lines			FSL	FEL			
SE	1/4	SW	1/4	SE	1/4	SE	1/4	76	931	
Depth of Deviation		Radius of Turn		Direction		Total Length				
		6784		1104	161.1			4810		
Measured Total Depth		True Vertical Depth		End Pt Location From Lease, Unit or Property Line:						
12,600		7,384		76						

LATERAL #2								
SEC	TWP	RGE	COUNTY					
Spot Location			Feet From 1/4 Sec Lines			FSL	FWL	
1/4	1/4	1/4	1/4	1/4	1/4			
Depth of Deviation		Radius of Turn		Direction		Total Length		
Measured Total Depth		True Vertical Depth		End Pt Location From Lease, Unit or Property Line:				

LATERAL #3								
SEC	TWP	RGE	COUNTY					
Spot Location			Feet From 1/4 Sec Lines			FSL	FWL	
1/4	1/4	1/4	1/4	1/4	1/4			
Depth of Deviation		Radius of Turn		Direction		Total Length		
Measured Total Depth		True Vertical Depth		End Pt Location From Lease, Unit or Property Line:				