

Oklahoma Corporation Commission
Oil & Gas Conservation Division
Post Office Box 52000
Oklahoma City, Oklahoma 73152-2000
Rule 165: 10-3-25

Form 1002A

API No.: 35081242330000

Completion Report

Spud Date: September 29, 2015

OTC Prod. Unit No.:

Drilling Finished Date: October 05, 2015

1st Prod Date: June 01, 2016

Completion Date: November 05, 2015

Drill Type: STRAIGHT HOLE

Well Name: OTTO HARRISON 5

Purchaser/Measurer:

Location: LINCOLN 8 16N 5E
NE NE NE SW
2322 FSL 2333 FWL of 1/4 SEC
Derrick Elevation: 0 Ground Elevation: 0

First Sales Date:

Operator: DANICK OPERATING USA INC 23273

5005 LYNDON B JOHNSON FWY STE 1250
DALLAS, TX 75244-6100

Completion Type	
	Single Zone
	Multiple Zone
X	Commingled

Location Exception
Order No
645483

Increased Density
Order No
There are no Increased Density records to display.

Casing and Cement							
Type	Size	Weight	Grade	Feet	PSI	SAX	Top of CMT
CONDUCTOR	20			40			
SURFACE	8 5/8	24	J-55	1014		450	SURFACE
PRODUCTION	4 1/2	10.5	J-55	3802		225	

Liner								
Type	Size	Weight	Grade	Length	PSI	SAX	Top Depth	Bottom Depth
There are no Liner records to display.								

Total Depth: 3825

Packer	
Depth	Brand & Type
There are no Packer records to display.	

Plug	
Depth	Plug Type
There are no Plug records to display.	

Initial Test Data										
Test Date	Formation	Oil BBL/Day	Oil-Gravity (API)	Gas MCF/Day	Gas-Oil Ratio Cu FT/BBL	Water BBL/Day	Pumpin or Flowing	Initial Shut-In Pressure	Choke Size	Flow Tubing Pressure
Jun 01, 2016	PRUE	8	40	60	7500		PUMPING			
May 20, 2016	OSWEGO			20			PUMPING			

Completion and Test Data by Producing Formation										
Formation Name: PRUE			Code: 404PRUE			Class: OIL				
Spacing Orders				Perforated Intervals						
Order No	Unit Size			From	To					
644664	160			3516	3562					
Acid Volumes				Fracture Treatments						
3,000 GALLONS				3,200 BARRELS FLUID, 150,000 POUNDS						

Formation Name: OSWEGO			Code: 404OSWG			Class: GAS				
Spacing Orders				Perforated Intervals						
Order No	Unit Size			From	To					
644664	160			3447	3463					
Acid Volumes				Fracture Treatments						
3,500 GALLONS				There are no Fracture Treatments records to display.						

Formation	Top
OSWEGO	3440
PRUE	3510
VERDIGRIS	3560

Were open hole logs run? Yes

Date last log run: October 15, 2015

Were unusual drilling circumstances encountered? No

Explanation:

Other Remarks
There are no Other Remarks.

FOR COMMISSION USE ONLY

1134269

Status: Accepted

RECEIVED

Form 1002A Rev. 2009

AUG 29 2016

OKLAHOMA CORPORATION COMMISSION

API NO. 081-24233
OTC PROD.
UNIT NO.

PLEASE TYPE OR USE BLACK INK ONLY
NOTE:

Attach copy of original 1002A if recompletion or reentry.

OKLAHOMA CORPORATION COMMISSION
Oil & Gas Conservation Division
Post Office Box 52000
Oklahoma City, Oklahoma 73152-2000
Rule 165:10-3-25

ORIGINAL
AMENDED (Reason)

COMPLETION REPORT

TYPE OF DRILLING OPERATION
STRAIGHT HOLE
DIRECTIONAL HOLE
HORIZONTAL HOLE
SERVICE WELL

SPUD DATE 09-29-2015
DRLG FINISHED DATE 10-05-2015
DATE OF WELL COMPLETION 11-05-2015
1st PROD DATE 6-1-2016
RECOMP DATE

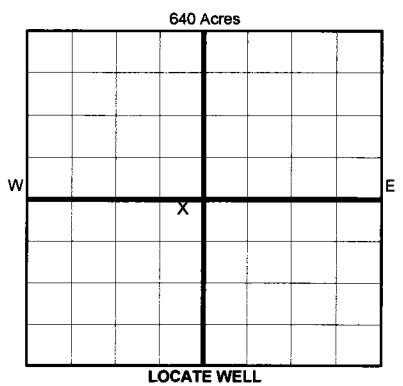

COUNTY LINCOLN SEC 8 TWP 16N RGE 05E
LEASE NAME OTTO HARRISON WELL NO. 5
NE 1/4 NE 1/4 NE 1/4 SW 1/4 FSL OF 1/4 SEC 2,322' FWL OF 1/4 SEC 2,333'
ELEVATIO Ground Latitude (if known) Longitude (if known)
OPERATOR NAME DANICK OPERATING OTC/OCC OPERATOR NO. 23273
ADDRESS 500 LBJ FREEWAY SUITE 1250
CITY DALLAS STATE TX ZIP 75244

COMPLETION TYPE

SINGLE ZONE
MULTIPLE ZONE
Application Date
COMMINGLED
Application Date
LOCATION
EXCEPTION ORDER
INCREASED DENSITY
ORDER NO. 645483

CASING & CEMENT (Form 1002C must be attached)

Table with columns: TYPE, SIZE, WEIGHT, GRADE, FEET, PSI, SAX, TOP OF CMT. Includes rows for CONDUCTOR, SURFACE, INTERMEDIATE, PRODUCTION, LINER.

Per 1002C

PACKER @ BRAND & TYPE PLUG @ TYPE PLUG @ TYPE
PACKER @ BRAND & TYPE PLUG @ TYPE PLUG @ TYPE

TOTAL DEPTH 3825'

COMPLETION & TEST DATA BY PRODUCING FORMATION

Table with columns: FORMATION, ORDER NUMBER, CLASS, PERFORATED INTERVALS, ACID/VOLUME, FRACTURE TREATMENT. Includes handwritten entries for PRUE and OSWEGO formations.

Monitor Report to Free-Focus

Min Gas Allowable OR Oil Allowable (165:10-17-7) (165:10-13-3)

Gas Purchaser/Measurer First Sales Date

INITIAL TEST DATA

Table with columns: INITIAL TEST DATE, OIL-BBL/DAY, OIL-GRAVITY (API), GAS-MCF/DAY, GAS-OIL RATIO CU FT/BBL, WATER-BBL/DAY, PUMPING OR FLOWING, INITIAL SHUT-IN PRESSURE, CHOKE SIZE, FLOW TUBING PRESSURE.

AS SUBMITTED

A record of the formations drilled through, and pertinent remarks are presented on the reverse. I declare that I have knowledge of the contents of this report and am authorized by my organization to make this report, which was prepared by me or under my supervision and direction, with the data and facts stated herein to be true, correct, and complete to the best of my knowledge and belief.
SIGNATURE DAN LANE DATE 8/20/2016 PHONE NUMBER 214-8272222
5005 LBJ FREEWAY SUITE 1250 DALLAS TX 75244 D.LANE@DANICKRESOURCES.COM
ADDRESS CITY STATE ZIP EMAIL ADDRESS

PLEASE TYPE OR USE BLACK INK ONLY
FORMATION RECORD

Give formation names and tops, if available, or descriptions and thickness of formations drilled through. Show intervals cored or drillstem tested.

LEASE NAME OTTO HARRISON WELL NO. 5

NAMES OF FORMATIONS	TOP
OSWEGO	3,440
PRUE	3,510
VERDIGRIS	3,560

FOR COMMISSION USE ONLY

ITD on file YES NO

APPROVED _____ DISAPPROVED _____

2) Reject Codes

Were open hole logs run? yes no

Date Last log was run 10/15/2015

Was CO₂ encountered? yes no at what depths? _____

Was H₂S encountered? yes no at what depths? _____

Were unusual drilling circumstances encountered? yes no

If yes, briefly explain below

Other remarks:

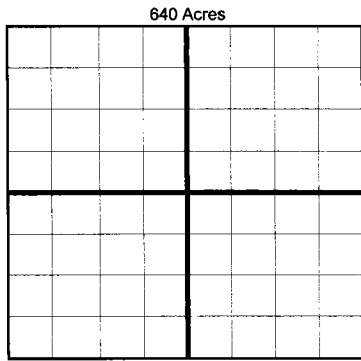

If more than three drainholes are proposed, attach a separate sheet indicating the necessary information.

Direction must be stated in degrees azimuth. Please note, the horizontal drainhole and its end point must be located within the boundaries of the lease or spacing unit.

Directional surveys are required for all drainholes and directional wells.

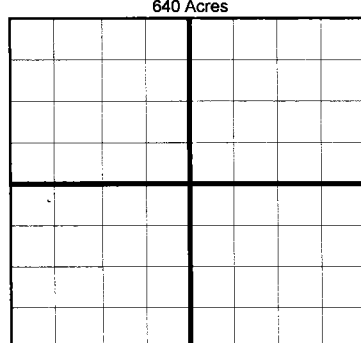

BOTTOM HOLE LOCATION FOR DIRECTIONAL HOLE

SEC	TWP	RGE	COUNTY	Spot Location	Feet From 1/4 Sec Lines	FSL	FWL
				1/4	1/4	1/4	1/4
Measured Total Depth		True Vertical Depth		BHL From Lease, Unit, or Property Line:			

BOTTOM HOLE LOCATION FOR HORIZONTAL HOLE: (LATERALS)

LATERAL #1

SEC	TWP	RGE	COUNTY	Spot Location	Feet From 1/4 Sec Lines	FSL	FWL
				1/4	1/4	1/4	1/4
Depth of Deviation		Radius of Turn		Direction		Total Length	
Measured Total Depth		True Vertical Depth		BHL From Lease, Unit, or Property Line:			

LATERAL #2

SEC	TWP	RGE	COUNTY	Spot Location	Feet From 1/4 Sec Lines	FSL	FWL
				1/4	1/4	1/4	1/4
Depth of Deviation		Radius of Turn		Direction		Total Length	
Measured Total Depth		True Vertical Depth		BHL From Lease, Unit, or Property Line:			

LATERAL #3

SEC	TWP	RGE	COUNTY	Spot Location	Feet From 1/4 Sec Lines	FSL	FWL
				1/4	1/4	1/4	1/4
Depth of Deviation		Radius of Turn		Direction		Total Length	
Measured Total Depth		True Vertical Depth		BHL From Lease, Unit, or Property Line:			