

Oklahoma Corporation Commission  
Oil & Gas Conservation Division  
Post Office Box 52000  
Oklahoma City, Oklahoma 73152-2000  
Rule 165: 10-3-25

Form 1002A

API No.: 35087220420000

**Completion Report**

Spud Date: March 18, 2016

OTC Prod. Unit No.: 087-217607

Drilling Finished Date: April 27, 2016

1st Prod Date: June 30, 2016

Completion Date: June 30, 2016

**Drill Type: HORIZONTAL HOLE**

Min Gas Allowable: Yes

Well Name: HEDRICK 1H-1XX

Purchaser/Measurer: NEWFIELD

Location: MCCLAIN 36 7N 4W  
NW SW SE SE  
440 FSL 1075 FEL of 1/4 SEC  
Latitude: 35.03091 Longitude: -97.56833  
Derrick Elevation: 1256 Ground Elevation: 1228

First Sales Date: 06/30/2016

Operator: NEWFIELD EXPLORATION MID-CON INC 20944

1 WILLIAMS CTR STE 1900  
TULSA, OK 74172-0162

Completion Type	
X	Single Zone
	Multiple Zone
	Commingled

Location Exception	
Order No	
653046	

Increased Density	
Order No	
There are no Increased Density records to display.	

Casing and Cement							
Type	Size	Weight	Grade	Feet	PSI	SAX	Top of CMT
CONDUCTOR	20	94	J-55	108		27	SURFACE
SURFACE	9 5/8	40	K-55	1500	1500	410	SURFACE
PRODUCTION	5 1/2	20	P-110	23099	11500	3005	831

Liner								
Type	Size	Weight	Grade	Length	PSI	SAX	Top Depth	Bottom Depth
There are no Liner records to display.								

**Total Depth: 23105**

Packer	
Depth	Brand & Type
There are no Packer records to display.	

Plug	
Depth	Plug Type
There are no Plug records to display.	

Initial Test Data										
Test Date	Formation	Oil BBL/Day	Oil-Gravity (API)	Gas MCF/Day	Gas-Oil Ratio Cu FT/BBL	Water BBL/Day	Pumpin or Flowing	Initial Shut-In Pressure	Choke Size	Flow Tubing Pressure
Jul 12, 2016	WOODFORD	501	40.5	532	1062	1502	FLOWING	1250	64	189

Completion and Test Data by Producing Formation										
Formation Name: WOODFORD			Code: 319WDFD			Class: OIL				
<b>Spacing Orders</b>				<b>Perforated Intervals</b>						
<b>Order No</b>	<b>Unit Size</b>			<b>From</b>			<b>To</b>			
637464	640			10200			22957			
651901	640									
653112	MULTIUNIT									
<b>Acid Volumes</b>				<b>Fracture Treatments</b>						
31,158 GALS 15% HCL				14,225,970 # PROPPANT 508,884 BLWTR						

Formation	Top
LOWER BLACK MARKER	9668
CANEY	9738
WOODFORD	9770

Were open hole logs run? No

Date last log run:

Were unusual drilling circumstances encountered? No

Explanation:

Other Remarks
OCC: FLE ORDER HAS NOT BEEN ISSUED. WE HAVE ACCEPTED OPERATORS DATA AS SUBMITTED. IRREGULAR SECTION.

Lateral Holes
Sec: 13 TWP: 6N RGE: 4W County: MCCLAIN
SW SE SE NE
2548 FNL 567 FEL of 1/4 SEC
Depth of Deviation: 9587 Radius of Turn: 857 Direction: 180 Total Length: 13515
Measured Total Depth: 23105 True Vertical Depth: 10061 End Pt. Location From Release, Unit or Property Line: 567

FOR COMMISSION USE ONLY
Status: Accepted
1133852

# Well Location Plat

M & M Land Surveying, Inc.

520 "E" Street NW. Ardmore, OK. 73401

Office 580-226-0446 Mobile 580-221-4999 Fax 580-226-7158

Company Name: Newfield Exploration Mid-Continent, Inc. Lease Name: Hedrick #1H-1XX

Section 36 Township 7 North Range 4 West County McClain Oklahoma

Surface Location 440' FSL - 1075' FEL Elevation 1228' Good Location? Yes

Topography

Location fell on existing pad 40' North of the Goshorn #1H-25x.

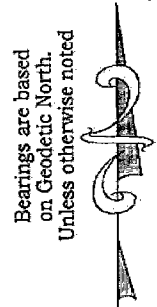
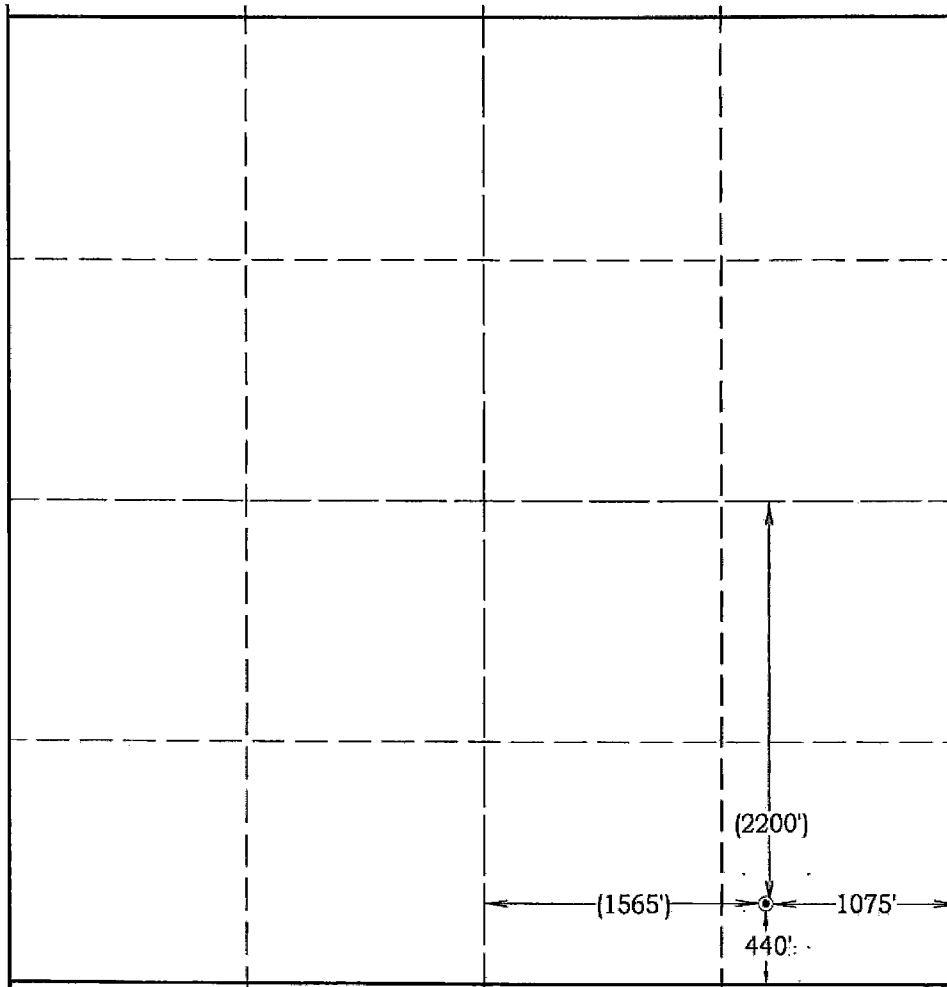

Scale: 1" = 1000'  
Invoice #16025  
Date 1/26/16

Elevations of Proposed Pad Corners

NW/C - N/A  
NE/C - N/A  
SE/C - N/A  
SW/C - N/A

Coordinates were derived from GPS RTK methods and are only accurate within ±10 feet

Location GPS NAD 27

Oklahoma South  
Surface Location  
Latitude: 35.03084°  
Longitude: 97.56802°  
Y= 618,029'  
X = 2,129,327'

Location NAD 83

Surface Location  
Latitude: 35.03091°  
Longitude: 97.56833°  
Y= 618,071'  
X = 2,097,730'

Best Accessibility to Location  
From the South

Distance & From the Jct. of S.H. #59 and S.H.#39, go 1 mile North on May Ave. to the  
Direction From Southeast corner of Section 36.  
Highway or Town \_\_\_\_\_

## CERTIFICATE:

I, D. Harry McClintick, a Registered Land Surveyor in the state of Oklahoma, do hereby certify that the above described Well Location was surveyed and staked on the ground as shown.

D. Harry McClintick 2/16/16  
D. Harry McClintick, R.P.L.S. # 1367, CA # 3093

This location has been staked according to the best official survey records available to us, but its accuracy is not guaranteed. Please review this plat and notify us immediately of any discrepancy.

The distances shown in parenthesis ( ) are calculated distances based on the quarter section being 2640' and have not been measured.

