

Oklahoma Corporation Commission  
Oil & Gas Conservation Division  
Post Office Box 52000  
Oklahoma City, Oklahoma 73152-2000  
Rule 165: 10-3-25

Form 1002A

API No.: 35095206500000

**Completion Report**

Spud Date: April 05, 2015

OTC Prod. Unit No.: 095-217243

Drilling Finished Date: August 07, 2015

1st Prod Date: July 01, 2016

Completion Date: July 01, 2016

**Drill Type: HORIZONTAL HOLE**

Well Name: DOROTHY 1-11H

Purchaser/Measurer:

Location: MARSHALL 11 5S 6E  
NW NW NE NW  
250 FNL 1380 FWL of 1/4 SEC  
Derrick Elevation: 0 Ground Elevation: 731

First Sales Date:

Operator: XTO ENERGY INC 21003

210 W PARK AVE STE 2350  
OKLAHOMA CITY, OK 73102-5683

Completion Type	
X	Single Zone
	Multiple Zone
	Commingled

Location Exception	
Order No	
653407	

Increased Density	
Order No	
640273	

Casing and Cement							
Type	Size	Weight	Grade	Feet	PSI	SAX	Top of CMT
CONDUCTOR	20	90	J-55	110			SURFACE
SURFACE	9 5/8	36	J-55	1026		590	SURFACE
PRODUCTION	5 1/2	20, 23	P-110	11786		1450	5628

Liner								
Type	Size	Weight	Grade	Length	PSI	SAX	Top Depth	Bottom Depth
There are no Liner records to display.								

**Total Depth: 11790**

Packer	
Depth	Brand & Type
6458	MODEL D

Plug	
Depth	Plug Type
There are no Plug records to display.	

Initial Test Data										
Test Date	Formation	Oil BBL/Day	Oil-Gravity (API)	Gas MCF/Day	Gas-Oil Ratio Cu FT/BBL	Water BBL/Day	Pumpin or Flowing	Initial Shut-In Pressure	Choke Size	Flow Tubing Pressure
Jul 24, 2016	WOODFORD	156	39	1003	6429	540	FLOWING	600	OPEN	235

Completion and Test Data by Producing Formation										
Formation Name: WOODFORD			Code: 319WDFD			Class: OIL				
<b>Spacing Orders</b>				<b>Perforated Intervals</b>						
<b>Order No</b>	<b>Unit Size</b>			<b>From</b>			<b>To</b>			
562312	640			6660			11633			
<b>Acid Volumes</b>				<b>Fracture Treatments</b>						
33,500 GALLONS				196,298 BTW, 644,580 POUNDS 100 MESH, 4,404,014 POUNDS 40/70						

Formation	Top
WOODFORD	6468

Were open hole logs run? No

Date last log run:

Were unusual drilling circumstances encountered? No

Explanation:

Other Remarks
IRREGULAR SECTION

Lateral Holes
Sec: 11 TWP: 5S RGE: 6E County: MARSHALL
SE SW SW SW
75 FSL 362 FWL of 1/4 SEC
Depth of Deviation: 6148 Radius of Turn: 1359 Direction: 192 Total Length: 5054
Measured Total Depth: 11790 True Vertical Depth: 5942 End Pt. Location From Release, Unit or Property Line: 4958

FOR COMMISSION USE ONLY
Status: Accepted
1134041

RECEIVED

Form 1002A Rev. 2009

JUL 26 2016

OKLAHOMA CORPORATION COMMISSION

API NO 095-20650
OTC PROD UNIT NO 095-217243

PLEASE TYPE OR USE BLACK INK ONLY
NOTE:

Attach copy of original 1002A if recompletion or reentry.

OKLAHOMA CORPORATION COMMISSION
Oil & Gas Conservation Division
Post Office Box 52000
Oklahoma City, Oklahoma 73152-2000
Rule 165:10-3-25

ORIGINAL
AMENDED (Reason)

COMPLETION REPORT

TYPE OF DRILLING OPERATION
STRAIGHT HOLE
DIRECTIONAL HOLE
HORIZONTAL HOLE
SERVICE WELL

SPUD DATE 4/5/2015
DRLG FINISHED DATE 8/7/2015
DATE OF WELL COMPLETION 7/1/2016
1st PROD DATE 7/1/2016
RECOMP DATE
ELEVATION Derrick FL Ground 731'
Latitude (if known) 34.142786°N
Longitude (if known) 96.649063°W
OPERATOR NAME XTO Energy Inc.
OTC/OCC OPERATOR NO. 21003
ADDRESS 210 Park Avenue, Suite 2350
CITY Oklahoma City STATE Oklahoma ZIP 73102

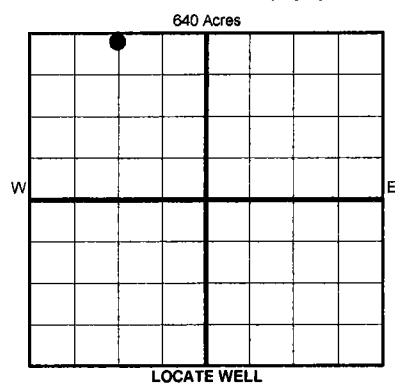

COUNTY Marshall SEC 11 TWP 5S RGE 6E
LEASE NAME Dorothy
WELL NO 1-11H
NW 1/4 NW 1/4 NE 1/4 NW 1/4
FNL OF 1/4 SEC 250' FWL OF 1/4 SEC 1380'
OPERATOR NAME XTO Energy Inc.
ADDRESS 210 Park Avenue, Suite 2350
CITY Oklahoma City STATE Oklahoma ZIP 73102

COMPLETION TYPE
X SINGLE ZONE
MULTIPLE ZONE
COMMINGLED
LOCATION EXCEPTION ORDER NO. 653407 F.O.
INCREASED DENSITY ORDER NO. 640273

Table with columns: TYPE, SIZE, WEIGHT, GRADE, FEET, PSI, SAX, TOP OF CMT. Rows include CONDUCTOR, SURFACE, INTERMEDIATE, PRODUCTION, LINER.

PACKER @ 6,458 BRAND & TYPE Model D
PLUG @ TYPE PLUG @ TYPE
TOTAL DEPTH 11,790'

Table with columns: FORMATION, SPACING & SPACING ORDER NUMBER, CLASS, PERFORATED INTERVALS, ACID/VOLUME, FRACTURE TREATMENT. Includes handwritten notes like '319 WDFD' and 'Reported to Frac Focus'.

INITIAL TEST DATA
Min Gas Allowable (165:10-17-7)
OR
Oil Allowable (165:10-13-3)
Gas Purchaser/Measurer
First Sales Date

Table with columns: INITIAL TEST DATE, OIL-BBL/DAY, OIL-GRAVITY (API), GAS-MCF/DAY, GAS-OIL RATIO CU FT/BBL, WATER-BBL/DAY, PUMPING OR FLOWING, INITIAL SHUT-IN PRESSURE, CHOKE SIZE, FLOW TUBING PRESSURE.

AS SUBMITTED

A record of the formations drilled through, and pertinent remarks are presented on the reverse. I declare that I have knowledge of the contents of this report and am authorized by my organization to make this report, which was prepared by me or under my supervision and direction, with the data and facts stated herein to be true, correct, and complete to the best of my knowledge and belief.
Signature: Debbie Waggoner
Address: 210 Park Avenue, Suite 2350, Oklahoma City, OK 73102
Date: 7/25/2016
Phone Number: 405-319-3243
Email Address: debbie\_waggoner@xtoenergy.com

PLEASE TYPE OR USE BLACK INK ONLY  
FORMATION RECORD

Give formation names and tops, if available, or descriptions and thickness of formations drilled through. Show intervals cored or drillstem tested.

LEASE NAME DOROTHY WELL NO. 1-11H

NAMES OF FORMATIONS	TOP
WOODFORD	6,468

FOR COMMISSION USE ONLY

ITD on file  YES  NO

APPROVED \_\_\_\_\_ DISAPPROVED \_\_\_\_\_

2) Reject Codes

\_\_\_\_\_

\_\_\_\_\_

\_\_\_\_\_

\_\_\_\_\_

Were open hole logs run? \_\_\_ yes  no

Date Last log was run \_\_\_\_\_

Was CO<sub>2</sub> encountered? \_\_\_ yes  no at what depths? \_\_\_\_\_

Was H<sub>2</sub>S encountered? \_\_\_ yes  no at what depths? \_\_\_\_\_

Were unusual drilling circumstances encountered? \_\_\_ yes  no

If yes, briefly explain below: \_\_\_\_\_

Other remarks: Irregular Section

\_\_\_\_\_

\_\_\_\_\_

\_\_\_\_\_

\_\_\_\_\_

640 Acres

If more than three drainholes are proposed, attach a separate sheet indicating the necessary information.

Direction must be stated in degrees azimuth. Please note, the horizontal drainhole and its end point must be located within the boundaries of the lease or spacing unit.

Directional surveys are required for all drainholes and directional wells.

640 Acres

BOTTOM HOLE LOCATION FOR DIRECTIONAL HOLE

SEC	TWP	RGE	COUNTY				
Spot Location	1/4	1/4	1/4	1/4	Feet From 1/4 Sec Lines	FSL	FWL
Measured Total Depth	True Vertical Depth		BHL From Lease, Unit, or Property Line:				

BOTTOM HOLE LOCATION FOR HORIZONTAL HOLE: (LATERALS)

LATERAL #1

SEC	TWP	RGE	COUNTY				
SEC 11	5S	6E	Marshall				
Spot Location	SE 1/4	SW 1/4	SW 1/4	SW 1/4	Feet From 1/4 Sec Lines	FSL 75'	FWL 362'
Depth of Deviation	6,148		Radius of Turn	1359		Direction	192°
Measured Total Depth	11,790'		True Vertical Depth	5942'		Total Length	5,054
BHL From Lease, Unit, or Property Line: 4958' FSL & 930' FWL							

LATERAL #2

SEC	TWP	RGE	COUNTY				
Spot Location	1/4	1/4	1/4	1/4	Feet From 1/4 Sec Lines	FSL	FWL
Depth of Deviation	Radius of Turn		Direction		Total Length		
Measured Total Depth	True Vertical Depth		BHL From Lease, Unit, or Property Line:				

LATERAL #3

SEC	TWP	RGE	COUNTY				
Spot Location	1/4	1/4	1/4	1/4	Feet From 1/4 Sec Lines	FSL	FWL
Depth of Deviation	Radius of Turn		Direction		Total Length		
Measured Total Depth	True Vertical Depth		BHL From Lease, Unit, or Property Line:				