

Oklahoma Corporation Commission
 Oil & Gas Conservation Division
 Post Office Box 52000
 Oklahoma City, Oklahoma 73152-2000
 Rule 165: 10-3-25

Form 1002A

API No.: 35095206520000

Completion Report

Spud Date: April 11, 2015

OTC Prod. Unit No.: 095-217257

Drilling Finished Date: September 14, 2015

1st Prod Date: June 27, 2016

Completion Date: June 27, 2016

Drill Type: HORIZONTAL HOLE

Well Name: DOROTHY 3-11H

Purchaser/Measurer:

Location: MARSHALL 11 5S 6E
 NW NW NE NW
 250 FNL 1420 FWL of 1/4 SEC
 Derrick Elevation: 0 Ground Elevation: 731

First Sales Date:

Operator: XTO ENERGY INC 21003

210 W PARK AVE STE 2350
 OKLAHOMA CITY, OK 73102-5683

Completion Type	
X	Single Zone
	Multiple Zone
	Commingled

Location Exception	
Order No	
653408	

Increased Density	
Order No	
640273	

Casing and Cement							
Type	Size	Weight	Grade	Feet	PSI	SAX	Top of CMT
CONDUCTOR	20	94	J-55	111			SURFACE
SURFACE	9 5/8	36	J-55	1048		510	SURFACE
PRODUCTION	5 1/2	20, 23	P-110	11452		1445	2854

Liner								
Type	Size	Weight	Grade	Length	PSI	SAX	Top Depth	Bottom Depth
There are no Liner records to display.								

Total Depth: 11452

Packer	
Depth	Brand & Type
6112	MODEL R

Plug	
Depth	Plug Type
There are no Plug records to display.	

Initial Test Data										
Test Date	Formation	Oil BBL/Day	Oil-Gravity (API)	Gas MCF/Day	Gas-Oil Ratio Cu FT/BBL	Water BBL/Day	Pumpin or Flowing	Initial Shut-In Pressure	Choke Size	Flow Tubing Pressure
Jul 24, 2016	WOODFORD	170	39	1235	7265	538	FLOWING	500	OPEN	290

Completion and Test Data by Producing Formation										
Formation Name: WOODFORD			Code: 319WDFD			Class: OIL				
Spacing Orders				Perforated Intervals						
Order No	Unit Size			From			To			
562312	640			6336			11313			
Acid Volumes				Fracture Treatments						
32,000 GALLONS				16 STAGES - 199,016 GALLONS, 648,805 POUNDS 100 MESH, 4,533,260 POUNDS 40/70						

Formation	Top
WOODFORD	6076

Were open hole logs run? No

Date last log run:

Were unusual drilling circumstances encountered? No

Explanation:

Other Remarks
IRREGULAR SECTION

Lateral Holes
Sec: 11 TWP: 5S RGE: 6E County: MARSHALL
SW SE SE SW
51 FSL 2001 FWL of 1/4 SEC
Depth of Deviation: 5835 Radius of Turn: 1410 Direction: 173 Total Length: 5008
Measured Total Depth: 11452 True Vertical Depth: 5782 End Pt. Location From Release, Unit or Property Line: 51

FOR COMMISSION USE ONLY
Status: Accepted
1134040

RECEIVED

Form 1002A Rev. 2009

JUL 26 2016

OKLAHOMA CORPORATION COMMISSION

API NO. 095-20652
OTC PROD UNIT NO. 095-217257

PLEASE TYPE OR USE BLACK INK ONLY NOTE:

Attach copy of original 1002A if recompletion or reentry.

OKLAHOMA CORPORATION COMMISSION Oil & Gas Conservation Division Post Office Box 52000 Oklahoma City, Oklahoma 73152-2000 Rule 165-10-3-25

ORIGINAL AMENDED (Reason)

COMPLETION REPORT

TYPE OF DRILLING OPERATION STRAIGHT HOLE DIRECTIONAL HOLE HORIZONTAL HOLE

SPUD DATE 4/11/2015
DRLG FINISHED DATE 9/14/2015
DATE OF WELL COMPLETION 6/27/2016
1st PROD DATE 6/27/2016
RECOMP DATE
Elevation Derrick FL Ground 731'
Latitude (if known) 34.142786°N
Longitude (if known) 96.648931°W
OPERATOR NAME XTO Energy Inc.
ADDRESS 210 Park Avenue, Suite 2350
CITY Oklahoma City STATE Oklahoma ZIP 73102

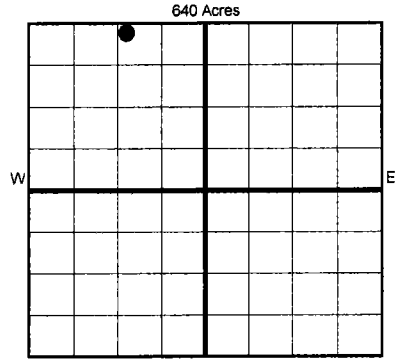

COUNTY Marshall SEC 11 TWP 5S RGE 6E
LEASE NAME Dorothy
NW 1/4 NW 1/4 NE 1/4 NW 1/4 ENL OF 1/4 SEC 250' FWL OF 1/4 SEC 1420'
OPERATOR NAME XTO Energy Inc.
ADDRESS 210 Park Avenue, Suite 2350
CITY Oklahoma City STATE Oklahoma ZIP 73102

COMPLETION TYPE SINGLE ZONE
MULTIPLE ZONE
COMMINGLED
LOCATION EXCEPTION ORDER NO. 653408 F.O.
INCREASED DENSITY ORDER NO. 640273

Table with columns: TYPE, SIZE, WEIGHT, GRADE, FEET, PSI, SAX, TOP OF CMT. Rows include CONDUCTOR, SURFACE, INTERMEDIATE, PRODUCTION, LINER.

PACKER @ 6112' BRAND & TYPE Model R PLUG @ TYPE PLUG @ TYPE
PACKER @ BRAND & TYPE PLUG @ TYPE PLUG @ TYPE

COMPLETION & TEST DATA BY PRODUCING FORMATION 319 WDFD
FORMATION Woodford
SPACING & SPACING ORDER NUMBER 640: 562312
CLASS Oil, Gas, Dry, Inj, Disp, Comm Disp, Svc Oil
PERFORATED INTERVALS 16 Stages 6336-11,313'
ACID/VOLUME 32,000 gals
FRACTURE TREATMENT (Fluids/Prop Amounts) 199,016 gals 648,805# 100 Mesh 4,533,260# 40/70

Reported to Frac Focus

INITIAL TEST DATA Min Gas Allowable (165-10-17-7) OR Gas Purchaser/Measurer First Sales Date

Table with columns: INITIAL TEST DATE, OIL-BBL/DAY, OIL-GRAVITY (API), GAS-MCF/DAY, GAS-OIL RATIO CU FT/BBL, WATER-BBL/DAY, PUMPING OR FLOWING, INITIAL SHUT-IN PRESSURE, CHOKE SIZE, FLOW TUBING PRESSURE.

AS SUBMITTED

A record of the formations drilled through, and pertinent remarks are presented on the reverse. I declare that I have knowledge of the contents of this report and am authorized by my organization to make this report, which was prepared by me or under my supervision and direction, with the data and facts stated herein to be true, correct, and complete to the best of my knowledge and belief.
Signature: Debbie Waggoner
Name: Debbie Waggoner
Date: 7/25/2016
Phone Number: 405-319-3243
Address: 210 Park Avenue, Suite 2350, Oklahoma City, Ok 73102
Email: debbie_waggoner@xtoenergy.com

PLEASE TYPE OR USE BLACK INK ONLY
FORMATION RECORD

Give formation names and tops, if available, or descriptions and thickness of formations drilled through. Show intervals cored or drillstem tested.

LEASE NAME DOROTHY WELL NO. 3-11H

NAMES OF FORMATIONS	TOP
WOODFORD	6,076

FOR COMMISSION USE ONLY

ITD on file YES NO

APPROVED _____ DISAPPROVED _____

2) Reject Codes _____

Were open hole logs run? ___ yes no

Date Last log was run _____

Was CO₂ encountered? ___ yes no at what depths? _____

Was H₂S encountered? ___ yes no at what depths? _____

Were unusual drilling circumstances encountered? ___ yes no
If yes, briefly explain below: _____

Other remarks: Irregular Section

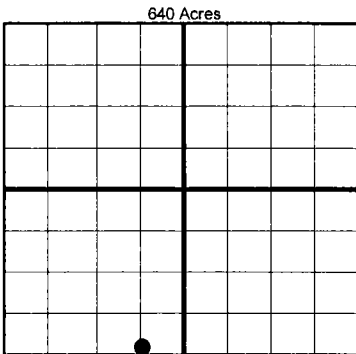

If more than three drainholes are proposed, attach a separate sheet indicating the necessary information.

Direction must be stated in degrees azimuth. Please note, the horizontal drainhole and its end point must be located within the boundaries of the lease or spacing unit.

Directional surveys are required for all drainholes and directional wells.

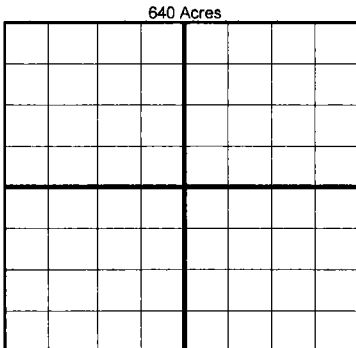

BOTTOM HOLE LOCATION FOR DIRECTIONAL HOLE

SEC	TWP	RGE	COUNTY				
Spot Location	1/4	1/4	1/4	1/4	Feet From 1/4 Sec Lines	FSL	FWL
Measured Total Depth	True Vertical Depth		BHL From Lease, Unit, or Property Line:				

BOTTOM HOLE LOCATION FOR HORIZONTAL HOLE: (LATERALS)

LATERAL #1

SEC	TWP	RGE	COUNTY							
11	5S	6E	Marshall							
Spot Location	SW 1/4	SE 1/4	SE 1/4	SW 1/4	Feet From 1/4 Sec Lines	FSL 51'	FWL 2001'			
Depth of Deviation	5,835		Radius of Turn	1410		Direction	173°	Total Length	5,008	
Measured Total Depth	11,452'		True Vertical Depth		5782'				BHL From Lease, Unit, or Property Line: 51' FSL & 2001' FWL	

LATERAL #2

SEC	TWP	RGE	COUNTY				
Spot Location	1/4	1/4	1/4	1/4	Feet From 1/4 Sec Lines	FSL	FWL
Depth of Deviation	Radius of Turn		Direction		Total Length		
Measured Total Depth	True Vertical Depth		BHL From Lease, Unit, or Property Line:				

LATERAL #3

SEC	TWP	RGE	COUNTY				
Spot Location	1/4	1/4	1/4	1/4	Feet From 1/4 Sec Lines	FSL	FWL
Depth of Deviation	Radius of Turn		Direction		Total Length		
Measured Total Depth	True Vertical Depth		BHL From Lease, Unit, or Property Line:				