

Oklahoma Corporation Commission
Oil & Gas Conservation Division
Post Office Box 52000
Oklahoma City, Oklahoma 73152-2000
Rule 165: 10-3-25

Form 1002A

API No.: 35003231590002

Completion Report

Spud Date: February 18, 2015

OTC Prod. Unit No.: 003-217630

Drilling Finished Date: March 11, 2015

Amended

1st Prod Date: June 30, 2016

Amend Reason: COMPLETED WELL

Completion Date: May 24, 2016

Drill Type: HORIZONTAL HOLE

Min Gas Allowable: Yes

Well Name: KRAUS 15-27-11 2H

Purchaser/Measurer: CHESAPEAKE OPERATING LLC

Location: ALFALFA 15 27N 11W
SW SE SE SW
159 FSL 2047 FWL of 1/4 SEC
Derrick Elevation: 1208 Ground Elevation: 1186

First Sales Date: 06/30/2016

Operator: CHESAPEAKE OPERATING LLC 17441
PO BOX 18496
6100 N WESTERN AVE
OKLAHOMA CITY, OK 73154-0496

Completion Type		Location Exception		Increased Density	
X	Single Zone	Order No		Order No	
	Multiple Zone	627519		627517	
	Commingle				

Casing and Cement							
Type	Size	Weight	Grade	Feet	PSI	SAX	Top of CMT
SURFACE	13 3/8	48	J-55	250		200	SURFACE
INTERMEDIATE	9 5/8	36	J-55	1205		320	SURFACE
PRODUCTION	7	26	P-110	5590		260	2468

Liner								
Type	Size	Weight	Grade	Length	PSI	SAX	Top Depth	Bottom Depth
LINER	4 1/2	11.6	P-110EC	4729	0	600	5372	10101

Total Depth: 10101

Packer	
Depth	Brand & Type
5311	AS-3

Plug	
Depth	Plug Type
There are no Plug records to display.	

Initial Test Data										
Test Date	Formation	Oil BBL/Day	Oil-Gravity (API)	Gas MCF/Day	Gas-Oil Ratio Cu FT/BBL	Water BBL/Day	Pumpin or Flowing	Initial Shut-In Pressure	Choke Size	Flow Tubing Pressure
Jul 12, 2016	MISSISSIPPIAN	340		1173	3450	1048	ARTIFICIA			147

Completion and Test Data by Producing Formation										
Formation Name: MISSISSIPPIAN				Code: 359MSSP				Class: OIL		
Spacing Orders				Perforated Intervals						
Order No		Unit Size		From			To			
615328		640		5600			9955			
Acid Volumes				Fracture Treatments						
8,000 GALLONS HCL ACID				38,860 BARRELS FRAC FLUID, 187,900 POUNDS PROPPANT						

Formation	Top
MISSISSIPPIAN	5353

Were open hole logs run? No

Date last log run:

Were unusual drilling circumstances encountered? No

Explanation:

Other Remarks
OCC - THIS DOCUMENT IS ACCEPTED BASED ON THE DATA SUBMITTED THE FINAL LOCATION EXCEPTION HAS NOT BEEN SUBMITTED.

Lateral Holes
Sec: 15 TWP: 27N RGE: 11W County: ALFALFA NE NE NE NW 186 FNL 2622 FWL of 1/4 SEC Depth of Deviation: 4930 Radius of Turn: 319 Direction: 358 Total Length: 4748 Measured Total Depth: 10101 True Vertical Depth: 5269 End Pt. Location From Release, Unit or Property Line: 186

FOR COMMISSION USE ONLY
<div>Status: Accepted</div> <div>1134005</div>

API NO. 35-003-23159
OTC PROD.
UNIT NO. 003-217630

PLEASE TYPE OR USE BLACK INK ONLY

NOTE:

Attach copy of original 1002A if recompletion or reentry.

OKLAHOMA CORPORATION COMMISSION

Oil & Gas Conservation Division

Post Office Box 52000

Oklahoma City, Oklahoma 73152-2000
Rule 165:10-3-25

RECEIVED

652842

Rev. 2009

JUL 21 2016

OKLAHOMA CORPORATION
COMMISSION

☐ ORIGINAL
☒ AMENDED

Reason Amended:

Completed Well
(Reclassify well as producing)

TYPE OF DRILLING OPERATION

☐ STRAIGHT HOLE ☐ DIRECTIONAL HOLE ☒ HORIZONTAL HOLE

If directional or horizontal, see reverse for bottom hole location.

COUNTY ALFALFA SEC 15 TWP 27N RGE 11W

LEASE NAME KRAUS 15-27-11 WELL NO 2H

SHL FSL FWL OF 159 1/4 SEC 2,047

ELEVATION 1,208 Ground 1,186 Latitude (if Known)

Derrick Fl 1,208 Ground 1,186

OPERATOR NAME CHESAPEAKE OPERATING, L.L.C.

OTC/OCC OPERATOR NO. 17441

ADDRESS P.O. BOX 18496

CITY OKLAHOMA CITY

STATE OK

ZIP 73154

COMPLETION REPORT

SPUD DATE 2/18/2015

DRLG FINISHED DATE 3/11/2015

DATE OF WELL COMPLETION 5/24/2016

1ST PROD DATE 6/30/2016

RECOMP DATE

Longitude

(if Known)

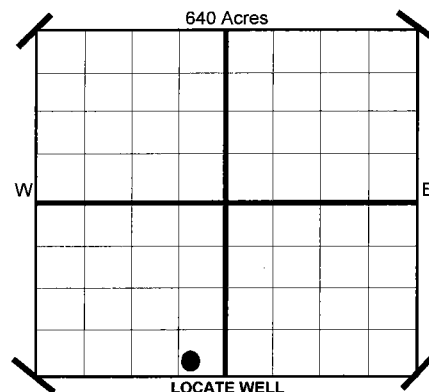

COMPLETION TYPE

<input checked="" type="checkbox"/>	SINGLE ZONE
<input type="checkbox"/>	MULTIPLE ZONE
<input type="checkbox"/>	Application Date
<input type="checkbox"/>	COMMINGLED
<input type="checkbox"/>	Application Date
LOCATION EXCEPTION ORDER NO. 627519 (INTERIM)	
INCREASED DENSITY ORDER NO. 627517	

CASING & CEMENT (Form 1002C must be attached)

TYPE	SIZE	WEIGHT	GRADE	FEET	PSI	SAX	TOP
CONDUCTOR							
SURFACE	13 3/8"	48#	J-55	250		200	SURFACE
INTERMEDIATE	9 5/8"	36#	J-55	1,205		320	SURFACE
PRODUCTION	7"	26#	P-110	5,590		260	2,468
LINER	4 1/2"	11.6#	P-110EC	5,372-10,101		600	5,372
						TOTAL DEPTH	10,101

PACKER @ 5.311 BRAND & TYPE AS-3

PLUG @ TYPE PLUG @ TYPE PLUG @ TYPE

COMPLETION & TEST DATA BY PRODUCING FORMATION

FORMATION	MISSISSIPPIAN								
SPACING & SPACING	640								
ORDER NUMBER	615328								
CLASS: Oil, Gas, Dry, Inj.									
Disp, Comm Disp, Svc	OIL								
PERFORATED INTERVALS	5,600-9,955								
ACID/VOLUME	HCL Acid 8,000 GALS								
FRACTURE TREATMENT (Fluids/Prop Amounts)	Frac Fluid 38,860 BBLs Proppant 187,900 LBS								

AS SUBMITTED

Reported to FracFocus

Minimum Gas Allowable (165:10-17-7)

Gas Purchaser/Measurer

Chesapeake Operating, L.L.C.

☒ OR

1st Sales Date

6/30/2016

INITIAL TEST DATA

INITIAL TEST DATE	7/12/2016								
OIL-BBL/DAY	340								
OIL-GRAVITY (API)									
GAS-MCF/DAY	1,173								
GAS-OIL RATIO CU FT/BBL	3,450								
WATER-BBL/DAY	1048								
PUMPING OR FLOWING	ARTIFICIAL LIFT								
INITIAL SHUT-IN PRESSURE									
CHOKE SIZE									
FLOW TUBING PRESSURE	147								

A record of the formations drilled through, and pertinent remarks are presented on the reverse. I declare that I have knowledge of the contents of this report and am authorized by my organization to make this report, which was prepared by me or under my supervision and direction, with the data and facts stated herein to be true, correct, and complete to the best of my knowledge and belief.

<i>JP Powell</i> SIGNATURE	JP Powell, Sr. Regulatory Analyst NAME (PRINT OR TYPE)	7/19/2016 DATE	405-848-8000 PHONE NUMBER
P.O. BOX 18496 ADDRESS	OKLAHOMA CITY CITY	OK STATE	73154 ZIP
		jp.powell@chk.com EMAIL ADDRESS	

Give formation names and tops, if available, or descriptions and thickness of formations drilled through. Show intervals cored or drillstem tested.

WELL NO. 2H

NAMES OF FORMATIONS	TOP
MISSISSIPPIAN	5,353

		FOR COMMISSION USE ONLY	
ITD on file	<input type="checkbox"/> YES	<input type="checkbox"/> NO	
APPROVED	DISAPPROVED		2) Reject Codes

Were open hole logs run?	_____ yes	<u>X</u> no
Date Last log was run	N/A	
Was CO ₂ encountered?	_____ yes	<u>X</u> no at what depths?
Was H ₂ S encountered?	_____ yes	<u>X</u> no at what depths?
Were unusual drilling circumstances encountered?	_____ yes	<u>X</u> no
If yes, briefly explain.		

Other remarks:

A 10x10 grid with a dot at the top center labeled "640 Acres".

If more than three drainholes are proposed, attach a separate sheet indicating the necessary information.

Direction must be stated in degrees azimuth.
Please note, the horizontal drainhole and its end
point must be located within the boundaries of the
lease or spacing unit.

Directional surveys are required for all drainholes and directional wells.

SEC	TWP	RGE	COUNTY			
Spot Location				Feet From 1/4 Sec Lines	FSL	FWL
1/4	1/4	1/4	1/4			
Measured Total Depth		True Vertical Depth		BHL From Lease, Unit, or Property Line:		

LATERAL #1										
SEC	15	TWP	27N	RGE	11W	COUNTY				
ALFALFA										
Spot Location		NE 1/4		NE 1/4		NW 1/4		Feet From 1/4 Sec Lines	FNL 186	FWL 2,622
Depth of Deviation		4,930		Radius of Turn		319		Direction	358	Total Length
Measured Total Depth		10.101		True Vertical Depth		5.269		BHL From Lease, Unit, or Property Line:		
								186		

SEC	TWP	RGE	COUNTY			
Spot Location				Feet From 1/4 Sec Lines	FSL	FWL
1/4	1/4	1/4	1/4			
Depth of Deviation		Radius of Turn	Direction	Total Length		
Measured Total Depth		True Vertical Depth	BHL From Lease, Unit, or Property Line:			

SEC	TWP	RGE	COUNTY				
Spot Location	1/4	1/4	1/4	1/4	Feet From 1/4 Sec Lines	FSL	FWL
Depth of Deviation	Radius of Turn			Direction	Total Length		
Measured Total Depth	True Vertical Depth			BHL From Lease, Unit, or Property Line:			

6709 NORTH CLASSEN BLVD., OKLA. CITY, OKLA. 73116 * LOCAL (405) 843-4847 * OUT OF STATE (800) 654-3219

Certificate of Authorization No. 1293 LS

ALFA

County, Oklahoma

159'FSL-2047'FWL Section 15 Township 27N Range 11W I.M.

