

Oklahoma Corporation Commission  
 Oil & Gas Conservation Division  
 Post Office Box 52000  
 Oklahoma City, Oklahoma 73152-2000  
 Rule 165: 10-3-25

Form 1002A

API No.: 35011236000000

**Completion Report**

Spud Date: May 08, 2016

OTC Prod. Unit No.:

Drilling Finished Date: May 28, 2016

1st Prod Date:

Completion Date: June 15, 2016

**Drill Type: HORIZONTAL HOLE**

Well Name: CASTONGUAY 14-16-10 1H

Purchaser/Measurer:

Location: BLAINE 14 16N 10W  
 NW NW NW NW  
 251 FNL 247 FWL of 1/4 SEC  
 Derrick Elevation: 1256 Ground Elevation: 1231

First Sales Date:

Operator: CHESAPEAKE OPERATING LLC 17441  
 PO BOX 18496  
 6100 N WESTERN AVE  
 OKLAHOMA CITY, OK 73154-0496

Completion Type	
X	Single Zone
	Multiple Zone
	Commingled

Location Exception	
Order No	
	652047
	652048

Increased Density	
Order No	
There are no Increased Density records to display.	

Casing and Cement							
Type	Size	Weight	Grade	Feet	PSI	SAX	Top of CMT
SURFACE	13 3/8	48	H-40	1505		1398	SURFACE
INTERMEDIATE	9 5/8	40	L-80	8441		461	5915
PRODUCTION	5 1/2	20	P-110-HC	20203		2118	6000

Liner								
Type	Size	Weight	Grade	Length	PSI	SAX	Top Depth	Bottom Depth
There are no Liner records to display.								

**Total Depth: 20203**

Packer	
Depth	Brand & Type
There are no Packer records to display.	

Plug	
Depth	Plug Type
There are no Plug records to display.	

Initial Test Data										
Test Date	Formation	Oil BBL/Day	Oil-Gravity (API)	Gas MCF/Day	Gas-Oil Ratio Cu FT/BBL	Water BBL/Day	Pumpin or Flowing	Initial Shut-In Pressure	Choke Size	Flow Tubing Pressure
There are no Initial Data records to display.										

Completion and Test Data by Producing Formation										
Formation Name: MISSISSIPPIAN			Code: 359MSSP			Class: TA				
<b>Spacing Orders</b>				<b>Perforated Intervals</b>						
<b>Order No</b>	<b>Unit Size</b>			<b>From</b>	<b>To</b>					
646685	640			10010	20064					
647101	640									
652044	MULTIUNIT									
<b>Acid Volumes</b>				<b>Fracture Treatments</b>						
2,000 GALLONS ACID				193,383 BARRELS FLUIDS, 16,590,280 POUNDS PROPPANT						

Formation	Top
MISSISSIPPIAN	9570

Were open hole logs run? No

Date last log run:

Were unusual drilling circumstances encountered? No

Explanation:

Other Remarks
NO FLOW-BACK TEST DATA: WELL NEVER FLOWED BACK AFTER FRAC COMPLETION

**Lateral Holes**

Sec: 2 TWP: 16N RGE: 10W County: BLAINE

NE NW NW NW

30 FNL 450 FWL of 1/4 SEC

Depth of Deviation: 9251 Radius of Turn: 126 Direction: 0 Total Length: 10633

Measured Total Depth: 20203 True Vertical Depth: 9377 End Pt. Location From Release, Unit or Property Line: 30

**FOR COMMISSION USE ONLY**

1133837

Status: Accepted

API NO. 011-23600  
 OTC PROD.  
 UNIT NO. N/A

PLEASE TYPE OR USE BLACK INK ONLY  
 NOTE:  
 Attach copy of original 1002A if recompletion or reentry.

OKLAHOMA CORPORATION COMMISSION  
 Oil & Gas Conservation Division  
 Post Office Box 52000  
 Oklahoma City, Oklahoma 73152-2000  
 Rule 165:10-3-25

RECEIVED Form 1002A Rev. 2009

JUN 29 2016

ORIGINAL  
 AMENDED  
 Reason Amended  
 TYPE OF DRILLING OPERATION  
 STRAIGHT HOLE  DIRECTIONAL HOLE  HORIZONTAL HOLE  
 SERVICE WELL  
 If directional or horizontal, see reverse for bottom hole location.

COMPLETION REPORT

SPUD DATE 5/8/2016  
 DRLG FINISHED DATE 5/28/2016  
 DATE OF WELL COMPLETION 6/15/2016  
 1ST PROD DATE N/A  
 RECOMP DATE  
 Longitude (if Known)  
 OTC/OCC OPERATOR NO. 17441

OKLAHOMA CORPORATION COMMISSION

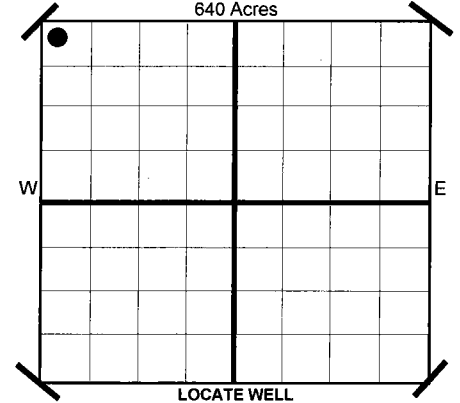

COUNTY Blaine SEC 14 TWP 16N RGE 10W  
 LEASE NAME Castonguay 14-16-10  
 SHL NW 1/4 NW 1/4 NW 1/4 NW 1/4 (FNL) 251  
 ELEVATION Derrick Fl 1,256 Ground 1,231  
 OPERATOR NAME CHESAPEAKE OPERATING, L.L.C.  
 ADDRESS P.O. BOX 18496  
 CITY OKLAHOMA CITY STATE OK ZIP 73154

COMPLETION TYPE

SINGLE ZONE  
 MULTIPLE ZONE  
 Application Date  
 COMMINGLED  
 Application Date I.O. I.O.  
 LOCATION EXCEPTION ORDER NO. 652047 / 652048  
 INCREASED DENSITY ORDER NO. N/A

CASING & CEMENT (Form 1002C must be attached)

TYPE	SIZE	WEIGHT	GRADE	FEET	PSI	SAX	TOP	
CONDUCTOR								
SURFACE	13-3/8"	48#	H-40	1,505		1,398	Surface	
INTERMEDIATE	9-5/8"	40#	L-80	8,441		461	5,915	
PRODUCTION	5-1/2"	20#	P110-HC	20,203		2,118	6,000	
LINER								
							TOTAL DEPTH	20,203

PACKER @ \_\_\_\_\_ BRAND & TYPE \_\_\_\_\_  
 PLUG @ \_\_\_\_\_ TYPE \_\_\_\_\_

PLUG @ \_\_\_\_\_ TYPE \_\_\_\_\_  
 PLUG @ \_\_\_\_\_ TYPE \_\_\_\_\_

COMPLETION & TEST DATA BY PRODUCING FORMATION

FORMATION	Mississippian						
SPACING & SPACING ORDER NUMBER	640 646685/647101/652044	I.O. Multunit					Reported to Frac Focus
CLASS: Oil, Gas, Dry, Inj. Disp, Comm Disp, Svc	Temporarily Abandoned						
PERFORATED INTERVALS	10,010 - 16,027 20,064	per Juanita Cooper					
ACID/VOLUME	2,000 gals acid						
FRACTURE TREATMENT (Fluids/Prop Amounts)	193,383 bbls fluids 16,590,280# proppant						

**AS SUBMITTED**

Minimum Gas Allowable (165:10-17-7)

Gas Purchaser/Measurer

OR

1st Sales Date

Oil Allowable (165:10-13-3)

INITIAL TEST DATA

INITIAL TEST DATE				
OIL-BBL/DAY				
OIL-GRAVITY ( API)				
GAS-MCF/DAY				
GAS-OIL RATIO CU FT/BBL				
WATER-BBL/DAY				
PUMPING OR FLOWING				
INITIAL SHUT-IN PRESSURE				
CHOKE SIZE				
FLOW TUBING PRESSURE				

A record of the formations drilled through, and pertinent remarks are presented on the reverse. I declare that I have knowledge of the contents of this report and am authorized by my organization to make this report, which was prepared by me or under my supervision and direction, with the data and facts stated herein to be true, correct, and complete to the best of my knowledge and belief.

*Juanita Cooper*  
 SIGNATURE

JUANITA COOPER - SR. REGULATORY ANALYST  
 NAME (PRINT OR TYPE)

6/28/2016  
 DATE

405-848-8000  
 PHONE NUMBER

P.O. BOX 18496  
 ADDRESS

OKLAHOMA CITY  
 CITY

OK 73154  
 STATE ZIP

juanita.cooper@chk.com  
 EMAIL ADDRESS

**PLEASE TYPE OR USE BLACK INK ONLY**  
FORMATION RECORD

Give formation names and tops, if available, or descriptions and thickness of formations drilled through. Show intervals cored or drillstem tested.

LEASE NAME Castonguay 14-16-10

WELL NO. 1H

NAMES OF FORMATIONS	TOP
Mississippian	9,570

FOR COMMISSION USE ONLY

ITD on file  YES  NO

APPROVED \_\_\_\_\_ DISAPPROVED \_\_\_\_\_

2) Reject Codes

\_\_\_\_\_

\_\_\_\_\_

\_\_\_\_\_

\_\_\_\_\_

Were open hole logs run? yes  no

Date Last log was run N/A

Was CO<sub>2</sub> encountered? yes  no at what depths?

Was H<sub>2</sub>S encountered? yes  no at what depths?

Were unusual drilling circumstances encountered? \_\_\_\_\_ yes  no  
If yes, briefly explain.

Other remarks: No flow-back test data: well never flowed back after frac completion

\_\_\_\_\_

\_\_\_\_\_

\_\_\_\_\_

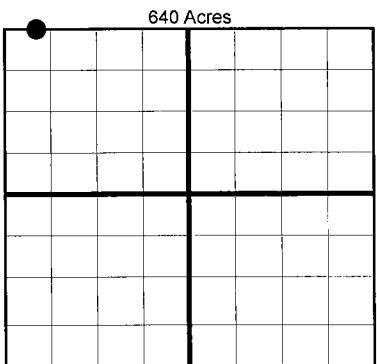

**BOTTOM HOLE LOCATION FOR DIRECTIONAL HOLE**

SEC	TWP	RGE	COUNTY				
Spot Location	1/4	1/4	1/4	1/4	Feet From 1/4 Sec Lines	FSL	FEL
Measured Total Depth	True Vertical Depth		BHL From Lease, Unit, or Property Line:				

**BOTTOM HOLE LOCATION FOR HORIZONTAL HOLE: (LATERALS)**

**LATERAL #1**

SEC	TWP	RGE	COUNTY							
2	16N	10W	Blaine							
Spot Location	NE 1/4	NW 1/4	NW 1/4	NW 1/4	Feet From 1/4 Sec Lines	FNL	30	FWL	450	
Depth of Deviation	9,251		Radius of Turn	126		Direction	0		Total Length	10,633
Measured Total Depth	20,203		True Vertical Depth		9,377		BHL From Lease, Unit, or Property Line:			30

**LATERAL #2**

SEC	TWP	RGE	COUNTY				
Spot Location	1/4	1/4	1/4	1/4	Feet From 1/4 Sec Lines	FSL	FWL
Depth of Deviation	Radius of Turn		Direction		Total Length		
Measured Total Depth	True Vertical Depth		BHL From Lease, Unit, or Property Line:				

**LATERAL #3**

SEC	TWP	RGE	COUNTY				
Spot Location	1/4	1/4	1/4	1/4	Feet From 1/4 Sec Lines	FSL	FWL
Depth of Deviation	Radius of Turn		Direction		Total Length		
Measured Total Depth	True Vertical Depth		BHL From Lease, Unit, or Property Line:				

If more than three drainholes are proposed, attach a separate sheet indicating the necessary information.

Direction must be stated in degrees azimuth. Please note, the horizontal drainhole and its end point must be located within the boundaries of the lease or spacing unit.

**Directional surveys are required for all drainholes and directional wells.**

