

Oklahoma Corporation Commission
 Oil & Gas Conservation Division
 Post Office Box 52000
 Oklahoma City, Oklahoma 73152-2000
 Rule 165: 10-3-25

Form 1002A

API No.: 35129240670000

Completion Report

Spud Date: January 09, 2016

OTC Prod. Unit No.: 129-217379

Drilling Finished Date: January 24, 2016

1st Prod Date: May 23, 2016

Completion Date: April 11, 2016

Drill Type: STRAIGHT HOLE

Min Gas Allowable: Yes

Well Name: PIERCE 1-12

Purchaser/Measurer: ENBRIDGE PIPELINE LP

Location: ROGER MILLS 12 13N 25W
 C NW SW NE
 990 FSL 330 FWL of 1/4 SEC
 Derrick Elevation: 2114 Ground Elevation: 2100

First Sales Date: 05/23/2016

Operator: REDLAND RESOURCES LLC 18774

6001 NW 23RD ST
 OKLAHOMA CITY, OK 73127-1253

Completion Type	
X	Single Zone
	Multiple Zone
	Commingled

Location Exception	
Order No	
There are no Location Exception records to display.	

Increased Density	
Order No	
There are no Increased Density records to display.	

Casing and Cement							
Type	Size	Weight	Grade	Feet	PSI	SAX	Top of CMT
CONDUCTOR	20			46		4	SURFACE
SURFACE	8.625	24		794		465	SURFACE
PRODUCTION	4.5	17	L-80	9345		225	7580

Liner								
Type	Size	Weight	Grade	Length	PSI	SAX	Top Depth	Bottom Depth
There are no Liner records to display.								

Total Depth: 9354

Packer	
Depth	Brand & Type
There are no Packer records to display.	

Plug	
Depth	Plug Type
There are no Plug records to display.	

Initial Test Data										
Test Date	Formation	Oil BBL/Day	Oil-Gravity (API)	Gas MCF/Day	Gas-Oil Ratio Cu FT/BBL	Water BBL/Day	Pumpin or Flowing	Initial Shut-In Pressure	Choke Size	Flow Tubing Pressure
Jun 21, 2016	TONKAWA	70	45	100	1428	2	PUMPING	1600		

Completion and Test Data by Producing Formation										
Formation Name: TONKAWA			Code: 406TNKW			Class: OIL				
Spacing Orders				Perforated Intervals						
Order No		Unit Size		From			To			
126799		640		9131			9212			
Acid Volumes				Fracture Treatments						
3,500 GALLONS 7.5% NEFE HCL				1,890 BARRELS, 25 POUNDS X-LINK GEL, 4% KCL, 136,000 POUNDS 20/40 OTTAWA SAND						

Formation	Top
DOUGLAS	8240
DOUGLAS LIME	8604
TONKAWA MARKER	9065
TONKAWA SAND UPPER	9130
TONKAWA SAND 2ND	9163

Were open hole logs run? Yes

Date last log run: February 05, 2016

Were unusual drilling circumstances encountered? No

Explanation:

Other Remarks
There are no Other Remarks.

FOR COMMISSION USE ONLY	
Status: Accepted	1133792

API NO. 129-24067
 OTC PROD UNIT NO. 29-217379

PLEASE TYPE OR USE BLACK INK ONLY
 NOTE:

Attach copy of original 1002A if recompletion or reentry.

OKLAHOMA CORPORATION COMMISSION
 Oil & Gas Conservation Division
 Post Office Box 52000
 Oklahoma City, Oklahoma 73152-2000
 Rule 165:10-3-25

RECEIVED

Form 1002A
 Rev. 2009

JUN 22 2016

OKLAHOMA CORPORATION COMMISSION

COMPLETION REPORT

ORIGINAL
 AMENDED (Reason) _____

TYPE OF DRILLING OPERATION

STRAIGHT HOLE DIRECTIONAL HOLE HORIZONTAL HOLE
 SERVICE WELL

If directional or horizontal, see reverse for bottom hole location.

COUNTY	ROGER MILLS	SEC	12	TWP	13N	RGE	25W	SPUD DATE	1-29-16
LEASE NAME	PIERCE			WELL NO.	1-12			DRLG FINISHED DATE	1-24-16
C	1/4 NW 1/4 SW 1/4 NE 1/4	FSL OF 1/4 SEC	990	FWL OF 1/4 SEC	330			DATE OF WELL COMPLETION	4-11-16
ELEVATION N Derrick	2114	Ground	2100	Latitude (if known)	35° 37' 11.9" N			1st PROD DATE	5-23-16
OPERATOR NAME	REDLAND RESOURCES, LLC			OTC/OCC OPERATOR NO.	18774				
ADDRESS	6001 N.W. 23RD								
CITY	OKLA. CITY	STATE	OKLA.	ZIP	73127				

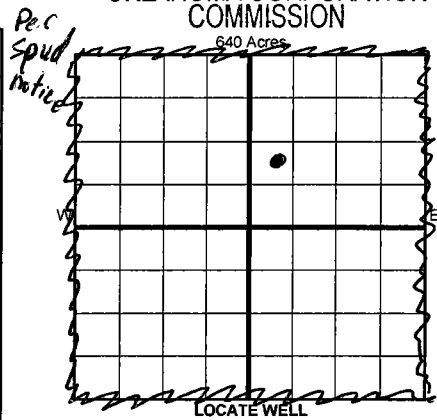

COMPLETION TYPE

<input checked="" type="checkbox"/>	SINGLE ZONE
<input type="checkbox"/>	MULTIPLE ZONE Application Date _____
<input type="checkbox"/>	COMMINGLED Application Date _____
LOCATION	
EXCEPTION ORDER: INCREASED DENSITY ORDER NO. _____	

CASING & CEMENT (Form 1002C must be attached)

TYPE	SIZE	WEIGHT	GRADE	FEET	PSI	SAX	TOP OF CMT	
CONDUCTOR	20"			46		4.5YD	SURFACE	
SURFACE	8.625	24		794		450 465	SURFACE	
INTERMEDIATE								
PRODUCTION	4.5	17	L-80	9345		225	7580	
LINER								
							TOTAL DEPTH	9354

PACKER @ _____ BRAND & TYPE _____ PLUG @ _____ TYPE _____ PLUG @ _____ TYPE _____
 PACKER @ _____ BRAND & TYPE _____ PLUG @ _____ TYPE _____ PLUG @ _____ TYPE _____

COMPLETION & TEST DATA BY PRODUCING FORMATION

FORMATION	TONKAWA						
SPACING & SPACING ORDER NUMBER	640 AC	126799					Reported to Fran Focus
CLASS: Oil, Gas, Dry, Inj, Disp, Comm Disp, Svc	OIL						
PERFORATED INTERVALS	9131-9134,	9136-9140					
	9166-9171	9174-9176		9179-9191			
	9194-9207	9210-9212					
ACID/VOLUME	3500 GAS. 7.5% NE FE HCL						
FRACTURE TREATMENT (Fluids/Prop Amounts)	1890 BBL. 25# X-LINK GEL, 4% KCL, 136,000 LBS 20/40 OTTAWA SAND						

Min Gas Allowable (165:10-17-7)

Gas Purchaser/Measurer ENBRIDGE PIPELINE LP

OR

Oil Allowable (165:10-13-3)

First Sales Date 5-23-16

INITIAL TEST DATA

INITIAL TEST DATE	6-21-16			
OIL-BBL/DAY	70			
OIL-GRAVITY (API)	45			
GAS-MCF/DAY	100 MCF			
GAS-OIL RATIO CU FT/BBL	1428 : 1			
WATER-BBL/DAY	2			
PUMPING OR FLOWING	PUMPING			
INITIAL SHUT-IN PRESSURE	1600#			
CHOKE SIZE				
FLOW TUBING PRESSURE				

AS SUBMITTED

A record of the formations drilled through, and pertinent remarks are presented on the reverse. I declare that I have knowledge of the contents of this report and am authorized by my organization to make this report, which was prepared by me or under my supervision and direction, with the data and facts stated herein to be true, correct, and complete to the best of my knowledge and belief.

<i>Leroy A. Buck</i>	LEROY A. BUCK	6-21-16	405 789-7104
SIGNATURE	NAME (PRINT OR TYPE)	DATE	PHONE NUMBER
6001 N.W. 23RD	OKLA. CITY OKLA. 73127		redlab5841@gmail.com
ADDRESS	CITY STATE ZIP		EMAIL ADDRESS

PLEASE TYPE OR USE BLACK INK ONLY
FORMATION RECORD

Give formation names and tops, if available, or descriptions and thickness of formations drilled through. Show intervals cored or drillstem tested.

LEASE NAME PIERCE WELL NO. 1-12

NAMES OF FORMATIONS	TOP
DOUGLAS	8240
DOUGLAS LIME	8604
TONKAWA MARKER	9065
TONKAWA SAND UPPER	9130
TONKAWA SAND 2ND	9163

FOR COMMISSION USE ONLY

ITD on file YES NO

APPROVED _____ DISAPPROVED _____

2) Reject Codes _____

Were open hole logs run? yes no

Date Last log was run 2-5-16 BOND LOG

Was CO₂ encountered? yes no at what depths? _____

Was H₂S encountered? yes no at what depths? _____

Were unusual drilling circumstances encountered? yes no
If yes, briefly explain below _____

Other remarks: _____

640 Acres

If more than three drainholes are proposed, attach a separate sheet indicating the necessary information.

Direction must be stated in degrees azimuth. Please note, the horizontal drainhole and its end point must be located within the boundaries of the lease or spacing unit.

Directional surveys are required for all drainholes and directional wells.

640 Acres

BOTTOM HOLE LOCATION FOR DIRECTIONAL HOLE

SEC	TWP	RGE	COUNTY							
Spot Location				1/4	1/4	1/4	1/4	Feet From 1/4 Sec Lines	FSL	FWL
Measured Total Depth		True Vertical Depth		BHL From Lease, Unit, or Property Line:						

BOTTOM HOLE LOCATION FOR HORIZONTAL HOLE: (LATERALS)

LATERAL #1

SEC	TWP	RGE	COUNTY							
Spot Location				1/4	1/4	1/4	1/4	Feet From 1/4 Sec Lines	FSL	FWL
Depth of Deviation		Radius of Turn		Direction		Total Length				
Measured Total Depth		True Vertical Depth		BHL From Lease, Unit, or Property Line:						

LATERAL #2

SEC	TWP	RGE	COUNTY							
Spot Location				1/4	1/4	1/4	1/4	Feet From 1/4 Sec Lines	FSL	FWL
Depth of Deviation		Radius of Turn		Direction		Total Length				
Measured Total Depth		True Vertical Depth		BHL From Lease, Unit, or Property Line:						

LATERAL #3

SEC	TWP	RGE	COUNTY							
Spot Location				1/4	1/4	1/4	1/4	Feet From 1/4 Sec Lines	FSL	FWL
Depth of Deviation		Radius of Turn		Direction		Total Length				
Measured Total Depth		True Vertical Depth		BHL From Lease, Unit, or Property Line:						