

Oklahoma Corporation Commission  
Oil & Gas Conservation Division  
Post Office Box 52000  
Oklahoma City, Oklahoma 73152-2000  
Rule 165: 10-3-25

Form 1002A

API No.: 35151236920001

**Completion Report**

Spud Date: May 25, 2012

OTC Prod. Unit No.: 151-208484

Drilling Finished Date: June 18, 2012

**Amended**

1st Prod Date: August 07, 2012

Amend Reason: RE-CLASSIFY AS GAS WELL

Completion Date: July 16, 2012

Recomplete Date: June 06, 2016

**Drill Type: HORIZONTAL HOLE**

Min Gas Allowable: Yes

Well Name: RED HILL TRUST 30-29-17 1H

Purchaser/Measurer: CHESAPEAKE OPERATING LLC

Location: WOODS 30 29N 17W  
NW NW NE NE  
300 FNL 1050 FEL of 1/4 SEC  
Derrick Elevation: 1969 Ground Elevation: 1954

First Sales Date: 08,07/2012

Operator: CHESAPEAKE OPERATING LLC 17441  
PO BOX 18496  
6100 N WESTERN AVE  
OKLAHOMA CITY, OK 73154-0496

Completion Type	
X	Single Zone
	Multiple Zone
	Commingled

Location Exception	
Order No	
603227	

Increased Density	
Order No	
There are no Increased Density records to display.	

Casing and Cement							
Type	Size	Weight	Grade	Feet	PSI	SAX	Top of CMT
SURFACE	13 3/8	48	H-40	525		465	SURFACE
INTERMEDIATE	9 5/8	36	J-55	1537		496	SURFACE
PRODUCTION	7	26	P-110EC	5796		191	3250

Liner								
Type	Size	Weight	Grade	Length	PSI	SAX	Top Depth	Bottom Depth
LINER	4 1/2	13.5	P-110EC	5253	0	540	4984	10237

**Total Depth: 10237**

Packer	
Depth	Brand & Type
4958	R

Plug	
Depth	Plug Type
10140	PBTD

Initial Test Data										
Test Date	Formation	Oil BBL/Day	Oil-Gravity (API)	Gas MCF/Day	Gas-Oil Ratio Cu FT/BBL	Water BBL/Day	Pumpin or Flowing	Initial Shut-In Pressure	Choke Size	Flow Tubing Pressure
Jun 06, 2016	MISSISSIPPIAN	12		301	25083	104	ARTIFICIA			229

Completion and Test Data by Producing Formation										
Formation Name: MISSISSIPPIAN			Code: 359MSSP			Class: GAS				
<b>Spacing Orders</b>				<b>Perforated Intervals</b>						
<b>Order No</b>		<b>Unit Size</b>		<b>From</b>			<b>To</b>			
597614		640		5777			10091			
<b>Acid Volumes</b>				<b>Fracture Treatments</b>						
13,500 GALLONS 15% HCL ACID				42,836 BARRELS FRAC FLUID, 908,038 POUNDS PROPPANT						

Formation	Top
MISSISSIPPIAN	5752

Were open hole logs run? No

Date last log run:

Were unusual drilling circumstances encountered? No

Explanation:

Other Remarks
There are no Other Remarks.

Lateral Holes
Sec: 30 TWP: 29N RGE: 17W County: WOODS
SW SE SE SE
67 FSL 643 FEL of 1/4 SEC
Depth of Deviation: 5121 Radius of Turn: 471 Direction: 175 Total Length: 4485
Measured Total Depth: 10237 True Vertical Depth: 5592 End Pt. Location From Release, Unit or Property Line: 67

FOR COMMISSION USE ONLY
Status: Accepted
1133760

API NO. 35-151-23692  
OTC PROD. UNIT NO. 151-208484

PLEASE TYPE OR USE BLACK INK ONLY  
NOTE: Attach copy of original 1002A if recompletion or reentry.

OKLAHOMA CORPORATION COMMISSION  
Oil & Gas Conservation Division  
Post Office Box 52000  
Oklahoma City, Oklahoma 73152-2000  
Rule 165:10-3-25

RECEIVED

JUN 14 2016

ORIGINAL AMENDED  
Reason Amended Reclassify as Gas Well

COMPLETION REPORT

OKLAHOMA CORPORATION COMMISSION  
640 Acres

TYPE OF DRILLING OPERATION  
 STRAIGHT HOLE  DIRECTIONAL HOLE  HORIZONTAL HOLE  
If directional or horizontal, see reverse for bottom hole location.

SPUD DATE 5/25/2012  
DRLG FINISHED DATE 6/18/2012  
DATE OF WELL COMPLETION 7/16/2012  
1ST PROD DATE 8/7/2012  
RECOMP DATE 6-6-2016  
Longitude (if Known)

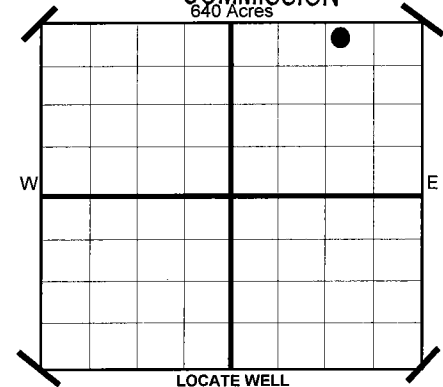

COUNTY WOODS SEC 30 TWP 29N RGE 17W  
LEASE NAME RED HILL TRUST 30-29-17 WELL NO 1H  
SHL NW 1/4 NW 1/4 NE 1/4 NE 1/4 300 1/4 SEC 1,050  
ELEVATION Derrick Fl 1,969 Ground 1,954  
OPERATOR NAME CHESAPEAKE OPERATING, L.L.C. OTC/OCC OPERATOR NO. 17441  
ADDRESS P.O. BOX 18496  
CITY OKLAHOMA CITY STATE OK ZIP 73154

COMPLETION TYPE  
 SINGLE ZONE  
 MULTIPLE ZONE  
 COMMINGLED  
LOCATION EXCEPTION ORDER NO. 603227 (F.O.)  
INCREASED DENSITY ORDER NO. N/A

CASING & CEMENT (Form 1002C must be attached)

TYPE	SIZE	WEIGHT	GRADE	FEET	PSI	SAX	TOP
CONDUCTOR							
SURFACE	13 3/8"	48#	H-40	525		465	SURFACE
INTERMEDIATE	9 5/8"	36#	J-55	1,537		496	SURFACE
PRODUCTION	7"	26#	P-110EC	5,796		191	3,250
LINER	4 1/2"	13.5#	P-110EC	4,984-10,237		540	4,984

PACKER @ 4,958 BRAND & TYPE R PLUG @ 10,140 TYPE PBTD PLUG @ TOTAL DEPTH 10,237

COMPLETION & TEST DATA BY PRODUCING FORMATION

359MSSP

FORMATION	SPACING & SPACING ORDER NUMBER	CLASS	PERFORATED INTERVALS	ACID/VOLUME	FRACTURE TREATMENT
MISSISSIPPIAN	640 597614	GAS	5,777-10,091	15% HCL Acid 13,500 GAL Frac Fluid	42,836 BBLs Proppant 908,038 LBS

Minimum Gas Allowable (165:10-17-7) Gas Purchaser/Measurer Chesapeake Operating, L.L.C.  
OR  
Oil Allowable (165:10-13-3) 1st Sales Date 8/7/2012

INITIAL TEST DATA

INITIAL TEST DATE	6/6/2016
OIL-BBL/DAY	12
OIL-GRAVITY ( API)	
GAS-MCF/DAY	301
GAS-OIL RATIO CU FT/BBL	25,083
WATER-BBL/DAY	104
PUMPING OR FLOWING	ARTIFICIAL LIFT
INITIAL SHUT-IN PRESSURE	
CHOKE SIZE	
FLOW TUBING PRESSURE	229

AS SUBMITTED

A record of the formations drilled through, and pertinent remarks are presented on the reverse. I declare that I have knowledge of the contents of this report and am authorized by my organization to make this report which was prepared by me or under my supervision and direction, with the data and facts stated herein to be true, correct, and complete to the best of my knowledge and belief.

SIGNATURE: JP Powell, Sr. Regulatory Analyst  
NAME (PRINT OR TYPE)  
DATE: 6/13/2016  
PHONE NUMBER: 405-848-8000  
ADDRESS: P.O. BOX 18496, OKLAHOMA CITY, OK 73154  
EMAIL ADDRESS: jp.powell@chk.com

PLEASE TYPE OR USE BLACK INK ONLY  
FORMATION RECORD

Give formation names and tops, if available, or descriptions and thickness of formations drilled through. Show intervals cored or drillstem tested.

LEASE NAME RED HILL TRUST 30-29-17

WELL NO. 1H

NAMES OF FORMATIONS	TOP
MISSISSIPPIAN	5,752

FOR COMMISSION USE ONLY	
ITD on file	<input type="checkbox"/> YES <input type="checkbox"/> NO
APPROVED	DISAPPROVED
2) Reject Codes	
_____	
_____	
_____	
_____	

Were open hole logs run?	yes	<input checked="" type="checkbox"/> no
Date last log was run	N/A	
Was CO <sub>2</sub> encountered?	yes	<input checked="" type="checkbox"/> no at what depths?
Was H <sub>2</sub> S encountered?	yes	<input checked="" type="checkbox"/> no at what depths?
Were unusual drilling circumstances encountered?	yes	<input checked="" type="checkbox"/> no
If yes, briefly explain.		

Other remarks:

---



---



---



---

640 Acres

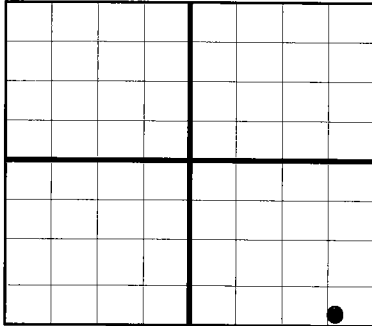

If more than three drainholes are proposed, attach a separate sheet indicating the necessary information.

Direction must be stated in degrees azimuth. Please note, the horizontal drainhole and its end point must be located within the boundaries of the lease or spacing unit.

**Directional surveys are required for all drainholes and directional wells.**

640 Acres

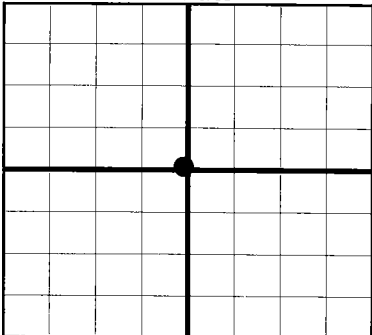

**BOTTOM HOLE LOCATION FOR DIRECTIONAL HOLE**

SEC	TWP	RGE	COUNTY			
Spot Location	1/4	1/4	1/4	Feet From 1/4 Sec Lines	FSL	FWL
Measured Total Depth	True Vertical Depth		BHL From Lease, Unit, or Property Line:			

**BOTTOM HOLE LOCATION FOR HORIZONTAL HOLE: (LATERALS)**

SEC	TWP	RGE	COUNTY			
Spot Location	SW 1/4	SE 1/4	SE 1/4	Feet From 1/4 Sec Lines	FSL 67	FEL 643
Depth of Deviation	5,121	Radius of Turn	471	Direction	175	Total Length 4,485
Measured Total Depth	10,237	True Vertical Depth	5,592	BHL From Lease, Unit, or Property Line: 67		

**LATERAL #2**

SEC	TWP	RGE	COUNTY			
Spot Location	1/4	1/4	1/4	Feet From 1/4 Sec Lines	FSL	FWL
Depth of Deviation	Radius of Turn		Direction	Total Length		
Measured Total Depth	True Vertical Depth		BHL From Lease, Unit, or Property Line:			

**LATERAL #3**

SEC	TWP	RGE	COUNTY			
Spot Location	1/4	1/4	1/4	Feet From 1/4 Sec Lines	FSL	FWL
Depth of Deviation	Radius of Turn		Direction	Total Length		
Measured Total Depth	True Vertical Depth		BHL From Lease, Unit, or Property Line:			

API NO. 35-151-23692  
 OTC PROD.  
 UNIT NO. 151-208484

PLEASE TYPE OR USE BLACK INK ONLY  
 NOTE: Attach copy of original 1002A if recompletion or reentry.

6/6/16

OKLAHOMA CORPORATION COMMISSION  
 Oil & Gas Conservation Division  
 Post Office Box 52000  
 Oklahoma City, Oklahoma 73152-2000  
 Rule 165:10-3-25

RECEIVED

Form 1002A  
 10/1/2009

JUN 14 2016 1016EZ

ORIGINAL AMENDED  
 Reason Amended **Reclassify as Gas Well**

TYPE OF DRILLING OPERATION  
 STRAIGHT HOLE  DIRECTIONAL HOLE  HORIZONTAL HOLE  
 SERVICE WELL  
 If directional or horizontal, see reverse for bottom hole location.

COUNTY **WOODS** SEC **30** TWP **29N** RGE **17W**  
 LEASE NAME **RED HILL TRUST 30-29-17** WELL NO. **1H**  
 SHL NW 1/4 NW 1/4 NE 1/4 NE 1/4 FNL 300 FEL OF 1/4 SEC 1,050  
 ELEVATION Derrick Fl 1,969 Ground 1,954 Latitude (if Known)  
 OPERATOR NAME **CHESAPEAKE OPERATING, L.L.C.** OTC/OCC OPERATOR NO. **17441**  
 ADDRESS **P.O. BOX 18496**  
 CITY **OKLAHOMA CITY** STATE **OK** ZIP **73154**

COMPLETION REPORT  
 SPUD DATE **5/25/2012**  
 DRLG FINISHED DATE **6/18/2012**  
 DATE OF WELL COMPLETION **7/16/2012**  
 1ST PROD DATE **8/7/2012**  
 RECOMP DATE **6-6-2016**  
 Longitude (if Known)  
 OTC/OCC OPERATOR NO. **17441**

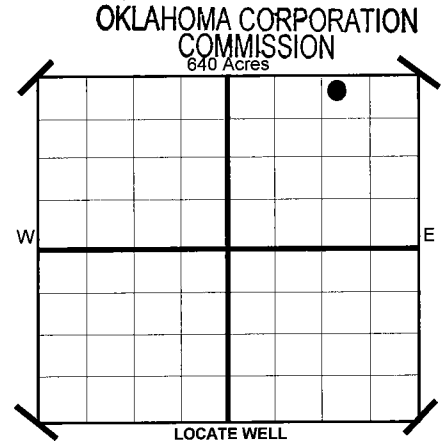

COMPLETION TYPE  
 SINGLE ZONE  
 MULTIPLE ZONE Application Date  
 COMMINGLED Application Date  
 LOCATION EXCEPTION ORDER NO. **603227 (F.O.)**  
 INCREASED DENSITY ORDER NO. **N/A**

CASING & CEMENT (Form 1002C must be attached)

TYPE	SIZE	WEIGHT	GRADE	FEET	PSI	SAX	TOP	
CONDUCTOR								
SURFACE	13 3/8"	48#	H-40	525		465	SURFACE	
INTERMEDIATE	9 5/8"	36#	J-55	1,537		496	SURFACE	
PRODUCTION	7"	26#	P-110EC	5,796		191	3,250	
LINER	4 1/2"	13.5#	P-110EC	4,984-10,237		540	4,984	
							TOTAL DEPTH	10,237

PACKER @ **4.958** BRAND & TYPE **R** PLUG @ **10.140** TYPE **PBTD** PLUG @ **10.140** TYPE **PBTD**  
 PACKER @ **4.958** BRAND & TYPE **R** PLUG @ **10.140** TYPE **PBTD** PLUG @ **10.140** TYPE **PBTD**

COMPLETION & TEST DATA BY PRODUCING FORMATION **359MSSP**

FORMATION	SPACING & SPACING ORDER NUMBER	CLASS: Oil, Gas, Dry, Inj. Disp, Comm Disp, Svc	PERFORATED INTERVALS	ACID/VOLUME	FRACTURE TREATMENT (Fluids/Prop Amounts)
<b>MISSISSIPPIAN</b>	<b>640 597614</b>	<b>GAS</b>	<b>5,777-10,091</b>	<b>15% HCL Acid 13,500 GAL Frac Fluid</b>	<b>42,836 BBLS Proppant 908,038 LBS</b>

Minimum Gas Allowable (165:10-17-7) Gas Purchaser/Measurer **Chesapeake Operating, L.L.C.**  
 OR Oil Allowable (165:10-13-3) 1st Sales Date **6/6/16**

INITIAL TEST DATA

INITIAL TEST DATE	<b>6/6/2016</b>
OIL-BBL/DAY	<b>12</b>
OIL-GRAVITY ( API)	
GAS-MCF/DAY	<b>301</b>
GAS-OIL RATIO CU FT/BBL	<b>25,083</b>
WATER-BBL/DAY	<b>104</b>
PUMPING OR FLOWING	<b>ARTIFICIAL LIFT</b>
INITIAL SHUT-IN PRESSURE	<b>1</b>
CHOKE SIZE	
FLOW TUBING PRESSURE	<b>229</b>

**AS SUBMITTED**

A record of the formations drilled through, and pertinent remarks are presented on the reverse. I declare that I have knowledge of the contents of this report and am authorized by my organization to make this report, which was prepared by me or under my supervision and direction, with the data and facts stated herein to be true, correct, and complete to the best of my knowledge and belief.

**JP Powell, Sr. Regulatory Analyst**  
 SIGNATURE: **JP Powell** NAME (PRINT OR TYPE): **JP Powell, Sr. Regulatory Analyst**  
 ADDRESS: **P.O. BOX 18496 OKLAHOMA CITY OK 73154** DATE: **6/13/2016** PHONE NUMBER: **405-848-8000**  
 EMAIL ADDRESS: **jp.powell@chk.com**

EZ

Form 1002A