

Oklahoma Corporation Commission  
Oil & Gas Conservation Division  
Post Office Box 52000  
Oklahoma City, Oklahoma 73152-2000  
Rule 165: 10-3-25

Form 1002A

API No.: 35073252390000

**Completion Report**

Spud Date: February 03, 2016

OTC Prod. Unit No.:

Drilling Finished Date: February 26, 2016

1st Prod Date: May 16, 2015

Completion Date: April 11, 2016

**Drill Type: HORIZONTAL HOLE**

Well Name: HOLIDAY ROAD 2-1H

Purchaser/Measurer:

Location: KINGFISHER 2 18N 6W  
SE SE SW SW  
196 FSL 1060 FWL of 1/4 SEC  
Derrick Elevation: 0 Ground Elevation: 1163

First Sales Date:

Operator: GASTAR EXPLORATION INC 23199

1331 LAMAR STE 650  
HOUSTON, TX 77010-3131

Completion Type	
X	Single Zone
	Multiple Zone
	Commingled

Location Exception	
Order No	
651023	

Increased Density	
Order No	
There are no Increased Density records to display.	

Casing and Cement							
Type	Size	Weight	Grade	Feet	PSI	SAX	Top of CMT
SURFACE	9.625	40	J-55	430		145	SURFACE
PRODUCTION	7	29	P-110	7140		287	6620

Liner								
Type	Size	Weight	Grade	Length	PSI	SAX	Top Depth	Bottom Depth
LINER	4.5	11.6	P-110	4970	0	550	7018	11988

**Total Depth: 12014**

Packer	
Depth	Brand & Type
There are no Packer records to display.	

Plug	
Depth	Plug Type
11875	CIBP

Initial Test Data										
Test Date	Formation	Oil BBL/Day	Oil-Gravity (API)	Gas MCF/Day	Gas-Oil Ratio Cu FT/BBL	Water BBL/Day	Pumpin or Flowing	Initial Shut-In Pressure	Choke Size	Flow Tubing Pressure
May 16, 2016	MISSISSIPPIAN	55	37.4	59	1072	1953	FLOWING			

**Completion and Test Data by Producing Formation**

Formation Name: MISSISSIPPIAN		Code: 359MSSP		Class: OIL	
<b>Spacing Orders</b>			<b>Perforated Intervals</b>		
<b>Order No</b>	<b>Unit Size</b>		<b>From</b>	<b>To</b>	
636633	640		7496	11872	
<b>Acid Volumes</b>			<b>Fracture Treatments</b>		
88,032 GALLONS			12,477,300 POUNDS SAND, 371,930 BARRELS WATER		

Formation Name: MISSISSIPPIAN		Code: 359MSSP		Class: DRY	
<b>Spacing Orders</b>			<b>Perforated Intervals</b>		
<b>Order No</b>	<b>Unit Size</b>		<b>From</b>	<b>To</b>	
636633	640		11876	11891	
<b>Acid Volumes</b>			<b>Fracture Treatments</b>		
There are no Acid Volume records to display.			There are no Fracture Treatments records to display.		

Formation	Top
BIG LIME	6200
MISSISSIPPI LIME	6860

Were open hole logs run? No  
Date last log run:  
Were unusual drilling circumstances encountered? No  
Explanation:

**Other Remarks**  
CIBP @ 11875 TO ISOLATE RDV FROM THE PRODUCING INTERVAL. OCC - THIS DOCUMENT IS ACCEPTED BASED ON THE DATA SUBMITTED THE FINAL LOCATION EXCEPTION HAS NOT BEEN ISSUED.

**Lateral Holes**

Sec: 2 TWP: 18N RGE: 6W County: KINGFISHER

NW NW NE NW

34 FNL 1459 FWL of 1/4 SEC

Depth of Deviation: 6263 Radius of Turn: 711 Direction: 360 Total Length: 4202

Measured Total Depth: 12014 True Vertical Depth: 6914 End Pt. Location From Release, Unit or Property Line: 34

**FOR COMMISSION USE ONLY**

1133588

Status: Accepted

RECEIVED

JUN 03 2016

Form 1002A Rev. 2009

OKLAHOMA CORPORATION COMMISSION

API NO. 35-073-25239  
OTC PROD. UNIT NO. 23199

PLEASE TYPE OR USE BLACK INK ONLY  
NOTE:

Attach copy of original 1002A if recompletion or reentry.

OKLAHOMA CORPORATION COMMISSION  
Oil & Gas Conservation Division  
Post Office Box 52000  
Oklahoma City, Oklahoma 73152-2000  
Rule 165-10-3-25

ORIGINAL  
 AMENDED (Reason)

COMPLETION REPORT

TYPE OF DRILLING OPERATION  
 STRAIGHT HOLE  DIRECTIONAL HOLE  HORIZONTAL HOLE  
 SERVICE WELL

SPUD DATE 02/03/2016  
DRLG FINISHED DATE 2/26/2016

If directional or horizontal, see reverse for bottom hole location.

COUNTY Kingfisher SEC 2 TWP 18N RGE 6W  
LEASE NAME Holiday Road WELL NO. 2-1H  
SE 1/4 SE 1/4 SW 1/4 SW 1/4 FSL OF 1/4 SEC 196' FWL OF 1/4 SEC 1060'  
ELEVATION Demick FL Ground 1163' Longitude (if known)  
OPERATOR NAME Gastar Exporation Inc. OTC/OCC OPERATOR NO. 23199  
ADDRESS 1331 Lamar Street, Suite 650  
CITY Houston STATE TX ZIP 77010

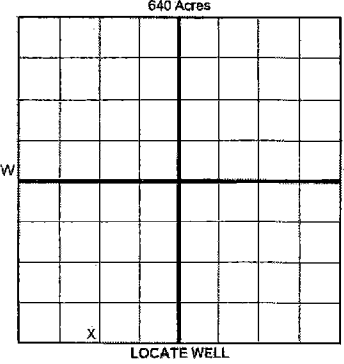

COMPLETION TYPE  
 SINGLE ZONE  
 MULTIPLE ZONE  
Application Date  
COMINGLED Application Date  
LOCATION EXCEPTION ORDER NO. 651023 I.O.  
INCREASED DENSITY ORDER NO.

CASING & CEMENT (Form 1002C must be attached)

TYPE	SIZE	WEIGHT	GRADE	FEET	PSI	SAX	TOP OF CMT
CONDUCTOR							
SURFACE	9.625	40	J-55	430		145	Surface
INTERMEDIATE	7	29	P-110	7,140		287	6,620
PRODUCTION	4.5	11.6	p-110	7018 - 11988		550	7018
LINER							

PACKER @ \_\_\_\_\_ BRAND & TYPE \_\_\_\_\_ PLUG @ 11875 TYPE CIBP PLUG @ \_\_\_\_\_ TYPE \_\_\_\_\_ TOTAL DEPTH 12,014  
PACKER @ \_\_\_\_\_ BRAND & TYPE \_\_\_\_\_ PLUG @ \_\_\_\_\_ TYPE \_\_\_\_\_ PLUG @ \_\_\_\_\_ TYPE \_\_\_\_\_

COMPLETION & TEST DATA BY PRODUCING FORMATION

See remarks

FORMATION	SPACING & SPACING ORDER NUMBER	CLASS: Oil, Gas, Dry, Inj, Disp, Corren D'sp, Svc	PERFORATED INTERVALS	ACID/VOLUME	FRACTURE TREATMENT (Fluids/Prop Amounts)
MISSISSIPPIAN	636633 - 640H	oil	7496 - 11891	88,032 gal	12,477,300 # sand
MISSISSIPPIAN	636633 (640)	oil	11872		371,930 bbl water

Min Gas Allowable (165-10-17-7) OR Oil Allowable (165-10-13-3) Gas Purchaser/Measurer First Sales Date

INITIAL TEST DATA

INITIAL TEST DATE	5/16/2016
OIL-BBL/DAY	55
OIL-GRAVITY (API)	37.4
GAS-MCF/DAY	59
GAS-OIL RATIO CU FT/BBL	1072
WATER-BBL/DAY	1953
PUMPING OR FLOWING	Flowing
INITIAL SHUT-IN PRESSURE	
CHOKE SIZE	
FLOW TUBING PRESSURE	

AS SUBMITTED

A record of the formations drilled through, and pertinent remarks are presented on the reverse. I declare that I have knowledge of the contents of this report and am authorized by my organization to make this report, which was prepared by me or under my supervision and direction, with the data and facts stated herein to be true, correct, and complete to the best of my knowledge and belief.  
SIGNATURE: [Signature] NAME (PRINT OR TYPE): John O'Dowd DATE: 6/3/2016 PHONE NUMBER: 405-772-1500  
ADDRESS: 3030 NW Expressway, Suite 500 CITY: Oklahoma City STATE: OK ZIP: 73112 EMAIL ADDRESS: Midcon-Reg@gastar.com

PLEASE TYPE OR USE BLACK INK ONLY  
FORMATION RECORD

Holiday Road

2-1H

Give formation names and tops, if available, or descriptions and thickness of formations drilled through. Show intervals cored or drillstem tested.

LEASE NAME Trinity Road WELL NO. 411

NAMES OF FORMATIONS	TOP
BIG LIME	6200' TVD
MISS LIME	6860' TVD

FOR COMMISSION USE ONLY

ITD on file  YES  NO

APPROVED \_\_\_\_\_ DISAPPROVED \_\_\_\_\_

2) Reject Codes  
\_\_\_\_\_  
\_\_\_\_\_  
\_\_\_\_\_  
\_\_\_\_\_

Were open hole logs run?  yes  no

Date last log was run \_\_\_\_\_

Was CO<sub>2</sub> encountered?  yes  no at what depths? \_\_\_\_\_

Was H<sub>2</sub>S encountered?  yes  no at what depths? \_\_\_\_\_

Were unusual drilling circumstances encountered?  yes  no  
If yes, briefly explain below: \_\_\_\_\_

Other remarks: CIBP @ 11,875 to isolate RDV from the producing interval

\_\_\_\_\_  
\_\_\_\_\_  
\_\_\_\_\_

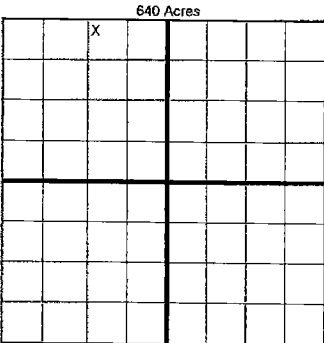

If more than three drainholes are proposed, attach a separate sheet indicating the necessary information.

Direction must be stated in degrees azimuth. Please note, the horizontal drainhole and its end point must be located within the boundaries of the lease or spacing unit.

Directional surveys are required for all drainholes and directional wells.

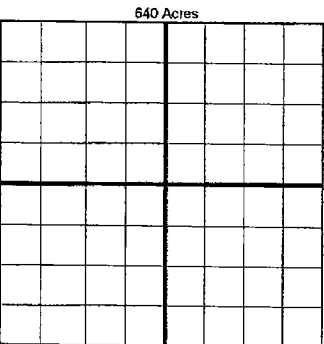

**BOTTOM HOLE LOCATION FOR DIRECTIONAL HOLE**

SEC	TWP	RGE	COUNTY							
Spot Location				1/4	1/4	1/4	1/4	Feet From 1/4 Sec Lines	FSL	FWL
Measured Total Depth				True Vertical Depth		BHL From Lease, Unit, or Property Line:				

**BOTTOM HOLE LOCATION FOR HORIZONTAL HOLE: (LATERALS)**

*Per Exhibit Final Location Exception*

SEC	TWP	RGE	COUNTY							
2	18N	6W	KINGFISHER							
Spot Location				NW	NW	NE	NW	Feet From 1/4 Sec Lines	FSL	FWL
Depth of Deviation				6263'		Radius of Turn 711.7'		Direction	Total Length	4202'
Measured Total Depth				12014		True Vertical Depth 6914'		BHL From Lease, Unit, or Property Line: <u>3358 34</u>		

**LATERAL #2**

SEC	TWP	RGE	COUNTY							
Spot Location				1/4	1/4	1/4	1/4	Feet From 1/4 Sec Lines	FSL	FWL
Depth of Deviation				Radius of Turn		Direction		Total Length		
Measured Total Depth				True Vertical Depth		BHL From Lease, Unit, or Property Line:				

**LATERAL #3**

SEC	TWP	RGE	COUNTY							
Spot Location				1/4	1/4	1/4	1/4	Feet From 1/4 Sec Lines	FSL	FWL
Depth of Deviation				Radius of Turn		Direction		Total Length		
Measured Total Depth				True Vertical Depth		BHL From Lease, Unit, or Property Line:				

2025 RELEASE UNDER E.O. 14176