

Oklahoma Corporation Commission
 Oil & Gas Conservation Division
 Post Office Box 52000
 Oklahoma City, Oklahoma 73152-2000
 Rule 165: 10-3-25

Form 1002A

API No.: 35133242610002

Completion Report

Spud Date: November 08, 2012

OTC Prod. Unit No.:

Drilling Finished Date: November 19, 2012

Amended

1st Prod Date:

Amend Reason: PLUG BACK

Completion Date: February 05, 2013

Recomplete Date: September 24, 2015

Drill Type: SERVICE WELL

Well Name: RIVER BEND 1-25 SWD

Purchaser/Measurer:

Location: SEMINOLE 25 11N 7E
 W2 SE NW NE
 1650 FSL 940 FWL of 1/4 SEC
 Derrick Elevation: 960 Ground Elevation: 944

First Sales Date:

Operator: NEW DOMINION LLC 20585

1307 S BOULDER AVE STE 400
 TULSA, OK 74119-3220

Completion Type	
<input type="checkbox"/>	Single Zone
<input type="checkbox"/>	Multiple Zone
<input type="checkbox"/>	Commingled

Location Exception
Order No
There are no Location Exception records to display.

Increased Density
Order No
There are no Increased Density records to display.

Casing and Cement							
Type	Size	Weight	Grade	Feet	PSI	SAX	Top of CMT
SURFACE	10 3/4	40.5	J-55	800	500	425	SURFACE
PRODUCTION	7	23	J-55	4881	1000	405	3960

Liner								
Type	Size	Weight	Grade	Length	PSI	SAX	Top Depth	Bottom Depth
There are no Liner records to display.								

Total Depth: 7662

Packer	
Depth	Brand & Type
4371	BAKER 82FA47

Plug	
Depth	Plug Type
4945	FILL / CONCRETE

Initial Test Data										
Test Date	Formation	Oil BBL/Day	Oil-Gravity (API)	Gas MCF/Day	Gas-Oil Ratio Cu FT/BBL	Water BBL/Day	Pumpin or Flowing	Initial Shut-In Pressure	Choke Size	Flow Tubing Pressure
There are no Initial Data records to display.										

Completion and Test Data by Producing Formation										
Formation Name: 2ND WILCOX			Code: 202WLCX2			Class: DISP				
Spacing Orders				Perforated Intervals						
Order No		Unit Size		From			To			
There are no Spacing Order records to display.				4471			4501			
Acid Volumes				Fracture Treatments						
668 BARRELS 20% HCL				There are no Fracture Treatments records to display.						

Formation Name: ARBUCKLE			Code: 169ABCK			Class: DISP				
Spacing Orders				Perforated Intervals						
Order No		Unit Size		From			To			
There are no Spacing Order records to display.				There are no Perf. Intervals records to display.						
Acid Volumes				Fracture Treatments						
668 BARRELS 20% HCL				There are no Fracture Treatments records to display.						

Formation	Top
1ST WILCOX	4412
MARSHALL ZONE	4426
2ND WILCOX	4446
MCLISH SAND ZONE	4704
OIL CREEK SAND ZONE	4786
ARBUCKLE LIME	4848

Were open hole logs run? No

Date last log run:

Were unusual drilling circumstances encountered? No

Explanation:

Other Remarks
PLUG BACK RIVER BEND 1-25 SWD PER OCC LETTER DATED MAY 18, 2015. PLUG BACK APPROVED BY JIM MARLATT, OCC OIL AND GAS SPECIALIST, SEISMICITY PER EMAIL DATED SEPTEMBER 25, 2015. PLUG BACK DONE ON SEPTEMBER 24, 2015 WITNESSED BY OCC FIELD INSPECTOR. OCC - UIC PERMIT NUMBER 1304300105. THIS WELL IS PERFORATED IN THE 2ND WILCOX AND AN OPEN HOLE COMPLETION FROM BOTTOM OF CASING AT 4,881' TO 4,945' TOP OF PLUG.

FOR COMMISSION USE ONLY

1133636

Status: Accepted

133-24261-02

RECEIVED

Form 1002A Rev. 2009

API NO. 133 24261B
OTC PROD.
UNIT NO.

PLEASE TYPE OR USE BLACK INK ONLY
NOTE:

Attach copy of original 1002A
if recompletion or reentry.

OKLAHOMA CORPORATION COMMISSION
Oil & Gas Conservation Division
Post Office Box 52000
Oklahoma City, Oklahoma 73152-2000
Rule 165:10-3-25

JUN 08 2016

OKLAHOMA CORPORATION
COMMISSION

ORIGINAL
 AMENDED (Reason)

Plug Back

COMPLETION REPORT

TYPE OF DRILLING OPERATION

STRAIGHT HOLE DIRECTIONAL HOLE HORIZONTAL HOLE
 SERVICE WELL

If directional or horizontal, see reverse for bottom hole location.

SPUD DATE 11/8/2012

DRLG FINISHED DATE 11/19/2012

DATE OF WELL COMPLETION 2/5/2013

1st PROD DATE

RECOMP DATE 9-24-2015

Longitude (if known) W 36 31' 04"

COUNTY Seminole SEC 25 TWP 11N RGE 07E

LEASE NAME River Bend SWO WELL NO. 1-25 SWD

W/2 1/4 SE 1/4 NW 1/4 NE 1/4 FSL OF 1/4 SEC 1,650' FWL OF 1/4 SEC 940'

ELEVATION N Derrick 960' Ground 944' Latitude (if known) N 35 24' 11"

OPERATOR NAME New Dominion, LLC OTC/OCC OPERATOR NO. 20585

ADDRESS 1307 South Boulder, Suite 400

CITY Tulsa STATE Ok. ZIP 74119

640 Acres
LOCATE WELL grid with 'X' in the top-right quadrant.

COMPLETION TYPE

SINGLE ZONE
MULTIPLE ZONE Application Date
COMMINGLED Application Date
LOCATION
EXCEPTION ORDER
INCREASED DENSITY
ORDER NO.

CASING & CEMENT (Form 1002C must be attached)

TYPE	SIZE	WEIGHT	GRADE	FEET	PSI	SAX	TOP OF CMT
CONDUCTOR							
SURFACE	10 3/4"	40.5#	J-55	800'	500	425	Cir to Surf
INTERMEDIATE							
PRODUCTION	7"	23#	J-55	4,881'	1000	405	3,960' CBL
LINER							

PACKER @ 4,371 BRAND & TYPE Baker 82FA47 PLUG @ 4,945' TYPE Fill/Conc PLUG @ TYPE TOTAL DEPTH 7,662'

PACKER @ BRAND & TYPE PLUG @ TYPE PLUG @ TYPE

COMPLETION & TEST DATA BY PRODUCING FORMATION 202WLCX2, 169ABCK

FORMATION	2nd Wilcox	Arbuckle
SPACING & SPACING ORDER NUMBER	Disp. Order # 1304300105	
CLASS: Oil, Gas, Dry, Inj, Disp, Comm Disp, Svc	Service/Disposal	Service/Disposal
PERFORATED INTERVALS	Perf. 4471-4501	O.H. 4881' - 7662'
ACID/VOLUME	668 bbls 20% HCL	
FRACTURE TREATMENT (Fluids/Prop Amounts)	None	None

AS SUBMITTED

Min Gas Allowable (165:10-17-7)

Gas Purchaser/Measurer

OR

First Sales Date

INITIAL TEST DATA

Oil Allowable (165:10-13-3)

INITIAL TEST DATE	N/A
OIL-BBL/DAY	N/A
OIL-GRAVITY (API)	N/A
GAS-MCF/DAY	N/A
GAS-OIL RATIO CU FT/BBL	N/A
WATER-BBL/DAY	N/A
PUMPING OR FLOWING	N/A
INITIAL SHUT-IN PRESSURE	N/A
CHOKE SIZE	N/A
FLOW TUBING PRESSURE	N/A

A record of the formations drilled through, and pertinent remarks are presented on the reverse. I declare that I have knowledge of the contents of this report and am authorized by my organization to make this report, which was prepared by me or under my supervision and direction, with the data and facts stated herein to be true, correct, and complete to the best of my knowledge and belief.

SIGNATURE: Jerry Breaux
NAME (PRINT OR TYPE): Jerry Breaux
DATE: 9/30/2015
PHONE NUMBER: 918-587-6242
ADDRESS: 1307 South Boulder, Suite 400
CITY: Tulsa STATE: Ok. ZIP: 74119
EMAIL ADDRESS: jerry.breaux@newdominion.net

PLEASE TYPE OR USE BLACK INK ONLY
FORMATION RECORD

Give formation names and tops, if available, or descriptions and thickness of formations drilled through. Show intervals cored or drillstem tested.

LEASE NAME _____ WELL NO. _____

NAMES OF FORMATIONS	TOP
1st Wilcox	4,412'
Marshall Zone	4,426'
2nd Wilcox	4,446'
McLish Sand Zone	4,704
Oil Creek Sand Zone	4,786'
Arbuckle Line	4,848'

FOR COMMISSION USE ONLY

ITD on file YES NO

APPROVED _____ DISAPPROVED _____

2) Reject Codes _____

Were open hole logs run? _____ yes _____ no

Date Last log was run _____

Was CO₂ encountered? _____ yes _____ no at what depths? _____

Was H₂S encountered? _____ yes _____ no at what depths? _____

Were unusual drilling circumstances encountered? _____ yes _____ no
If yes, briefly explain below _____

Other remarks: *Bend 1-255WD*
 Plug back River Creek SWB #1 per OCC letter dated 5/18/15, Plug Back approved by OCC Jim Marlatt Oil & Gas Specialist, Seismicity per email dated 9/25/2015
Plug back done on 9-24-2015 witnessed by OCC Field inspector
 OCC - UIC Permit Number 1304300105. This well is perforated in the 2nd Wilcox and an Open Hole Completion from Bottom of Casing at 4,881' to ~~Total Depth 7,662'~~ *4945' top of Plug*

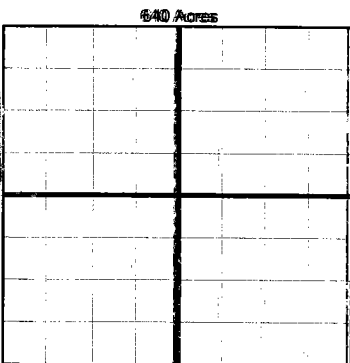

If more than three drainholes are proposed, attach a separate sheet indicating the necessary information.

Direction must be stated in degree azimuth. Please note, the horizontal drainhole and its end point must be located within the boundaries of the lease or spacing unit.

Directional surveys are required for all drainholes and directional wells.

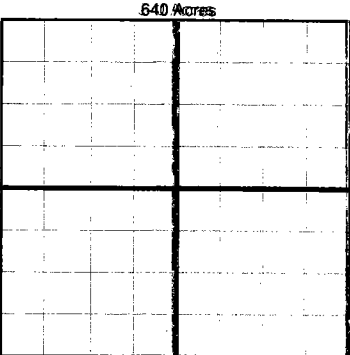

BOTTOM HOLE LOCATION FOR DIRECTIONAL HOLE

SEC	TWAP	R&GE	COUNTY				
Spot Location	1/4	1/4	1/4	1/4	Feet From 1/4 Sec Lines	FSL	FWL
Measured Total Depth	True Vertical Depth		BHL From Lease, Unit, or Property Line:				

BOTTOM HOLE LOCATION FOR HORIZONTAL HOLE: (LATERALS)

LATERAL #1

SEC	TWAP	R&GE	COUNTY				
Spot Location	1/4	1/4	1/4	1/4	Feet From 1/4 Sec Lines	FSL	FWL
Depth of Deviation	Radius of Turn		Direction		Total Length		
Measured Total Depth	True Vertical Depth		BHL From Lease, Unit, or Property Line:				

LATERAL #2

SEC	TWAP	R&GE	COUNTY				
Spot Location	1/4	1/4	1/4	1/4	Feet From 1/4 Sec Lines	FSL	FWL
Depth of Deviation	Radius of Turn		Direction		Total Length		
Measured Total Depth	True Vertical Depth		BHL From Lease, Unit, or Property Line:				

LATERAL #3

SEC	TWAP	R&GE	COUNTY				
Spot Location	1/4	1/4	1/4	1/4	Feet From 1/4 Sec Lines	FSL	FWL
Depth of Deviation	Radius of Turn		Direction		Total Length		
Measured Total Depth	True Vertical Depth		BHL From Lease, Unit, or Property Line:				