

Oklahoma Corporation Commission  
 Oil & Gas Conservation Division  
 Post Office Box 52000  
 Oklahoma City, Oklahoma 73152-2000  
 Rule 165: 10-3-25

Form 1002A

API No.: 35151244250000

**Completion Report**

Spud Date: December 13, 2015

OTC Prod. Unit No.: 151217426

Drilling Finished Date: January 28, 2016

1st Prod Date: April 17, 2016

Completion Date: April 14, 2016

**Drill Type: HORIZONTAL HOLE**

Min Gas Allowable: Yes

Well Name: GOUCHER 2514 2H-17 DD

Purchaser/Measurer: SEMGAS

Location: WOODS 20 25N 14W  
 NE NW NE NW  
 230 FNL 1665 FWL of 1/4 SEC  
 Derrick Elevation: 0 Ground Elevation: 1520

First Sales Date: 05/04/2016

Operator: MIDSTATES PETROLEUM COMPANY LLC 23079

321 S BOSTON AVE STE 600  
 TULSA, OK 74103-3322

Completion Type		Location Exception	Increased Density
X	Single Zone	Order No	Order No
	Multiple Zone	646071	645998
	Commingled		

Casing and Cement							
Type	Size	Weight	Grade	Feet	PSI	SAX	Top of CMT
SURFACE	9 5/8	36	J-55	1187		530	SURFACE
PRODUCTION	7	26	P-110	6481		175	5129

Liner								
Type	Size	Weight	Grade	Length	PSI	SAX	Top Depth	Bottom Depth
LINER	4.5	11.6	P-110	5526	0	605	6391	11917

**Total Depth: 11917**

Packer	
Depth	Brand & Type
There are no Packer records to display.	

Plug	
Depth	Plug Type
There are no Plug records to display.	

Initial Test Data										
Test Date	Formation	Oil BBL/Day	Oil-Gravity (API)	Gas MCF/Day	Gas-Oil Ratio Cu FT/BBL	Water BBL/Day	Pumpin or Flowing	Initial Shut-In Pressure	Choke Size	Flow Tubing Pressure
May 12, 2016	MISSISSIPPI LIME	73	29	325	4452	3059	PUMPING	54	64/64	216

Completion and Test Data by Producing Formation			
Formation Name: MISSISSIPPI LIME	Code: 351MSSLM	Class: OIL	
<b>Spacing Orders</b>		<b>Perforated Intervals</b>	
<b>Order No</b>	<b>Unit Size</b>	<b>From</b>	<b>To</b>
161084	640	7013	11828
<b>Acid Volumes</b>		<b>Fracture Treatments</b>	
5,095 BARRELS 15% GELLED AND RET ACID, 768 BARRELS 15% HCL		95,879 BARRELS SLICK WATER, 168,092 POUNDS ROCK SALT	

Formation	Top
HEEBNER	4726
TONKAWA	5062
AVANT LIME	5416
COTTAGE GROVE	5505
HOGSHOOTER	5567
OSWEGO	5739
CHEROKEE	5865
MISSISSIPPI	6112

Were open hole logs run? No

Date last log run:

Were unusual drilling circumstances encountered? No

Explanation:

Other Remarks
OCC - THIS DOCUMENT IS ACCEPTED BASED ON THE DATA SUBMITTED THE FINAL LOCATION EXCEPTION HAS NOT BEEN SUBMITTED.

**Lateral Holes**

Sec: 17 TWP: 25N RGE: 14W County: WOODS

NE NE NE NW

167 FNL 2318 FWL of 1/4 SEC

Depth of Deviation: 7218 Radius of Turn: 1025 Direction: 2 Total Length: 5436

Measured Total Depth: 11917 True Vertical Depth: 6456 End Pt. Location From Release, Unit or Property Line: 167

**FOR COMMISSION USE ONLY**

1133581

Status: Accepted

RECEIVED

MAY 18 2016

Form 1002A Rev. 2009

API NO. 151 24425
OTC PROD. UNIT NO. 151 217426

PLEASE TYPE OR USE BLACK INK ONLY
NOTE:

Attach copy of original 1002A if recompletion or reentry.

OKLAHOMA CORPORATION COMMISSION
Oil & Gas Conservation Division
Post Office Box 52000
Oklahoma City, Oklahoma 73152-2000
Rule 165:10-3-25

OKLAHOMA CORPORATION COMMISSION

ORIGINAL
AMENDED (Reason)

COMPLETION REPORT

TYPE OF DRILLING OPERATION
STRAIGHT HOLE
DIRECTIONAL HOLE
HORIZONTAL HOLE
SERVICE WELL

SPUD DATE 12/13/2015
DRLG FINISHED DATE 01/28/2016
DATE OF WELL COMPLETION 04/14/2016
1st PROD DATE 04/17/2016
RECOMP DATE
Longitude (if known)
OTC/OCC OPERATOR NO. 23079

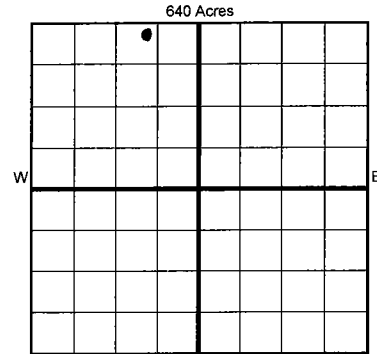

COUNTY Woods SEC 20 TWP 25N RGE 14W
LEASE NAME Goucher 2514
WELL NO. 2H-17 DD
NE 1/4 NW 1/4 NE 1/4 NW 1/4 OF 1/4 SEC 230N
FWL OF 1/4 SEC 1665
ELEVATION N Derrick Ground 1520
Latitude (if known)
OPERATOR NAME Midstates Petroleum Company LLC
ADDRESS 321 South Boston, Suite 1000
CITY Tulsa STATE OK ZIP 74103

COMPLETION TYPE
SINGLE ZONE
MULTIPLE ZONE
COMMINGLED
LOCATION EXCEPTION ORDER 646071 I.O.
INCREASED DENSITY ORDER NO. 645998

Table with columns: TYPE, SIZE, WEIGHT, GRADE, FEET, PSI, SAX, TOP OF CMT. Rows include CONDUCTOR, SURFACE, INTERMEDIATE, PRODUCTION, LINER, and TOTAL DEPTH 11,917'.

PACKER @ BRAND & TYPE PLUG @ TYPE PLUG @ TYPE
PACKER @ BRAND & TYPE PLUG @ TYPE PLUG @ TYPE

COMPLETION & TEST DATA BY PRODUCING FORMATION 351 MSSLM

Table with columns: FORMATION, SPACING & SPACING ORDER NUMBER, CLASS, PERFORATED INTERVALS, ACID/VOLUME, FRACTURE TREATMENT. Includes handwritten notes like 'Reported to Fred Focus'.

Min Gas Allowable (165:10-17-7) Gas Purchaser/Measurer SemGas
OR First Sales Date 05/04/2016
Oil Allowable (165:10-13-3)

Table with columns: INITIAL TEST DATE, OIL-BBL/DAY, OIL-GRAVITY (API), GAS-MCF/DAY, GAS-OIL RATIO CU FT/BBL, WATER-BBL/DAY, PUMPING OR FLOWING, INITIAL SHUT-IN PRESSURE, CHOKE SIZE, FLOW TUBING PRESSURE.

AS SUBMITTED

A record of the formations drilled through, and pertinent remarks are presented on the reverse. I declare that I have knowledge of the contents of this report and am authorized by my organization to make this report, which was prepared by me or under my supervision and direction, with the data and facts stated herein to be true, correct, and complete to the best of my knowledge and belief.
Signature: Chelce Rouse
NAME (PRINT OR TYPE): Chelce Rouse
DATE: 05/12/2016
PHONE NUMBER: 918-947-4647
ADDRESS: 321 South Boston, Suite 1000 Tulsa, OK 74103
CITY: Tulsa STATE: OK ZIP: 74103
EMAIL ADDRESS: chelce.rouse@midstatespetroleum.com

PLEASE TYPE OR USE BLACK INK ONLY  
FORMATION RECORD

Give formation names and tops, if available, or descriptions and thickness of formations drilled through. Show intervals cored or drillstem tested.

LEASE NAME Goucher 2514

WELL NO. 2H-17 DD

NAMES OF FORMATIONS	TOP
Heebner	4726
Tonkawa	5062
Avant Lm	5416
Cottage Grove	5505
Hogshooter	5567
Oswego	5739
Cherokee	5865
Mississippi	6112

FOR COMMISSION USE ONLY

ITD on file  YES  NO

APPROVED \_\_\_\_\_ DISAPPROVED \_\_\_\_\_ 2) Reject Codes \_\_\_\_\_

\_\_\_\_\_

\_\_\_\_\_

\_\_\_\_\_

\_\_\_\_\_

Were open hole logs run?  yes  no

Date Last log was run N/A

Was CO<sub>2</sub> encountered?  yes  no at what depths? \_\_\_\_\_

Was H<sub>2</sub>S encountered?  yes  no at what depths? \_\_\_\_\_

Were unusual drilling circumstances encountered?  yes  no

If yes, briefly explain below

Other remarks:

\_\_\_\_\_

\_\_\_\_\_

\_\_\_\_\_

\_\_\_\_\_

\_\_\_\_\_

640 Acres

If more than three drainholes are proposed, attach a separate sheet indicating the necessary information.

Direction must be stated in degrees azimuth. Please note, the horizontal drainhole and its end point must be located within the boundaries of the lease or spacing unit.

Directional surveys are required for all drainholes and directional wells.

640 Acres

**BOTTOM HOLE LOCATION FOR DIRECTIONAL HOLE**

SEC	TWP	RGE	COUNTY
Spot Location			
1/4	1/4	1/4	1/4
Measured Total Depth	True Vertical Depth	BHL From Lease, Unit, or Property Line:	

**BOTTOM HOLE LOCATION FOR HORIZONTAL HOLE: (LATERALS)**

**LATERAL #1**

SEC	TWP	RGE	COUNTY
17	25N	14W	Woods
Spot Location			
NONE	1/4 NE	1/4 NE	1/4 NW
Depth of Deviation	7,218	Radius of Turn	1,025
Measured Total Depth	11,917'	True Vertical Depth	6,456
		Direction	140° 2
		Total Length	5,436
		BHL From Lease, Unit, or Property Line: 167	

**LATERAL #2**

SEC	TWP	RGE	COUNTY
Spot Location			
1/4	1/4	1/4	1/4
Depth of Deviation	Radius of Turn		Direction
Measured Total Depth	True Vertical Depth		Total Length
		BHL From Lease, Unit, or Property Line:	

**LATERAL #3**

SEC	TWP	RGE	COUNTY
Spot Location			
1/4	1/4	1/4	1/4
Depth of Deviation	Radius of Turn		Direction
Measured Total Depth	True Vertical Depth		Total Length
		BHL From Lease, Unit, or Property Line:	