

Oklahoma Corporation Commission
Oil & Gas Conservation Division
Post Office Box 52000
Oklahoma City, Oklahoma 73152-2000
Rule 165: 10-3-25

Form 1002A

API No.: 35151244520000

Completion Report

Spud Date: February 27, 2016

OTC Prod. Unit No.: 151-217390

Drilling Finished Date: March 14, 2016

1st Prod Date: April 21, 2016

Completion Date: April 19, 2016

Drill Type: HORIZONTAL HOLE

Min Gas Allowable: Yes

Well Name: NELLETTA 2413 1H-05 B

Purchaser/Measurer: SEMGAS

Location: WOODS 32 25N 13W
SW SW SE SE
230 FSL 1185 FEL of 1/4 SEC
Derrick Elevation: 0 Ground Elevation: 1407

First Sales Date: 04/21/2016

Operator: MIDSTATES PETROLEUM COMPANY LLC 23079

321 S BOSTON AVE STE 600
TULSA, OK 74103-3322

Completion Type	
X	Single Zone
	Multiple Zone
	Commingled

Location Exception
Order No
650931

Increased Density
Order No
There are no Increased Density records to display.

Casing and Cement							
Type	Size	Weight	Grade	Feet	PSI	SAX	Top of CMT
SURFACE	9 5/8	36	J-55	1130		650	SURFACE
PRODUCTION	7	26	P-110	6592		330	3827

Liner								
Type	Size	Weight	Grade	Length	PSI	SAX	Top Depth	Bottom Depth
LINER	4.5	11.6	P-110	5554	0	605	6532	12086

Total Depth: 12086

Packer	
Depth	Brand & Type
There are no Packer records to display.	

Plug	
Depth	Plug Type
There are no Plug records to display.	

Initial Test Data										
Test Date	Formation	Oil BBL/Day	Oil-Gravity (API)	Gas MCF/Day	Gas-Oil Ratio Cu FT/BBL	Water BBL/Day	Pumpin or Flowing	Initial Shut-In Pressure	Choke Size	Flow Tubing Pressure
May 17, 2016	MISSISSIPPI SOLID	351	35	1911	5444	4625	PUMPING	217	64/64	255

Completion and Test Data by Producing Formation		
Formation Name: MISSISSIPPI SOLID	Code: 351MSSSD	Class: OIL
Spacing Orders		Perforated Intervals
Order No	Unit Size	From
57343	640	6853
		11996
Acid Volumes		Fracture Treatments
7,604 BARRELS 15% GELLED AND RET ACID, 835 BARRELS 15% HCL		105,076 BARRELS SLICK WATER, 201,155 POUNDS ROCK SALT

Formation	Top
HEEBNER SHALE	4635
TONKAWA	5126
AVANT	5358
COTTAGE GROVE	5441
HOGSHOOTER	5536
CHECKERBOARD	5594
BIG LIME	5733
OSWEGO	5765
CHEROKEE	5867
VERDIGRIS	5912
MISSISSIPPI CHAT	6165
MISSISSIPPI LIME	6176

Were open hole logs run? No

Date last log run:

Were unusual drilling circumstances encountered? No

Explanation:

Other Remarks
OCC - THIS DOCUMENT IS ACCEPTED BASED ON THE DATA SUBMITTED THE FINAL LOCATION EXCEPTION HAS NOT BEEN SUBMITTED.

Lateral Holes

Sec: 5 TWP: 24N RGE: 13W County: WOODS

SW SW SE SE

175 FSL 1395 FWL of 1/4 SEC

Depth of Deviation: 7051 Radius of Turn: 1411 Direction: 182 Total Length: 5495

Measured Total Depth: 12086 True Vertical Depth: 6318 End Pt. Location From Release, Unit or Property Line: 175

FOR COMMISSION USE ONLY

1133587

Status: Accepted

RECEIVED

Form 1002A Rev. 2009

MAY 19 2016

OKLAHOMA CORPORATION COMMISSION

API NO. 151 24452
OTC PROD. UNIT NO. 151 217390

PLEASE TYPE OR USE BLACK INK ONLY
NOTE:

Attach copy of original 1002A if recompletion or reentry.

OKLAHOMA CORPORATION COMMISSION
Oil & Gas Conservation Division
Post Office Box 52000
Oklahoma City, Oklahoma 73152-2000
Rule 165:10-3-25

COMPLETION REPORT

ORIGINAL
AMENDED (Reason)

TYPE OF DRILLING OPERATION
STRAIGHT HOLE
DIRECTIONAL HOLE
HORIZONTAL HOLE
SERVICE WELL

If directional or horizontal, see reverse for bottom hole location.

WELL INFORMATION: COUNTY Woods, SEC 32, TWP 25N, RGE 13W, LEASE NAME Nelletta 2413, WELL NO. 1H-05 B, SW 1/4 SW 1/4 SE 1/4 SE 1/4, FSL OF 1/4 SEC 230, DATE OF WELL COMPLETION 04/19/2016, 1st PROD DATE 04/21/2016, OPERATOR NAME Midstates Petroleum Company LLC, ADDRESS 321 South Boston, Suite 1000, CITY Tulsa, STATE OK, ZIP 74103

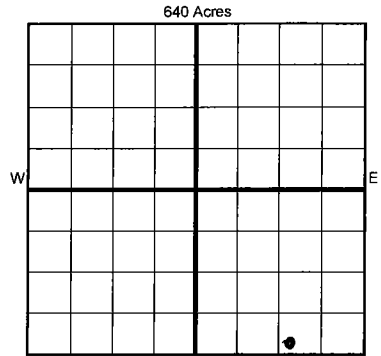

COMPLETION TYPE: SINGLE ZONE
MULTIPLE ZONE
COMMINGLED
LOCATION EXCEPTION ORDER 650931
INCREASED DENSITY ORDER NO. N/A

CASING & CEMENT (Form 1002C must be attached)

Table with columns: TYPE, SIZE, WEIGHT, GRADE, FEET, PSI, SAX, TOP OF CMT. Rows include CONDUCTOR, SURFACE, INTERMEDIATE (9-5/8, 36#, J-55, 1,130'), PRODUCTION (7, 26#, P-110, 6,592'), LINER (4.5, 11.6#, P-110, 6,532', 12,086'), and TOTAL DEPTH 12,086'.

PACKER @ BRAND & TYPE PLUG @ TYPE PLUG @ TYPE
PACKER @ BRAND & TYPE PLUG @ TYPE PLUG @ TYPE

COMPLETION & TEST DATA BY PRODUCING FORMATION 351MSSSD

Table with columns: FORMATION, SPACING & SPACING ORDER NUMBER, CLASS, PERFORATED INTERVALS, ACID/VOLUME, FRACTURE TREATMENT. Includes handwritten note 'Reported to Frac Focus'.

Min Gas Allowable (165:10-17-7) Gas Purchaser/Measurer SemGas
Oil Allowable (165:10-13-3) First Sales Date 04/21/2016

INITIAL TEST DATA

Table with columns: INITIAL TEST DATE, OIL-BBL/DAY, OIL-GRAVITY (API), GAS-MCF/DAY, GAS-OIL RATIO CU FT/BBL, WATER-BBL/DAY, PUMPING OR FLOWING, INITIAL SHUT-IN PRESSURE, CHOKE SIZE, FLOW TUBING PRESSURE.

AS SUBMITTED

A record of the formations drilled through, and pertinent remarks are presented on the reverse. I declare that I have knowledge of the contents of this report and am authorized by my organization to make this report, which was prepared by me or under my supervision and direction, with the data and facts stated herein to be true, correct, and complete to the best of my knowledge and belief.

Signature: Chelce Rouse, Date: 05/17/2016, Phone: 918-947-4647
321 South Boston, Suite 1000 Tulsa, OK 74103
chelce.rouse@midstatespetroleum.com

PLEASE TYPE OR USE BLACK INK ONLY
FORMATION RECORD

Give formation names and tops, if available, or descriptions and thickness of formations drilled through. Show intervals cored or drillstem tested.

LEASE NAME Nelletta 2413

WELL NO. 1H-05 B

NAMES OF FORMATIONS	TOP
HEEBNER SHALE	4,635
TONKAWA	5,126
AVANT	5,358
COTTAGE GROVE	5,441
HOGSHOOTER	5,536
CHECKERBOARD	5,594
BIG LIME	5,733
OSWEGO	5,765
CHEROKEE	5,867
VERDIGRIS	5,912
MISS CHAT	6,165
MISSISSIPPI LIME	6,176

FOR COMMISSION USE ONLY

ITD on file YES NO

APPROVED _____ DISAPPROVED _____

2) Reject Codes _____

Were open hole logs run? yes no

Date Last log was run N/A

Was CO₂ encountered? yes no at what depths? _____

Was H₂S encountered? yes no at what depths? _____

Were unusual drilling circumstances encountered? yes no
If yes, briefly explain below

Other remarks:

640 Acres

If more than three drainholes are proposed, attach a separate sheet indicating the necessary information.

Direction must be stated in degrees azimuth. Please note, the horizontal drainhole and its end point must be located within the boundaries of the lease or spacing unit.

Directional surveys are required for all drainholes and directional wells.

640 Acres

BOTTOM HOLE LOCATION FOR DIRECTIONAL HOLE

SEC	TWP	RGE	COUNTY							
Spot Location				1/4	1/4	1/4	1/4	Feet From 1/4 Sec Lines	FSL	FWL
Measured Total Depth				True Vertical Depth		BHL From Lease, Unit, or Property Line:				

BOTTOM HOLE LOCATION FOR HORIZONTAL HOLE: (LATERALS)

LATERAL #1

SEC	TWP	RGE	COUNTY							
05	24N	13W	Woods							
Spot Location				1/4	1/4	1/4	1/4	Feet From 1/4 Sec Lines	FSL	FWL
Depth of Deviation				Radius of Turn		Direction		Total Length		
Measured Total Depth				True Vertical Depth		BHL From Lease, Unit, or Property Line:				

SW 1/4 SW 1/4 SE 1/4 SW SE 1/4

1395
1,700

LATERAL #2

SEC	TWP	RGE	COUNTY							
Spot Location				1/4	1/4	1/4	1/4	Feet From 1/4 Sec Lines	FSL	FWL
Depth of Deviation				Radius of Turn		Direction		Total Length		
Measured Total Depth				True Vertical Depth		BHL From Lease, Unit, or Property Line:				

LATERAL #3

SEC	TWP	RGE	COUNTY							
Spot Location				1/4	1/4	1/4	1/4	Feet From 1/4 Sec Lines	FSL	FWL
Depth of Deviation				Radius of Turn		Direction		Total Length		
Measured Total Depth				True Vertical Depth		BHL From Lease, Unit, or Property Line:				