

Oklahoma Corporation Commission  
 Oil & Gas Conservation Division  
 Post Office Box 52000  
 Oklahoma City, Oklahoma 73152-2000  
 Rule 165: 10-3-25

Form 1002A

API No.: 35151244240000

**Completion Report**

Spud Date: December 11, 2015

OTC Prod. Unit No.: 151-217436

Drilling Finished Date: January 14, 2016

1st Prod Date: April 17, 2016

Completion Date: April 15, 2016

**Drill Type: HORIZONTAL HOLE**

Min Gas Allowable: Yes

Well Name: GOUCHER 2514 1H-17 BB

Purchaser/Measurer: SEMGAS

Location: WOODS 20 25N 14W  
 N2 NW NE NW  
 230 FNL 1650 FWL of 1/4 SEC  
 Derrick Elevation: 0 Ground Elevation: 1520

First Sales Date: 05/06/2016

Operator: MIDSTATES PETROLEUM COMPANY LLC 23079

321 S BOSTON AVE STE 600  
 TULSA, OK 74103-3322

Completion Type	
X	Single Zone
	Multiple Zone
	Commingled

Location Exception
Order No
646070

Increased Density
Order No
There are no Increased Density records to display.

Casing and Cement							
Type	Size	Weight	Grade	Feet	PSI	SAX	Top of CMT
SURFACE	9 5/8	36	J-55	1148		530	SURFACE
PRODUCTION	7	26	P-110	6422		260	5400

Liner								
Type	Size	Weight	Grade	Length	PSI	SAX	Top Depth	Bottom Depth
LINER	4.5	11.6	P-110	5490	0	605	6362	11852

**Total Depth: 11852**

Packer	
Depth	Brand & Type
There are no Packer records to display.	

Plug	
Depth	Plug Type
There are no Plug records to display.	

Initial Test Data										
Test Date	Formation	Oil BBL/Day	Oil-Gravity (API)	Gas MCF/Day	Gas-Oil Ratio Cu FT/BBL	Water BBL/Day	Pumpin or Flowing	Initial Shut-In Pressure	Choke Size	Flow Tubing Pressure
May 16, 2016	MISSISSIPPI LIME	21	33	451	21476	1900	PUMPING	41	64/64	133

Completion and Test Data by Producing Formation		
Formation Name: MISSISSIPPI LIME	Code: 351MSSLM	Class: OIL
<b>Spacing Orders</b>		<b>Perforated Intervals</b>
<b>Order No</b>	<b>Unit Size</b>	<b>From</b> <b>To</b>
161084	640	6937      11766
<b>Acid Volumes</b>		<b>Fracture Treatments</b>
5,653 BARRELS 15% GELLED AND RET ACID, 863 BARRELS 15% HCL		103,500 BARRELS SLICK WATER, 182,640 POUNDS ROCK SALT

Formation	Top
HEEBNER	4724
TONKAWA	5076
AVANT LIME	5423
COTTAGE GROVE	5510
HOGSHOOTER	5579
OSWEGO	5740
CHEROKEE	5862
MISSISSIPPI	6116

Were open hole logs run? No

Date last log run:

Were unusual drilling circumstances encountered? No

Explanation:

Other Remarks
OCC - THIS DOCUMENT IS ACCEPTED BASED ON THE DATA SUBMITTED THE FINAL LOCATION EXCEPTION HAS NOT BEEN SUBMITTED.

**Lateral Holes**

Sec: 17 TWP: 25N RGE: 14W County: WOODS

NW NE NW NW

168 FNL 968 FWL of 1/4 SEC

Depth of Deviation: 7058 Radius of Turn: 1116 Direction: 355 Total Length: 5430

Measured Total Depth: 11852 True Vertical Depth: 6452 End Pt. Location From Release, Unit or Property Line: 168

**FOR COMMISSION USE ONLY**

1133586

Status: Accepted

RECEIVED

Form 1002A Rev. 2009

MAY 19 2016

OKLAHOMA CORPORATION COMMISSION

API NO. 151 24424
OTC PROD. UNIT NO. 151 217436

PLEASE TYPE OR USE BLACK INK ONLY
NOTE:

Attach copy of original 1002A if recompletion or reentry.

OKLAHOMA CORPORATION COMMISSION
Oil & Gas Conservation Division
Post Office Box 52000
Oklahoma City, Oklahoma 73152-2000
Rule 165:10-3-25

COMPLETION REPORT

ORIGINAL
AMENDED (Reason)

TYPE OF DRILLING OPERATION
STRAIGHT HOLE
DIRECTIONAL HOLE
HORIZONTAL HOLE

SPUD DATE 12/11/2015
DRLG FINISHED DATE 01/14/2016
DATE OF WELL COMPLETION 04/15/2016
1st PROD DATE 04/17/2016

If directional or horizontal, see reverse for bottom hole location.

COUNTY Woods SEC 20 TWP 25N RGE 14W
LEASE NAME Goucher 2514 WELL NO. 1H-17 BB
N2 1/4 NW 1/4 NE 1/4 NW 1/4 OF 230N FWL OF 1650

ELEVATIO N Derrick Ground 1520
OPERATOR NAME Midstates Petroleum Company LLC
ADDRESS 321 South Boston, Suite 1000
CITY Tulsa STATE OK ZIP 74103

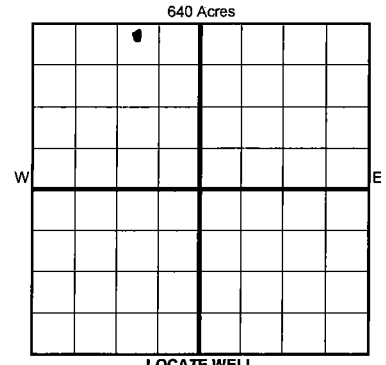

COMPLETION TYPE
SINGLE ZONE
MULTIPLE ZONE
COMMINGLED
LOCATION EXCEPTION ORDER 646070 I.O.
INCREASED DENSITY ORDER NO. N/A

Table with columns: TYPE, SIZE, WEIGHT, GRADE, FEET, PSI, SAX, TOP OF CMT. Rows include CONDUCTOR, SURFACE, INTERMEDIATE, PRODUCTION, LINER.

PACKER @ BRAND & TYPE PLUG @ TYPE PLUG @ TYPE
PACKER @ BRAND & TYPE PLUG @ TYPE PLUG @ TYPE

Table with columns: FORMATION, SPACING & SPACING ORDER NUMBER, CLASS, PERFORATED INTERVALS, ACID/VOLUME, FRACTURE TREATMENT. Includes handwritten '351MSSLIM' and 'Reported to Face Focus'.

Min Gas Allowable (165:10-17-7) Gas Purchaser/Measurer SemGas
Oil Allowable (165:10-13-3) First Sales Date 05/06/2016

Table with columns: INITIAL TEST DATE, OIL-BBL/DAY, OIL-GRAVITY (API), GAS-MCF/DAY, GAS-OIL RATIO CU FT/BBL, WATER-BBL/DAY, PUMPING OR FLOWING, INITIAL SHUT-IN PRESSURE, CHOKE SIZE, FLOW TUBING PRESSURE.

AS SUBMITTED

A record of the formations drilled through, and pertinent remarks are presented on the reverse. I declare that I have knowledge of the contents of this report and am authorized by my organization to make this report... Chelce Rouse
321 South Boston, Suite 1000 Tulsa, OK 74103
chelce.rouse@midstatespetroleum.com

PLEASE TYPE OR USE BLACK INK ONLY  
FORMATION RECORD

Give formation names and tops, if available, or descriptions and thickness of formations drilled through. Show intervals cored or drillstem tested.

LEASE NAME Goucher 2514

WELL NO. 1H-17 BB

NAMES OF FORMATIONS	TOP
Heebner	4724
Tonkawa	5076
Avant Lm	5423
Cottage Grove	5510
Hogshooter	5579
Oswego	5740
Cherokee	5862
Mississippi	6116

FOR COMMISSION USE ONLY

ITD on file  YES  NO

APPROVED \_\_\_\_\_ DISAPPROVED \_\_\_\_\_

2) Reject Codes

\_\_\_\_\_

\_\_\_\_\_

\_\_\_\_\_

\_\_\_\_\_

Were open hole logs run?  yes  no

Date Last log was run N/A

Was CO<sub>2</sub> encountered?  yes  no at what depths? \_\_\_\_\_

Was H<sub>2</sub>S encountered?  yes  no at what depths? \_\_\_\_\_

Were unusual drilling circumstances encountered?  yes  no

If yes, briefly explain below

Other remarks:

\_\_\_\_\_

\_\_\_\_\_

\_\_\_\_\_

\_\_\_\_\_

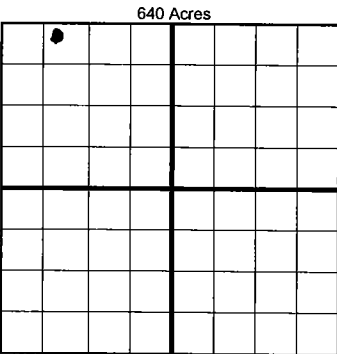

If more than three drainholes are proposed, attach a separate sheet indicating the necessary information.

Direction must be stated in degrees azimuth. Please note, the horizontal drainhole and its end point must be located within the boundaries of the lease or spacing unit.

Directional surveys are required for all drainholes and directional wells.

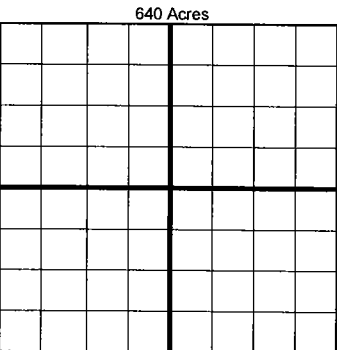

BOTTOM HOLE LOCATION FOR DIRECTIONAL HOLE

SEC	TWP	RGE	COUNTY		
Spot Location	1/4 1/4 1/4 1/4		Feet From 1/4 Sec Lines	FSL	FWL
Measured Total Depth	True Vertical Depth		BHL From Lease, Unit, or Property Line:		

BOTTOM HOLE LOCATION FOR HORIZONTAL HOLE: (LATERALS)

LATERAL #1

SEC	TWP	RGE	COUNTY				
17	25N	14W	Woods				
Spot Location	NE 1/4 NW 1/4 NW 1/4		Feet From 1/4 Sec Lines	FSL 168N	FWL 968		
Depth of Deviation	7,058	Radius of Turn	1,116	Direction	355	Total Length	5,430
Measured Total Depth	11,852'		True Vertical Depth	6,452'		BHL From Lease, Unit, or Property Line: 168	

LATERAL #2

SEC	TWP	RGE	COUNTY		
Spot Location	1/4 1/4 1/4 1/4		Feet From 1/4 Sec Lines	FSL	FWL
Depth of Deviation	Radius of Turn		Direction	Total Length	
Measured Total Depth	True Vertical Depth		BHL From Lease, Unit, or Property Line:		

LATERAL #3

SEC	TWP	RGE	COUNTY		
Spot Location	1/4 1/4 1/4 1/4		Feet From 1/4 Sec Lines	FSL	FWL
Depth of Deviation	Radius of Turn		Direction	Total Length	
Measured Total Depth	True Vertical Depth		BHL From Lease, Unit, or Property Line:		