

Oklahoma Corporation Commission  
 Oil & Gas Conservation Division  
 Post Office Box 52000  
 Oklahoma City, Oklahoma 73152-2000  
 Rule 165: 10-3-25

Form 1002A

API No.: 35073252030000

**Completion Report**

Spud Date: October 26, 2015

OTC Prod. Unit No.: 073-217223

Drilling Finished Date: November 24, 2015

1st Prod Date: February 26, 2016

Completion Date: February 23, 2016

**Drill Type: HORIZONTAL HOLE**

Min Gas Allowable: Yes

Well Name: J. R. BARTON 1H-28X

Purchaser/Measurer: NEWFIELD

Location: KINGFISHER 33 17N 8W  
 NW SW SW SW  
 390 FSL 255 FWL of 1/4 SEC  
 Latitude: 35.8996 Longitude: -98.06675  
 Derrick Elevation: 1234 Ground Elevation: 1211

First Sales Date: 0226/2016

Operator: NEWFIELD EXPLORATION MID-CON INC 20944

1 WILLIAMS CTR STE 1900  
 TULSA, OK 74172-0162

Completion Type	
X	Single Zone
	Multiple Zone
	Commingled

Location Exception	
Order No	
	650560
	650034

Increased Density	
Order No	
There are no Increased Density records to display.	

Casing and Cement							
Type	Size	Weight	Grade	Feet	PSI	SAX	Top of CMT
SURFACE	9 5/8	40	J-55	1500		405	SURFACE
PRODUCTION	5 1/2	20	P-110	18739	9500	2360	16857

Liner								
Type	Size	Weight	Grade	Length	PSI	SAX	Top Depth	Bottom Depth
There are no Liner records to display.								

**Total Depth: 18759**

Packer	
Depth	Brand & Type
There are no Packer records to display.	

Plug	
Depth	Plug Type
There are no Plug records to display.	

Initial Test Data										
Test Date	Formation	Oil BBL/Day	Oil-Gravity (API)	Gas MCF/Day	Gas-Oil Ratio Cu FT/BBL	Water BBL/Day	Pumpin or Flowing	Initial Shut-In Pressure	Choke Size	Flow Tubing Pressure
Mar 16, 2016	MISSISSIPPIAN	1496	44	1282	857	400	FLOWING	1000	64	269

Completion and Test Data by Producing Formation																
Formation Name: MISSISSIPPIAN	Code: 359MSSP	Class: OIL														
<table border="1"> <thead> <tr> <th colspan="2">Spacing Orders</th> </tr> <tr> <th>Order No</th> <th>Unit Size</th> </tr> </thead> <tbody> <tr> <td>650033</td> <td>640</td> </tr> <tr> <td>650924</td> <td>MULTIUNIT</td> </tr> </tbody> </table>		Spacing Orders		Order No	Unit Size	650033	640	650924	MULTIUNIT	<table border="1"> <thead> <tr> <th colspan="2">Perforated Intervals</th> </tr> <tr> <th>From</th> <th>To</th> </tr> </thead> <tbody> <tr> <td>8655</td> <td>18594</td> </tr> </tbody> </table>	Perforated Intervals		From	To	8655	18594
Spacing Orders																
Order No	Unit Size															
650033	640															
650924	MULTIUNIT															
Perforated Intervals																
From	To															
8655	18594															
<table border="1"> <thead> <tr> <th>Acid Volumes</th> </tr> </thead> <tbody> <tr> <td>21,056 GALLONS 15% HCL</td> </tr> </tbody> </table>		Acid Volumes	21,056 GALLONS 15% HCL	<table border="1"> <thead> <tr> <th>Fracture Treatments</th> </tr> </thead> <tbody> <tr> <td>14,382,080 # PROPPANT</td> </tr> <tr> <td>198,400 BLWTR</td> </tr> </tbody> </table>	Fracture Treatments	14,382,080 # PROPPANT	198,400 BLWTR									
Acid Volumes																
21,056 GALLONS 15% HCL																
Fracture Treatments																
14,382,080 # PROPPANT																
198,400 BLWTR																

Formation	Top
MISSISSIPPIAN	8534
MANNING	8140
CHESTER	7920

Were open hole logs run? No

Date last log run:

Were unusual drilling circumstances encountered? No

Explanation:

Other Remarks
OCC: FLE ORDER HAS NOT BEEN ISSUED. WE HAVE ACCEPTED OPERATORS DATA AS SUBMITTED. IRREGULAR SECTION.

Lateral Holes
Sec: 28 TWP: 17N RGE: 8W County: KINGFISHER NE NW NW NW 50 FNL 458 FWL of 1/4 SEC Depth of Deviation: 3948 Radius of Turn: 4603 Direction: 360 Total Length: 9939 Measured Total Depth: 18759 True Vertical Depth: 8415 End Pt. Location From Release, Unit or Property Line: 50

FOR COMMISSION USE ONLY
Status: Accepted
1132889

**Permit Plat**  
**M & M Land Surveying, Inc.**  
 520 "E" Street NW. Ardmore, OK. 73401  
 Office 580-226-0446 Mobile 580-221-4999 Fax 580-226-7158

API 073-25203

Company Name: Newfield Exploration Mid-Continent, Inc. Lease Name: J.R. Barton #1H-28X  
 Section 33 Township 17 North Range 8 West County Kingfisher Oklahoma  
 Surface Location 390' FSL - 255' FWL Elevation 1211'

**ALL SECTION CORNER COORDINATES ARE NAD 27**

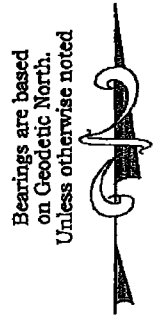
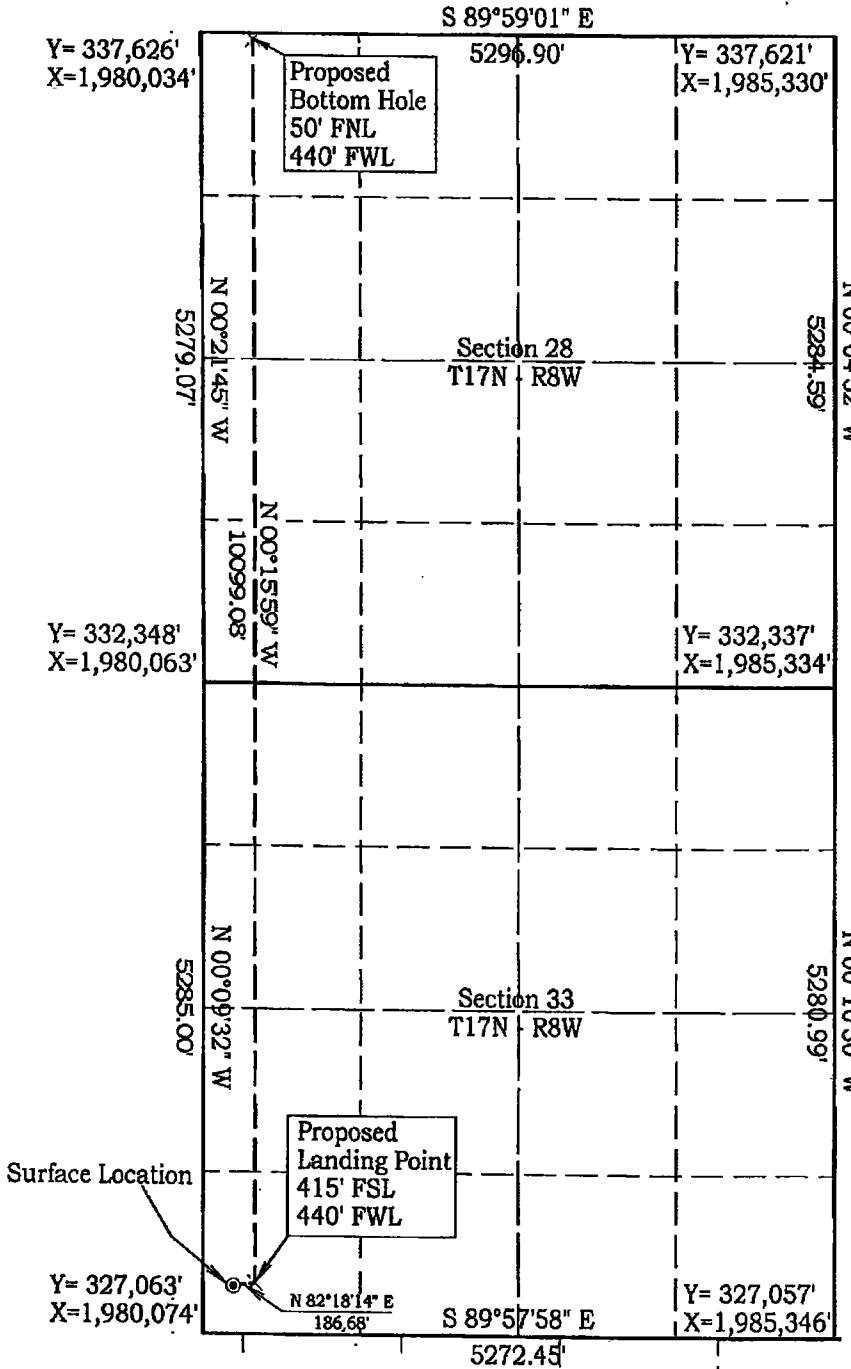

Scale: 1" = 1500'  
 Invoice # 15239  
 Date 6/11/15

Coordinates were derived from GPS RTK methods and are only accurate within ±10 feet

**Location GPS NAD 27**  
 Oklahoma North  
 Surface Location  
 Latitude: 35.89956°  
 Longitude: 98.06642°  
 Y= 327,453'  
 X = 1,980,328'

**Location NAD 83**  
 Surface Location  
 Latitude: 35.89960°  
 Longitude: 98.06675°  
 Y= 327,476'  
 X = 1,948,730'

*D. Harry McClintick* 10/12/15  
 D. Harry McClintick, R.P.L.S. # 1367, CA # 3093

This location has been staked according to the best official survey records available to us, but its accuracy is not guaranteed. Please review this plat and notify us immediately of any discrepancy.



# Well Location Plat

M & M Land Surveying, Inc.

520 "E" Street NW. Ardmore, OK. 73401

Office 580-226-0446 Mobile 580-221-4999 Fax 580-226-7158

Company Name: Newfield Exploration Mid-Continent, Inc. Lease Name: J.R. Barton #1H-28X

Section 33 Township 17 North Range 8 West County Kingfisher Oklahoma

Surface Location 390' FSL - 255' FWL Elevation 1211' Good Location? Yes

Topography

Location fell in pasture,  
±220' North of fence.  
±220' East of powerline  
and fence.

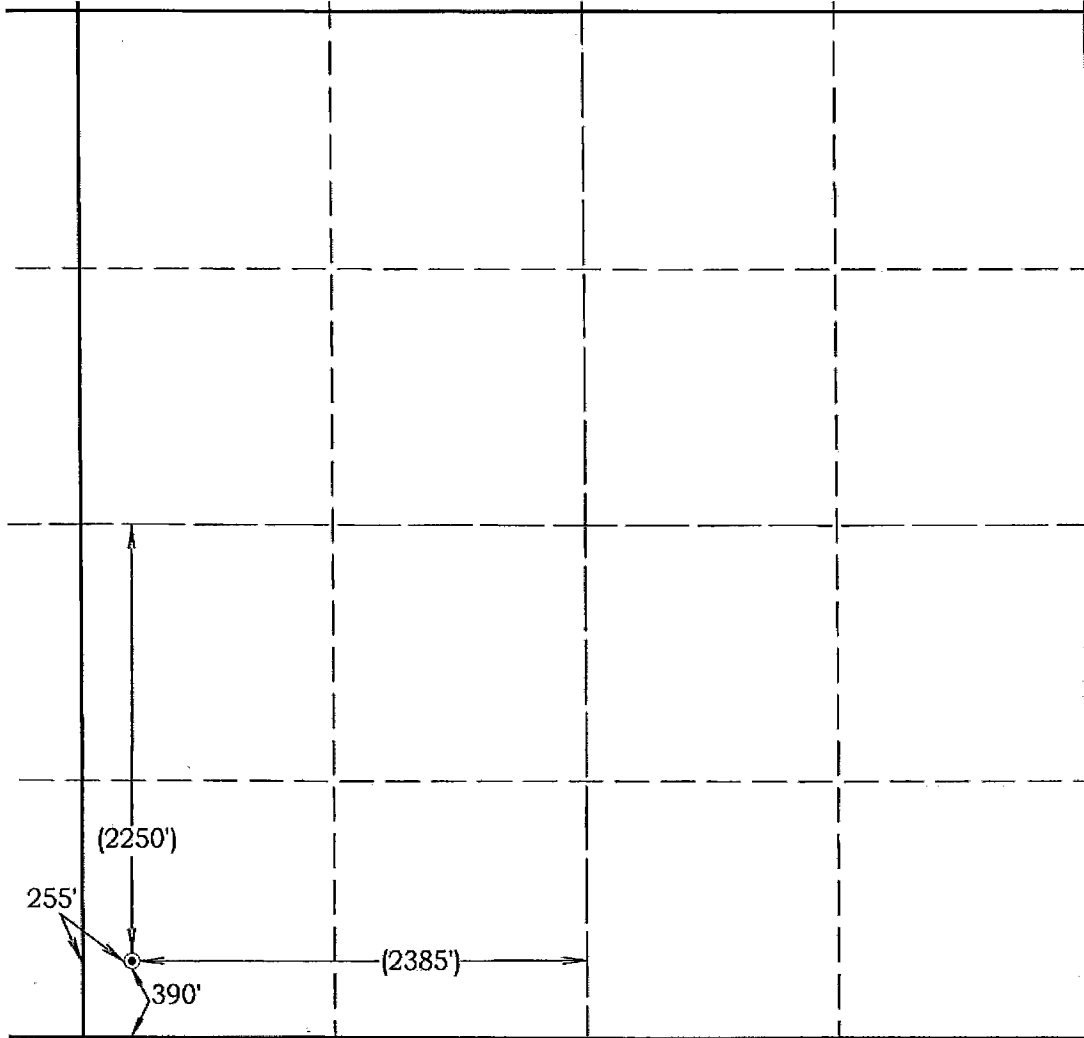

Bearings are based  
on Geodetic North.  
Unless otherwise noted



Scale: 1" = 1000'  
Invoice #15239  
Date 6/11/15

Elevations of Proposed  
Pad Corners

NW/C - N/A  
NE/C - N/A  
SE/C - N/A  
SW/C - N/A

Coordinates were derived  
from GPS RTK methods  
and are only accurate  
within ±10 feet

Location GPS NAD 27  
Oklahoma North  
Surface Location

Latitude: 35.89956°  
Longitude: 98.06642°  
Y= 327,453'  
X = 1,980,328'

Location NAD 83  
Surface Location  
Latitude: 35.89960°  
Longitude: 98.06675°

Best Accessibility to Location  
From the West

Distance & Direction From From the Jct. of U.S. #81 and S.H. #33, go 7.5 miles West on S.H. #33, then 3 miles North and .1 miles West on county roads to the Southwest corner of section 33.  
Highway or Town \_\_\_\_\_

## CERTIFICATE:

I, D. Harry McClintick, a Registered Land Surveyor in the state of Oklahoma, do hereby certify that the above described Well Location was surveyed and staked on the ground as shown.

D. Harry McClintick 7/24/15  
D. Harry McClintick, R.P.L.S. # 1367, CA # 3093

This location has been staked according to the best official survey records available to us, but its accuracy is not guaranteed. Please review this plat and notify us immediately of any discrepancy.

The distances shown in parenthesis ( ) are calculated distances based on the quarter section being 2640' and have not been measured.

