

Oklahoma Corporation Commission
 Oil & Gas Conservation Division
 Post Office Box 52000
 Oklahoma City, Oklahoma 73152-2000
 Rule 165: 10-3-25

Form 1002A

API No.: 35073251930000

Completion Report

Spud Date: October 21, 2015

OTC Prod. Unit No.: 073-217250

Drilling Finished Date: December 15, 2015

1st Prod Date: March 01, 2016

Completion Date: February 22, 2016

Drill Type: HORIZONTAL HOLE

Min Gas Allowable: Yes

Well Name: SANTANA 1H-29X

Purchaser/Measurer: NEWFIELD

Location: KINGFISHER 32 17N 8W
 SE SE SE SE
 275 FSL 250 FEL of 1/4 SEC
 Latitude: 35.89929 Longitude: -98.06846
 Derrick Elevation: 1237 Ground Elevation: 1214

First Sales Date: 03/01/2016

Operator: NEWFIELD EXPLORATION MID-CON INC 20944

1 WILLIAMS CTR STE 1900
 TULSA, OK 74172-0162

Completion Type	
X	Single Zone
	Multiple Zone
	Commingled

Location Exception
Order No
645140

Increased Density
Order No
There are no Increased Density records to display.

Casing and Cement							
Type	Size	Weight	Grade	Feet	PSI	SAX	Top of CMT
SURFACE	9 5/8	40	J-55	1505	500	405	SURFACE
PRODUCTION	5 1/2	20	P-110	18984	800	2380	18935

Liner								
Type	Size	Weight	Grade	Length	PSI	SAX	Top Depth	Bottom Depth
There are no Liner records to display.								

Total Depth: 19003

Packer	
Depth	Brand & Type
There are no Packer records to display.	

Plug	
Depth	Plug Type
There are no Plug records to display.	

Initial Test Data										
Test Date	Formation	Oil BBL/Day	Oil-Gravity (API)	Gas MCF/Day	Gas-Oil Ratio Cu FT/BBL	Water BBL/Day	Pumpin or Flowing	Initial Shut-In Pressure	Choke Size	Flow Tubing Pressure
Mar 21, 2016	MISSISSIPPIAN(EX CHESTER)	1119	46	961	859	749	FLOWING	500	64	215

Completion and Test Data by Producing Formation										
Formation Name: MISSISSIPPIAN(EX CHESTER)			Code: 359MSNLC			Class: OIL				
Spacing Orders				Perforated Intervals						
Order No		Unit Size		From			To			
645139		MULTIUNIT		8828			18838			
644685		640								
Acid Volumes				Fracture Treatments						
23,145 GALLONS 15% HCL				15,000,420 # PROPPANT						
				110,692 BLWTR						

Formation	Top
MISSISSIPPIAN	8424
MANNING	8144
CHESTER	7928

Were open hole logs run? No

Date last log run:

Were unusual drilling circumstances encountered? No

Explanation:

Other Remarks
OCC: FLE ORDER HAS NOT BEEN ISSUED. WE HAVE ACCEPTED OPERATORS DATA AS SUBMITTED. IRREGULAR SECTION.

Lateral Holes

Sec: 29 TWP: 17N RGE: 8W County: KINGFISHER

NW NE NE NE

48 FNL 434 FEL of 1/4 SEC

Depth of Deviation: 4166 Radius of Turn: 8915 Direction: 360 Total Length: 10010

Measured Total Depth: 19003 True Vertical Depth: 8660 End Pt. Location From Release, Unit or Property Line: 48

FOR COMMISSION USE ONLY

1132736

Status: Accepted

HW 1.075-0010

Permit Plat

M & M Land Surveying, Inc.

520 "E" Street NW. Ardmore, OK. 73401
Office 580-226-0446 Mobile 580-221-4999 Fax 580-226-7158

Company Name: Newfield Exploration Mid-Continent, Inc. Lease Name: Santana #1H-29X
Section 32 Township 17 North Range 8 West County Kingfisher Oklahoma

Surface Location 275' FSL - 250' FEL Elevation 1214'

ALL SECTION CORNER COORDINATES ARE NAD 27

Y= 337,634'
X=1,974,766'

S 89°57'06" E

Y= 337,626'
X=1,980,034'

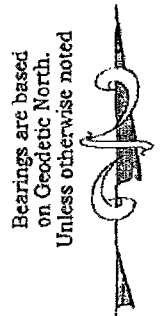
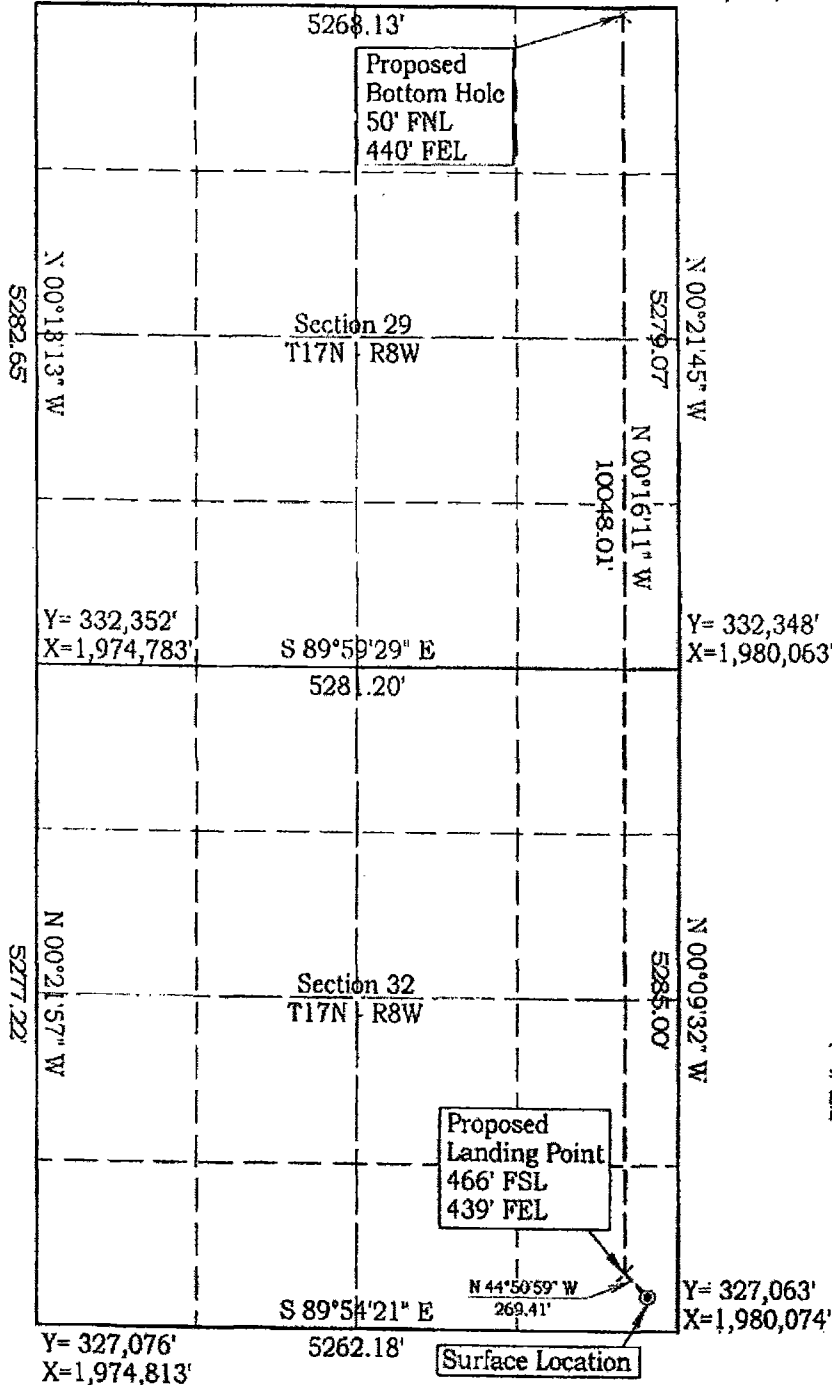

Scale: 1" = 1500'
Invoice # 15240
Date 6/11/15

Coordinates were derived from GPS RTK methods and are only accurate within ±10 feet

Location GPS NAD 27
Oklahoma North
Surface Location
Latitude: 35.89925°
Longitude: 98.06812°
Y= 327,339'
X= 1,979,824'

Location NAD 83
Surface Location
Latitude: 35.89929°
Longitude: 98.06816°
Y= 327,364'
X= 1,948,224'

D. Harry McClintick

D. Harry McClintick, R.P.L.S. # 1367, CA # 3093

This location has been staked according to the best official survey records available to us, but its accuracy is not guaranteed. Please review this plat and notify us immediately of any discrepancy.

