

Oklahoma Corporation Commission
Oil & Gas Conservation Division
Post Office Box 52000
Oklahoma City, Oklahoma 73152-2000
Rule 165: 10-3-25

Form 1002A

API No.: 35087218090003

Completion Report

Spud Date: September 23, 2008

OTC Prod. Unit No.: 087-126008

Drilling Finished Date: October 19, 2008

Amended

1st Prod Date: November 11, 2008

Amend Reason: RECOMPLETE HUNTON

Completion Date: November 07, 2008

Recomplete Date: April 17, 2016

Drill Type: STRAIGHT HOLE

Min Gas Allowable: Yes

Well Name: GUS (XTREME OIL CREEK 1-S19) 1-19

Purchaser/Measurer: KINDER-MORGAN

Location: MCCLAIN 19 6N 2W
W2 E2 NE SW
1980 FSL 2000 FWL of 1/4 SEC
Latitude: 34.976986 Longitude: -97.452472
Derrick Elevation: 1122 Ground Elevation: 1106

First Sales Date:

Operator: CHARTER OAK PRODUCTION CO LLC 21672

13929 QUAIL POINTE DR
OKLAHOMA CITY, OK 73134-1037

Completion Type		Location Exception		Increased Density	
X	Single Zone	Order No		Order No	
	Multiple Zone	612747		There are no Increased Density records to display.	
	Commingled				

Casing and Cement							
Type	Size	Weight	Grade	Feet	PSI	SAX	Top of CMT
CONDUCTOR	16			15		3	SURFACE
SURFACE	9 5/8	36	J-55	1200		390	SURFACE
PRODUCTION	5 1/2	17	N-80	9285		520	8454

Liner								
Type	Size	Weight	Grade	Length	PSI	SAX	Top Depth	Bottom Depth
There are no Liner records to display.								

Total Depth: 9285

Packer		Plug	
Depth	Brand & Type	Depth	Plug Type
There are no Packer records to display.		8465	CIBP

Initial Test Data

Test Date	Formation	Oil BBL/Day	Oil-Gravity (API)	Gas MCF/Day	Gas-Oil Ratio Cu FT/BBL	Water BBL/Day	Pumpin or Flowing	Initial Shut-In Pressure	Choke Size	Flow Tubing Pressure
Nov 29, 2008	1ST BROMIDE	78	38			187	PUMPING	50		100
Aug 19, 2013	VIOLA	75		119	1586	6	PUMPING	1820		
Apr 17, 2016	HUNTON	1	40.5	5	5000		PUMPING	1600		

Completion and Test Data by Producing Formation

Formation Name: 1ST BROMIDE

Code: 202BRMD1

Class: DRY

Spacing Orders

Order No	Unit Size
54965	80

Perforated Intervals

From	To
8734	8744

Acid Volumes

There are no Acid Volume records to display.

Fracture Treatments

There are no Fracture Treatments records to display.

Formation Name: VIOLA

Code: 202VIOL

Class: DRY

Spacing Orders

Order No	Unit Size
559826	80
570018	80

Perforated Intervals

From	To
8472	8486

Acid Volumes

13,842 GALLONS 15% ACID

Fracture Treatments

210 BW

Formation Name: HUNTON

Code: 269HNTN

Class: OIL

Spacing Orders

Order No	Unit Size
559826	80
570018	80

Perforated Intervals

From	To
7833	7840

Acid Volumes

7,500 GALLONS 15% NEFE HCL

Fracture Treatments

52 BARRELS 2% KCL

Were open hole logs run? Yes

Date last log run: October 17, 2008

Were unusual drilling circumstances encountered? No

Explanation:

Formation	Top
DEESE	7510
WOODFORD	7777
HUNTON	7833
VIOLA	8250
1ST BROMIDE	8700
2ND BROMIDE	8790

Other Remarks
There are no Other Remarks.

FOR COMMISSION USE ONLY	
Status: Accepted	1133505

RECEIVED

Form 1002A
Rev. 2009

MAY 09 2016

OKLAHOMA CORPORATION
COMMISSIONAPI NO. 35-087-21809
OTC PROD. UNIT NO. 087-126008PLEASE TYPE OR USE BLACK INK ONLY
NOTE:Attach copy of original 1002A
if recompletion or reentry.OKLAHOMA CORPORATION COMMISSION
Oil & Gas Conservation Division
Post Office Box 52000
Oklahoma City, Oklahoma 73152-2000
Rule 165:10-3-25☐ ORIGINAL
☒ AMENDED (Reason) Recomplete Hunton

COMPLETION REPORT

TYPE OF DRILLING OPERATION

☒ STRAIGHT HOLE ☐ DIRECTIONAL HOLE ☐ HORIZONTAL HOLE
☐ SERVICE WELL

If directional or horizontal, see reverse for bottom hole location.

COUNTY McClain	SEC 19	TWP 06N	RGE 02W	SPUD DATE 9/23/08
LEASE NAME Gus (Xtreme Oil Creek)	WELL NO. 1-19 (1-S19)	DATE OF WELL COMPLETION 11/7/08	DRLG FINISHED DATE 10/19/08	1st PROD DATE 11/11/08
W2 1/4 E2 1/4 NE 1/4 SW 1/4	FSL OF 1/4 SEC 1980'	FWL OF 1/4 SEC 2000'	RECOMP DATE 4/17/16	
ELEVATION N Derrick 1122' Ground 1106'	Latitude (if known) 34.976986	Longitude (if known) -97.452472		
OPERATOR NAME Charter Oak Production Co., LLC	OTC/OCC OPERATOR NO. 21672			
ADDRESS 13929 Quail Pointe Dr.				
CITY Oklahoma City	STATE OK	ZIP 73134		

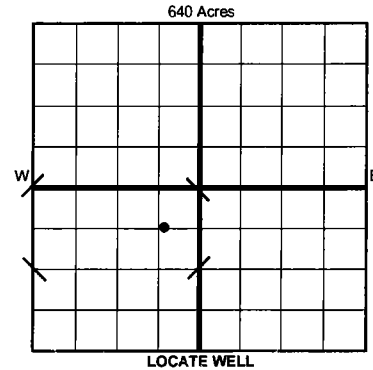

COMPLETION TYPE

<input checked="" type="checkbox"/> SINGLE ZONE
<input type="checkbox"/> MULTIPLE ZONE
Application Date
<input type="checkbox"/> COMMINGLED
Application Date
LOCATION EXCEPTION ORDER 612747
INCREASED DENSITY ORDER NO. N/A

CASING & CEMENT (Form 1002C must be attached)

TYPE	SIZE	WEIGHT	GRADE	FEET	PSI	SAX	TOP OF CMT
CONDUCTOR	16"			15'		3 yds	Surface
SURFACE	9 5/8"	36#	J-55	1200'		390	Surface
INTERMEDIATE							
PRODUCTION	5 1/2"	17#	N-80	9285'		520	8454'
LINER							
				TOTAL DEPTH	9285'		

PACKER @ _____ BRAND & TYPE _____ PLUG @ 8465' TYPE CIBP PLUG @ _____ TYPE _____
PACKER @ _____ BRAND & TYPE _____ PLUG @ _____ TYPE _____ PLUG @ _____ TYPE _____COMPLETION & TEST DATA BY PRODUCING FORMATION *202 BRMD 202 VIOL 269 HNTN*

FORMATION	1st Bromide	Viola	Hunton
SPACING & SPACING ORDER NUMBER	80 Ac. - 54965	80 Ac. - 559826/570018	80 Ac. - 559826/570018
CLASS: Oil, Gas, Dry, Inj, Disp, Comm Disp, Svc	<i>oil Dry under plug</i>	<i>oil Dry under plug</i>	Oil
PERFORATED INTERVALS	8734' - 8744'	8472' - 8486'	7833' - 7840'
ACID/VOLUME		13,842 Gal 15% acid	7500 Gal 15% NeFe HCl
FRACTURE TREATMENT (Fluids/Prop Amounts)		210 BW	52 BBL 2% KCl

AS SUBMITTED

Min Gas Allowable (165:10-17-7)

Gas Purchaser/Measurer

Kinder-Morgan



OR

First Sales Date

Unknown

INITIAL TEST DATA

Oil Allowable (165:10-13-3)

INITIAL TEST DATE	11/29/08	8/19/13	4/17/16
OIL-BBL/DAY	78	75	1
OIL-GRAVITY (API)	38		40.5
GAS-MCF/DAY	N/A	119	5
GAS-OIL RATIO CU FT/BBL	N/A	1586.67	5000
WATER-BBL/DAY	187	6	0
PUMPING OR FLOWING	Pumping	Pumping	Pumping
INITIAL SHUT-IN PRESSURE	50 psi	1820 psi	1600 psi
CHOKE SIZE	N/A	N/A	N/A
FLOW TUBING PRESSURE	100	N/A	N/A

A record of the formations drilled through, and pertinent remarks are presented on the reverse. I declare that I have knowledge of the contents of this report and am authorized by my organization to make this report, which was prepared by me or under my supervision and direction, with the data and facts stated herein to be true, correct, and complete to the best of my knowledge and belief.

Joseph C. Brevetti

JC Brevetti, Engineering Tech.

5/6/16

(405) 286-0361

SIGNATURE

NAME (PRINT OR TYPE)

DATE

PHONE NUMBER

13929 Quail Pointe Dr.

Oklahoma City

OK 73134

brevetti@charteroakproduction.com

ADDRESS

CITY

STATE

ZIP

EMAIL ADDRESS

Give formation names and tops, if available, or descriptions and thickness of formations drilled through. Show intervals cored or drillstem tested.

WELL NO. 1-19 (1-S19)

NAMES OF FORMATIONS	TOP
Deese	7510'
Woodford	7777'
Hunton	7833'
Viola	8250'
1st Bromide	8700'
2nd Bromide	8790'

FOR COMMISSION USE ONLY	
ITD on file	<input type="checkbox"/> YES <input type="checkbox"/> NO
APPROVED	DISAPPROVED
<div>2) Reject Codes</div> <div> <div></div> <div></div> <div></div> <div></div> <div></div> </div>	

Were open hole logs run? ☒ yes ☐ no

Date Last log was run October 17, 2008

Was CO₂ encountered? ☐ yes ☒ no at what depths? _____

Was H₂S encountered? ☐ yes ☒ no at what depths? _____

Were unusual drilling circumstances encountered? ☐ yes ☒ no

If yes, briefly explain below

Other remarks:

640 Acres

A blank 10x10 grid with a bold cross dividing it into four 5x5 quadrants.

If more than three drainholes are proposed, attach a separate sheet indicating the necessary information.

Direction must be stated in degrees azimuth.
Please note, the horizontal drainhole and its end
point must be located within the boundaries of the
lease or spacing unit.

Directional surveys are required for all drainholes and directional wells.

640 Acres

A blank 10x10 grid with a bold cross dividing it into four 5x5 quadrants.

BOTTOM HOLE LOCATION FOR DIRECTIONAL HOLE

SEC	TWP	RGE	COUNTY
Spot Location		Feet From 1/4 Sec Lines	FSL
1/4	1/4	1/4	1/4
Measured Total Depth	True Vertical Depth	BHL From Lease, Unit, or Property Line:	

BOTTOM HOLE LOCATION FOR HORIZONTAL HOLE: (LATERALS)

LATERAL #1

EXTERNAL #1						
SEC	TWP	RGE	COUNTY			
Spot Location				Feet From 1/4 Sec Lines	FSL	FWL
1/4	1/4	1/4	1/4			
Depth of Deviation		Radius of Turn		Direction	Total Length	
Measured Total Depth		True Vertical Depth		BHL From Lease, Unit, or Property Line:		

LATERAL #2

EXTERNAL #						
SEC	TWP	RGE	COUNTY			
Spot Location				Feet From 1/4 Sec Lines		FSL
1/4	1/4	1/4	1/4			FWL
Depth of Deviation		Radius of Turn		Direction		Total Length
Measured Total Depth		True Vertical Depth		BHL From Lease, Unit, or Property Line:		

LATERAL #3

SEC	TWP	RGE	COUNTY			
Spot Location				Feet From 1/4 Sec Lines	FSL	FWL
1/4	1/4	1/4	1/4			
Depth of Deviation		Radius of Turn	Direction	Total Length		
Measured Total Depth		True Vertical Depth	BHL From Lease, Unit, or Property Line:			