

OKLAHOMA CORPORATION COMMISSION
OIL & GAS CONSERVATION DIVISION
P.O. BOX 52000
OKLAHOMA CITY, OK 73152-2000
(Rule 165:10-3-1)

API NUMBER: 133 25227

Approval Date: 05/17/2016
Expiration Date: 11/17/2016

Straight Hole Oil & Gas

PERMIT TO DRILL

WELL LOCATION: Sec: 29 Twp: 7N Rge: 7E County: SEMINOLE
SPOT LOCATION: NW SE NE SE FEET FROM QUARTER: FROM SOUTH FROM WEST
SECTION LINES: 1905 1988

Lease Name: WILLIAMSON Well No: 1-29 Well will be 639 feet from nearest unit or lease boundary.
Operator Name: GULF EXPLORATION LLC Telephone: 4058403371 OTC/OCC Number: 20983 0

GULF EXPLORATION LLC
9701 N BROADWAY EXT
OKLAHOMA CITY, OK 73114-6316

FERRIL & PHYLLIS WILLIAMSON
200 WESTWOOD
WEWOKA OK 73114

Formation(s) (Permit Valid for Listed Formations Only):

Name	Depth	Name	Depth
1 WEWOKA	960	6 EARLSBORO	2450
2 CALVIN	1445	7 BARTLESVILLE	2850
3 ALLEN	2010	8 BOOCH	3000
4 SENORA	2070	9 GILCREASE	3100
5 THURMAN	2450	10	

Spacing Orders: 647115

Location Exception Orders:

Increased Density Orders:

Pending CD Numbers: 201601542

Special Orders:

Total Depth: 3200

Ground Elevation: 844

Surface Casing: 750

Depth to base of Treatable Water-Bearing FM: 700

Under Federal Jurisdiction: No

Fresh Water Supply Well Drilled: No

Surface Water used to Drill: Yes

PIT 1 INFORMATION

Approved Method for disposal of Drilling Fluids:

Type of Pit System: CLOSED Closed System Means Steel Pits

Type of Mud System: WATER BASED

Chlorides Max: 8000 Average: 5000

Is depth to top of ground water greater than 10ft below base of pit? Y

Within 1 mile of municipal water well? N

Wellhead Protection Area? N

Pit is located in a Hydrologically Sensitive Area.

Category of Pit: C

Liner not required for Category: C

Pit Location is ALLUVIAL

Pit Location Formation: ALLUVIUM

E. Haul to Commercial pit facility: Sec. 19 Twn. 8N Rng. 5E Cnty. 125 Order No: 274874

H. CLOSED SYSTEM=STEEL PITS PER OPERATOR REQUEST

Notes:

This permit does not address the right of entry or settlement of surface damages.
The duration of this permit is SIX MONTHS, except as otherwise provided by Rule 165: 10-3-1.
Rule 165: 10-3-4 (c) (7) (e) - The Operator shall give 24 Hours notice by telephone to the appropriate District Office of the Conservation Division as to when Surface Casing will be run.

133 25227 WILLIAMSON 1-29

Category	Description
HYDRAULIC FRACTURING	5/17/2016 - G71 - OCC 165:10-3-10 REQUIRES: 1) THE CHEMICAL DISCLOSURE OF HYDRAULIC FRACTURING INGREDIENTS FOR ALL WELLS BE REPORTED TO FRACFOCUS USING THE FOLLOWING LINK HTTP://FRACFOCUS.ORG/ WITH NOTICE GIVEN 48 HOURS IN ADVANCE OF FRACTURING TO THE LOCAL OCC DISTRICT OFFICE; AND, 2) PRIOR TO COMMENCEMENT OF FRACTURING OPERATIONS FOR HORIZONTAL WELLS, NOTICE ALSO GIVEN FIVE BUSINESS DAYS IN ADVANCE TO OFFSET OPERATORS WITH WELLS COMPLETED IN THE SAME COMMON SOURCE OF SUPPLY WITHIN 1/2 MILE.
PENDING CD - 201601542	5/17/2016 - G75 - (40) E2 SE4 29-7N-7E VAC 250314 ERLB E2 SE4 EST TRMN, ERLB, BRVL, BOCH, GLCR REC 5-17-2016 (THOMAS)
SPACING - 647115	5/17/2016 - G75 - (40) E2 SE4 29-7N-7E VAC 250314 CLVN, ALLN, SNOR E2 SE4 EST WWOK, CLVN, ALLN, SNOR
SURFACE LOCATION	5/17/2016 - G75 - 1905' FSL, 726' FNL, 1988' FWL, 639' FEL SE4 29-7N-7E PER STAKING PLAT

This permit does not address the right of entry or settlement of surface damages.
The duration of this permit is SIX MONTHS, except as otherwise provided by Rule 165: 10-3-1.
Rule 165: 10-3-4 (c) (7) (e) - The Operator shall give 24 Hours notice by telephone to the appropriate District Office of the Conservation Division as to when Surface Casing will be run.

133 25227 WILLIAMSON 1-29

APT 133-25227

SECTION 29, T 07 N - R 07 E, I.M.,
SEMINOLE COUNTY, OKLAHOMA

X: (2419198)
Y: (630573)

X: (2421841)
Y: (630550)

X: 2424484
Y: 630527

BEARINGS ARE GRID
OKLAHOMA SPC, NAD 27, SOUTH ZONE

X: (2424496)
Y: (627903)

X: (2419234)
Y: (627922)

29

DATUM: NAD-27
LAT: N35°02'54.9"
LONG: W96°35'02.0"
LAT: N35.048574
LONG: W96.583884
SPC (US FEET): OK-S
X: 2423860
Y: 627179

726'

1988'

639'

1905'

X: (2419270)
Y: (625272)

X: 2421890
Y: 625257

X: 2424508
Y: 625280

Operator: GULF EXPLORATION, L.L.C. Date Staked: 2/19/2016
Lease Name: WILLIAMSON Well No.: 1-29 Elevation: 844'
Topography and Vegetation: BRUSH
Good Drill Site? YES Reference or Alt. Location Stakes Set: NONE
Best Accessibility to Location: FROM COUNTY ROAD
Distance and Direction from Hwy. Jct. or town: FROM THE INTERSECTION OF US HWY. 56 AND CO. RD. E1360, HEAD WEST ON CO. RD. 1360 4.8 MILES. LOCATION IS 0.4 MILES NORTH OF CO. RD. 1360

LEGEND
SURFACE LOCATION
EXISTING PIPELINE
ELECTRIC LINE
OVERHEAD POWER
FENCE

Gulf Exploration, L.L.C.
9701 N. Broadway Ext.
Oklahoma City, OK 73114

Gateway Services Group, LLC
PO, BOX 960
WEEKER, OK 74855
OFF. (405) 273-0954
FAX (405) 273-0580
C.A. NO. 4091 (LS)
EXP. DATE 6-30-2016

FRED ANTHONY SELESKY
OKLAHOMA L.P.L.S. NO. 1860
DATE: 2-23-2016

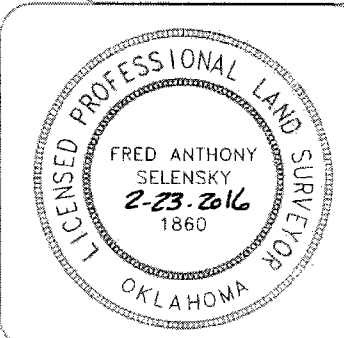

EXHIBIT "A" PRELIMINARY
WILLIAMSON 1-29
1905' FSL - 639' FEL
SE/4 SECTION 29, T 07 N - R 07 E, I.M.,
SEMINOLE COUNTY, OKLAHOMA

NOTE:
This is a plat of a proposed well location and does not represent a true boundary survey. The information shown hereon shall not be relied upon for the location or establishment of land boundary lines. All of the positions shown hereon have not been verified as being actual Section, Quarter or Property corners. Positions shown in (Parentheses) are based upon local occupation and improvements or calculated per proportional measurement and/or G.L.O. record distances. Review this plat and notify Gateway Services Group, LLC immediately of any possible discrepancy.

DRAWN BY: JE	DATE: 2/22/16	CHK'D BY: RLG	
GATEWAY NO.: 15-0109-101	SCALE: 1"=1000'		
PN#:	APP#:		
REV.	DWN.	DESCRIPTION	DATE