

Oklahoma Corporation Commission  
Oil & Gas Conservation Division  
Post Office Box 52000  
Oklahoma City, Oklahoma 73152-2000  
Rule 165: 10-3-25

Form 1002A

API No.: 35151244230000

**Completion Report**

Spud Date: November 03, 2015

OTC Prod. Unit No.: 151-217340

Drilling Finished Date: December 05, 2015

1st Prod Date: April 01, 2016

Completion Date: March 29, 2016

**Drill Type: HORIZONTAL HOLE**

Min Gas Allowable: Yes

Well Name: GATZ 2614 1H-04 D

Purchaser/Measurer: SEMGAS

Location: WOODS 4 26N 14W  
S2 S2 SE SE  
225 FSL 660 FEL of 1/4 SEC  
Derrick Elevation: 0 Ground Elevation: 1449

First Sales Date: 04/07/2016

Operator: MIDSTATES PETROLEUM COMPANY LLC 23079

321 S BOSTON AVE STE 600  
TULSA, OK 74103-3322

Completion Type	
X	Single Zone
	Multiple Zone
	Commingled

Location Exception
Order No
646073

Increased Density
Order No
There are no Increased Density records to display.

Casing and Cement							
Type	Size	Weight	Grade	Feet	PSI	SAX	Top of CMT
SURFACE	13 3/8	48	J-55	665		620	SURFACE
INTERMEDIATE	9 5/8	36	J-55	1080		385	SURFACE
PRODUCTION	7	26	P-110	6510		295	4075

Liner								
Type	Size	Weight	Grade	Length	PSI	SAX	Top Depth	Bottom Depth
LINER	4.5	11.6	P-110	5322	0	580	6202	11524

**Total Depth: 11524**

Packer	
Depth	Brand & Type
There are no Packer records to display.	

Plug	
Depth	Plug Type
There are no Plug records to display.	

Initial Test Data										
Test Date	Formation	Oil BBL/Day	Oil-Gravity (API)	Gas MCF/Day	Gas-Oil Ratio Cu FT/BBL	Water BBL/Day	Pumpin or Flowing	Initial Shut-In Pressure	Choke Size	Flow Tubing Pressure
Apr 26, 2016	MISSISSIPPI LIME	222	30	808	3640	3605	PUMPING	80	64/64	171

Completion and Test Data by Producing Formation																
Formation Name: MISSISSIPPI LIME	Code: 351MSSLM	Class: OIL														
<table border="1"> <thead> <tr> <th colspan="2">Spacing Orders</th> </tr> <tr> <th>Order No</th> <th>Unit Size</th> </tr> </thead> <tbody> <tr> <td>78190</td> <td>640</td> </tr> <tr> <td>78764</td> <td>640</td> </tr> </tbody> </table>		Spacing Orders		Order No	Unit Size	78190	640	78764	640	<table border="1"> <thead> <tr> <th colspan="2">Perforated Intervals</th> </tr> <tr> <th>From</th> <th>To</th> </tr> </thead> <tbody> <tr> <td>6550</td> <td>11435</td> </tr> </tbody> </table>	Perforated Intervals		From	To	6550	11435
Spacing Orders																
Order No	Unit Size															
78190	640															
78764	640															
Perforated Intervals																
From	To															
6550	11435															
<table border="1"> <thead> <tr> <th>Acid Volumes</th> </tr> </thead> <tbody> <tr> <td>5,260 BARRELS 15% GELLED AND RET ACID, 690 BARRELS 15% HCL</td> </tr> </tbody> </table>		Acid Volumes	5,260 BARRELS 15% GELLED AND RET ACID, 690 BARRELS 15% HCL	<table border="1"> <thead> <tr> <th>Fracture Treatments</th> </tr> </thead> <tbody> <tr> <td>102,861 BARRELS SLICK WATER, 170,716 POUNDS ROCK SALT</td> </tr> </tbody> </table>	Fracture Treatments	102,861 BARRELS SLICK WATER, 170,716 POUNDS ROCK SALT										
Acid Volumes																
5,260 BARRELS 15% GELLED AND RET ACID, 690 BARRELS 15% HCL																
Fracture Treatments																
102,861 BARRELS SLICK WATER, 170,716 POUNDS ROCK SALT																

Formation	Top
HEEBNER	4412
TONKAWA	4751
AVANT LIME	5075
COTTAGE GROVE	5133
HOGSHOOTER	5194
CHECKERBOARD	5235
OSWEGO	5374
CHEROKEE	5508
MISSISSIPPI LIME	5673

Were open hole logs run? No

Date last log run:

Were unusual drilling circumstances encountered? No

Explanation:

Other Remarks
OCC - THIS DOCUMENT IS ACCEPTED BASED ON THE DATA SUBMITTED THE FINAL LOCATION EXCEPTION HAS NOT BEEN SUBMITTED.

**Lateral Holes**

Sec: 4 TWP: 26N RGE: 14W County: WOODS

NE NW NE NE

125 FNL 669 FEL of 1/4 SEC

Depth of Deviation: 6556 Radius of Turn: 792 Direction: 360 Total Length: 5014

Measured Total Depth: 11524 True Vertical Depth: 5673 End Pt. Location From Release, Unit or Property Line: 125

**FOR COMMISSION USE ONLY**

1133450

Status: Accepted

RECEIVED

Form 1002A Rev. 2009

API NO. 151 24423
OTC PROD. UNIT NO. 151 217340

PLEASE TYPE OR USE BLACK INK ONLY
NOTE:

Attach copy of original 1002A if recompletion or reentry.

OKLAHOMA CORPORATION COMMISSION
Oil & Gas Conservation Division
Post Office Box 52000
Oklahoma City, Oklahoma 73152-2000
Rule 165:10-3-25

MAY 02 2016

OKLAHOMA CORPORATION COMMISSION

ORIGINAL AMENDED (Reason)

COMPLETION REPORT

TYPE OF DRILLING OPERATION: STRAIGHT HOLE, DIRECTIONAL HOLE, HORIZONTAL HOLE
COUNTY Woods, SEC 04, TWP 26N, RGE 14W
LEASE NAME Gatz 2614, WELL NO. 1H-04 D
DATE OF WELL COMPLETION 03/29/2016, 1st PROD DATE 04/01/2016
OPERATOR NAME Midstates Petroleum Company LLC, OTC/OCC OPERATOR NO. 23079
ADDRESS 321 South Boston, Suite 1000
CITY Tulsa, STATE OK, ZIP 74103

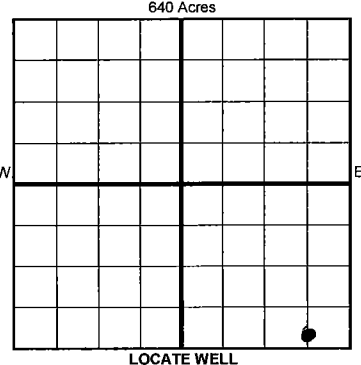

COMPLETION TYPE: SINGLE ZONE
MULTIPLE ZONE Application Date
COMMINGLED Application Date
LOCATION 646073 I.O.
EXCEPTION ORDER INCREASED DENSITY ORDER NO. N/A

CASING & CEMENT (Form 1002C must be attached)

Table with columns: TYPE, SIZE, WEIGHT, GRADE, FEET, PSI, SAX, TOP OF CMT. Rows include CONDUCTOR, SURFACE, INTERMEDIATE, PRODUCTION, LINER.

PACKER @ BRAND & TYPE PLUG @ TYPE PLUG @ TYPE
TOTAL DEPTH 11,524'

COMPLETION & TEST DATA BY PRODUCING FORMATION 351MSSLM

Table with columns: FORMATION, SPACING & SPACING ORDER NUMBER, CLASS, PERFORATED INTERVALS, ACID/VOLUME, FRACTURE TREATMENT. Includes handwritten notes like 'Mississippi Lime', '640/78764 / 78190 (640)', and 'Reported to Frac Focus'.

Min Gas Allowable (165:10-17-7) OR Oil Allowable (165:10-13-3)
GAS Purchaser/Measurer SemGas
First Sales Date 04/07/2016

INITIAL TEST DATA

Table with columns: INITIAL TEST DATE, OIL-BBL/DAY, OIL-GRAVITY (API), GAS-MCF/DAY, GAS-OIL RATIO CU FT/BBL, WATER-BBL/DAY, PUMPING OR FLOWING, INITIAL SHUT-IN PRESSURE, CHOKE SIZE, FLOW TUBING PRESSURE.

AS SUBMITTED

A record of the formations drilled through, and pertinent remarks are presented on the reverse. I declare that I have knowledge of the contents of this report and am authorized by my organization to make this report, which was prepared by me or under my supervision and direction, with the data and facts stated herein to be true, correct, and complete to the best of my knowledge and belief.
04/26/2016 918-947-4647

SIGNATURE Chelce Rouse NAME (PRINT OR TYPE) DATE PHONE NUMBER
321 South Boston, Suite 1000 Tulsa, OK 74103 chelce.rouse@midstatespetroleum.com
ADDRESS CITY STATE ZIP EMAIL ADDRESS

PLEASE TYPE OR USE BLACK INK ONLY  
FORMATION RECORD

Give formation names and tops, if available, or descriptions and thickness of formations drilled through. Show intervals cored or drillstem tested.

LEASE NAME Gatz 2614

WELL NO. 1H-04 D

NAMES OF FORMATIONS	TOP
Heebner	4412
Tonkawa	4751
Avant Lm	5075
Cottage Grove	5133
Hogshooter	5194
Checkerboard	5235
Oswego	5374
Cherokee	5508
Miss Lime	5673

FOR COMMISSION USE ONLY

ITD on file  YES  NO

APPROVED \_\_\_\_\_ DISAPPROVED \_\_\_\_\_

2) Reject Codes \_\_\_\_\_  
 \_\_\_\_\_  
 \_\_\_\_\_  
 \_\_\_\_\_

Were open hole logs run?  yes  no

Date Last log was run N/A

Was CO<sub>2</sub> encountered?  yes  no at what depths? \_\_\_\_\_

Was H<sub>2</sub>S encountered?  yes  no at what depths? \_\_\_\_\_

Were unusual drilling circumstances encountered?  yes  no  
 If yes, briefly explain below \_\_\_\_\_

Other remarks: \_\_\_\_\_  
 \_\_\_\_\_  
 \_\_\_\_\_  
 \_\_\_\_\_

640 Acres

If more than three drainholes are proposed, attach a separate sheet indicating the necessary information.

Direction must be stated in degrees azimuth. Please note, the horizontal drainhole and its end point must be located within the boundaries of the lease or spacing unit.

Directional surveys are required for all drainholes and directional wells.

640 Acres

BOTTOM HOLE LOCATION FOR DIRECTIONAL HOLE

SEC	TWP	RGE	COUNTY		
04	26N	14W	Woods		
Spot Location		Feet From 1/4 Sec Lines		FSL	FWL
1/4 1/4 1/4 1/4					
Measured Total Depth		True Vertical Depth		BHL From Lease, Unit, or Property Line:	

BOTTOM HOLE LOCATION FOR HORIZONTAL HOLE: (LATERALS)

LATERAL #1

SEC	TWP	RGE	COUNTY		
04	26N	14W	Woods		
Spot Location		Feet From 1/4 Sec Lines		FSL	FWL
N2 NE 1/4 N2 NW 1/4 NE 1/4 NE 1/4				125N	669E
Depth of Deviation 6,556'		Radius of Turn 792'		Direction <del>40</del> 360	
Total Length 5,014'		Measured Total Depth 11,524'		True Vertical Depth 5,673'	
				BHL From Lease, Unit, or Property Line: 125	

LATERAL #2

SEC	TWP	RGE	COUNTY		
04	26N	14W	Woods		
Spot Location		Feet From 1/4 Sec Lines		FSL	FWL
1/4 1/4 1/4 1/4					
Depth of Deviation		Radius of Turn		Direction	
Total Length		Measured Total Depth		True Vertical Depth	
				BHL From Lease, Unit, or Property Line:	

LATERAL #3

SEC	TWP	RGE	COUNTY		
04	26N	14W	Woods		
Spot Location		Feet From 1/4 Sec Lines		FSL	FWL
1/4 1/4 1/4 1/4					
Depth of Deviation		Radius of Turn		Direction	
Total Length		Measured Total Depth		True Vertical Depth	
				BHL From Lease, Unit, or Property Line:	